



FCC-ID:KR5FBD5

Continental Automotive GmbH

IC:7812D-FBD5

Installation Manual for FBD5

1. How to assembly / mount the module in vehicle

Module FBD5 will be fixed with clips in the vehicle chassis.

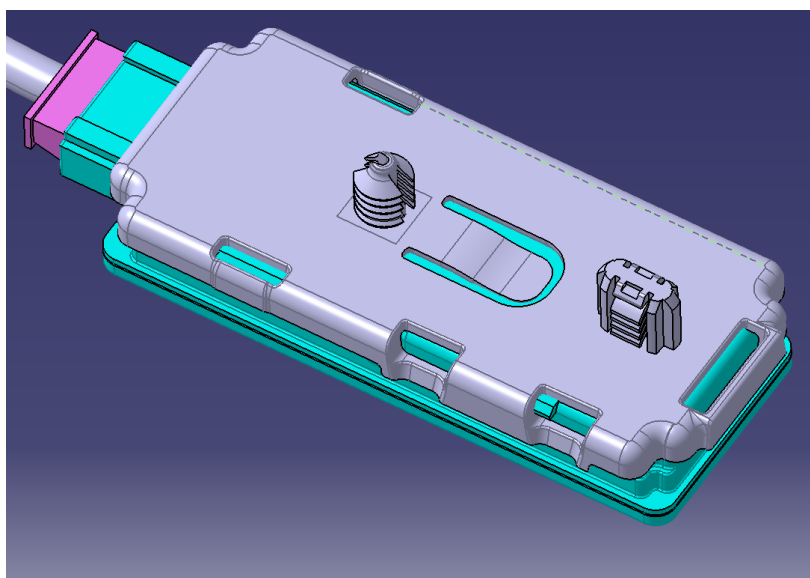



Continental Automotive GmbH

FCC-ID:KR5FBD5

IC:7812D-FBD5

2. Statement

a) User Information gem. FCC 15.21:

Changes or modifications not expressly approved by the party responsible for compliance could void the user's authority to operate the equipment.

b) Part 15 Statement gem. FCC 15.19 falls das Statement nicht auf dem Gerät steht, weil dieses kleiner als eine Handfläche ist)

This device complies with Part 15 of the FCC Rules. Operation is subject to the following two conditions:

(1) This device may not cause interference.

(2) This device must accept any interference, including interference that may cause undesired operation of the device.

c) Statement gem. RSS GEN Issue 5:.

This device contains licence-exempt transmitter(s)/receiver(s) that comply with Innovation, Science and Economic Development Canada's licence-exempt RSS(s). Operation is subject to the following two conditions:

(1) This device may not cause interference

(2) This device must accept any interference, including interference that may cause undesired operation of the device..

Cet appareil contient des émetteurs / récepteurs exemptés de licence conformes aux RSS (RSS) d'Innovation, Sciences et Développement économique Canada. Le fonctionnement est soumis aux deux conditions suivantes: (1) Cet appareil ne doit pas causer d'interférences (2) Cet appareil doit accepter toutes les interférences, y compris celles susceptibles de provoquer un fonctionnement indésirable de l'appareil.