

| REVISIONS | | |
|-----------|-----|------|
| REV | ECN | DATE |
| -- | --- | ---- |

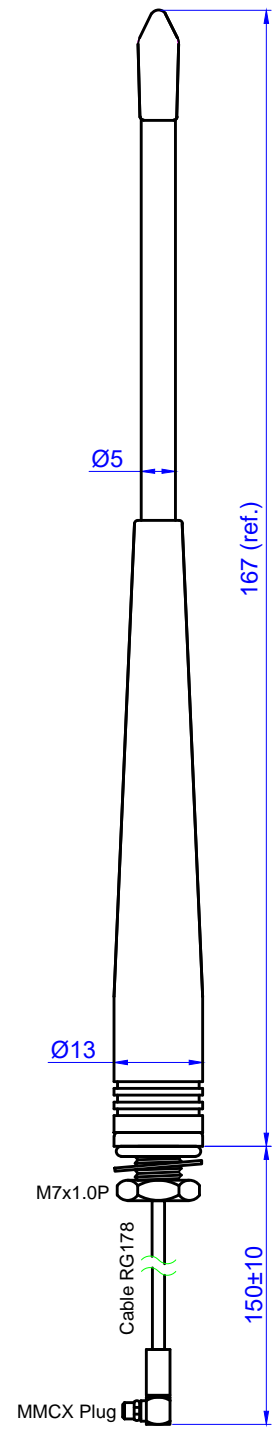

NOTES

1. THIS IS A RoHS COMPLIANT PRODUCT

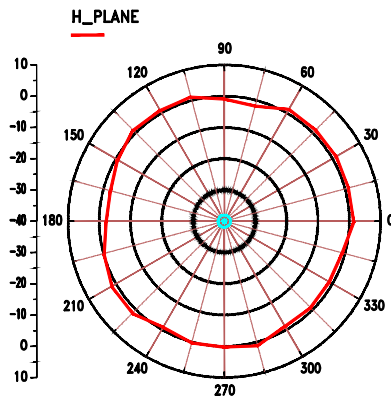
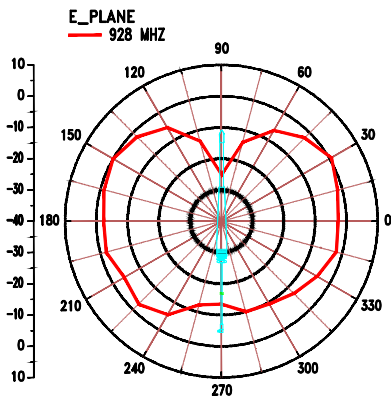
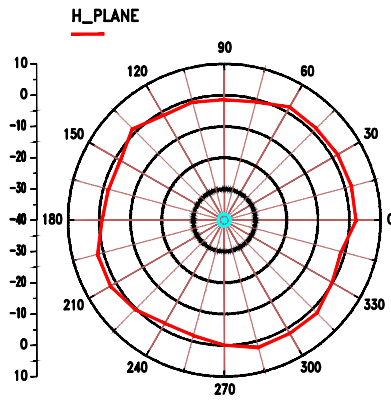
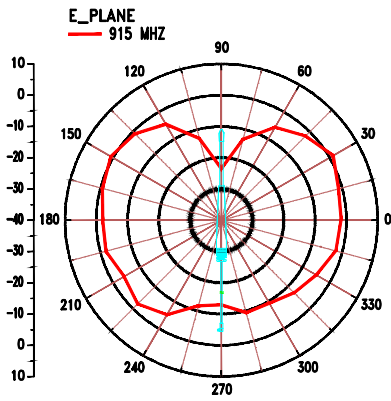
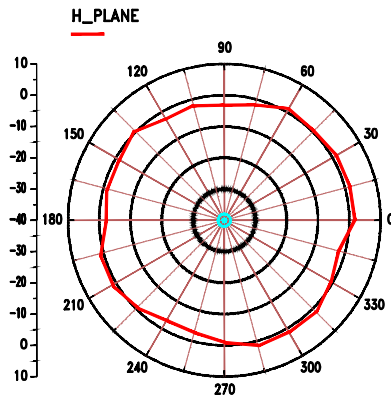
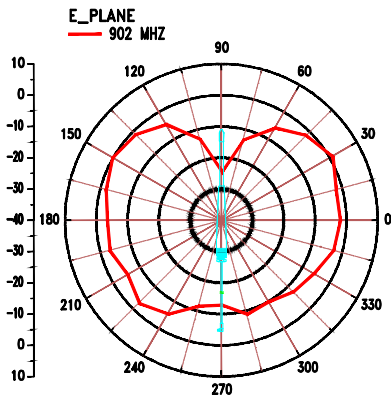
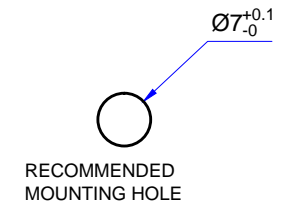

| Electrical Properties | | | |
|-----------------------|------------------------------------------------------|------------------|--------|
| Frequency Range | 902~928 MHz | | |
| Impedance | 50Ω | | |
| V.S.W.R. | ≤2.0 | | |
| Radiation | Omni | | |
| Gain | 2dBi | | |
| Polarization | Vertical | | |
| Mechanical Properties | | | |
| Body Material | PU/TPE | | |
| Connector | Brass | | |
| Weight | 22.5 g (est) | | |
| Operating Temp | -20°C ~ +65°C | | |
| TITLE | ISM Band Fixed Mount Straight Antenna - 467 model | Rev. Date | SHEET |
| | | 042524 | 1 OF 1 |
| UNIT | DWG. NO. | S467FL-5-RMM-915 | |
| mm | | | |
| SCALE | NEARSON | | |
| none | | | |