

STANDARD CE SYMBOL  
SEE NOTE 6

STANDARD WEEE SYMBOL  
MAY BE TAKEN FROM  
D-6045-0115  
SEE NOTE 6

VIEW ON A

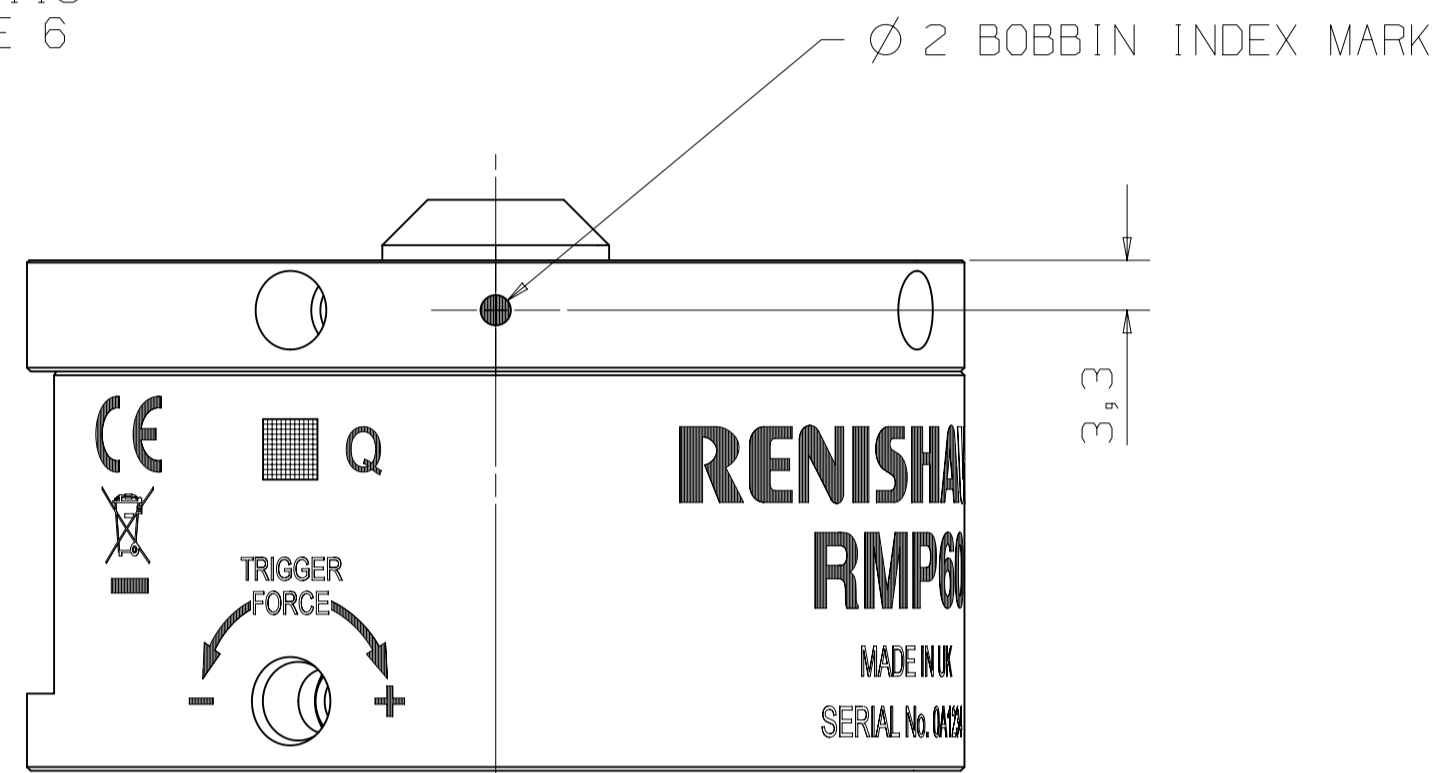

VIEW ON B

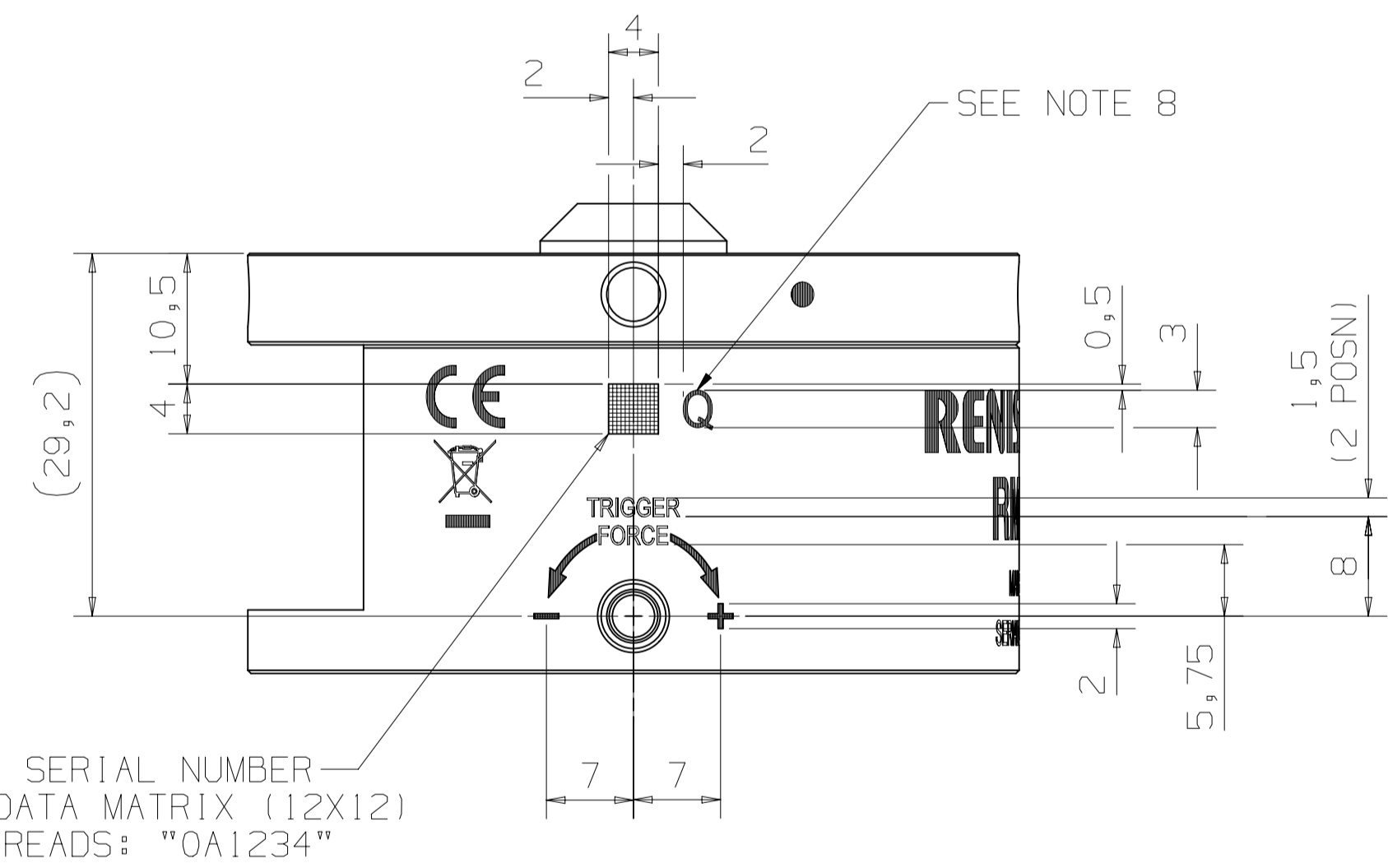
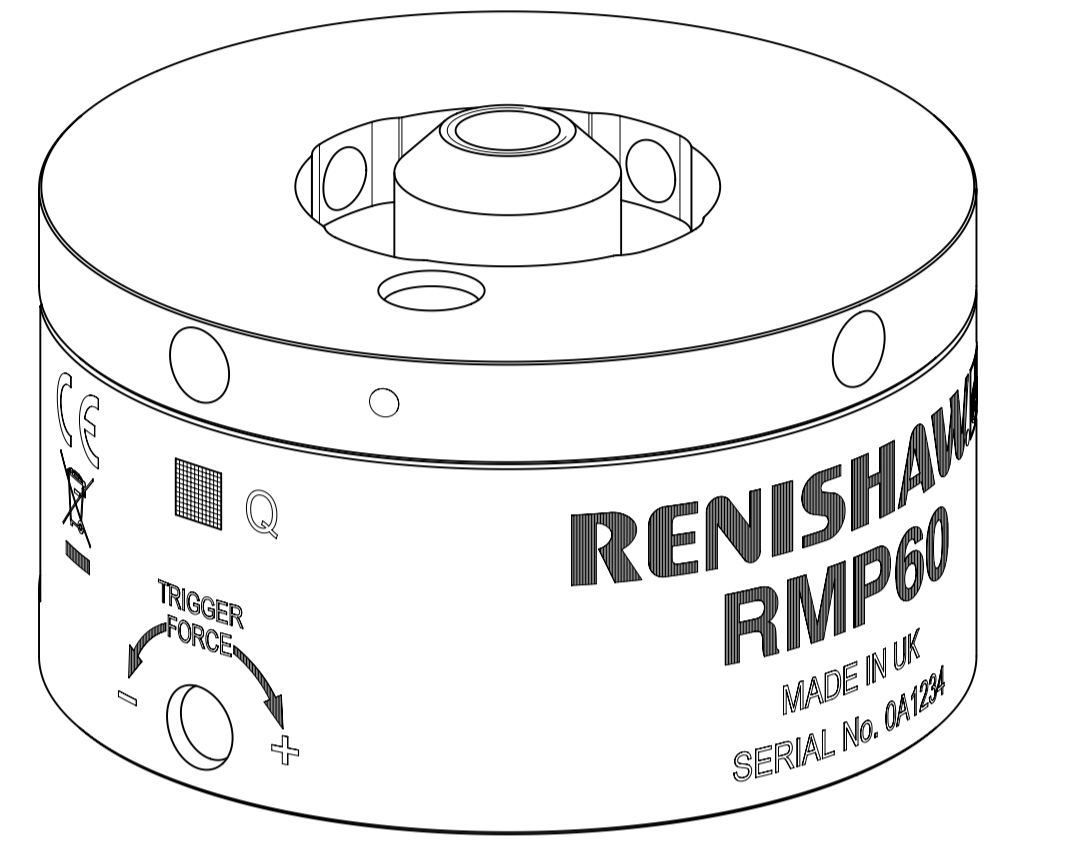
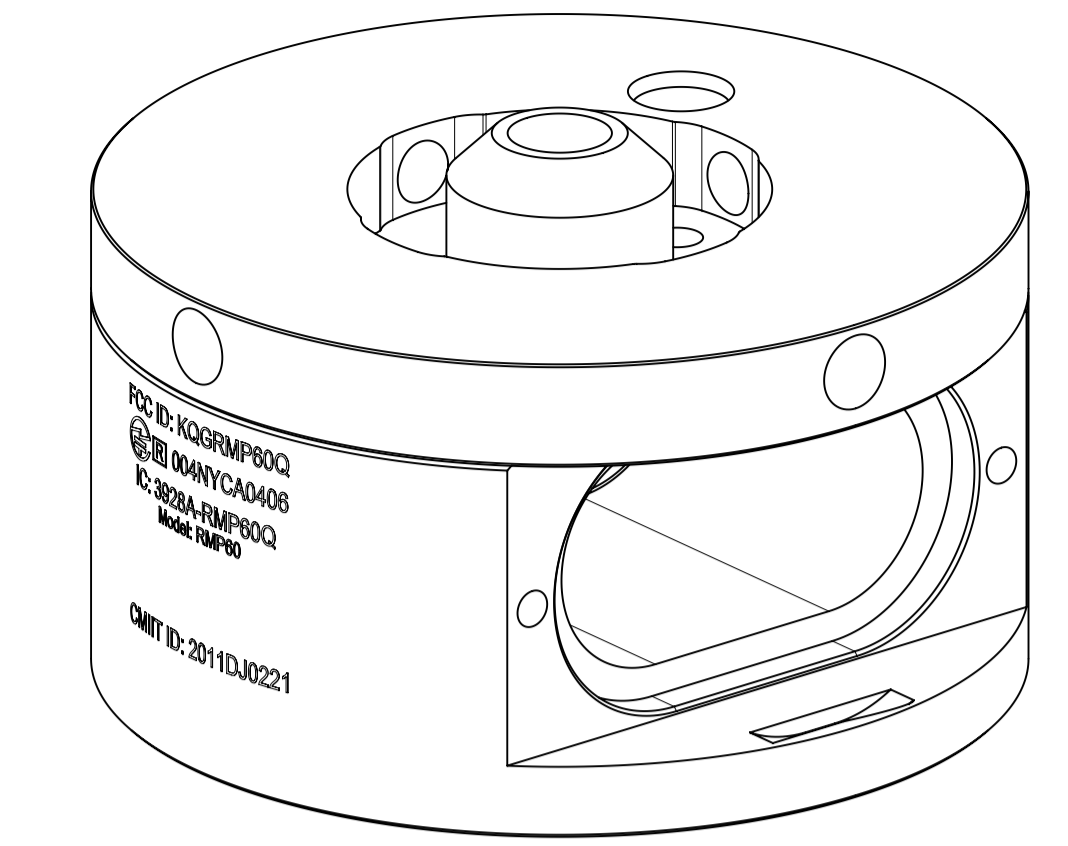
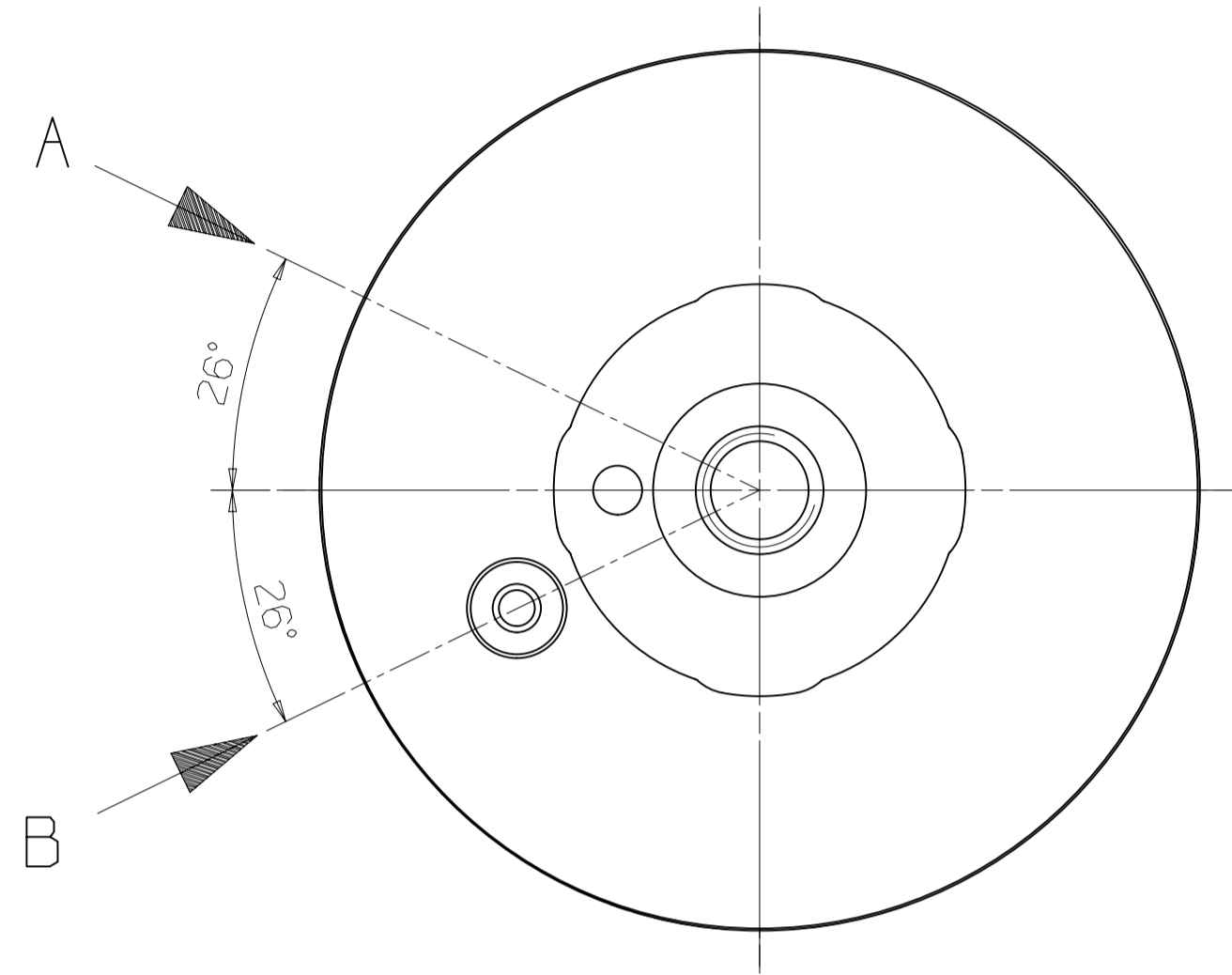

SEE NOTE 8

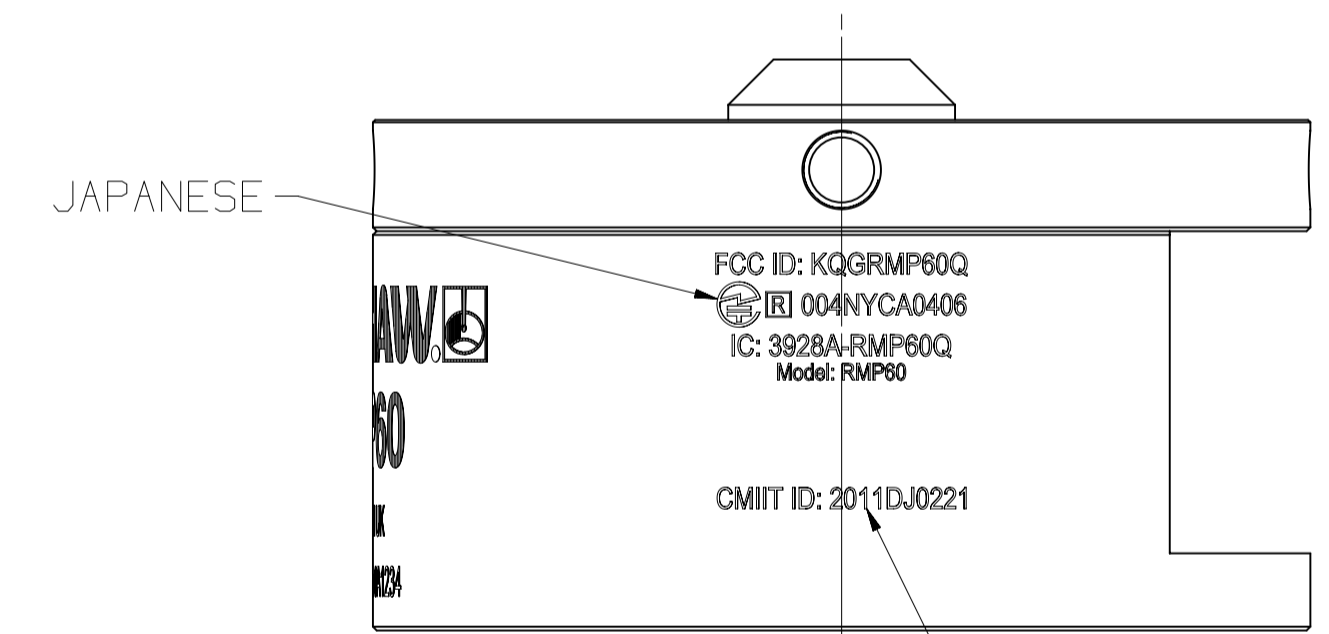
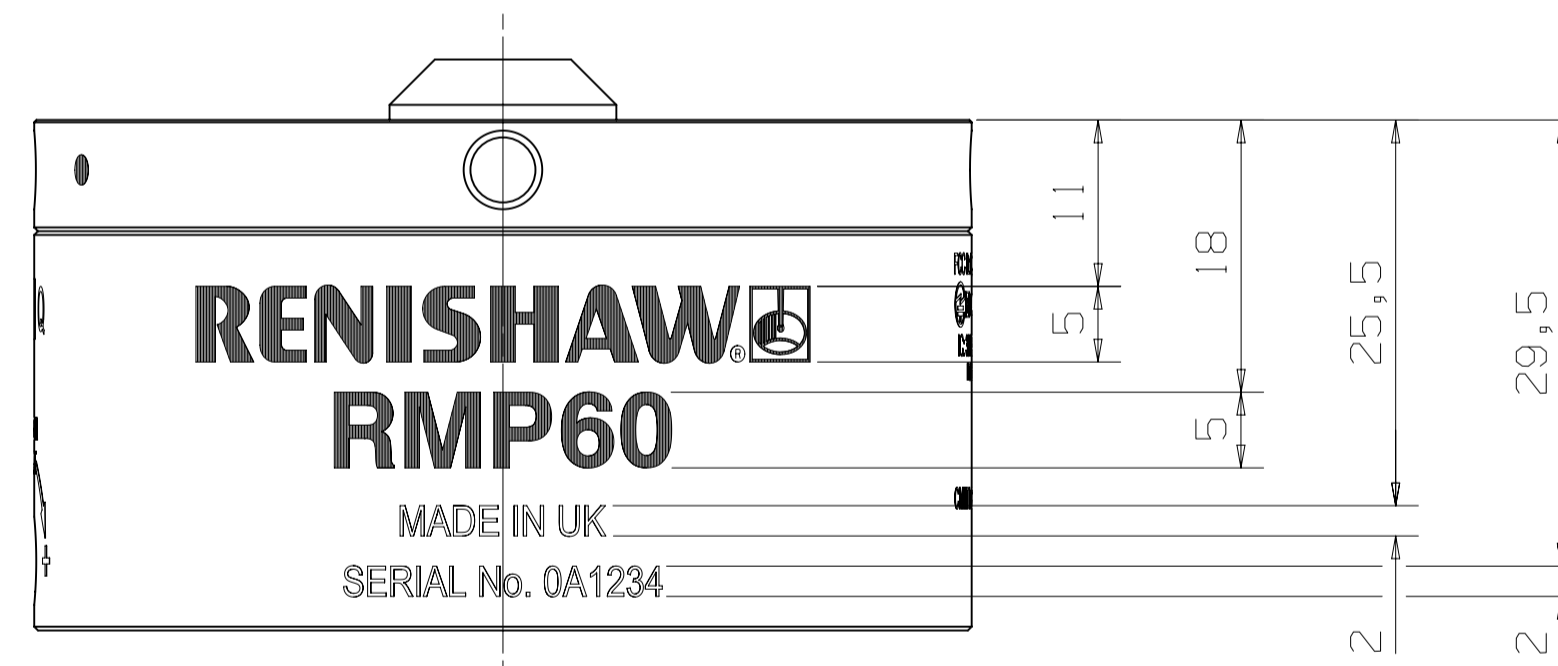

SEE SHEET 2 FOR  
DETAILS OF RADIO  
APPROVAL LASER  
MARKING

NOTES:-

1. ALL UNSPECIFIED TEXT HELVETICA, SIZE AS SHOWN.
2. ALL TEXT AND SYMBOLS TO BE FILLED AND CENTRALLY DISPOSED ABOUT PART CENTRELINE.
3. "RENISHAW" TO D-6045-0105  
"RENISHAW" AND "RMP60" AS PER LASER MARKING FILE J:/laser/hppl/4113/m021601b/10481.plt
4. ARROW SYMBOL AND TEXT AS PER LASER MARKING FILE J:/laser/hppl/4038/m014001b/10448.plt
5. BOBBIN INDEX MARK AS PER LASER MARKING FILE J:/laser/hppl/4038/m014001b/10480.plt
6. CE MARK AND WEEE SYMBOL AS PER LASER MARKING FILE \\Newbury\Mcshop\LASER\HPGL\5742\M-5742-0100-02-A\_DRG-LASER2.plt
7. SERIAL NUMBER TO BE IN FORMAT SHOWN, BASED ON PROCEDURE QA323  
(SERIAL NUMBER SHOWN IS AN EXAMPLE ONLY).
8. "Q" SYMBOL AS PER LASER MARKING FILE \\Newbury\Mcshop\LASER\HPGL\5742\M-5742-0100-02-A\_DRG-LASER3.plt
9. SEE SHEET 2 FOR DETAILS OF RADIO APPROVAL LASER MARKING.

SEE DESIGN STANDARD D5336 FOR DEFINITION OF  $\Delta$  SYMBOL.  
UNLESS OTHERWISE STATED :  
ALL DIMENSIONS IN MILLIMETRES TOL.  $\pm 0,25$  ANGLES  $\pm 2^\circ$   
REMOVE SHARP CORNERS - CHAMFER OR R0,5 MAX.  
INTERNAL RADI: 0,5 MAX. SURFACE TEXTURE  $\sqrt{163,2}$   
THREADS TO BS 3643 6g/6H.  
DRAWING PRACTICE TO BS 8888

3rd ANGLE PROJECTION

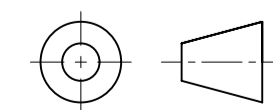

DO NOT SCALE

TITLE RMP60 (Q) BATTERY HOUSING

MATERIAL TYPE CODE

R-----

MATERIAL

MAKE FROM M-4038-0101-11

ISSUE No.

----

DRAWN BY

PNO

DRAWN DATE

MAY 12

SHEET

1 OF 2

CHECKED

MPS

CONFIDENTIAL. THIS DRAWING IS THE PROPERTY OF © RENISHAW  
plc, AND MAY NOT BE COPIED OR USED FOR ANY PURPOSE, OTHER  
THAN THAT FOR WHICH IT IS SUPPLIED, WITHOUT THE EXPRESS  
WRITTEN AUTHORITY OF RENISHAW plc.

RENISHAW®

Wotton - under - Edge  
Glos, England,  
GL12 8JR

SCALE  
U.O.S.  
2:1

DRAWING No.  
M-5742-0100-02-B

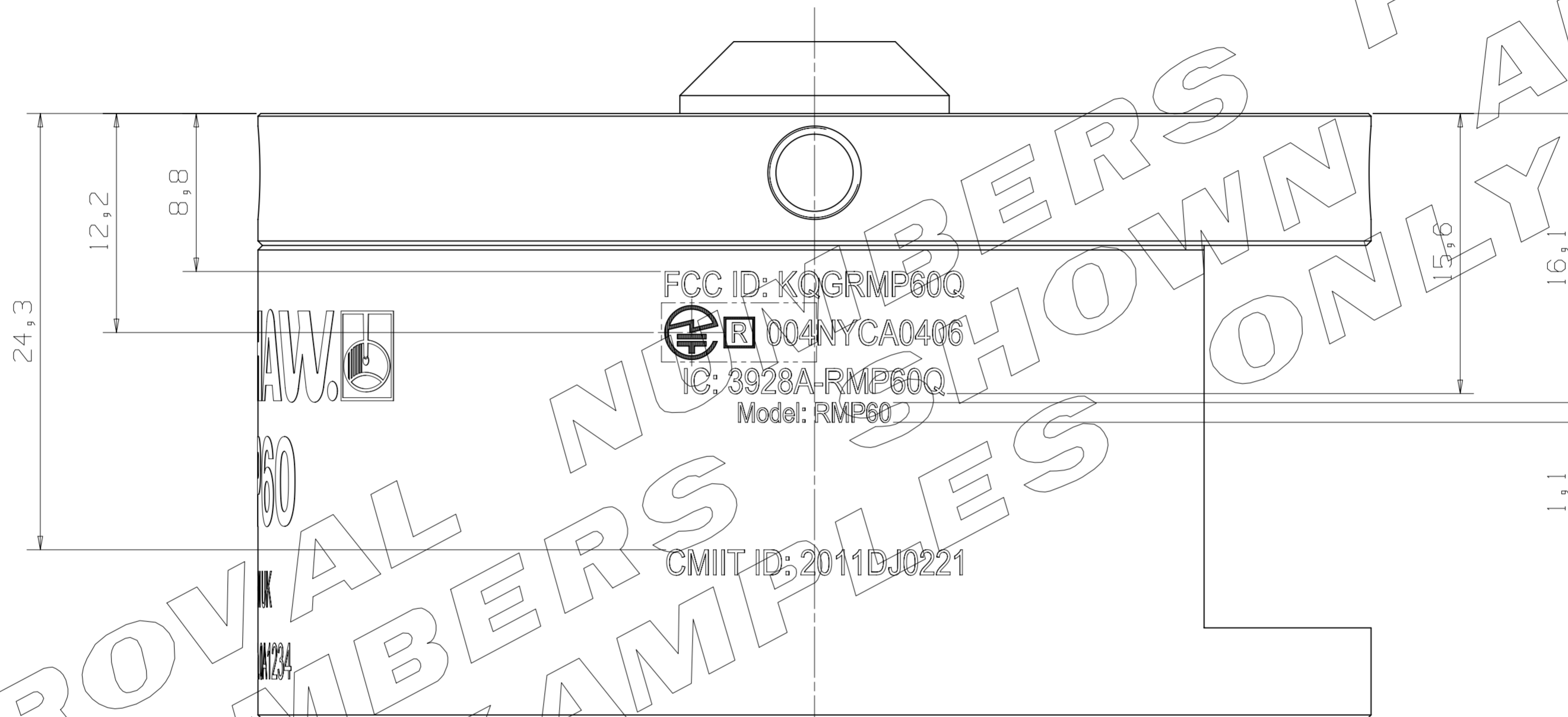
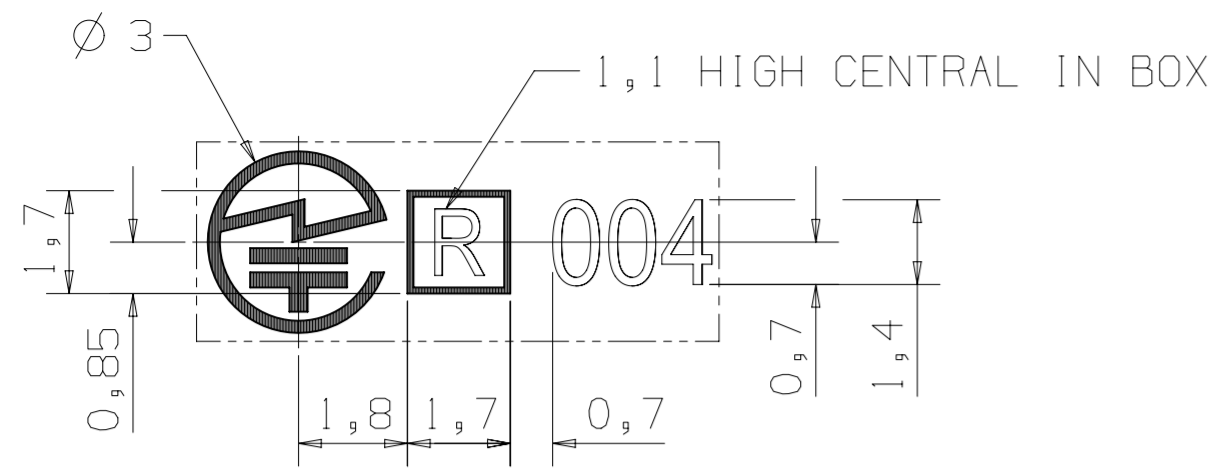

NOTES:-

- 10. ALL TEXT 1,4 HIGH HELVETICA MEDIUM U.O.S.  
TEXT TO BE HORIZONTALLY CENTRAL TO PART CENTRELIN AND VERTICALLY CENTRAL TO RELEVANT LOGO.
- 11. JAPANESE RADIO APPROVAL LOGO TO D-4113-0223 AND LASER MARKING FILE \\Newbury\Mcshop\LASER\HPGL\5742\M-5742-0100-02-A\_DRG-LASER4.plt

SEE DESIGN STANDARD D5336 FOR DEFINITION OF  SYMBOL. UNLESS OTHERWISE STATED : ALL DIMENSIONS IN MILLIMETRES TOL. ±0,25 ANGLES ±2° REMOVE SHARP CORNERS - CHAMFER OR R0,5 MAX. INTERNAL RADI 0,5 MAX. SURFACE TEXTURE -  Ro 3,2 THREADS TO BS 3643 6g/6H. DRAWING PRACTICE TO BS 8888	3rd ANGLE PROJECTION  DO NOT SCALE	TITLE RMP60 (Q) BATTERY HOUSING		ISSUE No. ----	DRAWN BY PNO	DRAWN DATE MAY 12
		MATERIAL TYPE CODE R- ----	MATERIAL SEE SHEET 1	SHEET 2 OF 2	CHECKED MPS	
CONFIDENTIAL. THIS DRAWING IS THE PROPERTY OF © RENISHAW plc, AND MAY NOT BE COPIED OR USED FOR ANY PURPOSE, OTHER THAN THAT FOR WHICH IT IS SUPPLIED, WITHOUT THE EXPRESS WRITTEN AUTHORITY OF RENISHAW plc.				SCALE U.O.S. 4:1	DRAWING No. M-5742-0100-02-B	