

RMP40



© 2007 Renishaw plc. All rights reserved.

This document may not be copied or reproduced in whole or in part, or transferred to any other media or language, by any means, without the prior written permission of Renishaw plc.

The publication of material within this document does not imply freedom from the patent rights of Renishaw plc.

Disclaimer

Considerable effort has been made to ensure that the contents of this document are free from inaccuracies and omissions. However, Renishaw makes no warranties with respect to the contents of this document and specifically disclaims any implied warranties. Renishaw reserves the right to make changes to this document and to the product described herein without obligation to notify any person of such changes.

Renishaw part no: H-5480-8500-01-A

Issued: 09.2007

Trademarks

RENISHAW® and the probe emblem used in the RENISHAW logo are registered trademarks of Renishaw plc in the UK and other countries.

apply innovation and **Trigger Logic** are trademarks of Renishaw plc.

Adobe and Acrobat are either registered trademarks or trademarks of Adobe Systems Incorporated in the United States and/or other countries.

All other brand names and product names used in this document are trade names, service marks, trademarks, or registered trademarks of their respective owners.



CAUTION: The RMP40 has a glass window, handle with care if broken to avoid injury

Batteries

Batteries : 1/2 AA (3.6 V) Lithium Thionyl Chloride × 2



Ecocel: EB 1425, EB1426
Saft: LS 14250 C, LS 14250
Sonnenschein: SL-750
Xeno: XL-050F



Dubilier: SB-AA02
Maxell: ER3S
Sanyo: CR 14250 SE
Sonnenschein: SL-350, SL-550
Tadiran: TL-4902 TL-5902,
TL-2150, TL-5101
Varta: CR 1/2 AA

Fitting the stylus

1



2

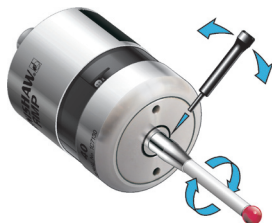

M-5000-3707

Installing the batteries

1



3



2

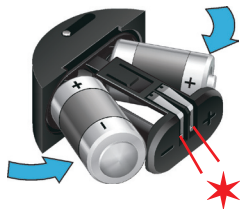

4



- * Take care not to short the battery contacts as this may be a fire hazard. Ensure the contact strips are located securely.

Reviewing the probe settings

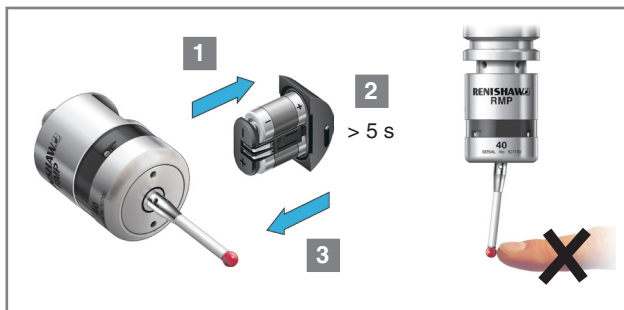

Key to the symbols

- LED short flash
- LED long flash

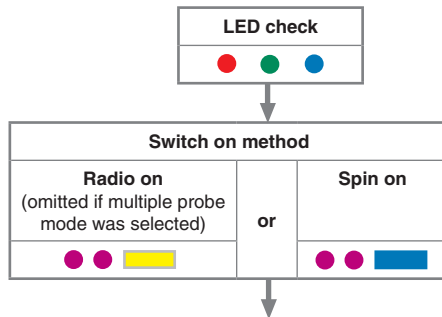

Reviewing the probe settings

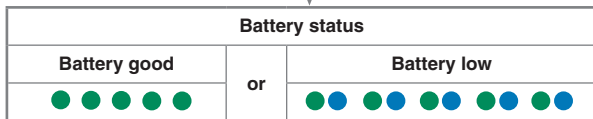
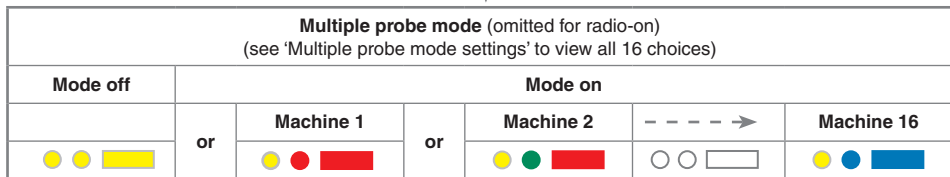
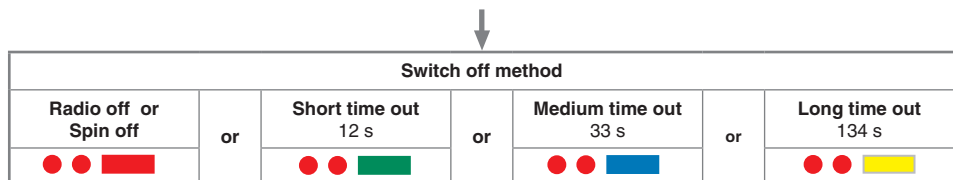

↓

Probe in standby mode
(after 5 seconds)

Multiple probe mode settings

Deflect stylus
< 4 sec
to cycle
to next
setting

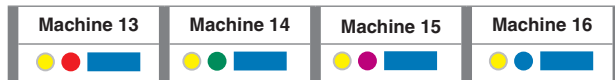
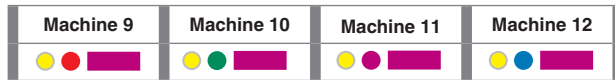
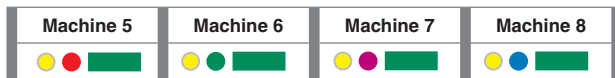
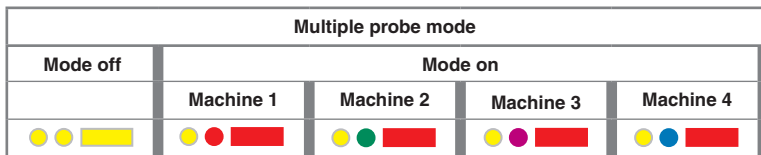

Return to **mode off**



Placing the probe in configuration mode

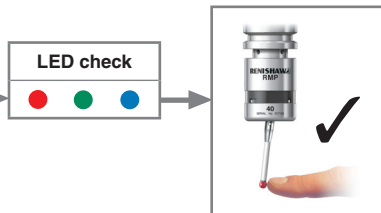
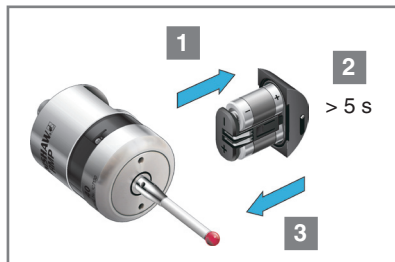

Deflect the stylus and hold deflected until the battery status has been displayed at the end of the review sequence

Key to the symbols	
	LED short flash
	LED long flash
	Deflect the stylus < 4 seconds to move to the next menu option
	Deflect the stylus > 4 seconds to move to the next menu
	To exit, leave the stylus untouched for > 20 seconds

Battery status		
Battery good	or	Battery low

To change to switch on method go to the next page

Changing the probe settings

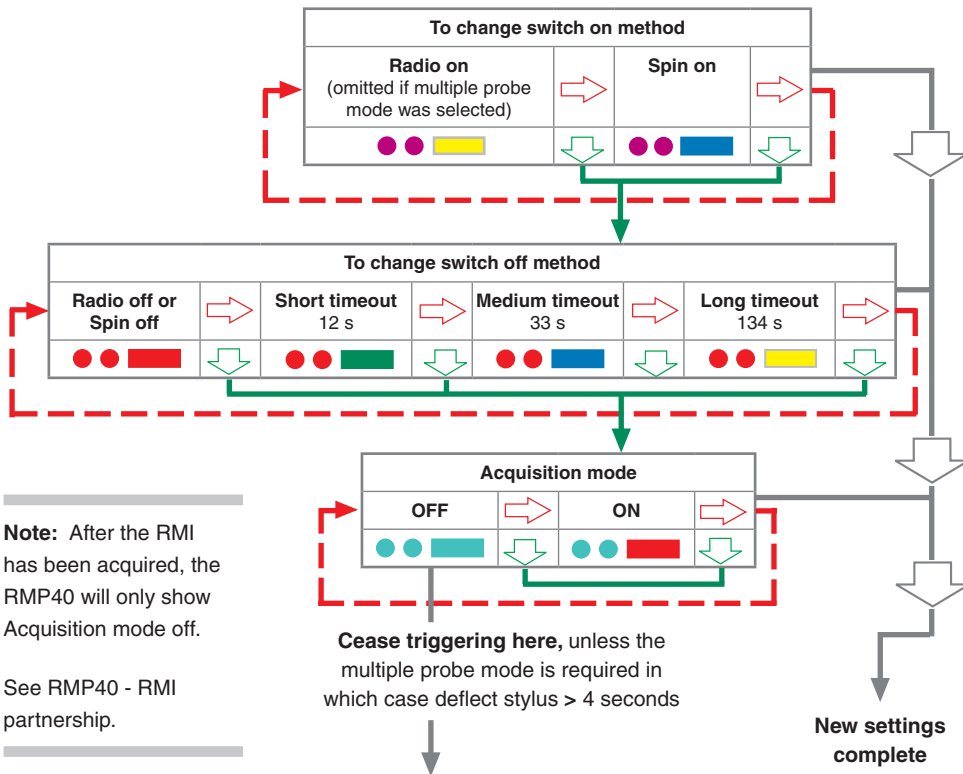

Changing the probe settings (continued)

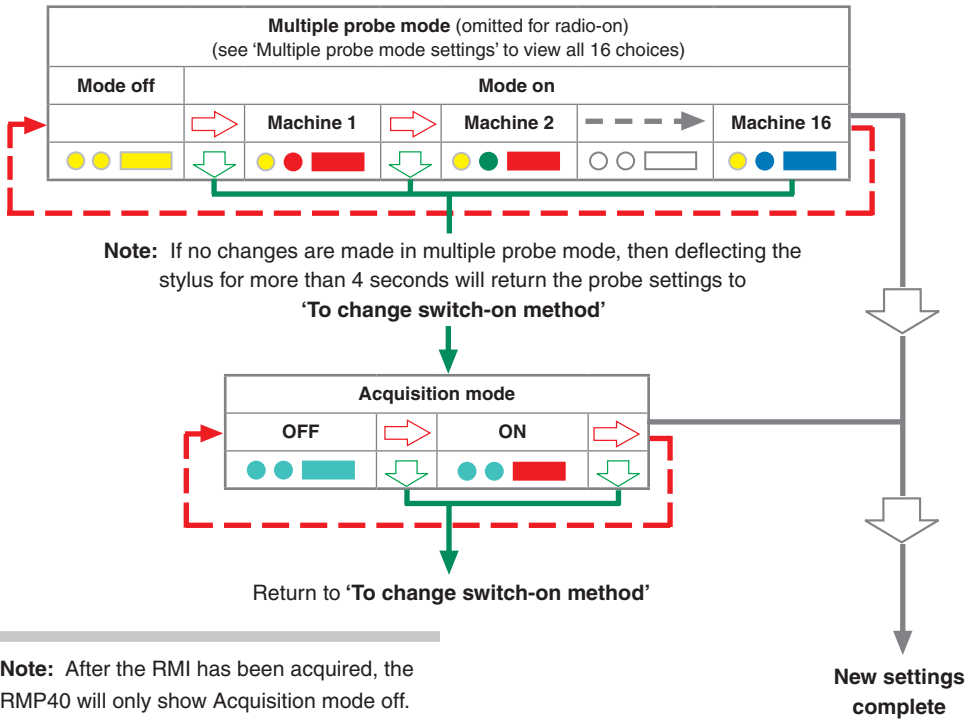

Note: After the RMI has been acquired, the RMP40 will only show Acquisition mode off.

See RMP40 - RMI partnership.

RMP40 - RMI partnership

Note: Unless the RMP40 is in 'Multiple probe' mode, it will be necessary to partner it with the RMI before use.

Note: In configuration mode, configure settings as required and then enter the 'Acquisition mode' menu. Select 'Acquisition mode off'.

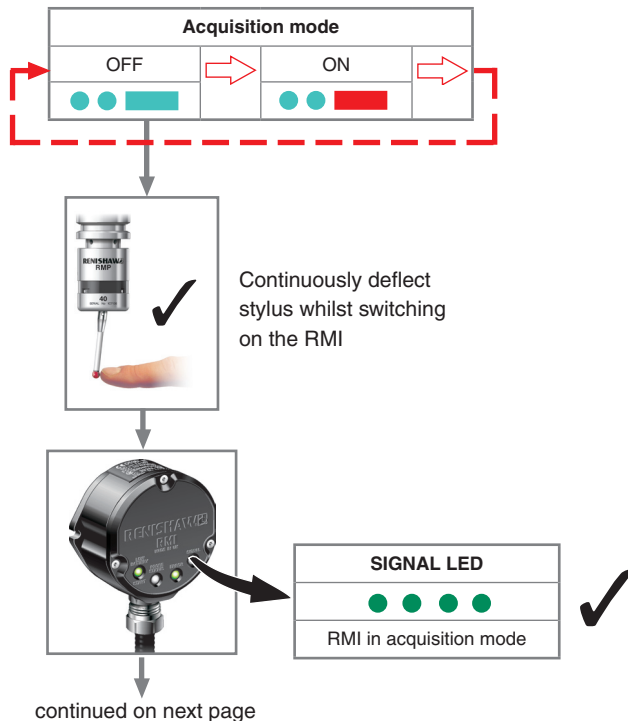

RMP40 - RMI partnership

Release and deflect the stylus to select 'Acquisition mode on'.

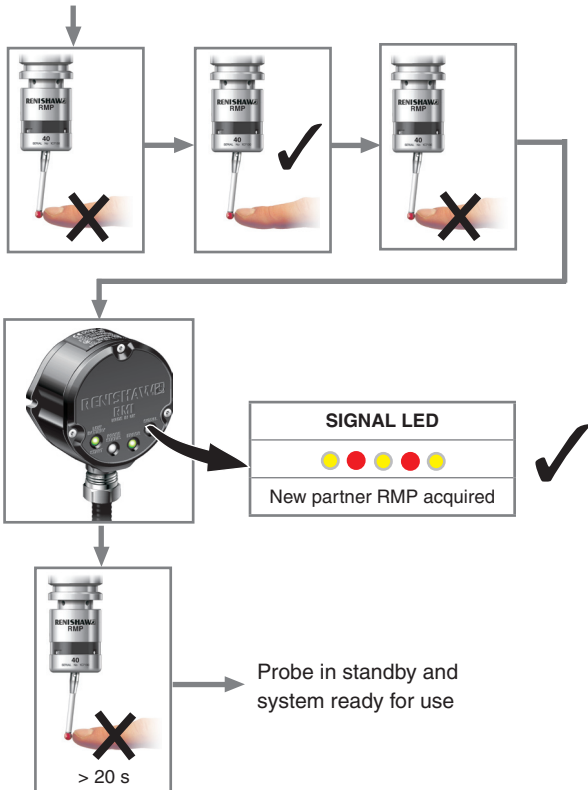

Mounting the probe on a shank

1

2.5 mm AF
x 4

2.5 mm AF
x 2

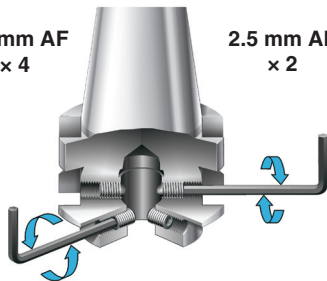

2

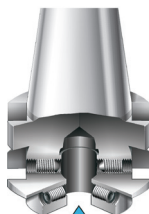

3

4 mm AF
2 Nm - 3 Nm
x 2



Stylus on-centre adjustment

1

2,5 mm AF
1 Nm x 4

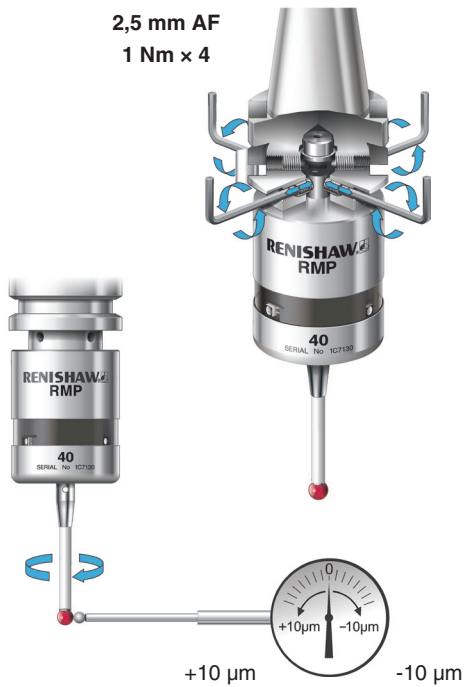

Stylus on-centre adjustment

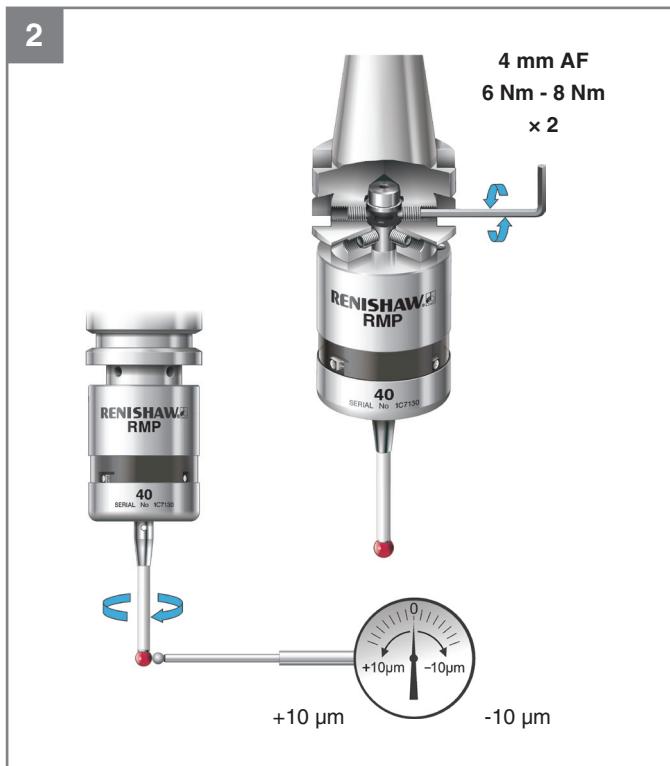

Stylus on-centre adjustment

3

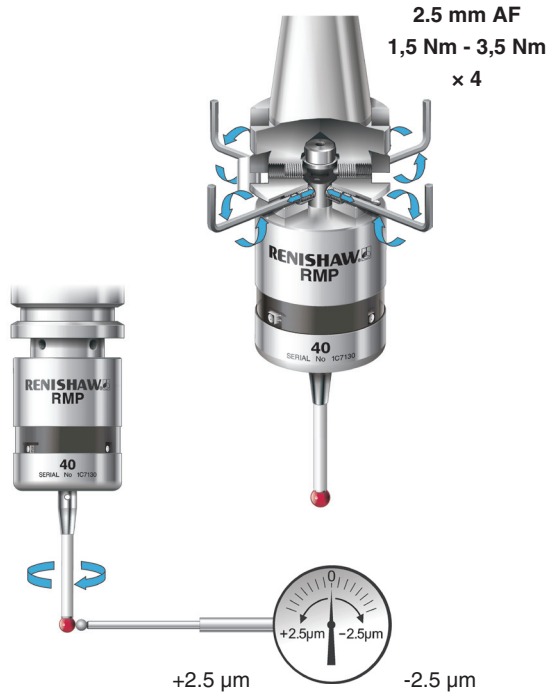



Use clean cloth

RMI visual diagnostics

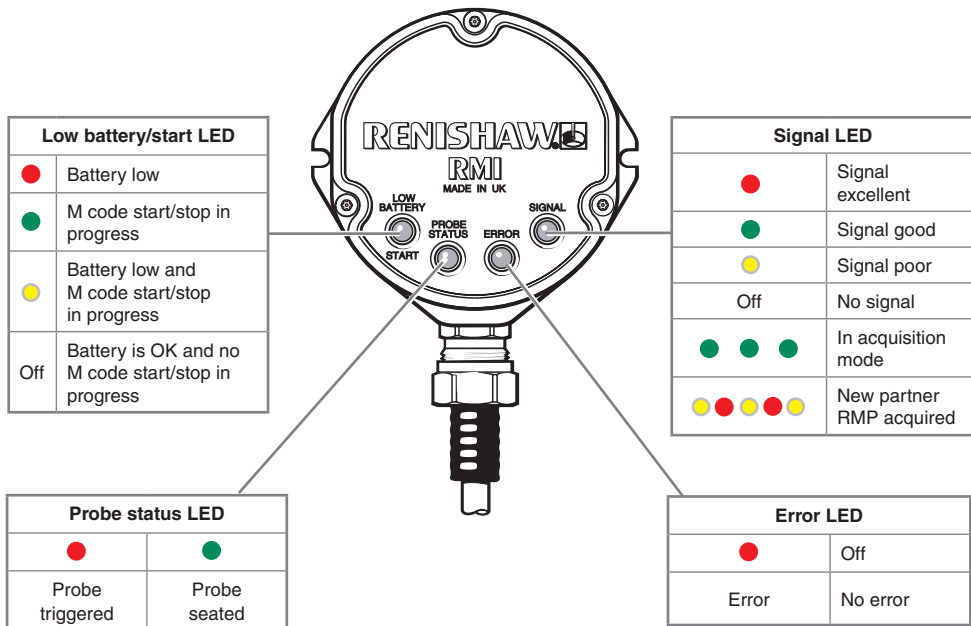



EC DECLARATION OF CONFORMITY

Renishaw plc declares that the product:-

Name: RMP40

Description: Radio machine probe

has been manufactured in conformity with the following standards:

61010-1:2001

EN 301 489-17

EN 300 328

EN 50371

and that it complies with the requirements of directives (as amended):

1999/5/EC R&TTE radio and
telecommunications
terminal equipment

The above information is summarised from the full EC declaration of conformity. A copy is available from Renishaw on request.

FCC DECLARATION (USA)

FCC Section 15.19

This device complies with Part 15 of the FCC rules. Operation is subject to the following conditions:

1. This device may not cause harmful interference, and
2. This device may accept any interference received, including interference that may cause undesired operation.

FCC Section 15.21

The user is cautioned that any changes or modifications not expressly approved by Renishaw plc, or authorised representative could void the user's authority to operate the equipment.

PATENT NOTICE

Features of the RMP40 probe and features of similar probes are the subject of one or more of the following patents and/or patent applications:

CN CN1732488A	EP 1734426	TW 200720626
EP 0390342	EP 1804020	US 2004-0178771
EP 0652413	JP 2,945,709	US 2006/0215614A1
EP 065926	JP 2,994,401	US 5,040,931
EP 1185838	JP 2004-279,417	US 5,150,529
EP 1373995	JP 2004-522,961	US 5,212,872
EP 1425550 B	JP 2005-502,035	US 5,279,042
EP 1457786	JP 2006-313567	US 5,669,151
EP 1477767	JP 2006-511860	US 6,776,344 B2
EP 1477768	JP 3,126,767	US 6,941,671 B2
EP 1576560	JP 3967592	
EP 1701234	WO 2007/028964	

Renishaw plc

New Mills, Wotton-under-Edge,
Gloucestershire, GL12 8JR
United Kingdom

T +44 (0)1453 524524

F +44 (0)1453 524901

E uk@renishaw.com

www.renishaw.com

RENISHAW 
apply innovation™

**For worldwide contact details,
please visit our main website at
www.renishaw.com/contact**



H - 5480 - 8500 - 01