

A			INITIAL ISSUE
ISSUE	NOTE No. DATE	UPDATE INITIALS	DESCRIPTION
MATERIAL:			
WEIGHT:		VOLUME:	
FINISH:			
DRAWN BS		CHECK N/A	
		YES/NO	SIGNED
DOCUMENT No.			
59304402.250			
SHEET: 1 OF 1			
CAD FILE: N/A			
FIRST USED ON: 20TN			

**Lucas**

Lucas Automotive Electronics  
Stratford Road Solihull B90 4GW

LUCAS LTD OWNS THE COPYRIGHT IN THIS DOCUMENT AND ASSOCIATED DOCUMENTS AND ALL RIGHTS ARE RESERVED. THIS DOCUMENT AND ASSOCIATED DOCUMENTS MUST NOT BE USED FOR ANY PURPOSE OTHER THAN THAT FOR WHICH THEY ARE SUPPLIED AND MUST NOT BE COPIED IN WHOLE OR IN PART, OR DISCLOSED TO OTHERS WITHOUT THE PRIOR WRITTEN CONSENT OF LUCAS LTD. ANY COPY OF THIS DOCUMENT MADE BY ANY METHOD MUST ALSO CONTAIN A COPY OF THIS LEGEND.  
LUCAS LTD 8<sup>TH</sup> NOVEMBER 1999

ALL STANDARDS SPECIFIED ARE TO LATEST ISSUE.

TOLERANCES (UNLESS OTHERWISE STATED) ;

ANGLES

± 30°

WHOLE FIGURE DIMENSIONS

± 0.40

ONE PLACE DECIMAL DIMENSIONS

± 0.20

TWO PLACE DECIMAL DIMENSIONS

± 0.10

IN ACCORDANCE WITH BS308 AND LUCAS SPEC51-3-5, FORM AND POSITIONAL TOLERANCES AND ASSOCIATED DATUM FEATURE APPLY REGARDLESS OF FEATURE SIZE UNLESS MODIFIED BY M.

DRG GENERALLY CONFORMS TO BS 308

SCALE: NTS OR AS STATED

DIMENSIONS IN mm DO NOT SCALE

THIRD  
ANGLE  
PROJ:

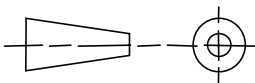

20TN-1 TYPE  
APPROVAL

A3  
297 X 420mm