



## Product Manual

PTY00-16416  
Ricochet Toy



Please read this entire guide before beginning

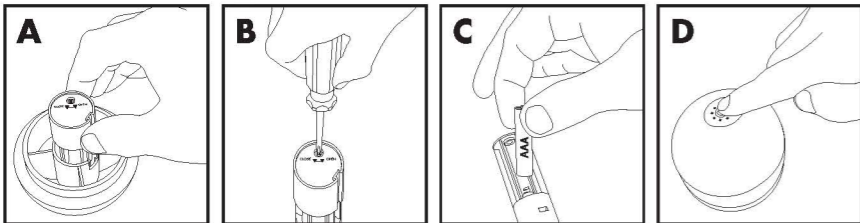

Hereinafter Radio Systems Corporation, Radio Systems PetSafe Europe Ltd., Radio Systems Australia Pty Ltd. and any other affiliate or Brand of Radio Systems Corporation may be referred to collectively as "We" or "Us".

### IMPORTANT SAFETY INFORMATION

#### Explanation of Attention Warnings and Symbols used in this guide



This is the safety alert symbol. It is used to alert you to potential personal injury hazards. Obey all safety messages that follow this symbol to avoid possible injury or death.



**CAUTION**, used with the safety alert symbol, indicates a hazardous situation which, if not avoided, could result in minor or moderate injury.



**CAUTION**, used without the safety alert symbol, indicates a hazardous situation which, if not avoided, could result in harm to your pet.



**NOTICE**, is used to address safe use practices not related to personal injury.



**Keep away from children.**

- Not intended as a Toy for children.
- Do not allow small children to use this product to play with your pet without adult supervision.
- Do not use this product until you have read the entire Product Manual.
- Do not use this product on an elevated surface such as a table or counter. Use on the floor only.
- This product should only be used in accordance with the instructions in the user guide.



- Adult supervision is required around pets.



- Inspect this product periodically for damage and discard product immediately if it appears worn or broken.
- Do not mix old and new batteries.
- Do not mix standard, alkaline or rechargeable batteries.
- Do not use rechargeable batteries.
- Exhausted batteries should be removed immediately. Do not dispose of batteries with household waste.

**These instructions must be retained and passed on with ownership.**

### Toy Assembly

No assembly is required. To use, simply install batteries and follow the Operating Instructions. Do not place the toy on any surface other than a flat, level floor.

### Battery Installation

1. Unscrew the two different colored halves of Toy A by hand and gently pull to remove the battery and sound cylinder (A).
2. Using a Phillips head screwdriver, unscrew the retaining cap on the end of the battery and sound cylinder (B).
3. Once the retaining cap is removed, insert three AAA batteries (not included) into the slots in the side of the cylinder (C).
4. Replace the retaining cap and secure with the Phillips head screw.
5. Slide the battery and sound cylinder back into the speaker end of the toy, taking care to match the speaker end of the cylinder with the speaker holes of the housing. There is a slot along the side of the battery and speaker cylinder that fits into a groove inside the speaker end of the toy to help with correct insertion.

6. Screw the housing back together by hand firmly, until you have matched the notches up on the side of the toy.
7. Repeat steps 1-6 for Toy B.

### Operating Instructions

The Ricochet Interactive Dog Toy is a set of two interactive dog toys that pair together via Bluetooth. Once both toys are turned on, they pair together automatically to create a digital squeak sound that "jumps" from one toy to the other, stimulating your dog's hunter instinct. As your pet plays with Toy A, it will trigger Toy B to begin to squeak. When your pet goes to play with Toy B, Toy A will resume squeaking. This game continues as long as your pet plays with the toys. The pair of toys automatically turn off after 60 minutes of non-activity.

1. Locate the colored end with speaker holes for each toy. Press and hold down on the soft portion of the speaker covering to turn on each toy (D). You should hear a chime for each toy, followed by a confirmation beep that the toys have paired. Then, Toy A will begin to squeak.
2. Place Toy A in one location, and Toy B in another location either across the room or in an adjacent room, maximum range of 30 feet. Let the playtime begin!

### To Ensure Proper Function

- Do not mix old and new batteries.
- Do not mix standard, alkaline or rechargeable batteries.
- Do not use rechargeable batteries.
- Exhausted batteries should be removed immediately. Do not dispose of batteries with household waste.

### Advice for use

Apart from playing with this product, it is recommended that pet parents interact with their pets and provide a variety of play activities, opportunities for stimulation and appropriate amount of daily exercise as determined by their veterinarian.



### Important Recycling Advice

Please respect the Waste Electrical and Electronic Equipment regulations in your country. This equipment must be recycled. If you no longer require this equipment, do not place it in the normal municipal waste system. Please return it to where it was purchased in order that it can be placed in our recycling system. If this is not possible, please contact the Customer Care Center for further information. For a listing of Customer Care Center telephone numbers, visit our website at petsafe.com.

### Compliance

#### FCC

This device complies with part 15 of the FCC Rules. Operation is subject to the following two conditions: (1) This device may not cause harmful interference, and (2) this device must accept any interference received, including interference that may cause undesired operation.

**CAUTION:** Modification or changes to this equipment not expressly approved by Radio Systems® Corporation may void the user's authority to operate the equipment.

**NOTE:** This equipment has been tested and found to comply with the limits for a Class B digital device, pursuant to part 15 of the FCC Rules. These limits are designed to provide reasonable protection against harmful interference in a residential installation. This equipment generates, uses, and can radiate radio frequency energy and, if not installed and used in accordance with the instructions, may cause harmful interference to radio communications. However, there is no guarantee that interference will not occur in a specific installation. If interference does occur to radio or television reception, which can be determined by turning the equipment off and on, the user is encouraged to try to correct the interference by one or more of the following measures:

- Reorient or relocate the receiving antenna.
- Increase the separation between the equipment and the receiver.
- Connect the equipment to an outlet on a circuit different from that to which the receiver is connected.
- Consult customer care, the dealer, or an experienced radio/TV technician for help.

#### ACMA

This device complies with the applicable EMC requirements specified by the ACMA (Australian Communications and Media Authority).

### Terms of Use and Limitation of Liability

#### 1. Terms of Use

Use of this Product is subject to your acceptance without modification of the terms, conditions and notices contained herein. Use of this Product implies acceptance of all such terms, conditions and notices. If you do not wish to accept these terms, conditions, and notices, please return the Product, unused, in its original packaging and at your own cost and risk to the relevant Customer Care Center together with proof of purchase for a full refund.

#### 2. Proper Use

If you are unsure whether this Product is appropriate for your pet, please consult your veterinarian or certified trainer prior to use. Proper use includes, without limitation, reviewing the entire Product Manual and any specific Caution statements.

#### 3. No Unlawful or Prohibited Use

This Product is designed for use with pets only. Using this Product in a way that is not intended could result in violation of Federal, State or local laws.

#### 4. Limitation of Liability

In no event shall Radio Systems Corporation or any of its associated companies be liable for (i) any indirect, punitive, incidental, special or consequential damage and/or (ii) any loss or damages whatsoever arising out of or connected with the misuse of this Product. The Purchaser assumes all risks and liability from the use of this Product to the fullest extent permissible by law.

#### 5. Modification of Terms and Conditions

Radio Systems Corporation reserves the right to change the terms, conditions and notices governing this Product from time to time. If such changes have been notified to you prior to your use of this Product, they shall be binding on you as if incorporated herein.

### Warranty

#### One Year Non-Transferable Limited Warranty

This Product has the benefit of a limited manufacturer's warranty. Complete details of the warranty applicable to this Product and its terms can be found at [petsafe.com](http://petsafe.com) and/ or are available by contacting your local Customer Care Center.

Radio Systems Corporation, 10427 PetSafe Way, Knoxville, TN 37932 USA

**Australia/New Zealand** – In compliance with the Australian Consumer Law, Warranties Against Defects, effective January 1, 2012, warranty details of this Product are as follows: Radio Systems Australia Pty Ltd. (hereinafter referred to as "Radio Systems") warrants to the original retail purchaser, and not any other purchaser or subsequent owner, that its Product, when subject to normal and proper residential use, will be free from defects in material or workmanship for a period of two (2) years from the purchase date. An "original retail consumer purchaser" is a person or entity who originally purchases the Product, or a gift recipient of a new Product that is unopened and in its original packaging. When serviced by Radio Systems Customer Service, Radio Systems covers labour and parts for the first two years of ownership; after the first two years, a service or upgrade charge will apply relative to replacement of the Product with new or refurbished items at Radio Systems' sole discretion.

The limited warranty is non-transferable and shall automatically terminate if the original retail consumer purchaser resells the Radio Systems Product or transfers the property on which the Radio Systems Product is installed. This Limited Warranty excludes accidental damage due to dog chews; lightning damage; or neglect, alteration, and misuse. Consumers who purchase products outside of Australia, New Zealand, or from an unauthorised dealer will need to return the Product to the original place of purchase for any warranty issues.

Please note that Radio Systems does not provide refunds, replacements, or upgrades for change of mind, or for any other reason outside of these Warranty terms.

Claims Procedure: Any claim made under this Warranty should be made directly to Radio Systems Australia Pty Ltd. Customer Care Centre at:

Radio Systems Australia Pty Ltd.  
 PO Box 7266, Gold Coast Mail Centre QLD 9726, Australia  
 Australia Residents: 1800 786 608  
 New Zealand Residents: 0800 543 054  
 Email: [aus-info@petsafe.net](mailto:aus-info@petsafe.net)

To file a claim, a proof of purchase must be provided. Without a proof of purchase, Radio Systems will not repair or replace faulty components. Radio Systems requests the Consumer to contact the Radio Systems Customer Care Centre to obtain a Warranty Return number, prior to sending the Product. Failure to do so may delay in the repair or replacement of the Product.

If the Product is deemed to be faulty within 30 days from date of original purchase, Radio Systems will organise for a replacement to be sent in advance of returning the faulty Product. A Post Bag will be included with the replacement Product for the return of the faulty Product. The Product must be returned within 7 days of receiving the replacement. If the Product is deemed to be faulty after 30 days from the date of original purchase, the consumer will be required to return the Product to Radio Systems at the consumer's own expense. Radio Systems will test and replace the faulty unit or its components and return to the consumer free of charge, provided the Product is within its said warranty period. This warranty is in addition to other rights and remedies available to you under the law. Radio Systems goods come with guarantees that cannot be excluded under the Australia Consumer Law. You are entitled to a replacement or refund for a major failure and for compensation for any other reasonably foreseeable loss or damage. You are also entitled to have the goods repaired or replaced if the goods fail to be of acceptable quality and the failure does not amount to a major failure.

Should you have any queries or require any further information, please contact our Customer Care Centre on 1800 786 608 (Australia) or 0800 543 054 (New Zealand).

This device complies with Industry Canada's licence-exempt RSSs. Operation is subject to the following two conditions:

- (1) This device may not cause interference; and
- (2) This device must accept any interference, including interference that may cause undesired operation of the device.

Cet appareil est conforme aux CNR exemptes de licence d'Industrie Canada. Son fonctionnement est soumis aux deux conditions suivantes :

- ( 1 ) Ce dispositif ne peut causer d'interférences ; et
- ( 2 ) Ce dispositif doit accepter toute interférence , y compris les interférences qui peuvent causer un mauvais fonctionnement de l'appareil.

Le dispositif a été conçu pour répondre à la demande générale de radioexposition.

#### Declaration of Conformity

Radio Systems Corporation hereby declares that this Ricochet Toy is in compliance with the essential requirements and other relevant provisions of Directive 2014/53/EU. In accordance with Article 10(2) and Article 10(10), This product is allowed to be used in all EU member states. Frequency band(s): 2.405GHz Maximum radio- frequency power: -3dbm

Radio Systems Corporation  
 10427 PetSafe Way  
 Knoxville, TN 37932  
 +1 (865) 777-5404

[petsafe.com](http://petsafe.com)

AW400-xxxx

©2018 Radio Systems Corporation