



protect. teach. love.™

Train 'n Praise™

Potty Training System

operating and training guide

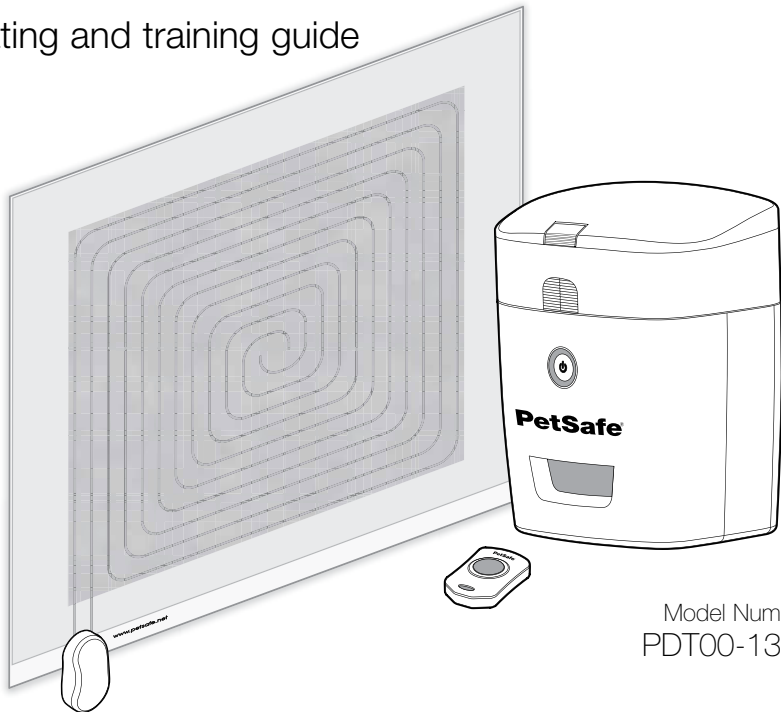

Model Number
PDT00-13649

PLEASE READ THIS ENTIRE GUIDE BEFORE BEGINNING

Important Safety Information

Explanation of Attention Words and Symbols used in this guide



This is the safety alert symbol. It is used to alert you to potential personal injury hazards. Obey all safety messages that follow this symbol to avoid possible injury or death.

WARNING WARNING indicates a hazardous situation which, if not avoided, could result in death or serious injury.

CAUTION CAUTION, used with the safety alert symbol, indicates a hazardous situation which, if not avoided, could result in minor or moderate injury.

CAUTION CAUTION, used without the safety alert symbol, indicates a hazardous situation which, if not avoided, could result in harm to your pet.

WARNING **Risk of explosion.** Do not short circuit, mix old and new batteries, dispose of in fire, or expose to water. When batteries are stored or disposed, they must be protected from shorting. Dispose of used batteries properly.

WARNING **Not for use with aggressive dogs.** Do not use this Product if your dog is aggressive, or if your dog is prone to aggressive behavior. Aggressive dogs can cause severe injury and even death to their owner and others. If you are unsure whether this product is appropriate for your dog, please consult your veterinarian or certified trainer.

CAUTION **Save these instructions for future reference. Read all instructions before operating product.**

- : For indoor use only.
- : For dry treats/kibble use only.
- : Do NOT use the Treat Dispenser with puppies or dogs with any physical disability.
- : Intended for use with pets only.
- : Do NOT allow small children to play with, in or around the Treat Dispenser or Pee Pads.
- : Before leaving for an extended time, always replace used batteries with new batteries to insure continual operation.
- : Do NOT place any foreign object in the Treat Dispenser.
- : Treat Dispenser should always be leveled.
- : Do NOT disassemble the Treat Dispenser except for the Hopper.
- : Dispose of all packaging material properly. Some items may be packed in poly bags; these bags could cause suffocation; keep away from children and pets.
- : Check operation frequently to be sure the Treat Dispenser is dispensing properly.
- : The Treat Dispenser, Handheld Remote, and Pee Pad Transmitter should NOT be submerged in water at any time, this may damage electronic components.

CAUTION Pee Pads can be a choke hazard if your dog chews or swallows the material. Do NOT allow your pet unsupervised access to the pad until he is trained in the proper use of the pad.

Thank you for choosing the PetSafe® brand. You and your pet deserve a companionship that includes memorable moments and a shared understanding together. Our products and training tools promote a lifestyle of protection, teaching, and love—essentials that influence memories for a lifetime. If you have any questions about our products or training your pet, please visit our website at www.petsafe.net or contact our Customer Care Center at 1-800-732-2677.

To get the most protection out of your warranty, please register your product within 30 days at www.petsafe.net. By registering and keeping your receipt, you will enjoy the product's full warranty and should you ever need to call the Customer Care Center, we will be able to help you faster. Most importantly, we will never give or sell your valuable information to anyone. Complete warranty information is available online at www.petsafe.net.

Table of Contents

Components.....	4
Other Items You May Need	4
How the System Works	4
Features.....	5
Key Definitions	5
Operating Guide	7
Prepare the Handheld Remote	7
Prepare the Treat Dispenser	7
Prepare the Pee Pad and Pee Pad Clip	9
To Pair the Handheld Remote, Pee Pad Clip and Treat Dispenser.....	11
Training Guide	12
General Tips	12
Nutritionally Balanced Diet for Your Dog	12
Training Sessions.....	12
Introducing Moisture Detection Pads.....	12
Training with Handheld Remote	13
Training With Pee Pad Clip	13
Teaching Your Pet the Audible Tone	14
Additional Training.....	14
Teaching Basic Obedience.....	15
Eliminating Unwanted Behavior.....	15
Optional Treat Dispenser Wall Mounting	16
Frequently Asked Questions	17
Troubleshooting	17
Care and Cleaning.....	18
Customer Care International	18
Terms of Use and Limitation of Liability	18
Battery Disposal	18
Perchlorate Battery.....	19
FCC	19
Warranty	19
Treat Dispenser Mounting Template.....	23

Components

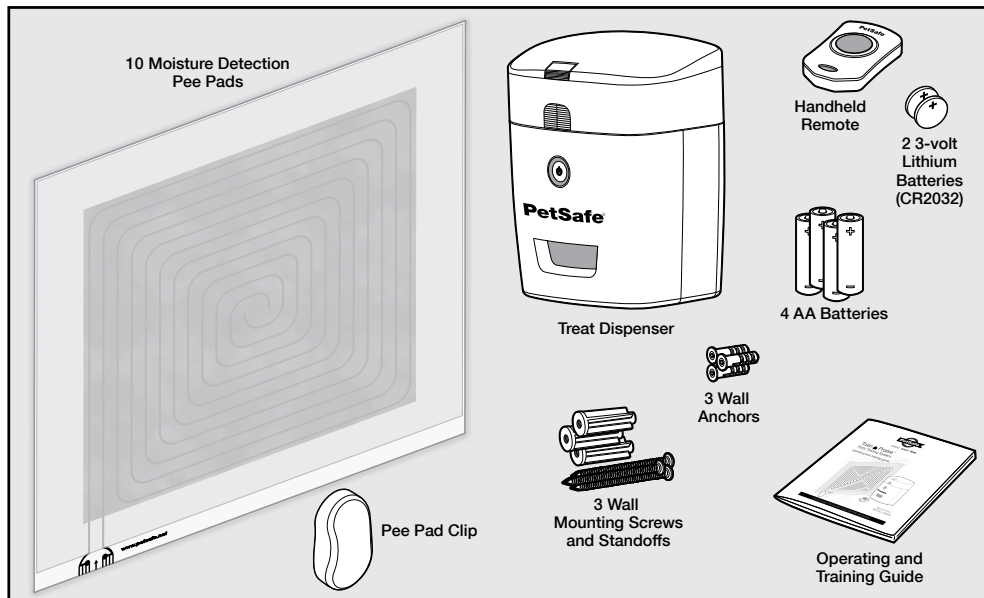

Other Items You May Need

- : Dry treats or kibble 1/2" or smaller
- : Small flat head screwdriver or equivalent
- : Collar and leash (optional) for training
- : Phillips screwdriver

How the System Works

The PetSafe® Train 'n Praise™ Potty Training System is an innovative aid to housebreaking. It is a reward system that uses an automated Treat Dispenser with Moisture Detection Pee Pads. A Handheld Remote for the Dispenser is also included for easy potty training in any room. When your dog has properly used the pee pad, the behavior is reinforced by providing the treat from the Treat Dispenser! Your dog will associate the usage of the pee pads with the treat and will repeat using the pads when you're not there.

For successful use of the PetSafe® Train 'n Praise™ Potty Training System we recommend at least 2-4 weeks of training with your new puppy or dog. We have included some guidelines with this operating and training guide.

Features

- : Treat Dispenser can be used with or without an audible tone for additional training and holds dry treats/kibble up to 1/2" in size
- : Treat Dispenser has a 20 minute time-out after a treat is dispensed
- : Treat Dispenser can be wall mounted or free standing and includes a low battery indicator
- : Handheld Remote or the Pee Pad Clip activates the Treat Dispenser up to 25 feet away
- : Moisture Detection Pee Pads include 6 layers for extra protection and include an attractant to encourage your pet to use them
- : Pee Pad Clip is water-resistant and easily attaches and reattaches to new pads

Key Definitions

Handheld Remote: Transmits signal to the Treat Dispenser to release dry treats/kibble. Used during training sessions.

Dispense Button: Activates the Treat Dispenser with or without an audible tone.

Battery Slot: Opens the Handheld Remote to add/replace the battery.

Clip Opening: Attaches to a key chain, wrist strap, lanyard, etc. (*not included*).

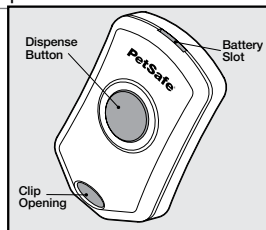

Treat Dispenser: Delivers dry treats/kibble and tone (optional) on a signal from the Handheld Remote or the Pee Pad Clip.

Treat/Kibble Size Indicators: Appropriately size the treats/kibble before adding to the Treat Dispenser Hopper (1/2" or smaller).

Hopper Lid: Encloses dry treats/kibble in the Treat Dispenser.

Hopper: Holds dry treats/kibble in the Treat Dispenser.

Hopper Button: Opens Hopper for cleaning.

On/Off Button: Turns the Treat Dispenser on and off.

Three Color Treat Dispenser LED: Indicates when the Treat Dispenser has been turned on or off; when the treats are dispensed and also serves as a battery status indicator.

Treat Compartment: Delivers dry treats/kibble to your dog.

Battery Compartment/Door: Remove to add/replace the batteries (4-AA).

Tone Switch: Turns the audible tone on and off.

Mounting Keyholes: Attaches to wall mounting screws (optional).

AC Adapter Input: Option for use without batteries, requires AC Adapter (sold separately).

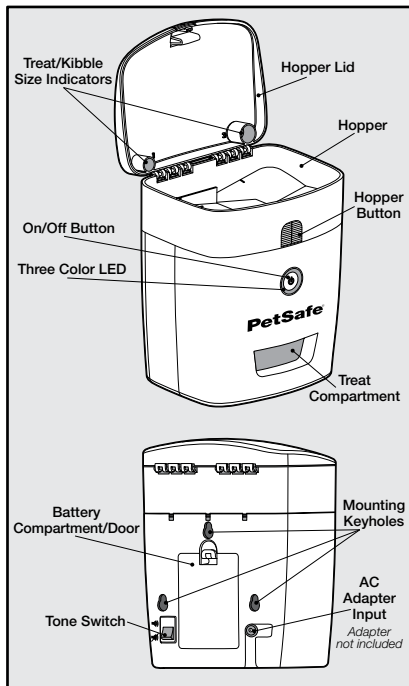

Moisture Detection Pee Pad: Used with the Pee Pad Clip to detect moisture and sends a signal to the Treat Dispenser to release treats/kibble.

Absorbent Area: 6 layers of absorbent, leak-proof protection.

Moisture Detection Sensors: Senses moisture on pad and activates the Pee Pad Clip.

Clip Attachment Area: Where the Pee Pad Clip attaches to the pad and converts the Pee Pad Clip to a wireless remote.

Pee Pad Clip: Transmits signal to the Treat Dispenser to release dry treats/kibble when Moisture Detection Pee Pad is used during post training sessions.

Battery Compartment/Door: Remove to add/replace battery.

Clamping Plate: Attaches the Pee Pad Clip to the pad.

Pee Pad Clip LED: Indicates when the Pee Pad Clip is on, when the battery is low, and when moisture is detected.

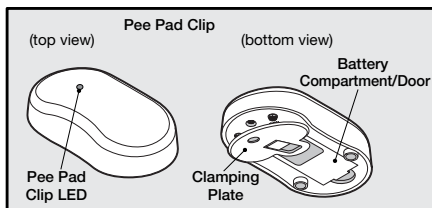
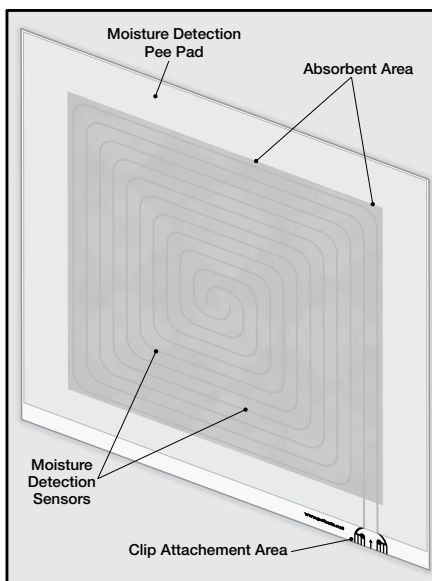

Operating Guide

Step 1

Prepare the Handheld Remote

1. Using a small flathead screwdriver (or equivalent), place into the slot on the bottom and turn until the top and bottom release (1A).
2. Install one (1) 3-volt (CR2032) battery under the clip, positive (+) side up (1B).
3. Firmly press the top and bottom back together (1C).

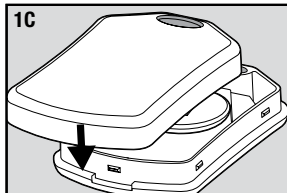
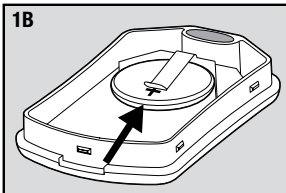
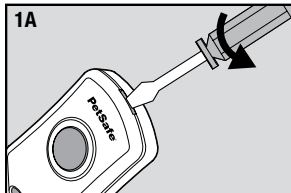

Replacement batteries (3-volt, CR2032) can be found at many retailers. Contact the Customer Care Center or visit our website at www.petsafe.net for a list of common retailers.

⚠ WARNING Risk of explosion if batteries are replaced by an incorrect type. Do not short circuit, mix old and new batteries, dispose of in fire, or expose to water. When batteries are stored or disposed, they must be protected from shorting. Dispose of used batteries properly.

Step 2

Prepare the Treat Dispenser

1. Remove the battery compartment door (2A).
2. Install four (4) AA batteries into the battery compartment on the back of the Treat Dispenser (2B).
3. Replace the battery compartment door.

⚠ WARNING Risk of explosion if batteries are replaced by an incorrect type. Do not short circuit, mix old and new batteries, dispose of in fire, or expose to water. When batteries are stored or disposed, they must be protected from shorting. Dispose of used batteries properly.

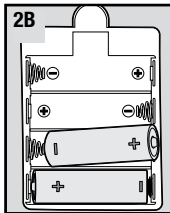
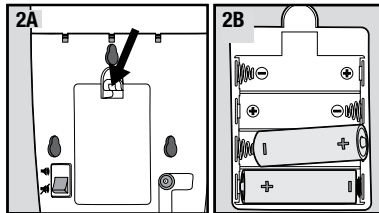

- Open the Hopper lid on the Treat Dispenser to size the treats/kibble before filling. This Treat Dispenser requires dry treats or kibble that can fit through the dispenser. Round or oval kibble of uniform size and shape work best, 1/2" size or smaller. The treat/kibble size indicator is located inside the Hopper lid (2C).

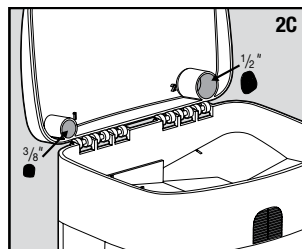

NOTICE For dry treats/kibble up to 1/2" size or smaller only.

- Remove the Hopper by pressing the Hopper button. Locate the ramp in the treat compartment. Move the ramp to correspond to the measured treat size. If the kibble fits into the cup labeled 1, the ramp needs to be in the lower position (2D). In this position you should be able to see the upper setting hole. If the kibble is larger and fits into cup 2, then the ramp must be snapped into the upper position (2E). *Note: The ramp will be set by default from the factory in the lower position for #1 size treats.*
- Once the treat/kibble size and ramp height have been determined, fill the Hopper to the fill line (2F) and close the hopper lid.
- Press and release the power button on front of the Dispenser to turn the Dispenser on. The LED's will light to indicate it is on and will display the battery status (see Battery Status Indicator below).
- The audible tone is on from the factory. Turn the tone switch off (on back of Dispenser) if you prefer to train without it.
- Press the button on the Handheld Remote to dispense the dry treats/kibble.
- To turn the Treat Dispenser off, press and hold the power button for 3 seconds or until the Red LED's turn off.

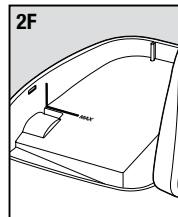
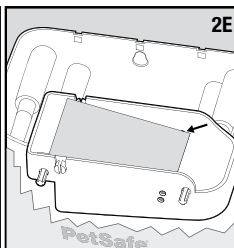
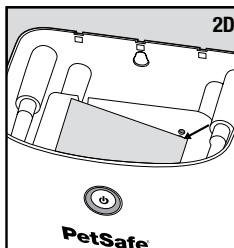

Battery Status Indicator

When turning on the Treat Dispenser, the LED surrounding the on/off button will indicate the battery status in the following manner:

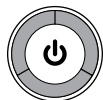

70-100% Battery
3 Green LEDs appear for 3 seconds



40-70% Battery
2 Green LEDs appear for 3 seconds

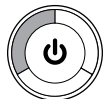

10-40% Battery
1 Green LEDs appear for 3 seconds



1-10% Battery
3 Red LEDs appear for 1 second then flash for 2 seconds

Treat Dispenser LED – Function and Response

Treat Dispenser Function	LED Response
Treat Dispenser is turned on	Battery status LEDs flash for 3 seconds
Treat Dispenser is on and idle	No LEDs or flashing
Treat Dispenser is on with low battery	3 Red LEDs flash 3 times every 8 seconds
Signal from Handheld Remote is received	3 Orange LEDs flash once
Pairing Mode	3 Green LEDs flash once every second
Pairing successful	3 Orange LEDs flash once

Step 3

Prepare the Pee Pad and Pee Pad Clip

1. Pull up lever to open battery door and remove (4A).
2. Install one (1) 3-volt (CR2032) battery, positive (+) side up (4B), under the battery contact (4C).
3. Slide battery door back into place and snap down firmly to close (4D).

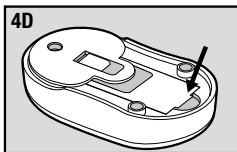
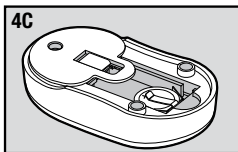
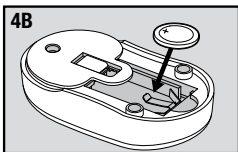
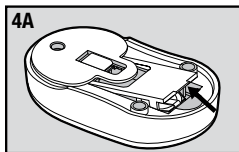

WARNING

Risk of explosion if batteries are replaced by an incorrect type. Do not short circuit, mix old and new batteries, dispose of in fire, or expose to water. When batteries are stored or disposed, they must be protected from shorting. Dispose of used batteries properly.

4. To attach the Pee Pad Clip to the pad, press the Clamping Plate lever (4E) to open and slide onto the designated area (4F).

NOTE: The pad must be fully opened with no folds. If the Pee Pad Clip is not attached to the designated area it will not operate.

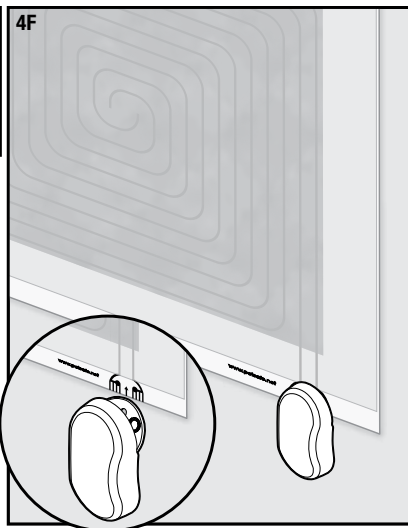
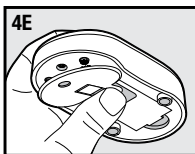

Pee Pad Clip LED – Function and Response

Pee Pad Clip Function	LED Response
Battery added and on	Green LED flashes once
Low battery	Red LED flashes once every 10 seconds
Moisture detected from Pee Pad	Orange LED flashes once

To Pair the Handheld Remote, Pee Pad Clip and Treat Dispenser

The Handheld Remote, Pee Pad Clip and Treat Dispenser are paired from the factory. If you installed the batteries properly and the Treat dispenser is not responding to the handheld Remote or Pee Pad Clip, follow these steps:

1. Remove the battery from the Pee Pad Clip.
2. Begin with the Treat Dispenser Off. Press and hold the power button for 4 seconds. During this time the green LED will appear solid. After the green LED disappears, release the button. The green LED will now flash for 30 seconds indicating the treat dispenser is in pairing mode.
3. While standing at least 3 feet away from the Treat Dispenser, press and release the Handheld Remote button once. The LED will flash orange and emit a confirmation tone (if the audible tone is enabled) when the Handheld Remote is paired.
4. While standing at least 3 feet away from the Treat Dispenser, insert the battery into the Pee Pad Clip. The Pee Pad Clip will automatically send a pairing message after the green LED turns off. The Treat Dispenser LED will briefly turn orange and emit an audible tone (if the audible tone is enabled), when the Pee Pad Clip pairs.
5. After 30 seconds the Treat Dispenser pairing mode is automatically exited. To exit pairing mode prior to 30 seconds press and release the Treat Dispenser button.
6. To test the Pee Pad Clip pairing, remove the battery from the Pee Pad Clip and return after 1 second. If paired correctly, the Treat Dispenser will dispense a treat.
7. To test the Handheld Remote pairing, push and release the Handheld Remote button once. If paired correctly, the Treat Dispenser will dispense a treat.
8. If the Handheld Remote or Pee Pad Clip is still not pairing, please contact the Customer Care Center.

Training Guide

General Tips

- : For multi dog households, train one dog at a time.
- : Use only **dry** treats/kibble.
- : When using the Handheld Remote, it is best that your dog associate the treats/kibble with you, not the Handheld Remote.
- : Don't point the remote at your pet.
- : Keep training fun!
- : If your dog barks, tries to bite or paw at the Treat Dispenser during training, change his focus to the pee pad. Give him some treats from your hand before using the Treat Dispenser. As he quiets and gives you good behavior give a treat from the Dispenser. Secure the Treat Dispenser at a level on wall higher than your dog can reach.
- : Make sure your dog is motivated with desirable treats/kibble before training begins. Change the treats/kibble until the value of the treat is worth the work.
- : Don't punish your pet for mistakes. This can only confuse your dog. If you notice he's about to pee in an inappropriate place, move him to the pee pad.

Nutritionally Balanced Diet for Your Dog

It is important that your dog is already on a nutritionally balanced feeding program before you begin using the Treat Dispenser. If you are using dry dog food/kibble, ensure they are the correct size and can be used in the Treat Dispenser for training.

NOTE: If you free feed your dog, and he shows no interest in the kibble from the Treat Dispenser, change to specific meal feeding times during the day while training with the Treat Dispenser. This should make the dispensed kibble more enticing. If you use treats instead of kibble, your training sessions should be over a longer number of days and the total calorie intake should be subtracted from your dog's daily intake of food. For most dogs, treats should make up less than 10% of a dog's daily food intake.

Training Sessions

Although we typically take our dogs outside to eliminate, it is sometimes necessary to provide an indoor potty area. This will require a minimum of four (estimated 10 – 15 minute) training sessions throughout a full day of your time with your dog over 2 – 4 week period. Your patience and direct supervision is critical to the success of the Train 'n Praise™ Potty Training System. If you have more than one dog, train each dog separately with no distractions by other pets, small children or any other interruptions. Training will begin without the Treat Dispenser and Pee Pad Clip. These will be introduced gradually. Please read all training steps before starting.

Step 1

Introducing Moisture Detection Pads

1. With the Treat Dispenser turned off, place or coax your dog onto a Train 'n Praise™ Pee Pad. It is best to choose the typical times dogs need to eliminate when on a regular nutritionally balanced diet. Be consistent by placing or coaxing your dog on a pee pad right after your dog wakes up in the morning, after eating or drinking, after playtime, after napping and before going to bed. Each time your dog is on the pee pad is considered a training session.

2. During the first couple of training sessions say a cue word as in “potty time” or “bathroom” and give a treat/kibble by hand when your dog is on the center of the pad. Keep your dog on the pee pad by giving treats/kibble until he is comfortable and familiar with the feel of the pee pad. Use the same treat/kibble by hand as you will use later in the Treat Dispenser.

Step 2

Training with Handheld Remote

The next step is introducing treats/kibble using the Handheld Remote and Treat Dispenser. Place the Treat Dispenser within range of the pee pad. Determine whether you are using the tone. Continue placing your dog on the pee pad. After your dog eliminates on the pee pad wait 10 seconds before pressing the Handheld Remote. Ensure he gets the treats/kibble. In addition, wait at least 20 minutes before the next training session as both of these specific time allowances will sequence your pet to fully relieve bladder and not pee a little to get a treat and “trick” the system, thus resulting in a conditioned training behavior/positive reward routine. Also, the specific times designed for the Train 'n Praise™ Potty Training System will provide adequate time for the pee pad's top layer to dry before the next use. Using the audible tone on the Treat Dispenser to alert the dog will also reinforce the positive reward.

1. When your dog eliminates on the pad (only on the absorbent section area) use the Handheld Remote to release a treat/kibble from the Treat Dispenser and do not use or show treats/kibble in your hand any longer.
2. Continue to place or coax your dog onto a Train 'n Praise™ Moisture Detection Pee Pad several times during the day and multiple days until the dog starts to go to the pee pad without your assistance or your verbal cues. It is important to continue to supervise during these training sessions to use the Handheld Remote to release a treat in a timely manner stated above. Consistency and patience during this time, just like any other type of training will be key to moving to the next training step and ultimately, successful indoor house-training. Do not give a treat when the dog goes outside of the absorbent pee pad area. Train to only allow a treat when used properly and not allowing a treat when the pad is missed will give you the desired results.
3. The pee pads are 100% disposable to keep clean-up easy and hassle free. It is recommended to use one pee pad per day, per dog and replace each night or first thing in the morning. Depending on use, a new pee pad must be replaced when it is full. Conveniently pull the pee pad together and toss in the garbage and lay down a new pee pad.

Step 3

Training With Pee Pad Clip

After your dog is consistently using the pee pad and taking treats/kibble that you dispense using the Handheld Remote, you are ready for the last step. The water-resistant, removable Pee Pad Clip is a wireless transmitter that works similar to the Handheld Remote. It is designed to send a signal to the Treat Dispenser when the pee pad detects moisture and is already programmed to wait 10 seconds before a treat/kibble is released. In addition, it is scheduled to wait at least 20 minutes before another signal can be given to the Treat Dispenser. The specific times designed for the Train 'n Praise™ Potty Training System will provide adequate time for the pee pad top layer to dry before the next use. You can decide to continue the audible tone on the Treat Dispenser to alert the dog, reinforcing the positive reward, as if you were there and using the Handheld Remote.

1. Following the instructions on page 10, add the Pee Pad Clip to the Moisture Detection Pee Pad within range of the Treat Dispenser.
2. After the Pee Pad Clip is attached, continue to monitor your pet 2-3 more times to ensure he is using the pee pad, the Treat Dispenser is releasing treats/kibble, and he is eating them.

3. Most dogs learn within a 2-4 week period to use the Train 'n Praise™ Potty Training System because the treat/kibble is dispensed and they are rewarded consistently for going in the right place. After following these recommendations, your dog should be consistently using the pee pad properly. This will allow you to have peace of mind that your dog is demonstrating good dog behavior when you are away for periods of time.

Tips

- : The Train 'n Praise™ Potty Training System has technology to show you when the batteries are low on the Treat Dispenser or the Pee Pad Clip. It is important to notice the low battery LED lights and change batteries before they have expired, keeping a well maintained system and turning house-training into a happy solution.
- : The Treat Dispenser works with up to 10 Moisture Detection Pee Pads and Pee Pad Clips (sold separately).
- : The Train 'n Praise™ Moisture Detection Pee Pads are 100% disposable to keep clean-up easy and hassle free. The Pee Pad Clip is water resistant, removable and can be wiped off to keep clean. The Pee Pad Clip has to be properly attached to a Train 'n Praise™ Moisture Detection Pee Pad as stated in the setup section and reattached to a new pee pad every time. It is recommended to use one pee pad per day, per dog and replace each night or first thing in the morning. Depending on use, a pee pad must be replaced when it is full. After removing the Pee Pad Clip, conveniently pull the pee pad together and toss in the garbage. Wipe off the Pee Pad Clip and reattach to a new pee pad. Lay both the Pee Pad Clip and pee pad down ready to be used when your dog needs it.

Teaching Your Pet the Audible Tone

The Treat Dispenser includes an audible tone that can be used for additional training. The tone is turned on by default from the factory. Using the Handheld Remote and Treat Dispenser, spend 10-15 minutes a day for a few days to teach your dog the association. Most dogs quickly learn a treat follows the tone.

1. Before teaching your dog the tone, use the Tone Switch on the back of the dispenser (see page 5) to turn the tone off.
2. Place treats/kibble in front of the Treat Dispenser. After he eats them, repeat adding more treats/kibble.
3. If your dog is comfortable with the Treat Dispenser, press the button on the Handheld Remote and dispense the treats/kibble. Continue until your dog is comfortable taking the food from the Treat Dispenser.
4. Turn the tone on using the Tone Switch on the back of the dispenser.
5. Press the Handheld Remote button and dispense the treats/kibble. Repeat 6-8 times. Your dog will learn the treats follow the tone!

Additional Training

The PetSafe® Train 'n Praise™ Moisture Detection Pee Pads have been designed to be an innovative aid to housebreaking, however with the addition of the Handheld Remote it can be used to reinforce other good behaviors at home. We recommend your dog be fully trained using the Treat Dispenser with the pad before other training begins.

NOTE: Please ensure the Treat Dispenser and pee pads are not together before doing the additional training.

Teaching Basic Obedience

Place

1. Ensure your dog's bed (a simple mat or blanket will also work) is in close proximity to the Train 'n Praise™ Treat Dispenser.
2. Ensure the Treat Dispenser is on and ready for use.
3. Using a leash, lead your dog to his spot while repeating the "Place" command.
4. While continuing to hold the leash, dispense treats/kibble and praise your dog as soon as he has all four paws on the surface of the bed.
5. Repeat steps three and four for up to ten minutes before giving your dog a training break.

Stay

1. Repeat PLACE steps three and four until you are confident your dog associates going to his place with receiving treats/kibble.
2. With your dog on his place, let go of (but do not remove) the leash.
3. Slowly begin adding distance by backing away, no more than four feet in the beginning, repeating the "Stay" command.
4. If your dog begins to follow while you add space, quickly grab the leash, lead him back to his place, and begin adding space again.
5. For every "Stay" command that is obeyed while you back away, dispense treats/kibble and praise your dog.
6. When you are confident your dog understands "Stay," lengthen the duration of the stay and diminish the frequency of treat dispensing.
7. Using the leash, lead your dog off his place while repeating "Release," communicating that the "Stay" is over.
8. Combine and repeat PLACE and STAY exercises in ten-minute training sessions for 4-5 days until the dog understands. Work to build up to a 15 minute "Stay."
9. After your pet stays reliably on receiving the "Stay" command, training for this behavior is complete.
10. Release your pet from his place and praise him verbally.
11. Practice this in several different areas and use different people or guest for distractions.

Eliminating Unwanted Behavior

Jumping Up

Pets typically jump up to get attention. If you do not want your pet to jump on you, then friends or members of the family should not encourage this behavior. That means every time your pet jumps on someone, he should be reprimanded or redirected to an alternate and acceptable behavior for which he can receive praise.

1. Ensure the Treat Dispenser is on and ready to use.
2. As soon as your pet lifts his paws off the ground to jump on you (or a guest) press the Handheld Remote button and dispense the treats/kibble.
3. Immediately praise him after he eats the treats/kibble.
4. Practice this in several different areas and use different people or guest for distractions.

NOTE: You (or your guest) should stand completely stationary and not give the dog any attention during this training. Continue to dispense treats/kibble until your dog goes to the Treat Dispenser. Your dog will learn he doesn't get attention until he stops jumping.

Begging

Begging can be annoying and disruptive. If you don't want your pet to beg, then friends or members of the family should not encourage this behavior. This means every time your pet begs, he should be reprimanded or redirected to an alternate and acceptable behavior, for which he can receive praise.

1. Ensure the Treat Dispenser is on and ready to use.
2. As soon as your pet begins to beg, press the Handheld Remote button and dispense the treats/kibble.
3. Immediately praise him after he eats the treats/kibble.
4. Practice this several times. Be consistent. Your dog will learn to redirect his focus from begging to the Treat Dispenser.

NOTE: Ensure you ignore your dog at the table. Don't make eye contact when he is begging. Keep the remote with you each time you are going to be in situations where your dog begs.

Optional Treat Dispenser Wall Mounting

A mounting template is located on the back cover of this guide. In order to ensure stability when mounting the Treat Dispenser, be sure to follow all instructions. *Note: It is important that the Treat Dispenser is level when mounted. Follow leveling instructions if mounting about floor level. Be sure to use the included anchors if there is no stud to avoid damage to your wall or the Treat Dispenser.*

1. If mounting the Treat Dispenser at floor level, fold at the line shown on the template (located on the back cover of this guide).
2. Place the fold flush with the floor and place removable tape on the template so it doesn't move during drilling.
3. If mounting on the wall above floor level, pick your desired location. Hold a level at the top of the template and lightly mark with a pencil. Align the template top to the pencil marks and use removable tape to keep the template in place during drilling.
4. If mounting the Treat Dispenser into a stud, use a 3/32" drill bit.
5. If using the included wall anchors to mount the Treat Dispenser, use a 1/4" drill bit.
6. Remove the template and install wall anchors in the holes.
7. Tap wall anchors flush with a hammer if necessary.
8. Place the screw in the standoff and screw into the anchors or wall stud (**3A**), making sure the standoff is flush against the wall. *Note: It is necessary to use the screws AND the standoffs to allow enough space for the Hopper lid to open when filling the Treat Dispenser.*
9. Align the screw heads with the lower portion of the mounting keyholes on the Treat Dispenser (**3B**). When all three are aligned, gently slide the Treat Dispenser onto the screw heads and then slide downward to secure the screw heads into the smaller upper portion of the mounting keyholes (**3C**).

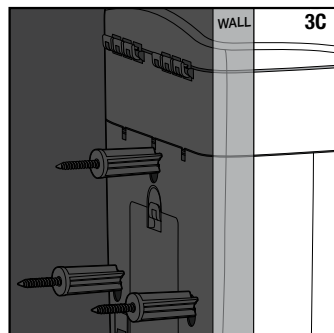
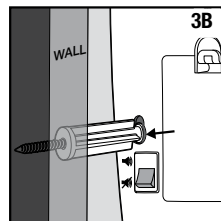
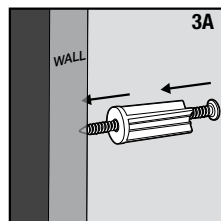

Frequently Asked Questions

How old does my dog have to be before using the PetSafe® Train 'n Praise™ Potty Training System?	: Training can begin as soon as your puppy begins eating dry treats/kibble and is weaned.
What type of behaviors can be improved or changed using the Train 'n Praise™ Potty Training System?	: House-training, jumping, trash raiding, begging at the table or for teaching basic obedience commands such as down, stay and rewarding calm behavior.
What is the range?	: The Pee Pad Clip and the Handheld Remote both work up to 25 feet.
What if my dog is afraid of the Train 'n Praise™ Potty Training System?	: Begin by giving treats from your hand. After providing a few treats/kibble, make a trail of treats/kibble leading to the Treat Dispenser. Do not dispense any treats, but allow your dog to walk up to the dispenser. After repeating this several times, your dog will learn to walk up to the Treat Dispenser without begin afraid.
My dog is barking or pawing at the Treat Dispenser.	: If your dog barks or paws at the Treat Dispenser, the Dispenser can be secured to a wall at a level your pet cannot reach. : Do not dispense any treats/kibble if your dog is barking or pawing at the dispenser. When your dog is quiet or not pawing, give him a treat/kibble from your hand. Repeat, giving him a treat/kibble from your hand several times until he is quiet or not pawing. Gradually increase the interval between treats/kibble. This will extend the time of not pawing and not barking. Once he consistently waits for his treats/kibble, begin treating him from the Train 'n Praise™ Treat Dispenser.

Troubleshooting

My Treat Dispenser is not dispensing when I press the Handheld Remote button.	: Check to see if the Treat Dispenser has been turned on. : Check to see if the batteries are low in the Treat Dispenser – the LED will flash red. : Check the battery in the Handheld Remote. : Replace the batteries. : If your Treat Dispenser still does not respond, contact the Customer Care Center.
My Treat Dispenser is not dispensing after my pet uses the pee pad.	: Ensure you are using only PetSafe® Train 'n Praise™ Moisture Detection Pee Pads. : Ensure the Pee Pad Clip is in the designated area outlined on the pee pad. : Check for low batteries in the Treat Dispenser and in the Pee Pad Clip. : Replace the batteries. : If your Treat Dispenser or Pee Pad Clip still does not respond, contact the Customer Care Center.

Care and Cleaning

- : Remove all batteries before cleaning.
 - : Clean the Treat Dispenser and Pee Pad Clip with a damp cloth.
 - : Do not disassemble the Treat Dispenser except for the Hopper.
 - : Do not use any kind of spray chemicals or solvent to clean.
 - : Do not immerse in water or any other liquid.
-

Customer Care International

USA & Canada - Tel: 800-732-2677

Monday - Friday 8 AM - 8 PM / Saturday 9 AM - 5 PM

Australia - Tel: 1800 786 608

Monday - Friday 8:30 AM - 5 PM

New Zealand - Tel: 0800 543 054

Monday - Friday 10:30 AM - 7 PM

Terms of Use and Limitation of Liability

1. Terms of Use

This Product is offered to you conditioned upon your acceptance without modification of the terms, conditions and notices contained herein. Usage of this product implies acceptance of all such terms, conditions, and notices.

2. Proper Use

This Product is designed for use with pets where training is desired. The specific temperament of your pet may not work with this product. We recommend that you not use this product if your pet is aggressive. If you are unsure whether this is appropriate for your pet, please consult your veterinarian, certified trainer or contact our Customer Care Center or visit our website at www.petsafe.net.

Proper use includes reviewing the entire Operating and Training Guide provided with your product and any specific Caution statements.

3. No Unlawful or Prohibited Use

This Product is designed for use with pets only. This pet training device is not intended to harm, injure, or provoke. Using this product in a way that is not intended could result in violation of Federal, State or local laws.

4. Limitation of Liability

In no event shall Radio Systems® Corporation be liable for any direct, indirect, punitive, incidental, special or consequential damages, or any damages whatsoever arising out of or connected with the use or misuse of this Product. Buyer assumes all risks and liability from the use of this Product.

5. Modification of Terms and Conditions

Radio Systems® Corporation reserves the right to change the terms, conditions and notices under which this Product is offered.



Battery Disposal

Separate collection of spent batteries is required in many regions; check the regulations in your area before discarding spent batteries. At the end of the product life, please contact our Customer Care Center to receive instructions on proper disposal of the unit. Please do not dispose of the unit in household or municipal waste. For a listing of Customer Care Center telephone numbers in your area, visit our website at www.petsafe.net.

Perchlorate Battery

Perchlorate Material – special handling may apply. See www.dtsc.ca.gov/hazardouswaste/perchlorate.

FCC

This device complies with part 15 of the FCC Rules. Operation is subject to the following two conditions:

(1) This device may not cause harmful interference, and (2) this device must accept any interference received, including interference that may cause undesired operation.

CAUTION: Modification or changes to this equipment not expressly approved by Radio Systems® Corporation may void the user's authority to operate the equipment.

NOTE: This equipment has been tested and found to comply with the limits for a Class B digital device, pursuant to part 15 of the FCC Rules. These limits are designed to provide reasonable protection against harmful interference in a residential installation. This equipment generates, uses, and can radiate radio frequency energy and, if not installed and used in accordance with the instructions, may cause harmful interference to radio communications. However, there is no guarantee that interference will not occur in a specific installation. If interference does occur to radio or television reception, which can be determined by turning the equipment off and on, the user is encouraged to try to correct the interference by one or more of the following measures:

- : Reorient or relocate the receiving antenna.
 - : Increase the separation between the equipment and the receiver.
 - : Connect the equipment to an outlet on a circuit different from that to which the receiver is connected.
 - : Consult customer care, the dealer, or an experienced radio/TV technician for help.
-

Warranty

One Year Non-Transferable Limited Warranty

This Product has the benefit of a limited manufacturer's warranty. Complete details of the warranty applicable to this Product and its terms can be found at www.petsafe.net and/or are available by sending a stamped addressed envelope to Radio Systems PetSafe Europe Ltd, 2nd Floor, Elgee Building, Market Square, Dundalk, Ireland.

Australia/New Zealand – In compliance with the Australian Consumer Law, Warranties Against Defects, effective January 1, 2012, warranty details of this Product are as follows:

One Year Non-Transferable Limited Warranty

What is covered: Radio Systems Australia Pty Ltd (hereinafter referred to as "Radio Systems") warrants to the original retail purchaser, and not any other purchaser or subsequent owner, that its Product, when subject to normal and proper residential use, will be free from defects in material or workmanship for a period of one (1) year from the purchase date. An "original retail consumer purchaser" is a person or entity who originally purchases the Product, or a gift recipient of a new Product that is unopened and in its original packaging. When serviced by Radio Systems Customer Service, Radio Systems covers labor and parts for the first year of ownership; after the first year, a service or upgrade charge will apply relative to replacement of the Product with new or refurbished items at Radio System's sole discretion.

The limited warranty is non-transferable and shall automatically terminate if the original retail consumer purchaser resells the Radio Systems Product or transfers the property on which the Radio Systems Product is installed. This Limited Warranty excludes accidental damage due to dog chews; lightning damage; or neglect, alteration, and misuse. Consumers who purchase Products outside of Australia, New Zealand, or from an unauthorized dealer will need to return the Product to the original place of purchase for any warranty issues.

Please note that Radio Systems does not provide refunds, replacements, or upgrades for change of mind, or for any other reason outside of these Warranty terms.

Claims Procedure

Any claim made under this Warranty should be made directly to Radio Systems Australia Pty Ltd Customer Care Center at:

Radio Systems Australia Pty Ltd
PO Box 765, Mudgeeraba QLD 4213
Australia Residents: 1800 786 608
New Zealand Residents: 0800 543 054
Email: info@petsafeaustralia.com.au

To file a claim, a proof of purchase must be provided. Without a proof of purchase, Radio Systems will not repair or replace faulty components. Radio Systems requests the Consumer to contact the Radio Systems Customer Care Center to obtain a Warranty Return number, prior to sending the Product. Failure to do so may delay in the repair or replacement of the Product.

If the Product is deemed to be faulty within 30 days from date of original purchase, Radio Systems will organise for a replacement to be sent in advance of returning the faulty Product. A Post Bag will be included with the replacement Product for the return of the faulty Product. The Product must be returned within 7 days of receiving the replacement. If the Product is deemed to be faulty after 30 days from the date of original purchase, the consumer will be required to return the Product to Radio Systems at the consumer's own expense. Radio Systems will test and replace the faulty unit or its components and return to the consumer free of charge, provided the Product is within its said warranty period. This warranty is in addition to other rights and remedies available to you under the law. Radio Systems goods come with guarantees that cannot be excluded under the Australia Consumer Law. You are entitled to a replacement or refund for a major failure and for compensation for any other reasonably foreseeable loss or damage. You are also entitled to have the goods repaired or replaced if the goods fail to be of acceptable quality and the failure does not amount to a major failure.

Should you have any queries or require any further information, please contact our Customer Care Center on 1800 786 608 (Australia) or 0800 543 054 (New Zealand).

Treat Dispenser Mounting Template

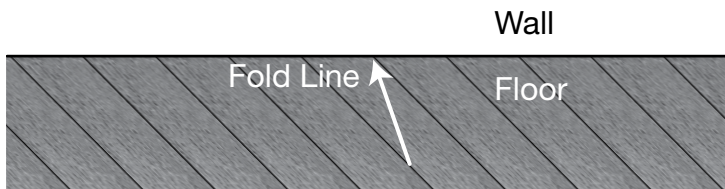
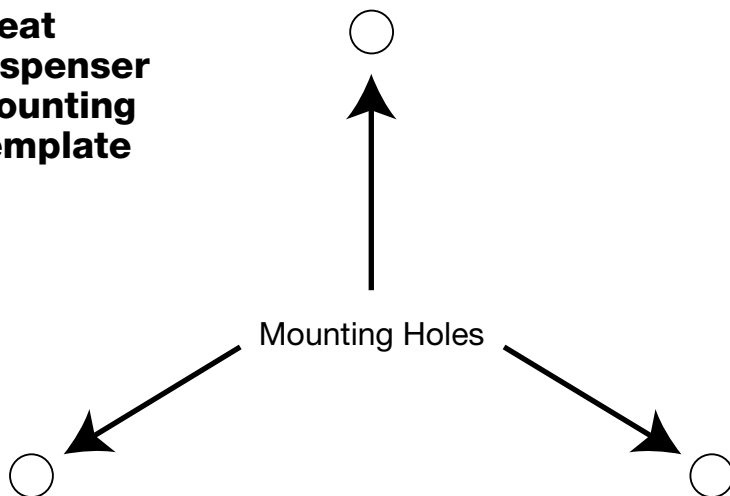

Radio Systems® Corporation
10427 PetSafe Way
Knoxville, TN 37932
1-800-732-2677
www.petsafe.net
400-1591

©2013 Radio Systems Corporation