



Invisible Fence[®] Brand

Shields[®]

Avoidance Solutions

Indoor Micro Shields[®] Owner's Manual

Please read this entire guide before operating.

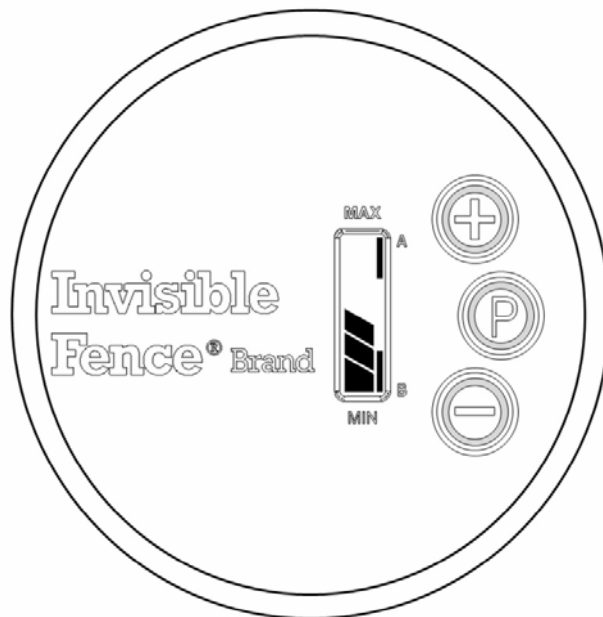

www.invisiblefence.com

Important Precautions

- Invisible Fence® Brand pet containment systems have contained over two million pets. However, there are some precautions you should take.
- Read and retain manuals: Read the entire Owner's Manual before using your new Indoor Micro Shields® solution. If you have any questions after reading this manual, call your Invisible Fence® Brand dealer.
- Adhere to all warnings and cautions contained in any Invisible Fence® Brand manual.

Explanation of Attention Words and Symbols used in this guide



This is the safety alert symbol. It is used to alert you to potential personal injury hazards. Obey all safety messages that follow this symbol to avoid possible injury or death.

⚠ WARNING

WARNING indicates a hazardous situation which, if not avoided, could result in death or serious injury.

⚠ CAUTION

CAUTION used with the safety alert symbol, indicates a hazardous situation which, if not avoided, could result in minor or moderate injury.

NOTICE

NOTICE is used to address safe use practices not related to personal injury.

⚠ WARNING

- Not every pet can be trained to avoid the established boundary. Sometimes even a properly trained pet may cross the boundary. Therefore, Invisible Fence, Inc., as well as Invisible Fence® Brand Distributors and Dealers cannot guarantee the system will, in all cases, keep a customer's pet within the established boundary. Accordingly, if a customer has reason to believe that their pet may pose a danger to others, or harm itself, the customer should not rely solely upon the Invisible Fence® Brand system to keep the pet from crossing the boundary.
- Do not install, connect, or remove your system during a lightning storm. If the storm is close enough for you to hear thunder, it is close enough to create hazardous surges.

⚠ CAUTION

- Read and follow the important tips on how to avoid pressure necrosis in your Invisible Fence® Brand Computer Collar® unit manual.
- Train your pet according to the instructions in the Invisible Fence® Brand training manuals. Complete all steps before allowing your pet to run free. Do not become overly confident if your pet has become conditioned to the Invisible Fence® Brand pet containment system sooner than expected.
- Your Invisible Fence® Brand dealer has professionally installed your pet containment system and ensured it is working properly. You will want to perform periodic maintenance checks to make sure the system is properly functioning for your pet's safe containment.
- Check the Invisible Fence® Brand transmitter periodically to make sure it is operating properly. To do this, simply bring the Computer Collar® unit to the edge of the signal field to verify function.
- Do not attempt to service any Invisible Fence® Brand equipment. Refer all service to your authorized Invisible Fence® Brand dealer. Only your authorized Invisible Fence® Brand dealer should make adjustments to your pet containment system.
- All Invisible Fence® Brand pet containment systems are designed for domesticated animal use only. Never attempt to use this product for any purpose not specifically described in this manual.

Congratulations on your purchase of the Indoor Micro Shields® solution. Please read and review this entire manual to become familiar with Indoor Micro Shields® solution components and its operation. It is strongly recommended you review this information before using the product.

The Indoor Micro Shields® solution gives you control over the areas a pet or pets have access to inside your home. It is designed to work independently or to complement your Invisible Fence® Brand Boundary Plus® and/or 800 Series digital electronic pet containment system. The Indoor Micro Shields® transmitter is designed for indoor use only. For information on or about Outdoor Shields® products, please contact your local Invisible Fence® Brand dealer or visit us at www.invisiblefence.com. **This device is not designed to operate as a containment transmitter.**

Table of Contents

Important Precautions.....	2
Components.....	4
How the Systems Works	4
Operating Guide	5
Charging.....	5
Adjust Signal Field Range.....	5
Verify Signal Field Range.....	5
Changing the Channel Setting on the Indoor Micro Shields® transmitter.....	6
Multi-Area Shielding.....	7
Programming the Computer Collar® unit.....	7
Training Guide	8
For Pets Trained to the Invisible Fence® Brand Outdoor Pet Containment System.....	8
For Pets New to Invisible Fence® Brand	8
Troubleshooting	9
Battery Disposal.....	10
Perchlorate Battery.....	10
Important Recycling Advice.....	10
Compliance.....	11

Components

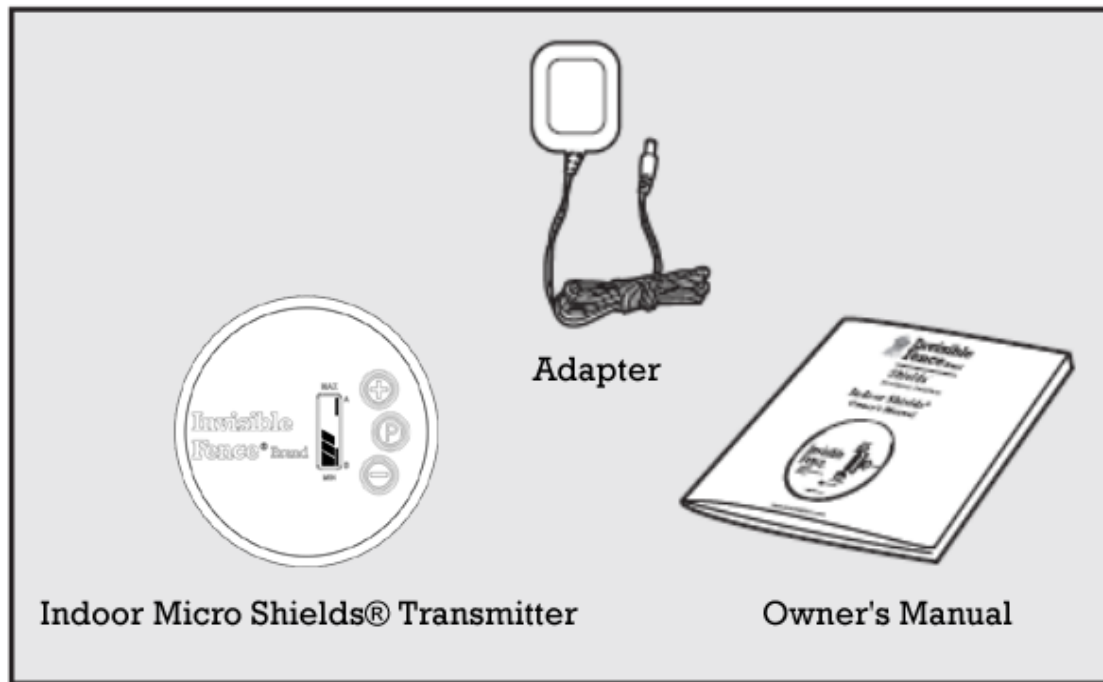

How the System Works

Indoor Micro Shields® Transmitter

The transmitter is the heart of the system. It is placed in areas you want to protect from your pet, or protect your pet from. The lightweight, portable design is easy to use and powered by a rechargeable battery pack. You may use the included AC adapter for locations near an electrical outlet. The adapter is also used for charging* the transmitter. The transmitter sends a signal field up to 4feetin diameter or as a 2 foot radius. Your pet wears a Computer Collar® unit that detects areas you have protected and delivers a correction when your pet enters those areas.

The Transmitter has three control buttons:

- Two for controlling the signal field range (RANGE UP & RANGE DOWN). These buttons also control power ON andOFF during normal use.
- One for use when programming the Computer Collar® unit to the Indoor Micro Shields® transmitter. The LCD display shows the signal field range and Channel A, Channel B, or Channels A and B mode.

AC Adapter

The AC adapter (RAC00-13701) is intended for long-term use or for recharging the Indoor Micro Shields® transmitter. Use the AC adapter to charge the battery pack for a minimum of 4 hours prior to first use.

Note: A correction is a training term used to describe an action taken to discourage unwanted pet behavior. The Computer Collar® unit delivers a correction when your pet enters a protected area or crosses the boundary of an Invisible Fence® Brand system.

Operating Guide

Important: To ensure your pet does not receive an unintended correction, make sure your pet is not wearing the Computer Collar® unit when turning ON or adjusting the Indoor Micro Shields® transmitter.

1. Charging

- To charge the battery, plug one end of the AC adaptor (RAC00-13701) into a standard wall outlet and the other end into the power jack located on the edge of the Indoor Micro Shields® transmitter.
- Allow the unit to charge a full 4 hours before first use. A charge time of 2 hours is required after the first charge.
- Fully charge the Indoor Micro Shields® transmitter for 4 hours after storage.
- Battery life of approximately 30 days can be expected from a fully charged battery.

2. Adjust signal field range

- Determine the desired location and the signal field range required (10 in / 5 cm minimum radius up to 2ft / .61 m maximum radius).
- With the unit ON, press the RANGE UP(+) or the RANGE DOWN (-) buttons to increase or decrease the signal field range. The first segment of the range indicator equals 10 in / 25 cm radius of signal field. Each additional segment represents approximately 3 in / 8 cm radius of range.
- Once the range is set, place the Indoor Micro Shields® transmitter in the desired area.

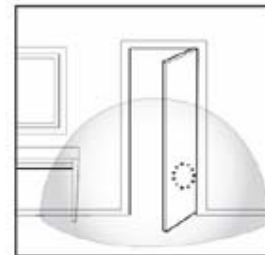
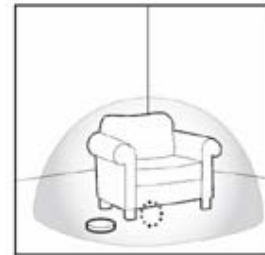

3. Verify signal field range

- Turn the Indoor Micro Shields® transmitter ON.
- Holding the Computer Collar® unit, start outside the range and move slowly towards the Indoor Micro Shields® transmitter. Do not touch the correction posts at this time.
- The Computer Collar® unit will beep as it approaches the outer range of the signal field width set in Step 2. The beeping will be followed by a correction.
- If the Computer Collar® unit fails to beep, see the troubleshooting chart found on page 9.
- Adjust range and/or relocate the Indoor Micro Shields® transmitter until desired area is protected.

Operating Guide

4. Changing the Channel Setting on the Indoor Micro Shields® transmitter

1. Press and release the RANGE DOWN (-) button until no bars appear on the LCD.
2. Turn the unit over and remove the bottom lid by rotating counter-clockwise.
3. Locate the switch for the Channel (A), Channel (B) and Channels (A+B). (Figure 1)
4. Select the desired setting. *Note: The Indoor Micro Shields® transmitter will not enter into programming mode if this switch is set to A+B.*
5. Replace the bottom lid and turn clockwise until the lid stops.

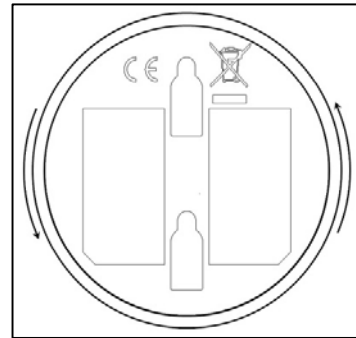

Note: Ensure the O-ring is in the top housing and seated in the channel before replacing the bottom lid. Failure to do so may allow moisture leakage and failure of the device. (Figure 1)

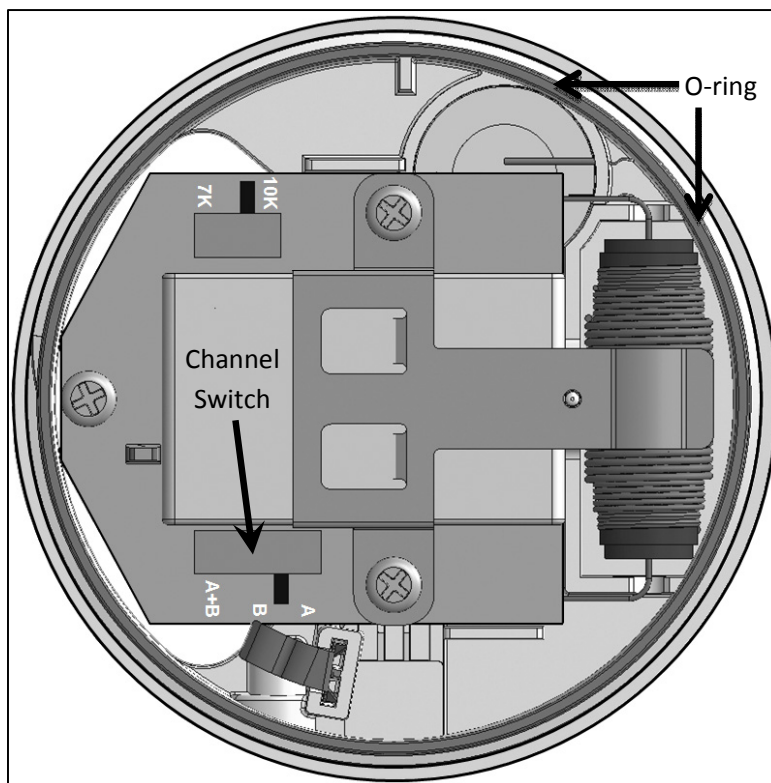

Figure 1

Operating Guide

Multi-Area Shielding

Your Indoor Micro Shields® Transmitter and the Computer Collar® unit are preset to operate on Channel A (CH.A). For homes with two or more pets, this setting is usually sufficient as long as all pets are required to avoid the same protected areas like keeping all pets away from the trash, off the counter tops off the sofa, etc. In some multi-pet homes, it may be desired to allow one pet access to an area while denying access to another pet.

- When set to Channel A (CH.A), the Indoor Micro Shields® transmitter denies access to pets wearing a Computer Collar® unit programmed to Channel A. (Channel A is the default setting for the Computer Collar® unit.)
- When set to Channel B (CH.B), the Indoor Micro Shields® transmitter denies access to pets wearing a Computer Collar® unit programmed to Channel B.
- When set to Channel A-B (CH. A and CH.B), the Indoor Micro Shields® transmitter denies access to all pets wearing a Computer Collar® unit.

Programming the Computer Collar® unit

1. Ensure all Computer Collar® units are removed from pets and are at least 3 feet from the Indoor Micro Shields® transmitter.
2. Follow procedure above, **Changing the Channel Setting on the Indoor Micro Shields® transmitter**, to select Channel A or Channel B to program into the Computer Collar® unit. Note: The Indoor Micro Shields® transmitter will not enter into programming mode if this switch is set to A+B. Turn the unit back over and set it down on a flat surface.
3. Press and hold the PROGRAM button while lowering the Computer Collar® unit from directly above the Indoor Micro Shields® transmitter.
4. Stop lowering when the Computer Collar® unit begins to flicker yellow and release the PROGRAM button when the Computer Collar® unit begins to flash green.
5. The Computer Collar® unit is now programmed to the desired channel.
6. Verify operation by turning ON the Indoor Micro Shields® transmitter and listening for Computer Collar® unit activation.

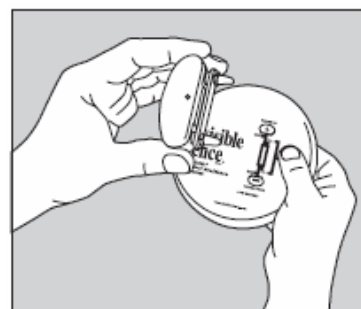

Note: Make sure any Computer Collar® units you do not wish to program are more than 3 feet from the Indoor Micro Shields® transmitter or have the Power Cap® Battery removed. Do not perform this procedure while the Computer Collar® Unit is on a pet.

Training Guide

For pets trained to the Invisible Fence® Brand system

- Use Invisible Fence® Brand training flags to mark the outside of the signal field range. This gives your pet a visual marker, similar to how they learned the signal field range of the outdoor pet containment system.
- Allow your pet to enter the protected area. By already being familiar with the training flags and the warning beep, your pet should react immediately by moving away from the protected area. It may take several times for your pet to recognize and avoid the protected area.
- Praise your pet for leaving the protected area.
- You may need to adjust the signal field range so your pet receives the warning beep earlier.

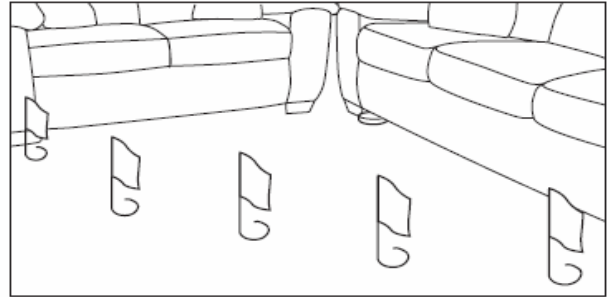

For pets new to the Invisible Fence® Brand system

- Use Invisible Fence® Brand training flags to mark the edge of the signal field range. This gives your pet a visual marker.
- Use Invisible Fence® Brand correction post covers, or safety posts, on the Computer Collar® Unit for the first training session. This will introduce your pet to the idea of leaving the protected area when he hears the warning beep.
- Attach a long lead to your pet's collar strap and show your pet how to avoid the protected area by gently guiding the pet out of the range when the warning beep sounds.

Note: Do not attach a lead to the Computer Collar® unit strap. This can result in Pulling the Correction Posts too tightly against your pet's neck. Attach a lead to a separate, nonmetallic collar or harness, making sure the extra collar strap does not put pressure on the Correction Posts.

- Praise your pet for leaving the protected area.
- Repeat this process until your pet reacts to the warning beep on their own by moving away from the protected area.
- Remove the post covers, or safety posts, on the Computer Collar® unit. Allow your pet to enter the protected area. Your pet should react immediately to the warning beep and correction by moving away from the protected area. It may take several times for your pet to recognize and avoid the protected area.
- After training is complete, remove your pet's Computer Collar® unit each night to prevent irritation. However, if this is not possible, please check the tightness of the collar each time you feed your pet by removing the collar and then.

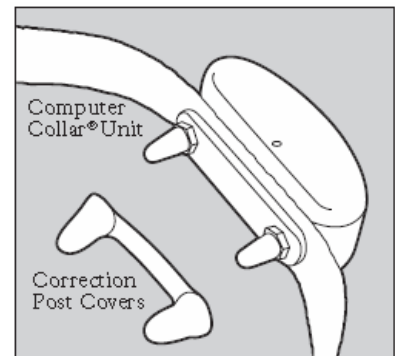

Troubleshooting

<p>Indoor Micro Shields® does not appear to work</p>	<ul style="list-style-type: none"> • Check for low battery (audible chirp once every 30 seconds and flashing LCD). If low battery is indicated, plug the AC adapter into the unit and charge for 2 hours. • Check/replace the Power Cap® Battery in the Computer Collar® unit. • The Indoor Micro Shields® transmitter power could be completely drained. Apply power to the Indoor Micro Shields® transmitter using the AC adapter to verify operation. • If using AC adapter for power, check connections. • Check the Computer Collar® unit fit to ensure posts have direct skin contact. • Ensure the Computer Collar® unit is programmed to same Indoor Micro Shields® transmitter
<p>LCD is black</p>	<ul style="list-style-type: none"> • Operating the Micro Shields® transmitter in direct sunlight may cause the LDC to overheat and turn completely black. The LCD will return to normal when the temperature drops below 150°F/65°C. Operating the transmitter when the LCD is black will not damage the device.
<p>Range is too low or too high</p>	<ul style="list-style-type: none"> • Check for low battery (audible chirp once every 30 seconds and flashing LCD). If low battery is indicated, plug the AC adapter into the unit and charge for 2 hours. • Adjust the Indoor Micro Shields® transmitter to increase/decrease signal field range. See Step 2 on page 5 (Adjust signal field range). • Metal objects may distort the transmitter's range. Consider alternate location for the Indoor Micro Shields® transmitter.
<p>Pet seems to receive no correction</p>	<ul style="list-style-type: none"> • Check/replace the Power Cap® Battery in the Computer Collar® unit. • Check the signal field range on the Indoor Micro Shields® transmitter. • Ensure post covers are removed from the Computer Collar® unit after training
<p>Computer Collar® Unit fails to sound warning beep</p>	<ul style="list-style-type: none"> • Check/replace the Power Cap® Battery in the Computer Collar® unit. • Ensure the Computer Collar® unit is set to same Indoor Micro Shields® transmitter CHANNEL setting. See Multi-Area Shielding Section on page 7

Need additional help? Contact your local Invisible Fence® Brand dealer. Call 1-800-578-3647 or visit www.invisiblefence.com to find your local dealer.

Battery Disposal

Separate collection of spent batteries is required in many regions; check the regulations in your area before discarding spent batteries. The Computer Collar[®] unit operates on one (1) Lithium (Li-MnO₂) battery with a 3 Volt, 160 mAh capacity, replace only with equivalent battery that may be obtained from your Invisible Fence[®] Brand dealer. The transmitter operates on 1 rechargeable Lithium Ion Polymer (Li-ion) battery pack with a 3.7 Volt, 420 mAh capacity.

Perchlorate Battery

Perchlorate Material – special handling may apply. See www.dtsc.ca.gov/hazardouswaste/perchlorate.

Important Recycling Advice

Please respect the Waste Electrical and Electronic Equipment regulations in your country. This equipment must be recycled. If you no longer require this equipment, do not place it in the normal municipal waste system. Please return it to where it was purchased in order that it can be placed in our recycling system. If this is not possible, please contact your InvisibleFence[®] Brand dealer.

Compliance

US and Canada

FCC ID: KE3-3002563

IC: 2721A-3002563

This device complies with Industry Canada rules. This device complies with part 15 of the FCC Rules. Operation is subject to the following two conditions: (1) This device may not cause harmful interference, and (2) this device must accept any interference received, including interference that may cause undesired operation.

Le présent appareil est conforme aux CNR d'Industrie Canada applicables aux appareils radio exempts de licence. Cet appareil est conforme à la partie 15 des règles FCC. L'exploitation est autorisée aux deux conditions suivantes : (1) l'appareil ne doit pas produire de brouillage, et (2) l'utilisateur de l'appareil doit accepter tout brouillage radioélectrique subi, même si le brouillage est susceptible d'en compromettre le fonctionnement.

CAUTION Modification or changes to this equipment not expressly approved by Radio Systems® Corporation may void the user's authority to operate the equipment.

NOTE: This equipment has been tested and found to comply with the limits for a Class B digital device, pursuant to part 15 of the FCC Rules. These limits are designed to provide reasonable protection against harmful interference in a residential installation. This equipment generates, uses, and can radiate radio frequency energy and, if not installed and used in accordance with the instructions, may cause harmful interference to radio communications. However, there is no guarantee that interference will not occur in a specific installation. If interference does occur to radio or television reception, which can be determined by turning the equipment off and on, the user is encouraged to try to correct the interference by one or more of the following measures:

- Reorient or relocate the receiving antenna.
- Increase the separation between the equipment and the Computer Collar® Unit.
- Connect the equipment to an outlet on a circuit different from that to which the Computer Collar® Unit is connected.
- Consult the dealer, or an experienced radio/TV technician for help.

This Class B digital apparatus complies with Canadian RSS-210.

Cet appareil numérique de la classe B est conforme à la norme RSS-210 du Canada.

Australia

This device complies with the applicable EMC requirements specified by the ACMA (Australian Communications and Media Authority).

European Union



This equipment has been tested and found to comply with relevant EU Electromagnetic Compatibility, Low Voltage and R&TTE Directives. Before using this equipment outside the EU countries, check with the relevant local R&TTE authority. Unauthorized changes or modifications to the equipment that are not approved by Radio Systems Corporation are in violation of EU R&TTE regulations, could void the user's authority to operate the equipment, and void the warranty.

This product is in full compliance with the provisions of the R&TTE - Directive 1999/05/EEC. The Declaration of Conformity can be found at: <http://www.invisiblefence.com/international/declarations-of-conformity.asp>.

Dealer Name: _____

Dealer Phone: _____

System Frequency: _____

Notes:

800-578-3647 (USA)
(865) 777-5404 (International)
©2012 Radio Systems® Corporation Need to remove the symbol here.
All rights reserved.

Protected by Patents:
U.S.: 7,046,152; 7,068,174; 7,204,204;
7,278,376; 7,495,570

www.invisiblefence.com