



寰波科技股份有限公司

Document for Approval

Part Name : SA2-22008-N5

Customer approved By : _____ Date : _____

Approved By : Anderson Date : 7th, July, 2004

Prepared By : Dora Date : 7th, July, 2004

Dual-Band Omni-Directional Antenna for 2.4 / 5.25 / 5.6 / 5.8 GHz

SA2-22008-N5 Specification

Electrical Specification

Frequency range	2400 MHz - 2483 MHz	5150 MHz - 5875 MHz
Peak gain	4.5 dBi	5.0 dBi
Average gain	2.5 dBi	3.0 dBi
VSWR	2.0 : 1 Max.	
Polarization	Linear, vertical	
Power handling	2 W (cw)	
Impedance	50 Ohms	
Connector	RP- N plug	



Environmental & Mechanical Characteristics

Survival wind speed	216 km/hr
Temperature	- 40°C to +70°C
Humidity	95% @ 25° C
Radome color	Gray
Radome material	ABS
Dimensions	f22 x 183 mm

E-plane Co-polarization pattern

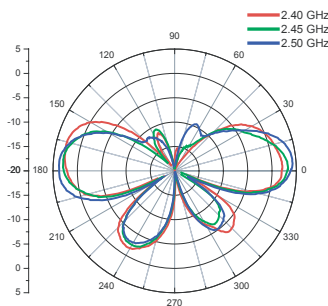

E-plane Co-polarization pattern

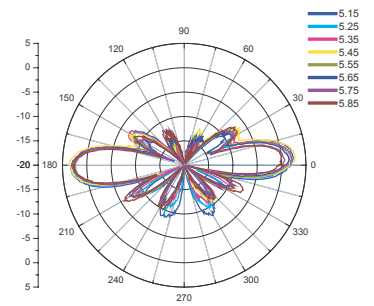

H-plane Co-polarization pattern

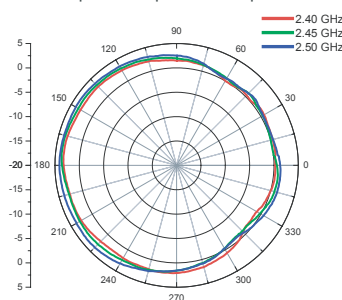

H-plane Co-polarization pattern

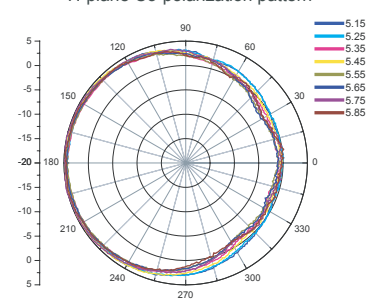

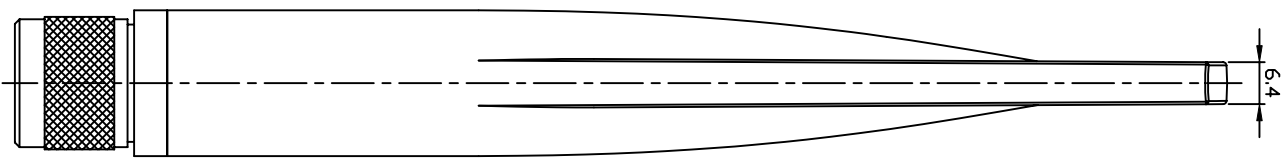
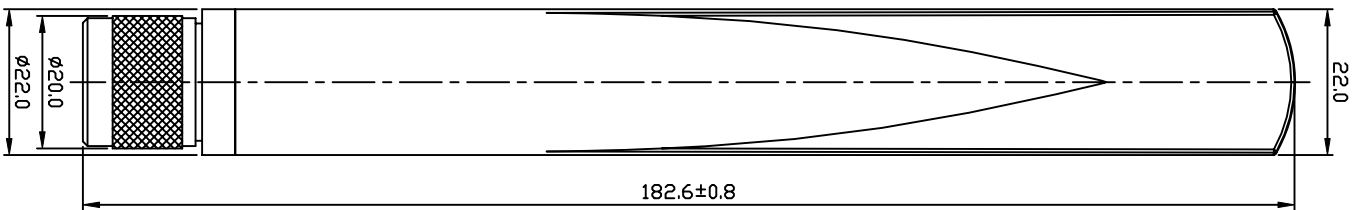

GENERAL TOLERANCE RANGE

	±1MIL
PCB(电路板)	X=±0.5 X.X=±0.2 X.XX=±0.1
MACHINING(加工件)	X=±0.4 X.X=±0.2 X.XX=±0.1
STAMP(冲压件)	X=±0.6 X.X=±0.2 X.XX=±0.15
INJECTION(射出件)	X=±1 X.X=±0.5 X.XX=±0.15
CASTING(铸件)	X=±1 X.X=±0.5 X.XX=±0.15
PACKING(包材)	X=±6 X.X=±3 X.XX=±1
ASSEMBLY(组合件)	X=±1 X.X=±0.5 X.XX=±0.15

註:有()表參考尺寸,不需特別檢驗

A			
LTR	REV/RECORD	DR	APVD

ITEM	PART NO.	DESCRIPTION	QTY
2	RP N PLUG CONNECTOR		1
1	ANTENNA RADOME		1

Surface Treatment	MTL
DRW TITLE	SA2-22008-N5
DRW/G/NO	R0422-068-01
SCALE	1:1
UNIT	mm

DRAWN	Dora
ENGR	Pat
APVD	

