

belkin.com

**Belkin Tech Support**

US: 310-898-1100, ext. 2263

800-223-5546, ext. 2263

UK: 0845 607 77 87

Australia: 1800 235 546

New Zealand: 0800 235 546

Europe: [www.belkin.com/support](http://www.belkin.com/support)

© 2009 Belkin International, Inc. All rights reserved. All trade names are registered trademarks of respective manufacturers listed.

8820-00400 • F5L075-USB

**FCC Statement**

(15.21)

Warning: Changes or modifications to this unit not expressly approved by the party responsible for compliance could void the user authority to operate the equipment.

15.19 (a)(3)

This device complies with Part 15 of the FCC Rules. Operation is subject to the following two conditions: (1) this device may not cause harmful interference, and (2) this device must accept any interference received, including interference that may cause undesired operation.

**IC Statement**

Operation is subject to the following two conditions: (1) this device may not cause interference, and (2) this device must accept any interference, including interference that may cause undesired operation of the device

**BELKIN.**

## **Wireless Mouse**

---

### Quick Installation Guide



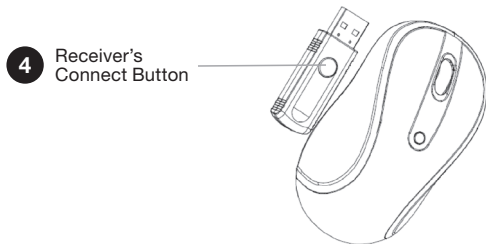
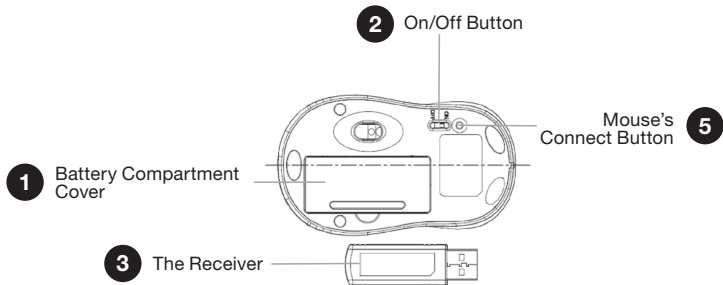

## Setup Instructions

Connect the mouse and receiver when you use the mouse for the first time and when replacing batteries.

1. Remove the battery compartment cover and install two AAA alkaline batteries as indicated by the polarity symbols (+/-), then replace the cover.
2. Turn on the mouse.
3. Plug the receiver into an available USB port.
4. Press the USB receiver's Connect button.
5. Press the mouse's Connect button.

### Note:

- The unit will go into stand-by mode after a few seconds of idling. Slide the mouse around to wake it up.
- The unit will go into sleep mode after 6–8 minutes of idling and the LED will go off. Click the mouse button to wake it up.