

ENFORCER Wireless Entry Alert System

Installing the Optional Solar Charger (E-931ACC-SPQ):

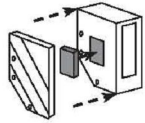

1. Install the solar panel in an area exposed to sunlight.
2. Use the included Phillips screwdriver to remove the side panel of the sensor.
3. Install the 3.7V lithium-ion battery included with the solar charger into the sensor.
4. Replace the side panel.

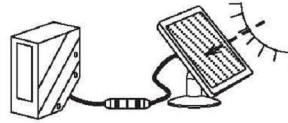

5. Connect the solar charger's DC plug to the sensor's DC jack.
6. Attach the bracket to the solar panel by twisting into the back of the solar panel until tight.
7. Adjust the solar panel and then tighten the adjustment knob.

Sample Applications:

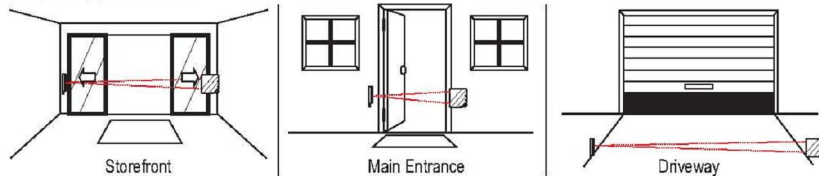

Troubleshooting:

Sensor does not detect object	<ul style="list-style-type: none">• Change the angle of the sensor or reflector
Red LED does not turn on	<ul style="list-style-type: none">• Change the angle of the sensor or reflector• Check power adapter and cable• Make sure solar charger is installed in an area exposed to sunlight (E-931ACC-SPQ Only).
Speaker does not sound	<ul style="list-style-type: none">• Make sure speaker is switched to Chime or Alarm.• If using Alarm, make sure alarm duration is long enough.• Try pairing the sensor to the speaker. See <i>Pairing the Sensor and Optional Additional Speaker</i> on page 3.

CAUTION: This sensor was not designed to prevent bodily injury or loss of life. Use of this sensor in certain security applications may be regulated by local laws or codes. SECO-LARM is not responsible for compliance with such laws or codes.

FCC COMPLIANCE STATEMENT

Information to the user: This equipment has been tested and found to comply with the limits for a class B digital device, pursuant to part 15 of the FCC rules. These limits are designed to provide reasonable protection against harmful interference when the equipment is operated in a commercial environment. This equipment generates, uses, and can radiate radio frequency energy and, if not installed and used in accordance with the instruction manual, may cause harmful interference to radio communications. Operation of this equipment in a residential area is likely to cause harmful interference in which case the user will be required to correct the interference at his or her own expense.

WARRANTY: This SECO-LARM product is warranted against defects in material and workmanship while used in normal service for the life of the product from the date of sale to the original customer. SECO-LARM's obligation is limited to the repair or replacement of any defective part if the unit is returned, transportation prepaid, to SECO-LARM. This Warranty is void if damage is caused by or attributed to acts of God, physical or electrical misuse or abuse, neglect, repair or alteration, improper or abnormal usage, or faulty installation, or if for any other reason SECO-LARM determines that such equipment is not operating properly as a result of causes other than defects in material and workmanship. The sole obligation of SECO-LARM and the purchaser's exclusive remedy, shall be limited to the replacement or repair only, at SECO-LARM's option. In no event shall SECO-LARM be liable for any special, collateral, incidental, or consequential personal or property damage of any kind to the purchaser or anyone else.

NOTICE: The information and specifications printed in this manual are current at the time of publication. However, the SECO-LARM policy is one of continual development and improvement. For this reason, SECO-LARM reserves the right to change specifications without notice. SECO-LARM is also not responsible for misprints or typographical errors. Copyright © 2013 SECO-LARM U.S.A., Inc. All rights reserved. This material may not be reproduced or copied, in whole or in part, without the written permission of SECO-LARM.

SECO-LARM® U.S.A., Inc.

16842 Millikan Avenue, Irvine, CA, 92606
Tel: (949) 261-2999 | (800) 662-0800

Website: www.seco-larm.com
Email: sales@seco-larm.com

PITSW3
MIE-931CS22RFQ_1308.docx

SECO-LARM U.S.A., Inc.

ENFORCER®

FCCID: K4E931CS22RF

Wireless Entry Alert System



Manual



- For monitoring a driveway or for use as an entrance indicator
- No wiring necessary between sensor and speaker
- Sensor range: Up to 22ft (7m)
- Sensor is weatherproof for outdoor use
- Speaker makes chime or alarm sound if beam is interrupted
- Wireless range: Up to 328ft (100m) between the sensor and speaker
- Each sensor can be paired with an unlimited number of speakers
- Each speaker can be paired with up to 5 sensors

SLI SECO-LARM®



Note: Model numbers that end with "Q" or that have a round green "Q" sticker signify RoHS-compliant products.

Introduction:

The ENFORCER Wireless Entry Alert System is a self-contained easy-to-install alert system for commercial or home applications. Each set contains a reflective photoelectric beam sensor that, when tripped, communicates wirelessly with a speaker installed up to 328ft (100m) away*. An additional speaker may be installed to alert more than one area on the property and an optional solar charger may be installed with the sensor for even more convenience.

Specifications:

		Sensor	Speaker
Sensing range		Up to 22ft (7m)	N/A
Wireless range		Up to 328ft (100m)*	
Operating frequency		433.92 MHz	
Operating voltage		12VDC	
Current draw	Standby	5mA	25mA
	Active	20mA	100mA
Power input		2.5mm DC Jack	
Light source		IR LED	N/A
Operating temperature		32°~122° F (0°~50° C)	
Volume		N/A	0~90 dB
Alarm time range		N/A	3~30 s (Adjustable)
Speaker output		N/A	Chime/Off/Alarm (selectable)
IP Rating		IP55	N/A
Dimensions		3 1/4" x 2 9/16" x 1 1/2" (82x66x38 mm)	3 1/4" x 2 15/16" x 1 9/16" (83x75x40 mm)

*Range may vary greatly depending on the installation and operating environment.

Parts List:

- | | | |
|----------------------|-------------------------------|--------------------|
| 1x Sensor | 1x Mode adjustment pin | 4x Nuts |
| 1x Speaker | 1x Sensor mounting bracket | 5x Mounting screws |
| 1x Reflector | 1x Reflector mounting bracket | 1x Screw anchor |
| 2x Power adapters | 2x Bolts (Sensor) | 1x Manual |
| 1x Small screwdriver | 2x Bolts (Reflector) | |

Overview:

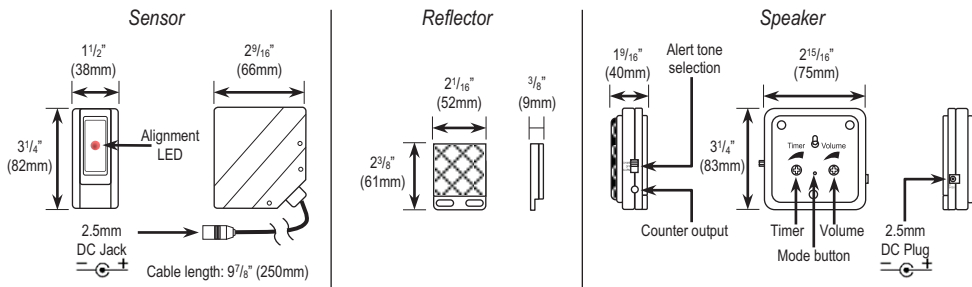

Optional Accessories:

Additional Wireless Speaker
E-931ACC-SFQ



Digital Counter
E-931ACC-CQ



Replacement Square Reflector
E-931ACC-R2Q



Solar Charger for Sensor
E-931ACC-SPQ



Hood for Square and Round Reflectors
E-931ACC-HR1Q



3" Round Reflector
E-931ACC-RC1Q



Installation:

1. Install the reflector and sensor so they face each other about 2ft (61cm) off the ground.
 2. Install the speaker within 328ft (100m) of the sensor.
 3. Connect an included power adapter to the sensor. If optional solar charger is used, see pg. 4, *Installing the Optional Solar Charger*.
 4. Connect an included power adapter to the speaker.
 5. To find the correct alignment, slowly adjust the angles of the sensor and reflector.
- NOTE:** Alignment is correct when the red LED turns ON.

Mounting:

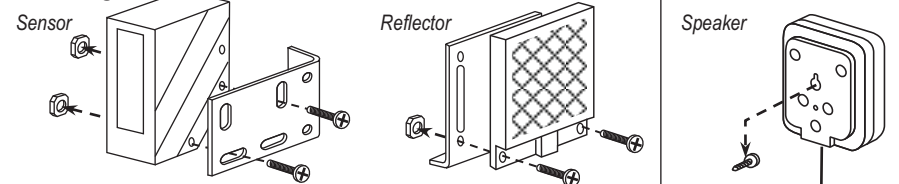

1. Attach the sensor or reflector to their respective brackets by using the included bolts and nuts.
 2. Mount the bracket to the wall using two of the included mounting screws.
1. Drill included screw into wall.
 2. Hang speaker on screw.

Programming the Speaker:

1. Choose between **Chime**, **Alarm**, and **Off** using the alert tone selection switch on the side of the speaker.
2. Adjust the volume by using the included Phillips screwdriver to turn the volume adjustment screw. Turning clockwise increases the volume; counter-clockwise decreases the volume.
3. Adjust the timer by using the included Phillips screwdriver to turn the timer adjustment screw. Turning all the way clockwise will set the timer for 30 seconds; turning all the way counter-clockwise will set the timer for three seconds.

NOTE: Timer mode only applies if **Alarm** is chosen as the alert tone.

Pairing the Sensor and Optional Additional Speakers (E-931ACC-SFQ):

Use one of the two methods below to pair the optional additional speaker with the sensor.

NOTE: The speaker included with the Wireless Entry Alert System is pre-paired with the sensor.

Method 1:

1. Use the included mode adjustment pin to press and hold the mode switch until you hear a long beep from speaker. This means the speaker is in the learning mode.
2. Trigger the sensor by breaking the beam. The speaker will beep once.
3. After 10 seconds, the speaker will make one long beep indicating successful pairing.

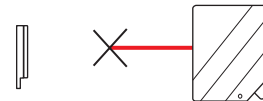

Method 2:

1. Remove the side panel of the sensor with the included small Phillips screwdriver.
2. Perform the point 1 of "Method 1" and then press sensor's learning button once. The speaker will beep once.
3. After 10 seconds, the speaker will make one long beep indicating successful pairing.

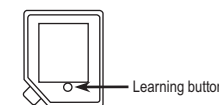

Clearing Memory:

1. Use the included mode adjustment pin to press and hold the mode switch until you hear a long beep and two short beeps after five seconds.
2. Release the mode button and the memory has been cleared.

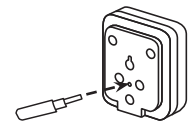

IMPORTANT: When pairing additional speaker, release the mode switch immediately after two seconds and hearing the long beep. Pressing the mode switch for more than five seconds will delete the memory.

Connecting the Optional Counter (E-931ACC-CQ):

1. Connect the plug from the counter to the counter output jack of the speaker.
2. Test the counter. Each time the beam is broken, the counter should automatically increase by 1.
3. Manually add or subtract 1 by pressing the "+" or "-" buttons
4. Reset the counter by pressing "RESET".

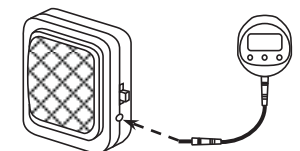

The Federal Communication Commission Statement

This equipment has been tested and found to comply with the limits for a Class B Digital Device, pursuant to Part 15 of the FCC rules. These limits are designed to provide reasonable protection against harmful interference in a residential installation. This equipment generates, uses and can radiate radio frequency energy and, if not installed and used in accordance with the instruction, may cause harmful interference to radio communication. However, there is no guarantee that interference will not occur in a particular installation. If this equipment does cause harmful interference to radio or television reception, which can be determined by turning the equipment off and on, the user is encouraged to try to correct the interference by one of more of the following measures: -

- **Reorient or relocate the receiving antenna.**
- **Increase the separation between the equipment and receiver.**
- **Connect the equipment into an outlet on a circuit different from that to which the receiver is connected.**
- **Consult the dealer or an experienced Radio/TV technician for help.**

Use only shielded cables to connect I/O devices to this equipment. You are cautioned that change or modifications not expressly approved by the party responsible for compliance could void your authority to operate the equipment.

THIS DEVICE COMPLIES WITH PART 15 OF FCC RULES. OPERATION IS SUBJECT TO THE FOLLOWING TWO CONDITIONS:

- 1 This device may not cause harmful interference and
- 2 This device must accept any interference received, including interference that may cause undesired operation.

The antenna used for this transmitter must not be collocated or operation in conjunction with any other antenna or transmitter.

Notice : The changes or modifications not expressly approved by the party responsible for compliance could void the user's authority to operate the equipment.

IMPORTANT NOTE: To comply with the FCC RF exposure compliance requirements, no change to the antenna or the device is permitted. Any change to the antenna or the device could result in the device exceeding the RF exposure requirements and void user's authority to operate the device.