

HRST-W, HRST-W2B, HRST-W3RL & HRST-W4B
120-277 V~ 50/60 Hz

Included Components

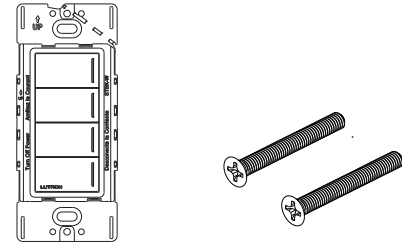

Keypad Mounting Screws

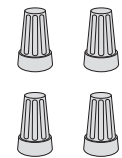

Wire Nut Yellow (x4)

Help

HomeWorks Support Center
For additional support in installing, programming, and troubleshooting



www.lutron.com/support

Limited Warranty: For warranty information, please see the Warranty enclosed with the product, or visit www.lutron.com/resiinfo

For FCC/IC information: Please visit: www.lutron.com/fcc-ic

©Lutron, Lutron, HomeWorks, Claro, Satin Colors, Sunnata and the sunburst logo are trademarks or registered trademarks of Lutron Electronics Co., Inc. in the US and/or other countries.

App Store is a service mark of Apple Inc., registered in the U.S. and other countries.

All other product names, logos, and brands are property of their respective owners.

©2020 Lutron Electronics Co., Inc.

1 Turn power OFF at circuit breaker

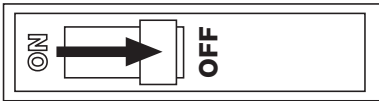

WARNING: ELECTRIC SHOCK HAZARD. May result in Serious Injury or Death. Turn off power at circuit breaker or fuse before installing.

2 Prepare wires

When making wire connections, follow the recommended strip lengths and combinations for the supplied wire connectors. Note: Wire connectors provided are suitable for copper wire only.

| AWG | Strip Length |
|--|-----------------|
| 12 & 14 AWG (2.5 & 1.5 mm ²) | 3/8 in (10 mm) |
| 18 AWG (0.75 mm ²) | 7/16 in (11 mm) |

IMPORTANT NOTES

Codes: Install in accordance with all local and national electrical codes.

Environment: Ambient operating temperature: 32 °F to 104 °F (0 °C to 40 °C), 0 to 90% humidity, non-condensing. Indoor use only.

Wallplates: Use only Lutron wallplates with these keypads. The mechanical design of the keypad MAY NOT be compatible with non-Lutron wallplates. Non-Lutron wallplates MAY NOT sit flush against the wall. Claro and Satin Colors wallplates are designed for best color match and clean aesthetic appearance. Do not paint controls, buttons, or wallplates.

Cleaning: For disinfecting keypad, please refer to App Note #758 (048758). See HomeWorks Support Center link in Help Section.

Wallboxes: All keypads require a U.S. wallbox. 3 1/2 in (89 mm) deep recommended, 2 1/4 in (57 mm) deep minimum.

RF Device Placement: For reliable performance in a system, this device should be placed within 25 ft (7.6 m) of two additional compatible wireless devices, such as HomeWorks Sunnata products and the HomeWorks Processor. For more information and a full list of compatible wireless devices please refer to the Wireless Setup guide, which can be found in the HomeWorks Support Center link in the HELP Section.

System Programming: Programming and activation (addressing) must be accomplished through the HomeWorks software.

Raise/Lower Default: Raise/lower the last button pressed.

3 Wire control

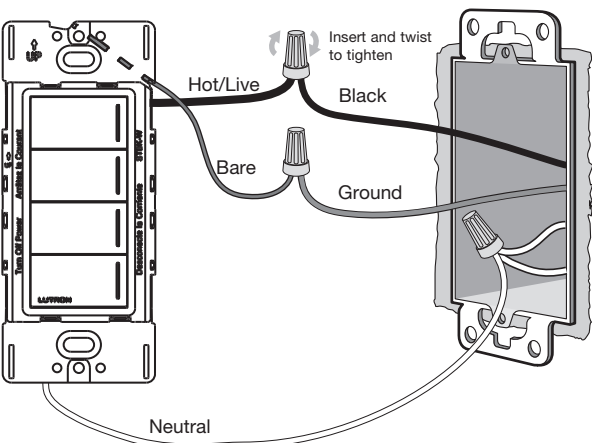

4 Mount wall plate adapter

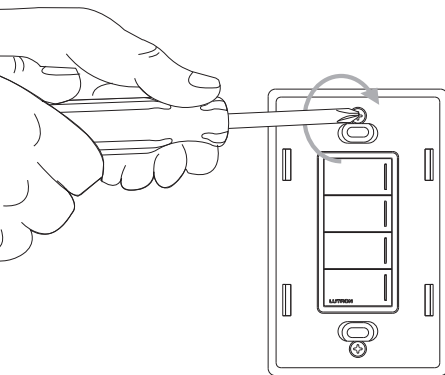

5 Mount dimmer and attach wall plate

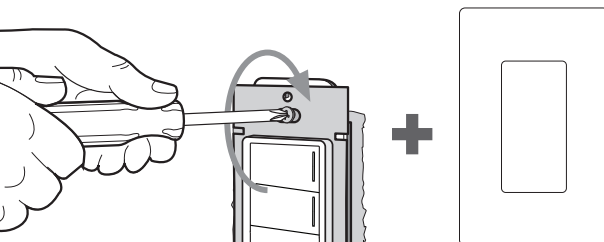

6 Turn power ON at circuit breaker

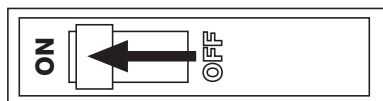

7 System setup

This keypad must be used in a HomeWorks system with a main repeater for control of dimmers, switches, and shades. Use the HomeWorks programming software to setup the system (training required to access the software).

Troubleshooting

| Symptom | Cause | Action |
|--|--|---|
| LEDs on the keypad don't light up when buttons on it are pressed. | Power not present at keypad | Circuit breaker OFF. Turn ON breaker |
| | Incorrect wiring | Wire the keypad according to the Installation section |
| A specific dimmer, switch or shade/drapery is not controlled when a button is pressed on the keypad. | The dimmer, switch or shade/drapery is not assigned to the keypad | Refer to the HomeWorks programming software and ensure the device is assigned to the keypad. Perform a transfer and make sure it is successful |
| | Failure has occurred on the lamp(s) controlled by the dimmer/switch | Replace the lamp(s) |
| | There is no power to the dimmer, switch, shade/drapery | Ensure that the device is powered and that the FASS switch is pushed in |
| Dimmer, switch or shade/drapery does not go to the desired level or position when a button on the keypad is pressed. | Devices are out of range | Ensure this device is placed within 25 ft (7.6 m) of two additional compatible wireless devices, such as HomeWorks Sunnata products and the HomeWorks processor |
| | The button was not programmed correctly | Refer to the HomeWorks programming software and ensure the device is assigned to the keypad. Perform a transfer and make sure it is successful |
| All LEDs on the keypad flash when any button is pressed. | Devices are out of range | Ensure this device is placed within 25 ft (7.6 m) of two additional compatible wireless devices, such as HomeWorks Sunnata products and the HomeWorks processor |
| | The keypad is in the Factory Settings mode and has not been configured to work in a system | Refer to the HomeWorks programming software and ensure the device is assigned to that keypad. Perform a transfer and make sure it is successful |

Note: Refer to the system setup guide for additional troubleshooting suggestions.

Return to Factory Settings

Note: Returning a keypad to its factory settings will remove the keypad from the system and erase all programming.

Step 1: Triple tap any button on the keypad (except raise/lower). DO NOT release after third tap.

Step 2: Keep the button pressed on the third tap until all the status LEDs start to flash slowly (approximately 3 seconds).

Step 3: Immediately release the button and triple tap the button again. The status LEDs on the keypad will flash quickly.

The keypad has now been returned to its factory settings.

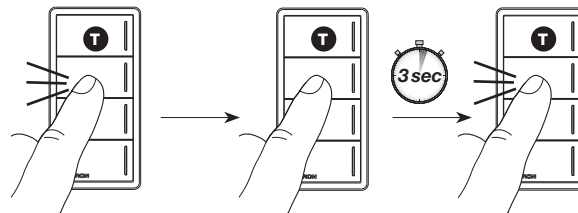

FCC/IC/IFT Information

This device complies with part 15 of the FCC Rules and Industry Canada license-exempt RSS standard(s). Operation is subject to the following two conditions:

- (1) This device may not cause interference, and
- (2) This device must accept any interference, including interference that may cause undesired operation. Modifications not expressly approved by Lutron Electronics Co., Inc. could void the user's authority to operate this equipment.

NOTE: This equipment has been tested and found to comply with the limits for a Class B digital device, pursuant to part 15 of the FCC Rules. These limits are designed to provide reasonable protection against harmful interference in a residential installation. This equipment generates, uses and can radiate radio frequency energy and, if not installed and used in accordance with the instructions, may cause harmful interference to radio communications. However, there is no guarantee that interference will not occur in a particular installation. If this equipment does cause harmful interference to radio or television reception, which can be determined by turning the equipment off and on, the user is encouraged to try to correct the interference by one or more of the following measures:

- Reorient or relocate the receiving antenna
- Increase the separation between the equipment and receiver
- Connect the equipment into an outlet on a circuit different from that to which the receiver is connected
- Consult the dealer or an experienced radio/TV technician for help.

This equipment complies with FCC radiation exposure limits set forth for an uncontrolled environment. The user should avoid prolonged exposure within 20cm of the antenna, which may exceed FCC radio frequency exposure limits.

This Class B digital apparatus complies with Canadian ICES-003.

RadioRA3 SUNNATA

Keypad

P/N 044373 REV A

Please read before installing.

English

RRST-W2B, RRST-W3RL & RRST-W4B
120-277 V~ 50/60 Hz 0.25 A

Included Components

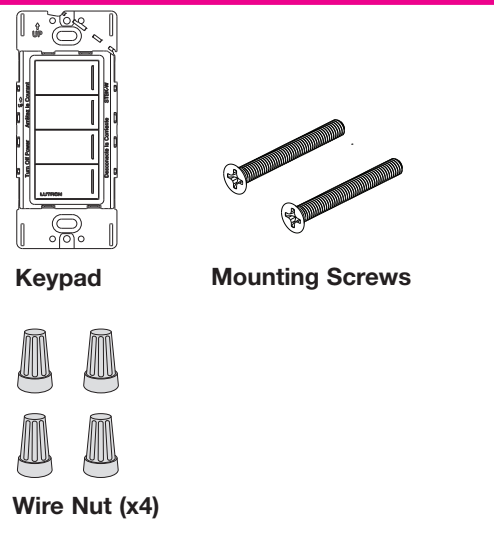

1 Turn power OFF at circuit breaker

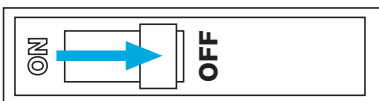

WARNING: ELECTRIC SHOCK HAZARD.
May result in Serious Injury or Death. Turn off power at circuit breaker or fuse before installing.

2 Prepare wires

When making wire connections, follow the recommended strip lengths and combinations for the supplied wire connectors. Note: Wire connectors provided are suitable **for copper wire only**.

| AWG | Strip Length |
|--|-----------------|
| 12 & 14 AWG (2.5 & 1.5 mm ²) | 3/8 in (10 mm) |
| 18 AWG (0.75 mm ²) | 7/16 in (11 mm) |

IMPORTANT

Codes: Install in accordance with all local and national electrical codes.

Environment: Ambient operating temperature: 32 °F to 104 °F (0 °C to 40 °C), 0 to 90% humidity, non-condensing. Indoor use only.

Wallplates: Use only Lutron wallplates with these keypads. The mechanical design of the keypad **MAY NOT** be compatible with non-Lutron wallplates. Non-Lutron wallplates **MAY NOT** sit flush against the wall. Claro and Satin Colors wallplates are designed for best color match and clean aesthetic appearance. Do not paint controls, buttons, or wallplates.

Cleaning: For disinfecting keypad, please refer to App Note #758 (048758). See RA3 Support Center link in **Help** Section.

Wallboxes: All keypads require a U.S. wallbox. 3 1/2 in (89 mm) deep recommended, 2 1/4 in (57 mm) deep minimum.

RF Device Placement: For reliable performance in a system, this device should be placed within 25 ft (7.6 m) of two additional compatible wireless devices, such as RadioRA 3 Sunnata products and the RadioRA 3 processor. For more information and a full list of compatible wireless devices please refer to the Wireless Setup guide, which can be found in the RA3 Support Center link in the **HELP** Section.

System Programming: Programming and activation (addressing) must be accomplished through the RadioRA 3 software.

Raise/Lower Default: Raise/lower the last button pressed.

3 Wire control

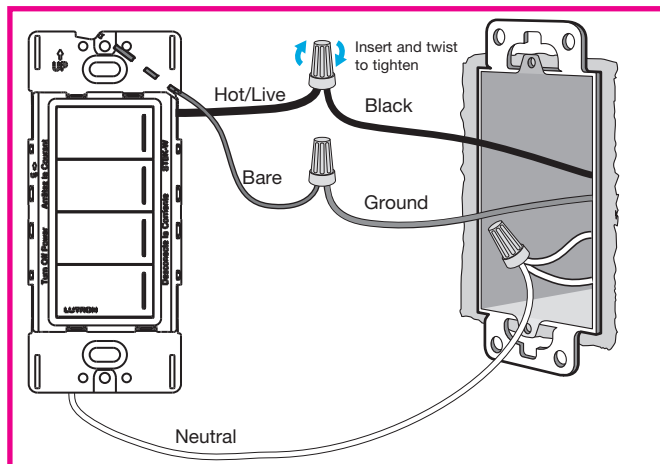

4 Mount wallplate adapter

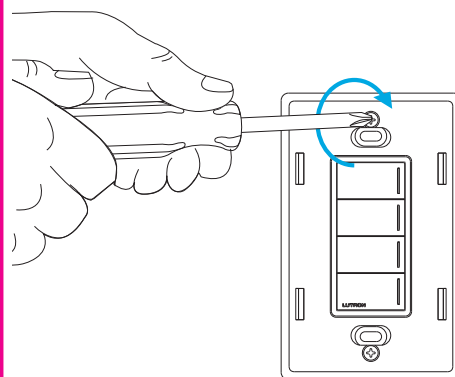

5 Mount keypad and attach wallplate

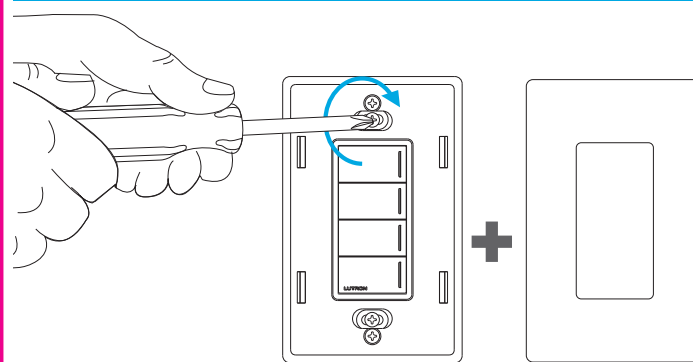

6 Turn power ON at circuit breaker

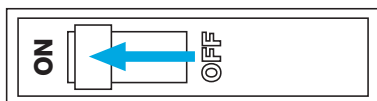

7 System setup

This keypad must be used in a RadioRA 3 system with a main repeater for control of dimmers, switches, and shades. Use the RadioRA 3 programming software to setup the system (training required to access the software).

Troubleshooting

| Symptom | Cause | Action |
|--|--|---|
| LEDs on the keypad don't light up when buttons on it are pressed. | Power not present at keypad | Circuit breaker OFF. Turn ON breaker |
| | Incorrect wiring | Wire the keypad according to the Installation section |
| A specific dimmer, switch or shade/drapery is not controlled when a button is pressed on the keypad. | The dimmer, switch or shade/drapery is not assigned to the keypad | Refer to the RadioRA 3 programming software and ensure the device is assigned to the keypad. Perform a transfer and make sure it is successful |
| | Failure has occurred on the lamp(s) controlled by the dimmer/switch | Replace the lamp(s) |
| | There is no power to the dimmer, switch, shade/drapery | Ensure that the device is powered and that the FASS switch is pushed in |
| Devices are out of range | Devices are out of range | Ensure this device is placed within 25 ft (7.6 m) of two additional compatible wireless devices, such as RadioRA 3 Sunnata products and the RadioRA 3 processor |
| Dimmer, switch or shade/drapery does not go to the desired level or position when a button on the keypad is pressed. | The button was not programmed correctly | Refer to the RadioRA 3 programming software and ensure the device is assigned to the keypad. Perform a transfer and make sure it is successful |
| | Devices are out of range | Ensure this device is placed within 25 ft (7.6 m) of two additional compatible wireless devices, such as RadioRA 3 Sunnata products and the RadioRA 3 processor |
| All LEDs on the keypad flash when any button is pressed. | The keypad is in the Factory Settings mode and has not been configured to work in a system | Refer to the RadioRA 3 programming software and ensure the device is assigned to that keypad. Perform a transfer and make sure it is successful |

Note: Refer to the system setup guide for additional troubleshooting suggestions.

Return to factory settings

Note: Returning a keypad to its factory settings will remove the keypad from the system and erase all programming.

Step 1: Triple tap any button on the keypad (except raise/lower). DO NOT release after third tap.

Step 2: Keep the button pressed on the third tap until all the status LEDs start to flash slowly (approximately 3 seconds).

Step 3: Immediately release the button and triple tap the button again. The status LEDs on the keypad will flash quickly.

The keypad has now been returned to its factory settings.

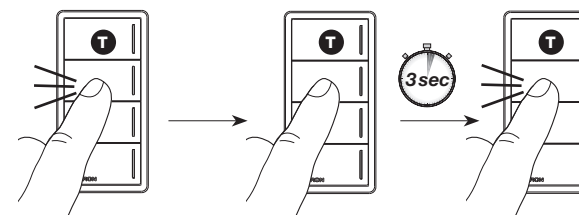

FCC/IC/IFT Information

This device complies with part 15 of the FCC Rules and Industry Canada license-exempt RSS standard(s). Operation is subject to the following two conditions:

- (1) This device may not cause interference, and
- (2) This device must accept any interference, including interference that may cause undesired operation. Modifications not expressly approved by Lutron Electronics Co., Inc. could void the user's authority to operate this equipment.

NOTE: This equipment has been tested and found to comply with the limits for a Class B digital device, pursuant to part 15 of the FCC Rules. These limits are designed to provide reasonable protection against harmful interference in a residential installation. This equipment generates, uses and can radiate radio frequency energy and, if not installed and used in accordance with the instructions, may cause harmful interference to radio communications. However, there is no guarantee that interference will not occur in a particular installation. If this equipment does cause harmful interference to radio or television reception, which can be determined by turning the equipment off and on, the user is encouraged to try to correct the interference by one or more of the following measures:

- Reorient or relocate the receiving antenna
- Increase the separation between the equipment and receiver
- Connect the equipment into an outlet on a circuit different from that to which the receiver is connected
- Consult the dealer or an experienced radio/TV technician for help.

This equipment complies with FCC radiation exposure limits set forth for an uncontrolled environment. The user should avoid prolonged exposure within 20cm of the antenna, which may exceed FCC radio frequency exposure limits.

This Class B digital apparatus complies with Canadian ICES-003.

Help

Sunnata Support Center

For additional support in installing, programming, and troubleshooting



lutron.com/RA3support

Call us:

U.S.A. | Canada | Caribbean
1.844.LUTRON1 (588.7661) (24/7)
Mexico
+1.888.235.2910
Others
+1.610.282.3800

Limited Warranty:

For warranty information, please see the warranty enclosed with the product, or visit www.lutron.com/resiinfo

For FCC/IC information:

Please visit: www.lutron.com/fcc-ic

©Lutron, Lutron, RadioRA, Claro, Satin Colors, Sunnata and Pico are trademarks or registered trademarks of Lutron Electronics Co., Inc. in the US and/or other countries.

App Store is a service mark of Apple Inc., registered in the U.S. and other countries.

All other product names, logos, and brands are property of their respective owners.

©2020 Lutron Electronics Co., Inc.

French translation of the IC information

Information de la FCC/IC

Ce dispositif est conforme à la section 15 des règlements du FCC et des standards CNR exempt de licence d'Industrie Canada. L'opération est sous réserve des deux conditions suivantes :

(1) Cet appareil ne peut causer d'interférence nuisible, et

(2) Cet appareil doit tolérer toute interférence, même celle pouvant affecter son fonctionnement. Tout changement ou modification sans l'autorisation expresse de Lutron Electronics Co., Inc. pourrait annuler le droit d'utiliser cet équipement.

REMARQUE : Cet équipement a été testé et jugé conforme aux limites applicables aux dispositifs numériques Classe B, conformément à la section 15 des règles de la FCC. Ces limites sont conçues pour procurer une protection raisonnable contre les perturbations nuisibles en application résidentielle. Cet équipement génère, utilise et peut radier l'énergie de fréquences radiophoniques. S'il n'est pas installé et utilisé selon les directives, peut causer des interférences radiophoniques nuisibles. Cependant, il n'y a aucune garantie à l'effet qu'aucune interférence ne se produira dans une installation précise. Si votre équipement produit de l'interférence à la réception radiophonique ou télévisuelle, ce qui peut être détecté en coupant et refermant l'alimentation au système d'éclairage. Dans le cas d'interférence, l'utilisateur sera contraint d'essayer de corriger la situation par un ou plusieurs des moyens suivants :

- Réorienter ou re-localiser l'antenne de réception
- Augmenter la distance séparant l'équipement et le récepteur
- Brancher l'équipement sur un circuit différent que celui sur lequel le récepteur est branché
- Demander l'aide du distributeur ou d'un technicien expérimenté en radio et télévision

Cet équipement est conforme aux limites d'exposition aux radiations de la FCC définies pour un environnement non contrôlé. L'utilisateur doit éviter une exposition prolongée à moins de 20 cm de l'antenne, qui peut dépasser les limites d'exposition aux fréquences radio de la FCC.

Cet appareil numérique de la classe B est conforme à la norme NMB-003 du Canada.