

## Installation Instructions

*Please Read Before Installing*

### RF Tabletop Keypads

#### HRT-

5KP-A, -C 10KP-A, -C 15KP-A, -C 6LKP-A, -C

5RL-A, -C 10RL-A, -C 15RL-A, -C 6LRL-A, -C

120/127 V ~, 50/60 Hz (9 V ⎓ adapter, -A and -C models)

Batteries: 2 AAA size, 1.5V each (-C models)

### Overview

RF Tabletop Keypads are for use with *HomeWorks* systems. The keypad buttons are programmed with a personal computer using the *HomeWorks* Utility.

Up to 32 keypads, each with a unique address, can be assigned to each *HomeWorks* RF Processor.

### Important Notes

**Codes:** Install in accordance with all local and national electrical codes.

**Power:** *Battery-powered models (-C only):* Use only high quality alkaline batteries, two (2) size AAA, 1.5V each.



**Caution - Do not** use rechargeable batteries. Using improperly rated batteries could damage the RF Tabletop Keypad.

*All models (-A, -C):* Use only the adapter provided by Lutron with your RF Tabletop Keypad.



**Caution -** Using an adapter not rated for the following specifications could damage the keypad and possibly overheat the adapter.

- Input: 120/127 VAC, 50/60 Hz
- Output: 9 VDC/300 mA Class 2

**Environment:** Ambient operating temperature: 32-104°F (0-40°C), 0-90% humidity, non-condensing. Indoor use only.

**Faceplates:** Do not paint controls or faceplates.

**Cleaning:** To clean, wipe with a clean damp cloth. **DO NOT** use any chemical cleaning solutions.

**RF Device Placement:** RF Tabletop Keypads must be located within 30 feet (10m) of an RF Signal Repeater or an RF Processor.

**Setup:** RF Tabletop Keypads will not function until they are addressed and programmed. See the *HomeWorks* Utility online help.

HRT-5KP

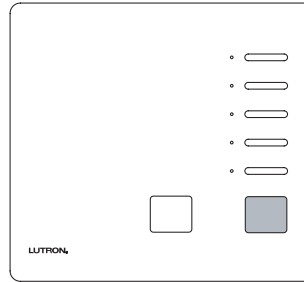

HRT-5RL

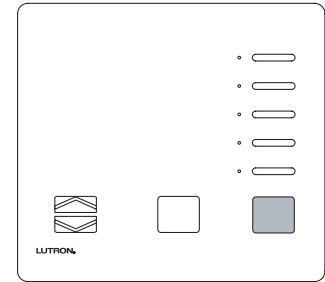

HRT-10KP

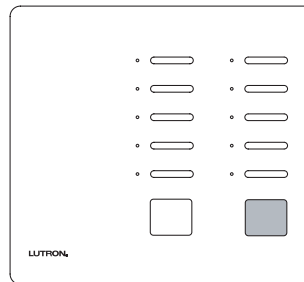

HRT-10RL

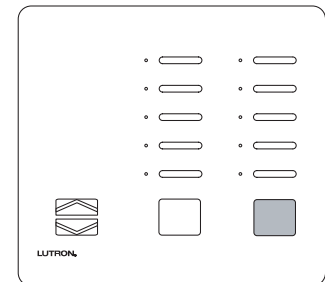

HRT-15KP

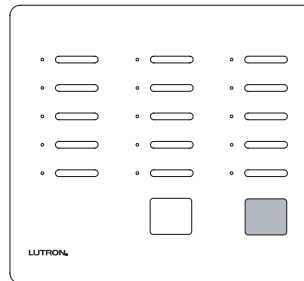

HRT-15RL

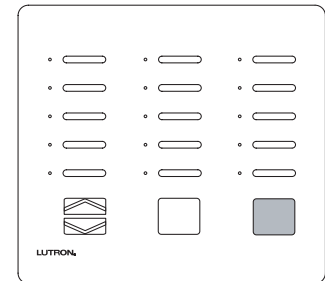

HRT-6LKP

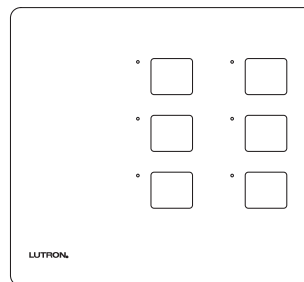

HRT-6LRL

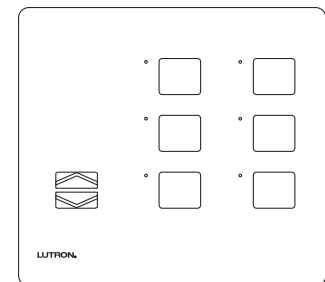

## Installation

### Battery Installation (-C Models)

1. Remove battery cover.

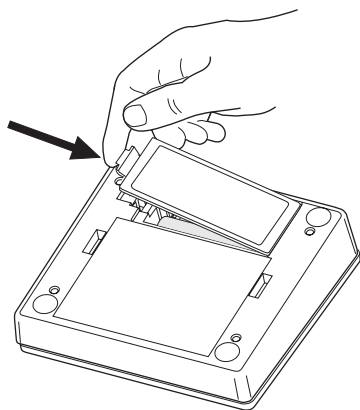

2. Install batteries as shown. Use two 1.5V AAA alkaline batteries only.

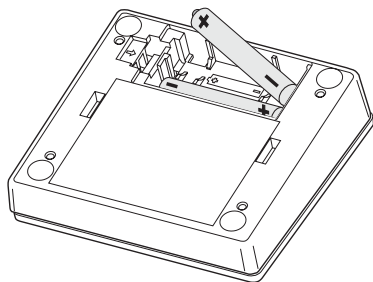

Refer to battery installation diagram molded inside battery compartment.

3. Replace battery cover.

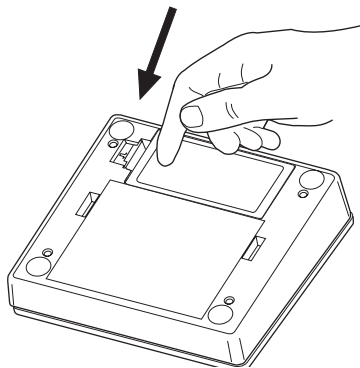

#### Note: Battery-powered models only

- The RF Tabletop Keypad goes to “sleep” after a short period of inactivity.
- Press any button to “wake up” the keypad.

### Adapter Installation (All Models)

1. Find a suitable location for the RF Tabletop Keypad. Place the keypad in a convenient and accessible location. **Note:** RF Keypads must be located within 30 feet (10m) of an RF Signal Repeater or an RF Processor.
2. Apply power to the RF Tabletop Keypad.

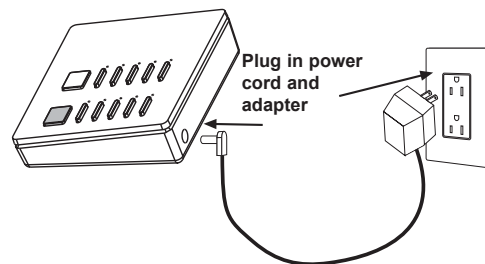

### Mounting Diagram

RF Tabletop Keypads may be wall mounted using the supplied wall bracket.

1. Attach wall bracket to wall using the supplied screws and wall anchors.

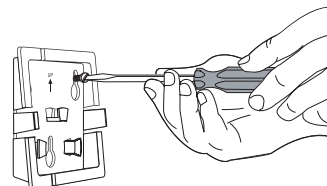

2. Wrap excess adapter cord (if using) around the cord holder. Align keypad and snap onto wall bracket.

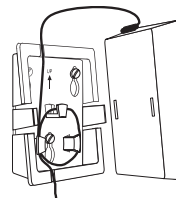

---

## Troubleshooting Guide

RF Keypads will not control other system devices until the keypads are addressed and programmed. See the HomeWorks® Utility online help.

Symptom	Cause and Action
LEDs on an adapter-powered keypad do not light.	No power available to keypad. <ul style="list-style-type: none"><li>• Verify adapter is plugged in.</li></ul> Faulty adapter. <ul style="list-style-type: none"><li>• Replace adapter.</li></ul>
A battery-powered keypad will not “wake up” when a button is pressed.	Dead, low, or no batteries in keypad. <ul style="list-style-type: none"><li>• Replace the batteries.</li></ul> Batteries are incorrectly installed. <ul style="list-style-type: none"><li>• Install batteries as indicated inside the keypad.</li></ul> Batteries are not making contact with the battery terminals. <ul style="list-style-type: none"><li>• Adjust the batteries so they make contact with the terminals.</li></ul>
A battery-powered keypad “wakes up” but goes to “sleep” quickly after a button press.	Batteries are low. <ul style="list-style-type: none"><li>• Replace the batteries.</li></ul>
A battery-powered keypad’s LEDs cycle up and down during “wake up”, but the system lights do not respond to button presses.	Keypad is out of system communications range. <ul style="list-style-type: none"><li>• Move the keypad to within 30 ft. (10m) of an RF Signal Repeater or RF Processor.</li></ul> Button being pressed has not been programmed. <ul style="list-style-type: none"><li>• See the <i>HomeWorks</i> Utility online help for programming details.</li></ul>
Button presses on keypad cause the keypad to <i>quickly</i> flash all its LEDs simultaneously.	Keypad has not been addressed. <ul style="list-style-type: none"><li>• See the <i>HomeWorks</i> Utility online help for setup details.</li></ul>
Button presses on keypad cause the keypad to <i>slowly</i> flash all its LEDs simultaneously.	Keypad has an address, but does not have a valid programming database. <ul style="list-style-type: none"><li>• See the <i>HomeWorks</i> Utility online help for programming details.</li></ul>

---

## FCC Information

**Note:** This equipment has been tested and found to comply with the limits for a Class B digital device, pursuant to Part 15 of the FCC rules. These limits are designed to provide reasonable protection against harmful interference in a residential installation. This equipment generates, uses and can radiate radio frequency energy and, if not installed in accordance with the instructions, may cause harmful interference to radio communications. However, there is no guarantee that interference will not occur in a particular installation. If this equipment does cause harmful interference to radio or television reception, which can be determined by turning the equipment off and on, the user is encouraged to try to correct the interference by one or more of the following measures:

- Reorient or relocate the receiving antenna.
- Increase the separation between the equipment and receiver.
- Connect the equipment into an outlet on a circuit different from that to which the receiver is connected.
- Consult the dealer or an experienced radio/TV technician for help.

**Caution:** Changes or modifications not expressly approved by Lutron Electronics Co. could void the user's authority to operate this equipment.

## Industry Canada Information

The term "IC:" before the radio certification number only signifies that Industry Canada technical specifications were met.

## Technical and Sales Assistance

If you need assistance, call the toll-free **Lutron Technical Support Center**. Please provide exact model number when calling.

(800) 523-9466 (U.S.A., Canada and the Caribbean)

Other countries call:

Tel: (610) 282-3800

Fax: (610) 282-3090

Visit our Web site at [www.lutron.com](http://www.lutron.com)

## LIMITED WARRANTY

Lutron will, at its option, repair or replace any unit that is defective in materials or manufacture within two years after purchase. For warranty service, return unit to place of purchase or mail to Lutron at 7200 Suter Rd., Coopersburg, PA 18036-1299, postage pre-paid. Telephone the Lutron Technical Support Center toll free at 800-523-9466. After the two year period, a pro-rated warranty applies to this product until eight years after the purchase. For more information regarding this warranty contact your Lutron representative.

**THIS WARRANTY IS IN LIEU OF ALL OTHER EXPRESS WARRANTIES, AND THE IMPLIED WARRANTY OF MERCHANTABILITY IS LIMITED TO TWO YEARS FROM PURCHASE. THIS WARRANTY DOES NOT COVER THE COST OF INSTALLATION, REMOVAL OR REINSTALLATION, OR DAMAGE RESULTING FROM MISUSE, ABUSE, OR IMPROPER OR INCORRECT REPAIR, OR DAMAGE FROM IMPROPER WIRING OR INSTALLATION. THIS WARRANTY DOES NOT COVER INCIDENTAL OR CONSEQUENTIAL DAMAGES. LUTRON'S LIABILITY ON ANY CLAIM FOR DAMAGES ARISING OUT OF OR IN CONNECTION WITH THE MANUFACTURE, SALE, INSTALLATION, DELIVERY, OR USE OF THE UNIT SHALL NEVER EXCEED THE PURCHASE PRICE OF THE UNIT.**

This warranty gives you specific legal rights, and you may also have other rights which vary from state to state. Some states do not allow limitations on how long an implied warranty lasts, so the above limitation may not apply to you. Some states do not allow the exclusion or limitation of incidental or consequential damages, so the above limitation or exclusion may not apply to you.

This product may be covered by one or more of the following U.S. patents: 5,248,919; 5,736,965; 5,838,226; 5,905,442; D389,461; D395,037; D422,969; D428,855; D436,579 and corresponding foreign patents. U.S. and foreign patents pending. Lutron and HomeWorks are registered trademarks of Lutron Electronics Co., Inc.  
© 2003 Lutron Electronics Co., Inc.