

## Troubleshooting

| Symptom                                     | Possible Cause  | Solution  |
|---|---|---|
| A Master Control appears not to be working. | <ul style="list-style-type: none"><li>• No power available to unit.</li><li>• Master Control is not programmed into the system.</li></ul> | <ul style="list-style-type: none"><li>• Ensure power is turned on.</li><li>• See Activating Controls in the RadioRA® Setup Guide.</li></ul> |

## English

# RadioRA®

## Installation Instructions for Large Button Wall-Mounted Master Controls

### Please Leave for Occupant

P R E L I M I N A R Y

## Large Button Wall-Mounted Master Control

RALB-2W-SD, RALB-5W-AO, RALB-5W-RL  
RBLB-2W-SD, RBLB-5W-AO, RBLB-5W-RL

120/127 V ~ 50/60Hz

Read all instructions completely before installation.

### Important Notes

 **Note:** Do not use non-Lutron wallplates with these devices.

1. Install in accordance with all national and local electrical codes.
2. A neutral wire connection is required for the Wall-Mounted Master control.
3. Do not paint controls or wallplates.
4. **Clean with a soft damp cloth only.** Do not use any chemical cleaners.
5. Operate in ambient temperatures between 0°C (32°F) and 40°C (104°F).
6. Recommended wallbox depth is 2 1/2 in. minimum.
7. The range and performance of the RadioRA System is highly dependent on a variety of complex factors such as:
  - Distance between system components
  - Geometry of the home
  - Construction of walls separating system components
  - Electrical equipment located near system components
8. Do not mix RadioRA “A” and “B” frequency products within the same system. Products with different frequencies **are not** compatible.

## Table of Contents

### Installation



### Operation of the Master Control



**Note:** Request Application Note #41 on how to retrofit a RadioRA Wall-Mounted Master Control into an existing home.

## FCC Information

**Note:** This equipment has been tested and found to comply with the limits for a Class B digital device, pursuant to Part 15 of the FCC rules. These limits are designed to provide reasonable protection against harmful interference in a residential installation. This equipment generates, uses and can radiate radio frequency energy and, if not installed in accordance with the instructions, may cause harmful interference to radio communications. However, there is no guarantee that interference will not occur in a particular installation. If this equipment does cause harmful interference to radio or television reception, which can be determined by turning the equipment off and on, the user is encouraged to try to correct the interference by one or more of the following measures:

- Reorient or relocate the receiving antenna.
  - Increase the separation between the equipment and receiver.
  - Connect the equipment into an outlet on a circuit different from that to which the receiver is connected.
  - Consult the dealer or an experienced radio/TV technician for help.
- Caution: Changes or modifications not expressly approved by Lutron Electronics Co. could void the user's authority to operate this equipment.

## Technical Assistance

If you have questions concerning the installation or operation of this product, call the **Lutron Technical Support Center**. Please provide exact model number when calling.

(800) 523-9466 (U.S.A., Canada, and the Caribbean)  
Other countries call (610) 282-3800  
Fax (610) 282-3090

Visit our web site at [www.lutron.com](http://www.lutron.com)

## Limited Warranty

Lutron will, at its option, repair or replace any unit that is defective in materials or manufacture within one year after purchase. For warranty services, return unit to place of purchase or mail to Lutron at 7200 Suter Rd., Coopersburg, PA 18036-1299, postage pre-paid.

**THIS WARRANTY IS IN LIEU OF ALL OTHER EXPRESS WARRANTIES, AND THE IMPLIED WARRANTY OF MERCHANTABILITY IS LIMITED TO ONE YEAR FROM PURCHASE. THIS WARRANTY DOES NOT COVER THE COST OF INSTALLATION, REMOVAL OR REINSTALLATION, OR DAMAGE RESULTING FROM MISUSE, ABUSE, OR IMPROPER OR INCORRECT REPAIR, OR DAMAGE FROM IMPROPER WIRING OR INSTALLATION. THIS WARRANTY DOES NOT COVER INCIDENTAL OR CONSEQUENTIAL DAMAGES. LUTRON'S LIABILITY ON ANY CLAIM FOR DAMAGES ARISING OUT OF OR IN CONNECTION WITH THE MANUFACTURE, SALE, INSTALLATION, DELIVERY, OR USE OF THE UNIT SHALL NEVER EXCEED THE PURCHASE PRICE OF THE UNIT.**

This warranty gives you specific legal rights, and you may also have other rights which vary from state to state. Some states do not allow limitations on how long an implied warranty lasts, so the above limitation may not apply to you. Some states do not allow the exclusion or limitation of incidental or consequential damages, so the above limitation or exclusion may not apply to you.

These products may be covered under one or more of the following U.S. patents: 4,835,343; 4,924,349; 4,954,788; 5,248,919; 5,399,940; 5,637,990; 5,738,965; 5,798,581; 5,838,226; 5,848,054; 5,905,442; 5,982,103; D422,567; D436,990; D463,742; D466,783; D461,782; D465,480; D465,770; D466,090; D466,091; D466,484; D475,024; D475,025 and corresponding foreign patents. U.S. and foreign patents pending. Lutron, Claro and RadioRA are registered trademarks and Chronos and Saini Color's are trademarks of Lutron Electronics Co., Inc.

© 2003 Lutron Electronics Co., Inc.

Lutron Electronics Co., Inc.

7200 Suter Road

Coopersburg, PA 18036-1299, U.S.A.

Made and printed in the U.S.A. 11703 P/N 044-039 Rev. A

# LUTRON®

## Installation

Installing a Wall-Mounted Master Control in a newly installed wallbox.

### ✓ Check off Steps as completed.

**Step 1** Turn power off at circuit breaker panel or remove fuse from fusebox.

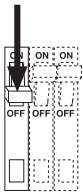

## Important Wiring Information

When making wire connections, follow the recommended strip lengths and combinations for the supplied wire connectors. **Note:** Wire connectors provided are suitable for *copper wire only*. For aluminum wire, consult an electrician.

### Small:

Strip insulation 3/8" for 14 AWG wire  
Strip insulation 1/2" for 16 or 18 AWG wire  
Use to join one 14 AWG supply wire with one 16 or 18 AWG control wire.

### Large:

Strip insulation 1/2" for 10, 12 or 14 AWG wire  
Strip insulation 5/8" for 16 or 18 AWG wire  
Use to join one or two 12 or 14 AWG supply wires with one 10, 12, 14, 16, or 18 AWG control wire.

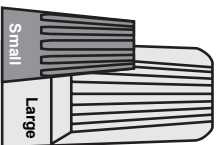

Twist wire connectors for tight.  
**Be sure no bare wire is exposed.**

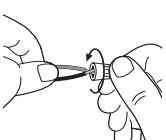

## Step 2 Wire the Control.

Using the wire connectors provided:

- Connect the **black** control wire to the **HOT** wire coming from the breaker panel.
- Connect the **white** control wire to the **NEUTRAL** wire coming from the breaker panel.

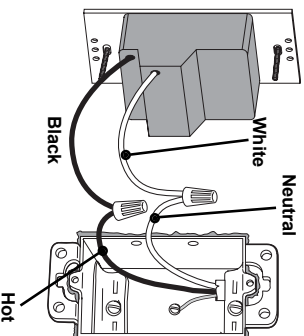

## Wiring Diagram

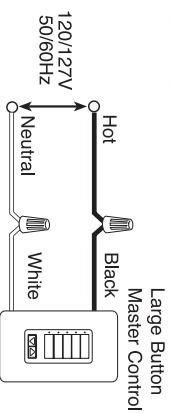

## Step 3

Attach wallplate adapter. Mount and align control. Snap on Claro® or Satin Colors™ wallplate (purchased separately).

Tighten screws until snug.

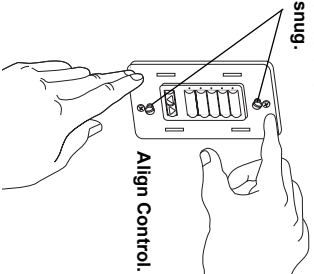

Align Control.

Snap on wallplate.

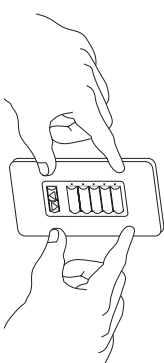

## Step 4

Turn power ON.

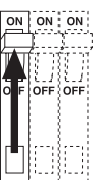

## Operation of the Master Control

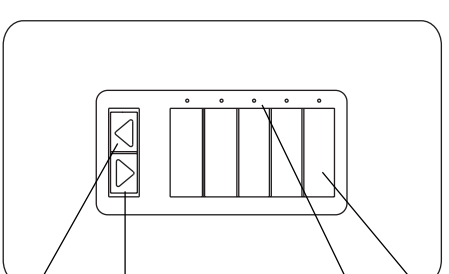

**Button**  
Turns lights on/off.

**LEDs**  
Glow when associated Room or Scene lights are on. Glow dimly as night light when lights are off.

**Raise**  
Brighten ROOM or SCENE lights\*.

**Lower**  
Dim ROOM or SCENE lights\*.

\* To select the ROOM or SCENE button you wish to Raise or Lower, quickly tap that button twice.



**NOTE:** Master Controls will not operate until they have been programmed.

**For detailed instructions on programming your Master Control, refer to the Setup and Installation Guide for a RadioRA® Chronos™ System Bridge and Timeclock that is included with a Chronos or the RadioRA Setup Guide that is included with an RF Signal Repeater.**