

User's Manual (instruction sheet)

RadioRA® Wireless Central Lighting Control

Installation Instructions for Multi-Location Control

Please Leave for Occupant

Before installation read instructions completely.

Important Notes

- 1. Caution:** To avoid overheating and possible damage to other equipment, do not use to control receptacles, fluorescent lighting fixtures, motor-operated or transformer-supplied appliances.
- Install in accordance with all national and local electrical codes.
- Do not paint dimmers or wallplates.
- Do not use where total wattage is under recommended minimum load.

Minimum Load Chart

Type of Dimmer	Dimmer Wattage	
	600W	1000W
Incandescent	50W	50W
Magnetic Low-Voltage	50VA	100VA

- Do not exceed maximum load rating of dimmers.
- In any 3-way/4-way circuit use only one *Dimmer* with up to 9 *Accessory Dimmers*.
- Dimmer may not work with dioded lamps (Sylvania Designer 16™ or Philips PAR-16™).
- Operate in ambient temperatures between 0°C (32°F) and 40°C (104°F).
- Dimmer may feel warm to the touch during normal operation.
- Recommended wallbox depth is 2 1/2" minimum.
- The range and performance of the RadioRA System is highly dependent on a variety of complex factors such as:
 - Distance between system components
 - Geometry of the home
 - Construction of walls separating system components
 - Electrical equipment located near system components

Low-Voltage dimmers only:

- Use "RALV-" models only with core and coil (magnetic) low-voltage transformers. Do not use to control solid-state (electronic) low-voltage transformers.

Incandescent / 120V Halogen

RA-600LM, RB-600LM
RA-1000LM, RB-1000-LM

Magnetic Low-Voltage

RALV-600LM, RBLV-600LM
RALV-1000LM, RBLV-1000LM

Accessory Dimmer

RA-AD

120/127VAC, 50/60Hz

- 13. CAUTION:** Operating a dimmed low-voltage circuit with all lamps inoperative or removed may result in current flow in excess of normal levels. To avoid possible transformer overheating and premature failure, Lutron strongly recommends the following:
 - Do not operate dimmed low-voltage circuits without operative lamps in place.
 - Replace burned-out lamps immediately.
 - Use transformers with thermal protection or fused primary windings to prevent transformer failure due to excess current.

Installation Contents

Single-Location Installation

Installing one RadioRA *Dimmer* to control light(s) from a single location.

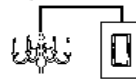

Page 2

Two-Location Installation

Installing one RadioRA *Dimmer* and one *Accessory Dimmer* to control light(s) from two locations.

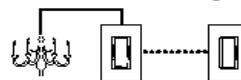

Page 4

Three-Location Installation

Installing one RadioRA *Dimmer* and two *Accessory Dimmers* to control light(s) from three locations.

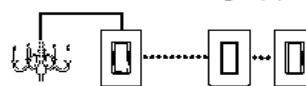

Page 6

Multi-Location Installation

For installations beyond Three-Location, call the *Lutron Technical Assistance Hotline* at 1-800-532-9466.

Operation

Using the RadioRA *Dimmer*.

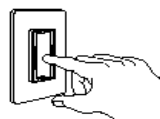

Page 8

LUTRON®

Al reverso en Español

User's Manual (instruction sheet)

Multigang Installations

Lutron Claro® wallplates are available in 1-, 2-, 3- and 4-gang versions. Purchase Claro multigang plates separately. When combining dimmers in the same wallbox, remove all inner side sections prior to wiring. Using pliers, bend side sections up and down until they break off.

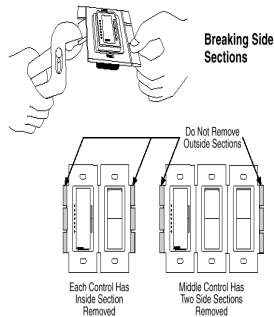

When removing side sections for multigang installations, reduction of the dimmers load capacity is required. See table below.

Model Number	No sides removed	1 side removed	2 sides removed
RA-600LM	600W	500W	400W
RA-1000LM	1000W	800W	650W
RALV-600LM	600VA/450W	500VA/375W	400VA/300W
RALV-1000LM	1000VA/800W	800VA/650W	650VA/500W

Single-Location Installation



For installations involving more than one dimmer in a wallbox, refer to Multigang Installations above before beginning.

✓ Check off Steps as completed.

Step 1 Turn power off at circuit breaker or remove fuse.

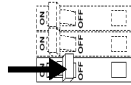

Step 2 Remove wallplate. Pull switch from wall.

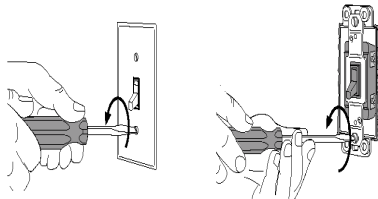

Step 3 Disconnect wires.

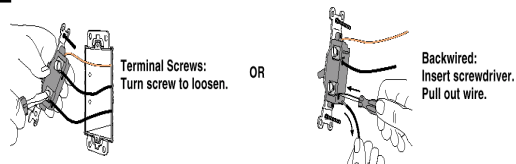

Step 4 Prepare wires. Twist and trim wires to the proper length indicated below when completing Step 5.

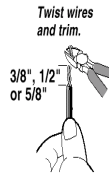

Strip length:
 600W: 3/8" for 14, 16, or 18 gauge
 1000W: 1/2" for 10, 12, or 14 gauge
 5/8" for 16 and 18 gauge
 Note: Wire connectors provided are suitable for copper wire only. For aluminum wire, consult an electrician. Use to join the following combinations:
 600W: One 14 gauge with one 16 or 18 gauge.
 1000W: One or two 12 or 14 gauge with one 10, 12, 14, 16 or 18 gauge.



Twist wire connector tight. Be sure no bare wire is exposed.

Step 5 Wire the Dimmer.

Using the wire connectors provided:

- Connect the Dimmer green ground wire to the green or bare copper ground wire in the wallbox. If there is no ground wire in your wallbox, consult an electrician.
- Connect the Dimmer black wire to either of the wires removed from the switch.
- Connect the Dimmer red wire to the remaining wire removed from the switch.
- Cap off the Dimmer blue wire. It is not needed for a Single Location Installation.

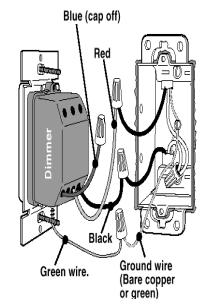

Wiring Diagram

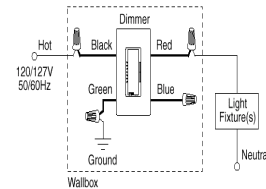

Step 6 Mount and align dimmer. Attach Claro wallplate (purchased separately).

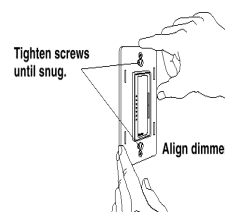

Tighten screws until snug.

Align dimmer.

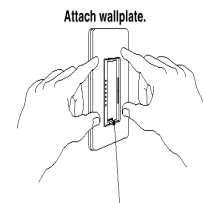

Attach wallplate.

Ensure FASS switch is to the right.

Step 7 Turn power ON.

