

XXXXXXXXXX

User Guide

Contents

.....

Getting Ready

.....

Basic Operations

.....

Safety Precautions

.....

Appendix

.....



Preface

Thank you for buying this product.
Before using the product, be sure to read "User Guide" (this manual) to ensure correct use.
After you have finished reading the manuals, be sure to keep them accessible.

- Reproduction of the content of this manual in part or in whole is prohibited.



memo

- The battery is built into the product.
- Illustrations in this manual are only for reference. They may look different from the actual product.

Operating Instructions

Descriptions of this manual are based on the product switched to Android mode.

"User Guide" (This Manual)

Handles only basic operations for main features.

Regarding Notations Used in This Document

Note on Button Illustrations

In this manual, buttons are simplified as shown below.

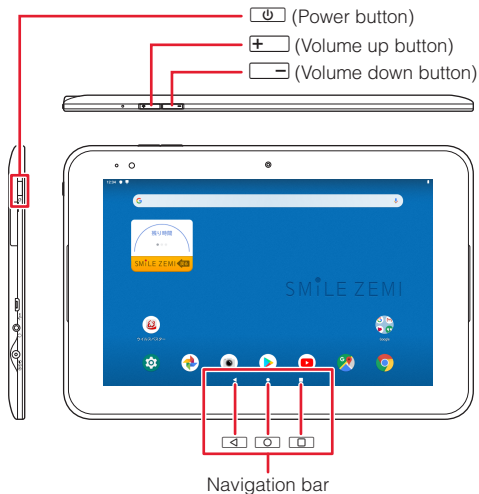

■ Description of Operations for Selecting Item/Icon/Button etc.

Notations used for operation procedures in this manual are as follows.

Description	Explanation
Home screen → [Chrome] → [:]	Tap "Chrome" on the home screen. Tap [:]
In sleep mode, [Power button] (Power button)	In sleep mode, press [Power button] (Power button).

- Tapping is to select a button or icon displayed on the screen by lightly tapping it with your finger.

■ Notes on Illustrations/Screenshots

The illustrations and screenshots in this manual may look different from the actual illustrations or screens. Note that part of the screen etc. may be omitted.

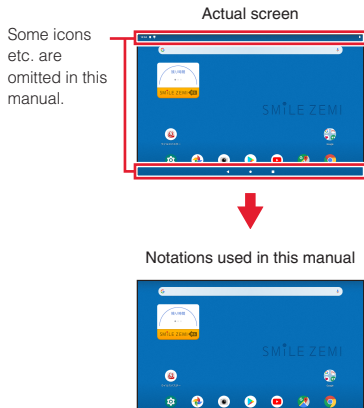



memo

- ◎ In this manual, the operations with horizontally oriented screens are provided as examples. With vertically oriented screens, descriptions for menu item/icon/on-screen button may be different.
- ◎ Menu items, layers and icons described in this manual may be different according to functions being used and conditions.
- ◎ In this manual, "microSD™ memory card (commercially available)", "microSDHC™ memory card (commercially available)", and "microSDXC™ memory card (commercially available)" are abbreviated as "microSD memory card (commercially available)" or "microSD".
- ◎ Company names and product names referred to in this manual are trademarks or registered trademarks of the respective companies. The TM, ® marks may be omitted in this manual.

Contents

Preface.....	1
Operating Instructions.....	1
Regarding Notations Used in This Document.....	1

Contents4

Getting Ready.....5

Names and Functions of Parts	5
Using microSD Memory Card	7
Charging	8
Turning the Power On/Off	10
Using the Touch Panel	11
Initial Settings	12
Setting Wi-Fi®.....	16
Start Screen.....	17

Basic Operations18

Using the Home Screen.....	18
Taking Screenshot	18
Setting Do Not Disturb	18
Setting Home Screen.....	19
Activating the Apps	19
Notification Panel	20
Setting Airplane Mode	21
Setting Functions	21
Setting Battery Saver.....	22

Safety Precautions.....23

When Using the Product.....	23
Safety Precautions (Observe Strictly).....	25
Material List	33
Handling Precautions.....	34
Notes on Using Bluetooth®/Wireless LAN (Wi-Fi®) Function	39

Appendix.....42

Updating Software	42
Troubleshooting.....	43
After-Sales Service	44
Main Specifications.....	45
General Notes.....	46
FCC Compliance Information	49
Simplified EU Declaration of Conformity.....	49
Product Disposal.....	50
Intellectual Property Rights.....	51

Getting Ready

Names and Functions of Parts

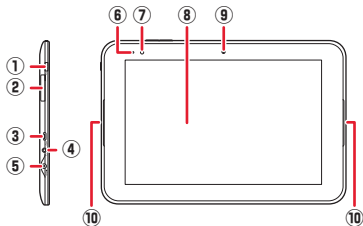

- ① Power button**
Press to power ON/OFF, activate/deactivate sleep mode, etc.
- ② microSD memory card slot cover**
- ③ External connection terminal**
Used for connecting an external connection device, etc.
- ④ Earphone microphone terminal**
Used for connecting earphones (commercially available) or other accessories.
- ⑤ Charging terminal**
Used for connecting the AC adapter.
- ⑥ Notification (charging) light**
The light works as follows.

	Color	Behavior
Power on	Green	Illuminates
On charge	Red	Illuminates
Charge completed	Green	Illuminates
Remaining amount of the battery is 5% below	Red	Flashes

- ⑦ Light sensor**
Detects the ambient light level to adjust the display brightness.
- ⑧ Display (touch panel)**
- ⑨ In camera (lens)**
- ⑩ Speaker**
Outputs notification sounds, alarms, etc.

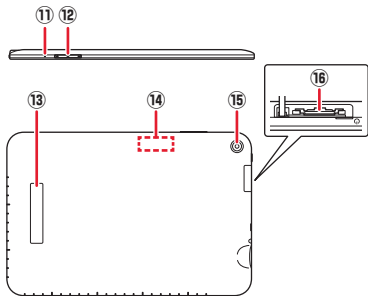

■ How to open the card slot cover



Insert a fingernail a small way into one of the corners marked  and pull open the cover.

⑪ Microphone

⑫ Volume up / down button

Press to adjust volume.

⑬ Name plate sticker

⑭ Built-in Bluetooth® / Wi-Fi® antenna*

⑮ Out camera (lens)

⑯ microSD memory card slot

* The antenna is built into the product. Covering the antenna with your hand might affect communication quality.



memo

- The exterior case of the product is not removable. Removing the exterior case with force may cause damage or malfunction.
- The battery is built into the product and it is not removable. To force stop and reboot the product, refer to "Forcing the Product to Shut Down and Restart" (▶ P.10).

Using microSD Memory Card

Attaching/Removing microSD Memory Card

■ Attaching microSD Memory Card

1 Open the microSD memory card slot cover of the product

2 Confirm the insertion direction of the microSD memory card, and slowly insert it into the slot until it clicks

When inserting the card into the product, confirm the card is locked with snaps. Be aware that the card may fly out if you release your finger before the card is locked. Be careful about it.

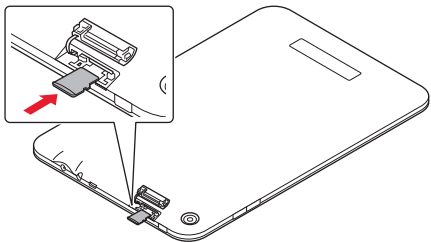

3 Close the microSD memory card slot cover

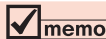

memo

- The microSD memory card has a back and front side/top and bottom orientation. Trying to insert the card forcefully may cause confinement or damage.
- This product supports microSDXC™ memory cards with maximum capacities of 512 GB.

Removing microSD Memory Card

1 Home screen → [⚙️] → [Storage] → [▲]
The card is unmounted.

2 Open the microSD memory card slot cover of the product

3 Slowly push the microSD memory card toward the slot until it clicks

Pull out the microSD memory card with fingers on when you hear "click". Keep your fingers on while the microSD memory card comes out of the slot. Be aware that the card may fly out if you release your finger while pressing hard.

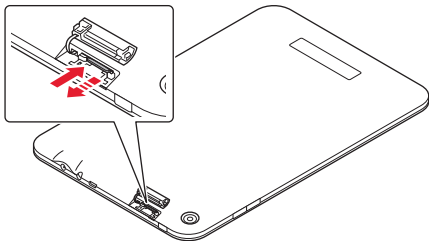

4 Slowly pull the microSD memory card

Slowly pull out the card as straight as possible. Depending on the microSD memory card, it is difficult to pull out from the slot due to the failure of unlocking. In that case, remove the card by pulling lightly with your fingers.

5 Close the microSD memory card slot cover



memo

- Do not touch the terminal part of microSD memory card.
- Do not pull out the microSD memory card forcefully. Doing so might cause a fault or loss of data.
- After using the product for a long time, the removed microSD memory card may become warm. This is not a malfunction.
- When you remove the microSD memory card, be sure to unmount the card properly to prevent data corruption or erasure (▶ P.7).

Charging

The internal battery is not fully charged at the time of purchase. Charge the battery before using the product. When the red light turns into green, the charging will be completed.



memo

- The product may become warm while charging or during other operations, this is not abnormal.
- Charging the product while using the camera function, the charging time may take longer than usual.
- Doing various operations with the AC adapter connected, the battery life may get short due to the short time charging/discharging.
- When temperature of environment or the product is extremely high or low, charging may be stopped even if charging is started. Charge the battery at room temperature as much as possible.
- Make sure the connection is correct if the charging light of the product blinks in red. If the charging light continues to blink, immediately stop charging, and contact the support center on the back cover.
- Right after 100% is displayed on a sleep mode screen while charging, the charging light may not turn to green, but the light will turn to green soon and the charging will be completed.
- Keep a metal accessory or conductive materials (metal pieces, pencil lead, etc.) from coming in contact with the connection terminal and prevent them from getting inside.

Charging with the AC Adapter

How to charge the product using the supplied AC adapter is described here.

- 1 Connect the power plug of the supplied AC adapter to an outlet (100V - 240V AC)**

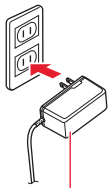

Supplied AC adapter

- 2 Insert the DC plug of the supplied AC adapter to straight into the charging terminal**

Make sure that the charging light turns into red. When the battery power turns on, "E" appears on the status bar.

When charging is complete, the charging light turns into green.

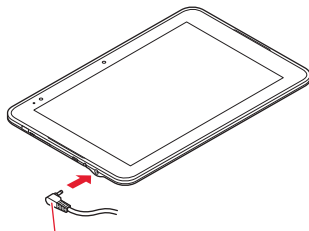

Supplied AC adapter

- 3 When charging is complete, pull out the plug straight from the charging terminal**
- 4 Unplug the power plug of the supplied AC adapter from the outlet**



memo

- ◎ Note that applying unnecessary force with the AC adapter connected to the charging terminal may cause damage.
- ◎ When the battery is charged in the case that the batteries run out, charging light may not turn to green soon, but charging is started.

Turning the Power On/Off

Turning the Power On

- 1 Press and hold  (Power button) until the notification light turns on

The start screen appears (► P. 17).

- For the first time you turn on the product, the initial settings activate. Set them as required.

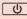

memo

- When logos are being displayed on the screen, do not touch the screen because the initial setting of the touch panel activates. Doing so may prevent the touch panel from working properly.
- Press  (Power button) when the screen is on or turn the screen off with no operation for a certain period, the product enters sleep mode.

Turning the Power Off

- 1 Press and hold  (Power button) for at least 1 second
- 2 [Power off]

Forcing the Product to Shut Down and Restart

You can force the product to power off and reboot when the screen does not respond, or the power cannot be turned off.

- 1 Press and hold  (Power button) and  (Volume up button) at the same time for at least 11 seconds

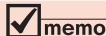

memo

- If you turn off the product forcibly and restart, an unsaved data will be lost. Do not perform except when the product does not respond.

Using the Touch Panel

The product is equipped with a touch panel, allowing you to operate by touching directly the screen with your fingers.

■ Tap/Double-tap

Lightly touch a screen and then immediately release your finger. Tapping a screen twice in the same position is called double-tap.



■ Long-touch

Keep touching an item, button, etc.

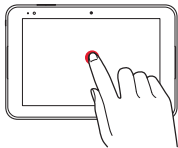

■ Slide/Swipe

While lightly touching the screen, trace it up and down, or sideways in order to view hidden content.

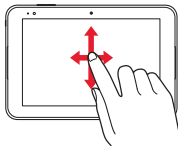

■ Flick

Touch the screen and flick up/down/left/right.

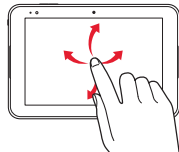

■ Zoom-in/Zoom-out

While touching the screen with two fingers, move the fingers away and closer to each other.

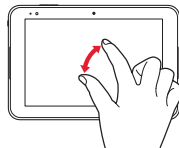

■ Drag

While lightly touching the screen, trace to the desired position.

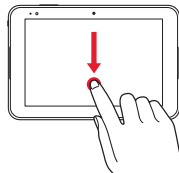

Initial Settings

When you turn on the product for the first time after purchasing the product, follow the on-screen instructions to set language preferences, Wi-Fi®, Google account, and so on.

■ Setting up Google Account

Set up Google account to use Google apps such as "Gmail" and "Play Store".

Setting items are as below (besides the items below, register "First name" and "Last name").

User name	Register your Google account (user ID) and a character string for mail address. You can register a desired name, but a name already registered by another user cannot be set.
Password	Register password for the Google account.

1 Tap [日本語(日本)] → [English] → Select the language region → [START]

- If you use Japanese, leave [日本語(日本)] (Japanese) selected.

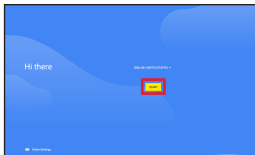

2 Set up the Wi-Fi® network to connect as required

- If you tap "SKIP" → [CONTINUE], an input screen for date & time appears. Set up them and proceed to step 10. From here on, follow the on-screen instructions.



3 Copy apps and data

- To copy, [NEXT] → follow the on-screen instructions.
- To not copy, tap "DON'T COPY".

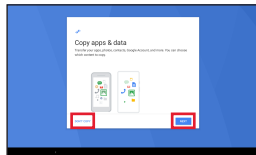

4 [Create account] → [For myself] / [For my child]

- If you have a Google account, enter a mail address or phone number → [Next].



5 Enter "First name" and "Last name" → [Next] → Enter the birthday and gender → [Next] → Enter a user name you want → [Next]

Checking registration of user name starts.

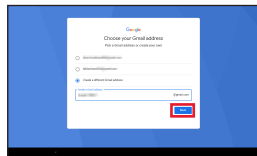
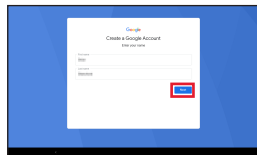

6 Enter a password → Reenter the password for confirmation → [Next]



7 Set up the phone number

- To set up, check the country and enter a phone number → [Yes, I'm in]* → follow on the on-screen instructions.
- To not set up, tap "Skip".
- * Text message for Google verification code will be sent to the set phone number.

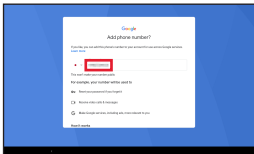

8 Check the contents, then [I agree]



9 Check the contents, then [Next]



10 Confirm the Google service settings → [ACCEPT]

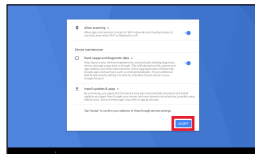

11 Set up the screen lock

- To set up, enter a PIN → [NEXT] → reenter the PIN → [CONFIRM]
- To not set up, tap [SKIP] → [SKIP ANYWAY].

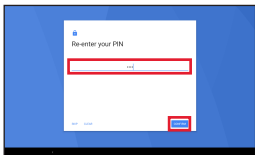
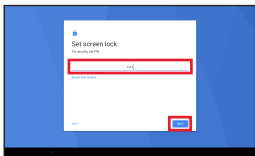

12 Set up the Google Assistant

- To set up, [Turn on] → follow the on-screen instructions.
- To not set up, tap [No Thanks].



13 Set up the Google Pay

- To set up, [Add a card] → follow the on-screen instructions.
- To not set up, tap [Skip].

14 Set up other settings as required

- To set up, make desired settings, return to the previous screen, and tap [DONE FOR NOW].
- To not set up, tap "NO THANKS". After settings are completed, tap [⚙️] to check the settings.

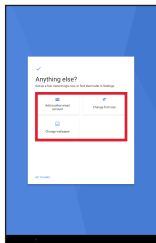

15 Set up the accelerated location

- To set up, check the box → tap [NEXT].
- To not set up, leave the box unchecked → tap [NEXT].

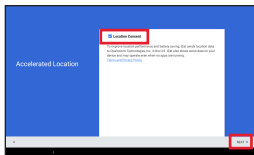

Setting Wi-Fi®

Use your home wireless LAN (Wi-Fi®) or public wireless LAN to connect to the Internet.

1 Home screen → [⚙️]

2 [Network & internet] → [Wi-Fi] → "ON"

Wi-Fi setting screen appears, and available Wi-Fi® networks are listed.

3 Select a Wi-Fi® network to connect → [CONNECT]

- If you connect a security-protected Wi-Fi® network, enter a password (security key)* → [CONNECT]
- * A password (security key) is set up at an access point. For details, contact a network administrator.
- When the connection is completed,  appears in the status bar.

memo

- © The battery is consumed faster when the wireless LAN (Wi-Fi®) function is set to on. You are recommended to turn off the wireless LAN (Wi-Fi®) function when not using it.

Start Screen

The start screen is displayed when you turn the product on or cancel the sleep mode.

Switching to the Home Screen from the Start Screen

You can switch to the home screen with the following operations when the start screen appears.

1 Swipe/flick

The home screen appears (▶P. 18). Or, the previous screen which the product turns to sleep mode appears.

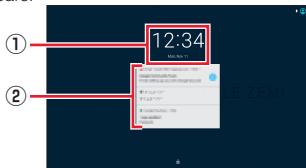

<Start screen>

① Clock display

② Notifications

- Double-tap a notification to activate notified app.

Sleep Mode

Press  (Power button) while the backlight is turned on or perform no operation for a certain period, the screen goes off temporarily and the product enters sleep mode. Doing the following operation, cancel the sleep mode.

1 In sleep mode, press (Power button)

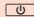

memo

- ◎ To change the time to enter sleep mode, home screen →  → [Display] → [Advanced] → [Sleep], and select the time.
- ◎ When you press  (Power button) to display the screen in sleep mode, do not touch the screen. Doing so may prevent the touch panel from working properly.

Basic Operations

Using the Home Screen

The home screen consists of multiple screens. Slide/flick right or left to switch the screen.

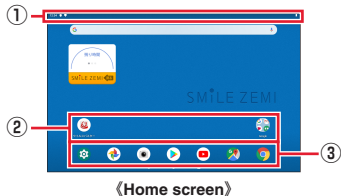

- ① Status bar
- ② Shortcuts/Folders
- ③ Quick launch area

Taking Screenshot

Press (Power button) and (Volume down button) at the same time for at least 1 second to save the currently-displayed screen as image (screenshot). After screenshot is completed, open the notification panel to check the saved image.

memo

- Alternatively, hold down (Power button) for at least 1 second → [Screenshot] to take a screenshot.
- Screenshots are saved to the internal storage. You can check saved screenshots on the "Photos", "Files", and so on.
- Screenshot may not operate depending on an app and function.

Setting Do Not Disturb

Set to Do Not Disturb so as not to disturb others around you in public places.

Setting Do Not Disturb (Vibration)

- 1** Press (Volume up button) or (Volume down button)
 - Volume adjustment bar is displayed.
- 2** []
 - An icon of the bar is switched to [].

Setting Do Not Disturb (Mute)

1 Press  (Volume up button) or  (Volume down button)

- Volume adjustment bar is displayed.

2 [] → []

- An icon of the bar is switched to [].

Setting Home Screen

Set various displays of the home screen.

1 Home screen → Long-touch an empty space

The setting screen of the home screen appears.

2

Home settings	Show Google apps or notification dots on the home screen, and add an icon to the home screen.
Widgets	Add widgets to the home screen.
Wallpapers	Change wallpapers on the home screen.

3 Set the required items

Activating the Apps

Tap an app icon to use its function.

1 Home screen → Tap an app/folder to activate

- If you tap a folder, tap an app to activate from the app list in the folder.

Notification Panel

1 Slide down the status bar

Notification panel is displayed.

- Tap  to hide the notification panel.

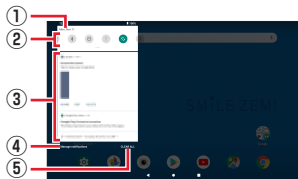

① Date area

② Quick settings tile

Turn on/off frequently-used functions.
Slide down the notification panel to view a hidden tile, brightness adjustment slider, and settings menu icon.

Tap "Edit" to select an icon to display.

③ Information (notification) area

Check the product status and notification. By tapping a notification, the corresponding app activates depending on the information type.

④ Manage notifications

Customize the method of displaying notifications.

⑤ CLEAR ALL

Tap to clear all notifications. However, some notifications cannot be cleared.



memo

- Alternatively, slide up the notification panel to hide the panel.
- To clear a notification individually, flick a notification to be cleared right or left.

Setting Airplane Mode

When Airplane mode is turned on, wireless functions are disabled (packet communication, wireless LAN (Wi-Fi®), and Bluetooth®).

1 Settings menu → [Network & internet] → Tap "🔄" of "Airplane mode" to turn on.

When Airplane mode is turned on, "🔄" appears in the status bar.



memo

- When Airplane mode is turned on, communication such as messaging, wireless LAN (Wi-Fi®), and Bluetooth® are disabled.
- If Airplane mode is turned on, wireless LAN (Wi-Fi®) and Bluetooth® can be turned on. Follow the instructions given by the respective company or institution regarding the use of the product in a plane or hospital.

Setting Functions

Set and manage various functions from the settings menu.

1 Home screen → [⚙️]

The settings menu is displayed.

List of the Settings Menu Items

Items	Settings
[Network & internet]	Set up network such as Wi-Fi® and airplane mode.
Connected devices	Set up devices connected to the product such as Bluetooth® and USB.
Apps & notifications	Make settings of apps and notifications such as checking name, version, and memory usage for an app, turning on/off and uninstalling app, blocking notifications, and selecting notifications to display on a start screen.
Battery	Display remaining level and consuming level of the battery. And also, set up the battery saver, etc.
Display	Make screen display settings such as brightness, screen orientation and font.
Sound	Make sound settings such as Do Not Disturb, vibration, ring sound, notification sound and touch sound.

Items	Settings
Storage	Check memory capacity of the internal storage or microSD memory card, and initialize the microSD memory card.
Security & location	Make settings of location information and security.
Accounts	Manage online service accounts, and make basic settings on data synchronization.
Accessibility	Make accessibility service settings such as text size to be displayed.
Google	Check information on Google account and service, and change settings.
System	Make settings of language for use, character input, date & time. And also, set up backup to Google server, reset the product, and check information on the product. Also, system update is available here.

Setting Battery Saver

Reduce the product's performance, and limit background data.

1 Settings menu → [Battery] → [Battery Saver]

2 [TURN ON NOW]

Battery saver activates. "🔋" appears in the status bar.



memo

- ⊙ Email, messaging, and other apps that rely on syncing may not updated unless it is activated.
- ⊙ Battery saver is turned off automatically while charging.

Safety Precautions

When Using the Product

- Before you start using the product, make sure to read the "Safety Precautions" in this manual to ensure correct use.
 - Use this data communication terminal so that you can hold the product at least 1.5 cm away from your body and also do not contain metal parts between the product and your body.
 - Communication may not be possible in poor reception areas. Communication may be interrupted if you move into poor reception areas during communications.
 - Since this product uses radio waves, the possibility of communication intercepts by third parties cannot be eliminated.
 - Since the product is a radio station under the Radio Law, you may be asked to temporarily submit the product for inspection in accordance with the Radio Law.
 - The Company is not liable for any damages arising from earthquakes, lightning, storms, floods or other natural disasters, as well as fires, actions by third parties, other accidents, intentional or mistaken operation by the customer, or use under other unusual conditions outside the responsibility of the Company.
- The Company is not liable for any incidental damages (change/disappearance of described content, loss of business income, disruption of business, etc.) arising from use or inability to use the product.
 - The Company is not liable for any damages arising from failure to observe the described content of this manual.
 - The Company is not liable for any damages arising, for example, from malfunction caused by combination with connected devices or software not related to the Company.
 - Captured image data or downloaded data may sometimes be altered or lost due to faults, repair or other handling of the product. The Company is not liable for any damage or lost income resulting from recovery of these data.
 - It is recommended you keep a copy of important data in your PC's hard disk, etc. Whatever the cause of the defect or malfunction may be, the Company assumes no responsibility for alteration or loss of saved data.
 - Contents saved in the product, such as contacts, mails and favorites, might be altered or lost by an accident, fault, repair or mishandling. Be sure to keep a copy of important contents. Note that the Company assumes no responsibility for any damages or lost profits resulting from altered or lost contents.

- Note that content data (both charged or free content) saved on the product cannot be returned to the customer when the product is replaced for repair of a fault, for example.
- The product uses liquid crystal for its display. The main display response speed may become slow when the ambient temperature is low, which is due to the characteristics of liquid crystal and is not a malfunction. The main display response speed will return to normal at room temperature.
- Although the display used on the product is made using high-precision technology, some pixels (dots) might be lit or out at all times. This is not a malfunction.
- You are recommended to store copies of individual data such as photos/movies you took and music in your PC by sending each file as mail attachment, etc. Note, however, that you may not be able to make copies of some copyrighted data even by the above-mentioned means.
- Do not discard the product together with regular trash. Please cooperate in the collection of the product when the product is no longer needed to protect the environment and effectively use resources.





memo

- ⊙ Reproduction of the content of this manual in part or in whole is prohibited.
- ⊙ The content of this manual is subject to change without notice.
- ⊙ Some functions may not be available due to OS specification changes, or service changes/end, etc.
- ⊙ Every effort has been made in the preparation of this manual. Should you notice any unclear points, omissions, etc., feel free to contact us.

Safety Precautions (Observe Strictly)

- Before using the product, thoroughly read this "Safety Precautions" for proper use.
- These precautions are intended to protect you and others around you. Read and follow them carefully to avoid injury, damage to the product or damage to property.
- The signs below differentiate between the levels of danger that can occur if the product is not used within the specified guidelines.







 DANGER	This sign denotes that "death or serious injury" ^{*1} may directly result from improper use".
 WARNING	This sign denotes that "death or serious injury" ^{*1} may result from improper use".
 CAUTION	This sign denotes that "minor injury" ^{*2} or damage to property" ^{*3} may result from improper use".

*1 Serious injury: This refers to loss of sight, injury, burns (high- and low-temperature), electric shock, broken bones, injuries with residual aftereffects from poisoning, etc., and injuries requiring hospital admission for treatment or long term hospital attendance as an outpatient.

*2 Minor injury: This refers to injuries, burns (high- and low-temperature), electric shock, etc. that do not require hospital admission for treatment or long-term hospital attendance as an outpatient.

*3 Physical damage: This refers to extended damage to buildings, furniture, livestock, or pets.

Explanation of Graphic Symbols Used in This Manual

	Indicates an action that is not allowed.		Indicates that handling with wet hands is not allowed.
	Indicates that disassembly is not allowed.		Indicates an action based on instructions that must be done.
	Indicates that use in a place where the product is likely to get wet or allowing the product to get wet is not allowed.		Indicates that the power plug must be disconnected from the power outlet.

Precautions Common to the Main Unit, Internal Battery, Charger, Peripheral Devices



 **Do not use, store or leave the product in hot places (e.g. by the fire, near a heater, under a kotatsu or futon, in direct sunlight, in a car in the hot sun).**
Doing so may cause fire, burns, injuries, or electric shock.

 **Do not put the product into or near a heating cooking device such as a microwave oven or IH cooker, or high-pressure container such as a pressure cooker.**
Doing so may cause fire, burns, injuries, or electric shock.

 **Do not put sand, dirt, or mud on the product or put it on them directly. Do not touch the product with hands to which sand or others adhere.**
Doing so may cause fire, burns, injuries, or electric shock.

 **Do not charge when the product is wet with water (drinking water, perspiration, seawater, urine of pet animals, etc.).**
Also, do not charge in places where it comes into contact with water such as a bathroom.
Doing so may cause fire, burns, injuries, or electric shock.

 **Do not subject the product to strong pressure or break the product. Especially when bringing the product putting in a bag, etc., do not let the product hit against surroundings or being put between the objects.**

Doing so may cause fire, burns, or injury due to built-in battery damage.

* Examples to avoid

- Putting the product in a bag and catching them in a door or a door of car
- Stepping on the product on a soft object such as a sofa, bed, or bedding, or on a floor

 **Do not disassemble or modify in that manner.**
Doing so may cause fire, burns, injuries, or electric shock.

 **Do not try to remove the internal battery of the product.**
Doing so may cause fire, burns, or injuries.

 **Do not try to remove the rear cover of the product.**
Doing so may cause fire, burns, or injuries.

 **Do not let the product get wet with water (drinking water, perspiration, seawater, urine of pet animals, etc.).**
Doing so may cause fire, burns, injuries, or electric shock.

 **Do not put water (drinking water, perspiration, seawater, urine of pet animals, etc.) into the charging terminal or the external connection terminal.**
Doing so may cause fire, burns, injuries, or electric shock.



Use the optional products specified by the Company.

Not doing so may cause fire, burns, injuries, or electric shock.

WARNING



Do not drop, trample, or throw the product or give a strong force or vibration to it.

Doing so may cause fire, burns, injuries, or electric shock.



Do not allow conductive materials (metal pieces, pencil lead, etc.) to come in contact with the charging terminal or the external connection terminal, and do not allow dust to get inside.

Doing so may cause fire, burns, injuries, or electric shock.



Do not cover or wrap the product with bedding, etc. while using or charging the product.

Doing so may cause fire or burns.



If charging is not completed after the specified charging time, stop charging.

Overcharging may cause fire, burns, or injuries.



Make sure to turn off the product or stop charging before you get close to places where a flammable gas or dust can be generated.

Ignition of flammable gas may cause an explosion or fire.



Follow the instructions given by the respective institution regarding the use of the product in a gas station.

Do not charge the product in a gas station.

Be careful not to drop the product when using in a gas station. Do not use the product, especially while refueling.

Ignition of flammable gas may cause an explosion or fire.



Perform the following operations while using, charging, or keeping the product if there are odors, noise, smoke, overheating, discoloring, deformation, or other abnormalities.

- Remove the power plug from the wall outlet.
- Turn the product off.

Not doing the above operations may cause fire, burns, injuries, or electric shock.

CAUTION



Do not use the damaged product.

Doing so may cause fire, burns, or injuries.



Do not leave the product on unstable or sloping surfaces.

The product may fall and cause injuries.



Do not use or store the product in humid or dusty places, or places that get hot.

Doing so may cause fire, burns, or electric shock.



When children use the product, do not let them use incorrectly without instruction by an adult for proper use.

Doing so may cause injuries.



Do not store the product within the reach of babies. Especially, be careful where you store small parts.

Doing so may cause accidental swallowing, injuries, or electric shock.



Be careful when using the product continuously or charging as it gets hot. Also, avoid touching the product continuously falling asleep unintentionally.

The product or AC adapter may become hot when using continuously such as applications, data communication, watching videos, or while charging. Depending on your physical predisposition and physical condition, contacting continuously with a high temperature part may cause skin redness, itching, rash, or low-temperature burns.

■ Main Unit



Do not throw the product into fire or apply heat.

Doing so may cause fire, burns, or injuries.



Do not apply excessive force such as sticking a sharp object (nails, etc.) into the product, hitting it with a hard object (hammer, etc.) or stepping on it.

Doing so may cause fire, burns, or injuries.



If the substance inside the main unit comes into contact with your eyes, mouth and so on, immediately rinse the area with clean water, and then see a doctor right away.

Not doing so may cause loss of sight or poor physical condition due to the influence of the substance inside the main unit.



Do not watch a repeatedly flickering screen for a long time.

Doing so may cause muscle spasms or loss of consciousness, etc.



Do not allow water or other liquids (drinking water, perspiration, seawater, urine of pet animals, etc.), metal pieces, flammable material or foreign object into the microSD memory card slot on the product. Do not mistake the slot and direction of the microSD memory card.

Doing so may cause fire, burns, injuries, or electric shock.



Do not expose the camera lens part to direct sunlight for an extended period.

Doing so may cause fire, burns, or injuries by the light-collecting mechanism of the lens part.



Turn off the product or set it to Airplane mode before going aboard an airplane.

Since using the product on airplanes is restricted, follow the instructions given by the respective airlines. The product's signals may adversely affect on-board electronic equipment.

If you commit a prohibited act while using the product on an airplane, you might be punished by law.



Follow the instructions given by the respective medical institution regarding the use of the product in a hospital.

Turn off the product in areas where the use of the product is prohibited.

The product's signals may affect electronic equipment and electronic medical equipment.



If you have a weak heart, be careful about notification sound volume settings.

Sudden notification sound surprises you, it may cause harmful effect on heart.



To use electronic medical equipment, check with electronic medical equipment manufacturer or vendor to determine how devices are affected by radio waves before using.

Not doing so may cause harmful effect on electronic medical equipment, etc.



Turn the product off near high-precision electronic control equipment or electronic equipment using low-power signals.

Not doing so may cause the equipment to fail or malfunction.

* Examples of electronic equipment to avoid
A hearing aid, an implanted pacemaker, an implanted cardioverter-defibrillator, other electronic medical equipment, or other automatic control devices, etc. To use an implanted pacemaker, an implanted cardioverter-defibrillator, or other electronic medical equipment, check with electronic medical equipment manufacturer or vendor to determine how devices are affected by radio waves before using.



When the display or camera lens part is accidentally broken, be careful of broken glass or exposed internal parts of the product.

Not doing so may cause burns, injuries, or electric shock with damaged parts or exposed parts.



If the internal battery leaks or gives off a strange smell, immediately remove the product from the vicinity of open flames.

The battery fluid is flammable and could ignite, causing a fire, explosion, etc.



Be careful not to let your pet bite the product.

May cause the battery to ignite, burst, heat, or leak, and may cause fire, burns, or injuries.

CAUTION



If the display breaks and the fluid leaks out from inside, do not let the fluid contact with the skin on your face or hands, or clothes.

Doing so may cause eye or skin problems.

If the substance inside the display enters your eyes, mouth, and so on, or comes into contact with your skin or clothes, immediately rinse the area with clean water. If the fluid enters your eyes, mouth, and so on, immediately see a doctor after rinsing.



Do not discard the old product together with regular trash.

Doing so may cause fire, burns, or injuries. Also, may cause environmental disruption. If you dispose of the product, follow the instructions of your local municipality that has a battery recycling program.



If fluid leaks out from the internal battery, do not let the fluid contact with the skin on your face or hands, or clothes.

Doing so may cause eye or skin problems.

If the substance inside the display enters your eyes, mouth, and so on, or comes into contact with your skin or clothes, immediately rinse the area with clean water. If the fluid enters your eyes, mouth, and so on, immediately see a doctor after rinsing.



To use the product in car, check with automobile manufacturer or dealer to determine how vehicle devices are affected by radio waves before using. In rare cases, using the product in some vehicle models can cause the vehicles electronic equipment to malfunction. In that case, stop using the product immediately.



If you develop skin problems, stop using the product immediately, and see a doctor.

Itching, rashes, eczema, etc. sometimes occurs depending on your physical constitution and condition.

For material of each part ▶ P.33 "Material List"



Make sure that there is no adhered metal pieces (cutter blade, staples, etc.) as the speaker part of this product generates magnetism.

Not doing so may cause injuries with adhered metal pieces.



Use the product in a well-lighted area and put some distance between you and the display when watching the display.

Using the product in dark places or near eyes may affect your vision.

Charger

WARNING



Do not use if the cord of the AC adapter is damaged.

Doing so may cause fire, burns, or electric shock.



Do not touch the AC adapter if you hear thunder.

Doing so may cause electric shock.



Do not short the charging terminal while it is connected to an outlet. Do not allow any part of your body such as your hands or fingers to come into contact with the charging terminal.

Doing so may cause fire, burns, or electric shock.



Do not place heavy objects on the cord of the AC adapter, or do not pull the cord with excessive force.

Doing so may cause fire, burns, or electric shock.



When you plug/unplug the AC adapter into/from the outlet, do not contact metal objects with the jack.

Doing so may cause fire, burns, or electric shock.



Do not connect a transformer for overseas travel (travel converter) to the AC adapter.

Doing so may cause ignition, overheating, or electric shock.



Do not apply excessive force on the connection part with the AC adapter connected to the product.

Doing so may cause fire, burns, injuries, or electric shock.



Do not touch the cord, charging terminal or power plug of the AC adapter with wet hands.

Doing so may cause fire, burns, or electric shock.



Use the product at the specified power supply voltage.

When charging the product overseas, use the AC adapter for global use.

Incorrect power supply voltage may cause fire, burns, or electric shock.

AC adapter: 100V AC (Connect to an AC outlet for internal household use)

AC adapter for global use: 100V AC to 240V AC (Connect to an AC outlet for internal household use)



Wipe off dust on the power plug.

Not doing so may cause fire, burns, or electric shock.



Fully plug the AC adapter into the outlet.

Not doing so may cause fire, burns, or electric shock.



When you disconnect the power plug from an outlet, do not pull the cord of the AC adapter with excessive force. Instead, grasp the adapter to disconnect.

Pulling the cord of the AC adapter may damage the cord and cause fires, burns, electric shock, etc.



When plugging/unplugging the AC adapter into/ from the product, do not pull the cord with excessive force. Instead, plug/unplug it straightly toward the jack to connect.

Not doing so may cause fire, burns, injuries, or electric shock.



Stop using the product immediately if you notice deformation of the charging terminal. Also, stop using the product after recovering the original form of the terminal.

Short-circuiting of the charging terminal may cause fire, burns, injuries, or electric shock.



When the AC adapter is not used for a long time, disconnect the power plug from the outlet.

Not doing so may cause fire, burns, or electric shock.



Immediately remove the power plug from the outlet if water or other fluids (drinking water, perspiration, seawater, urine of pet animals, etc.) get on the adapter.

Not doing so may cause fire, burns, or electric shock.



Always remove the power plug from an outlet when cleaning the equipment.

Not doing so may cause fire, burns, or electric shock.

CAUTION



Do not keep touching the AC adapter when connected to an outlet.

Doing so may cause burns.

■ Use near Medical Instruments and inside Medical Facilities

WARNING



Wearers of medical equipment such as implanted pacemakers or defibrillators must carry and use the product at least 15 cm away from the implanted device. Radio waves may affect the performance of electronic medical equipment.



When using electronic medical devices as home medical treatment other than an implanted pacemaker and an implanted cardioverter defibrillator outside medical facilities, check individually with the manufacturer of the electronic medical equipment regarding the influence of radio waves.

Radio waves may affect the performance of electronic medical equipment.



Make sure that the product will not emit any signals (turn off power, put it in Airplane mode, etc.) if within 15 cm of those around you, such as where crowded and you cannot move freely.

Since there may be people with an implanted pacemaker or an implanted cardioverter-defibrillator nearby. Radio waves may affect the performance of electronic medical equipment.



When using the product in medical facilities, be sure to observe the regulations of the facility.

Radio waves may affect the performance of electronic medical equipment.

Digitizer Pen

CAUTION



Store small parts such as the spare pen tip out of small children's reach.

Swallowing small parts by accident may cause suffocation or injuries.



Do not press or hit the pen tip strongly against the display.

Doing so may damage the display and cause malfunction.



Do not apply excessive load or pressure on the pen tip.

Doing so might cause a failure or malfunction.



Be careful not to pinch your finger when you attach the pen tip.

Doing so may cause injuries.



Do not swing the digitizer pen at a person.

Doing so may cause accidents such as injuries or breakage.



Do not use the digitizer pen with a broken or sharpened tip.

Doing so may damage the display and cause malfunction.



Use the supplied digitizer pen.

Using other products may cause malfunction or damage the product.

Material List

Main Unit

Part	Material	Surface Treatment
Exterior case	PC + GF resin	Heat cured urethane coating
Display	Strengthened glass	Chemically strengthened processing
Power button	PC resin	Heat cured acrylic coating + UV cured acrylic coating
Exterior panel (all circumferential side), volume up/down button, camera lens circumference	PC resin	UV cured acrylic coating
Camera lens	PMMA resin	Chemically cured processing
microSD memory card slot cover	PC resin/TPE resin	Heat cured acrylic coating + UV cured acrylic coating

AC Adapter

Part	Material
Main unit (exterior)	PC resin
Cable	PVC resin
Plug	Nickel plating

Digitizer Pen

Part	Material	Surface Treatment
Main unit	ABS resin	-
Pen tip	POM resin	Bitter coating
Eraser	POM resin	-

Handling Precautions

These precautions are provided to prevent product faults and to ensure that performance can be fully demonstrated. Thoroughly read these precautions to ensure correct use.

Precautions Common to the Main Unit, Internal Battery, Charger, Peripheral Devices

- Do not apply excessive force to the product during use. Be sure not to put the product into a tightly packed bag or place a heavy object on the product in a bag. Doing so might damage the display or internal circuit board resulting in a malfunction.
Keeping an external connection device connected to the external connection terminal, earphone microphone terminal, or charging terminal might damage the connector resulting in a malfunction. Such damage and malfunction are not covered by the warranty, even if there is no external damage.
- Do not use the product in extremely hot, cold or humid places. (Use within an ambient temperature range of 5°C to 35°C and humidity range of 35% to 85%.)

- Do not use in places subject to lots of dust or vibration. Doing so may cause malfunction.
- Clean the external connection terminal, earphone microphone terminal, and charging terminal with dry cotton swabs, etc. every now and then. Soiling may result in a poor connection. Do not exert a strong force to clean the external connection terminal, earphone microphone terminal, or charging terminal to prevent deformation.
- Clean the product with a soft dry cloth (such as the type used for eyeglasses). Forcefully rubbing with a dry cloth may scratch the display. The display may be stained if splash or smear is left attached to the surface. Wiping the product using alcohol, thinner, benzene, detergent, etc. might erase the printing on the outer cover or cause malfunction.
- Use as far away as possible from land-line phones, TVs and radios. Use nearby might affect them.
- The product may become warm while charging or during other operations, depending on the situation, but this is not abnormal.
- Do not place near corrosive chemicals or in places where corrosive gas is generated. Doing so may cause malfunction.
- Do not use outside when you can hear thunder. Doing so might risk lightning strikes and electric shock.
- Use only the operation-verified peripheral devices. Use of other peripheral devices might cause malfunction.

- Do not put the product in a cooking apparatus such as microwave oven or a pressure vessel. Doing so may cause malfunction.
- The customer is not allowed to disassemble, modify or repair the product. Doing so may cause malfunction. Modification of the product is in violation of the Radio Law and Telecommunications Business Law.
- Do not allow your finger or conductive foreign objects (metal fragments, pencil leads, etc.) to come into contact with or get inside the connection terminal, earphone microphone terminal, and charging terminal to avoid them from short-circuit. Doing so may cause malfunction.
- In the event that the product gets wet while charging, immediately disconnect the power plug of the AC adapter.
- Do not use the product while driving a car or motorbike, riding a bicycle or walking. Use of a tablet while driving a car or motorbike is prohibited by law. Use of a tablet while riding a bicycle may be punishable by some regulations.
- Using or charging the product in a bag or while it is covered with bedding might cause malfunction.
- When using an AC adapter or external device, insert/remove the connector straight to/from the terminal. Make sure the orientation of the connector. Unless it is correct, it may cause a fault.
- Do not expose the camera lens part to direct sunlight for an extended period. Doing so may cause malfunction.
- Do not store the product in places subject to direct sunlight (e.g. in a car), places that get hot, places that get extremely cold, and in humid or dusty places. Doing so may cause malfunction.

- Do not leave the product on unstable or sloping surfaces. Be careful especially when the product is charging. The product may fall and cause malfunction.
- For charging the product, do not exceed the rating of an outlet or wiring device by starburst connection etc.

■ Main Unit

- The battery is built into the product and it is not user replaceable. For information on battery replacement, contact the support center on the back cover.
- Do not forcefully press, tap or intentionally subject the display to strong impact. Doing so might cause scratching or damage.
- Do not forcefully press your fingernails, sharp objects, or hard objects against buttons or display surface. Doing so may cause scratching or damage.
- The touch panel is designed to be lightly touched by fingers. Avoid pressing forcefully or using sharp objects (fingernail, ballpoint pen, pin, etc.). The touch panel might not respond to the following types of operation. These may also result in malfunction.
 - with fingernails
 - with gloved fingers
 - with another object placed on the operation area
 - with a protective film or sticker adhered

- Never use the modified product. Use of a modified device violates the Radio Law and Telecommunications Business Law.
The product has acquired such certification as conformity with technical regulations for a specified radio station based on the Radio Law and conformity with technical regulations for a terminal device based on the Telecommunications Business Law, and the "Technical Conformity Mark" is indicated in the name plate sticker on the product.
If the modification is made to the internal components, the certifications of conformity with technical regulations will become invalid. Never use the product without these certifications valid. Doing so violates the Radio Law and Telecommunications Business Law.
- Take care not to place magnetized items such as magnetic cards, speakers and TV sets near the product as it might cause malfunction.
Putting strong magnetism close to the product might cause false operation.
- Do not bring magnetized cards such as cash cards, credit cards and prepaid cards closer to the product. Doing so may result in loss of recorded information.
- When you put the product in your bag, etc., take care so that the display does not come in contact with metal objects or other hard objects. Doing so may cause scratching or damage. Contacting metal or other hard parts with the display may cause scratching or damage.

- When suddenly brought into a warm place from a cold place, or when in a humid location, or when used where temperature suddenly changes (e.g. near the air discharge port of an air conditioner), water droplets (i.e. condensation) sometimes are formed inside the product. Note that when used under conditions such as this, humidity might cause corrosion or a fault.
- Camera lens part or inside of the display may mist over (dew formation) because of usage environment such as temperature or humidity. This is not malfunctioning or abnormal.
- Environment for easily generating dew formation on the camera lens part or inside of the display
In the following cases, such as large temperature change or high humidity, camera lens part or inside of the display mist over because of usage environment.
 - Bring the product from a high temperature land into a low temperature water.
 - Bring the product from a cold place into a warm place such as an indoor.
 - Open/Close the microSD memory card slot cover in a high humidity environment.
- How to reduce condensation
Do not use the product in places that get hot and humid, and sandy or dusty places. Leave the product with the microSD memory card slot cover opened for a while until the condensation is cleared when the ambient temperature is held constant.

-
- While writing/reading data to/from a microSD memory card, do not subject the product to vibration or impact, or turn off the power. Doing so may cause data loss or malfunction.
-
- Do not cover the sensor with your finger or put a sticker on it. May hinder the sensor from detecting the ambient light level and functioning correctly.
-
- Keep the microSD memory card slot cover closed when using the product. Using the product with the cover opened can allow dust, liquid, etc. to enter and may cause malfunction.
-
- Do not allow liquids, metal objects, or other foreign objects to get inside of the microSD memory card slot. Doing so may cause malfunction.
-
- Do not give strong impact on the product such as dropping, throwing, stomping. Doing so may cause malfunction.
-
- Do not place the product directly on sand at a beach, etc. If sand or other small particles get inside the microphone, speaker, or the product, it may cause the volume to drop or malfunction.

■ Touch Panel

- Any soiling on the display surface may cause false operation. Wipe the display with a soft, dry cloth.
-
- Putting stickers or sheets (e.g. commercially available protective films, peep prevention sheets) on the display might cause incorrect operation of the touch panel.
-
- When carrying the product in your bag, etc., take care not to put the touch panel close to metals or other conductive materials, as it might cause false operation of the touch panel.

■ Internal Battery



Li-ion 00

(The internal battery of the product is a lithium-ion battery.)

The internal battery is not fully charged at the time of purchase. Charge the battery before using the product. Also charge the battery after long periods of disuse before using the product.

-
- Use in very hot or cold environments, for example, when left in an automobile with the windows closed in summer, will cause the battery capacity to drop and shorten the available battery usage time. This will also shorten the internal battery's service life. Try to use the internal battery as much as possible at room temperature.
-
- After the internal battery is charged, battery power decreases bit by bit even if the product is not used. The internal battery may be discharged if the product is not used for a long time. We recommend charging the battery before use.
-
- The internal battery is a consumable accessory. If the performance of an internal battery does not recover (e.g. the usable time after each charge has become extremely short), the internal battery is at the end of service life, so stop using the product. Since the battery is built into the product, the support center keeps your product and replaces the battery for a fee. Please note that you may not be able to use the product for a certain period. Please understand. Note that the length of service life varies depending on the usage condition, etc.
-

-
- The internal battery may swell up as it approaches the end of its battery life. This is due to the properties of lithium-ion batteries, and is not a problem in terms of safety.

■ Charger

- Do not wrap the cord of the AC adapter around the adapter unit. Do not forcibly bend the AC adapter plug or the connection between the connector and power cord. Do not place heavy objects on the cord of the AC adapter or USB connection cable, or do not pull the cord with excessive force. Doing so may cause malfunction.
-
- When unplugging the power plug of the AC adapter from the power outlet, hold and pull the power plug. If you pull the cable, it might be damaged.

■ Camera

- When photographing important occasions, take a trial shot and check the shot image to make sure it is correctly shot.
-
- Do not shoot in areas where shooting is prohibited.

■ Copyrights and Rights of Portrait of Portrait

- You are not allowed to copy, distribute, publish, modify or edit the data you shot, recorded or downloaded using the product without consent of the copyright holder, except for personal use, under the copyright law.
In addition, do not use or modify portraits or names of other individuals without their consent, as it may infringe on rights of portrait.
Note that shooting and recording might be restricted at some live performances, shows and exhibitions even for personal use.
-

-
- Be careful about the copyright and portrait right when posting photos you shot, etc. on Internet homepages.

■ Backup Content On the Product

- Please back up important content registered to the product or downloaded to the product from an outside source. Content recorded to memory on the product sometimes is cleared, altered, and so on by unexpected factors, such as static electricity or a fault, repair, mishandling, etc.

■ FCC Certification Information

- The product is certified by Federal Communications Commission (FCC).
The product's FCC ID is JOYKB18.
Also, FCC ID is indicated in the name plate sticker on the product.

Notes on Using Bluetooth®/ Wireless LAN (Wi-Fi®) Function

- The Bluetooth® function of the product conforms to domestic standards of Japan, FCC standards, and has been certified.
 - Use of the Bluetooth® function is limited in some countries or regions. If you use the product overseas, check the relevant laws and regulations of the country/region you visit.
 - The wireless LAN (Wi-Fi®) function of the product conforms to domestic standards of Japan, FCC standards, and has been certified.
 - Use of the Wireless LAN (Wi-Fi®) function is limited in some countries or regions. If you use the product overseas, check the relevant laws and regulations of the country/region you visit.
 - The 2.4 GHz band used by wireless LAN (Wi-Fi®) and Bluetooth® devices is operated by various other devices. For this reason, the communication speed and connectable range may be decreased, or disconnection may occur, due to interference from other devices.
 - Do not use this product in places where electromagnetic waves are generated or near electric products, AV and OA equipment, or other magnetized devices.
- Subjecting this product to magnetic or electrical noise might increase noise, prevent it from performing communications, and so on. (This product is particularly susceptible to noise when it is used near a microwave oven.)
 - Using this product near a TV, radio or similar appliance might cause reception interference, disrupt TV images, and so on.
 - Searching might not be successful if there are multiple wireless LAN (Wi-Fi®) access points near the product or the same channel is being used.
 - Since using the product on airplanes is restricted, follow the instructions given by the respective airlines.
 - The communication speed and connectable range vary depending on the distance between communication devices, obstacles and the devices used.

IEEE802.11b/g/n

IEEE802.11a/n

J52	W52	W53	W56
-----	-----	-----	-----

Cautions on Using 2.4 GHz Band

The frequencies used by the Bluetooth® and/or Wireless LAN (Wi-Fi®) function of the product are in the 2.4 GHz band. In this frequency band, other similar wireless stations, in-plant wireless stations for mobile unit identification that require a license for use, such as factory production lines, specific small power wireless stations that do not require licenses, amateur wireless stations (collectively called "other wireless stations" from here on) are operated in addition to home electrical appliances such as microwave ovens, devices for industrial, scientific and medical devices.

1. Before using the product, make sure that "other wireless stations" are not in operation nearby.
2. In the event that instances of radio wave interference have occurred between the product and "other wireless stations", immediately either relocate the product or stop operation of the device (stop emission of radio waves).



memo

- ◎ Connections between the product and all other Bluetooth® and wireless LAN (Wi-Fi®) devices have not been confirmed. Therefore, connections with all Bluetooth® and wireless LAN (Wi-Fi®) devices are not guaranteed.
- ◎ This product supports security features for wireless communications that are compliant with the Bluetooth® and wireless LAN (Wi-Fi®) standard specifications, but the security may not be sufficient depending on the usage environment and configuration. Be careful when making data communication using Bluetooth® or wireless LAN function (Wi-Fi®).
- ◎ Wireless LAN (Wi-Fi®) has the advantage that it can be freely connected anywhere within the radio wave range, as it uses radio waves for exchanging information. However, not making security settings allows the risk of malicious use by third parties. While at the customer's discretion and responsibility, it is recommended that you make security settings before using the product.
- ◎ The Company assumes no responsibility for leakage of data or information that may occur during Bluetooth® / wireless LAN (Wi-Fi®) communication.
- ◎ Since Bluetooth® and wireless LAN (Wi-Fi®) functions use the same frequency band, using the both functions at the same may cause radio wave interference resulting in decreased communication speed or disconnection from the network. If connection fails, stop using either of the Bluetooth® and wireless LAN (Wi-Fi®) functions.

Bluetooth® and wireless LAN (Wi-Fi®) functions of the product use frequencies in the 2.4 GHz band.

• **Bluetooth® function: 2.4FH1/XX1**



This product uses the 2.4 GHz band. FH-SS is used as the modulation scheme. The interference distance is about 10 m or less.

The band of mobile unit identification devices cannot be avoided.

• **Wireless LAN (Wi-Fi®) function: 2.4DS4/OF4**



This product uses the 2.4 GHz band. DS-SS and OFDM are used as the modulation schemes. The interference distance is about 40 m or less.

This means that all bandwidths are used, and that band of mobile unit identification devices can be avoided.

Available channels vary depending on countries. For use in an airplane, check with the airline company in advance.

Cautions on Using 5 GHz Band

Outdoor use of 5.2 GHz/5.3 GHz band (W52/W53) is prohibited under the Radio Law, except communications with a base station or a land mobile relay station for 5.2 GHz band high output power data communication system.

The used channels of the product are as follows.

- W52 (5.2 GHz band / 36, 38, 40, 44, 46, 48 ch)
- W53 (5.3 GHz band / 52, 54, 56, 60, 62, 64 ch)
- W56 (5.6 GHz band / 100, 102, 104, 108, 110, 112, 116, 118, 120, 124, 126, 128, 132, 134, 136, 140 ch)

Appendix

Updating Software

You can update the product to the most recent software for optimal performance and to get the latest enhancements.

Use Wi-Fi® functions of this product to download and update the software.

■ Notes on Software Update

- It is recommended to back up your data before updating software.
- For details, refer to the support information on the Kyocera homepage.
- If software update has failed or stopped, perform the same procedure again.
- If the software update fails, it may become impossible to operate the product. If you cannot use the product, contact the support center on the back cover.
- Software update may not be available overseas.
- Any operations are not available during software update. Alarm does not work, either.

Downloading Software into the Product to Update

Downloading updated software via the Internet directly from the product is available.

- 1 **Home screen** → **[⚙️]** → **[System]** → **[Advanced]** → **[System update]**

From here on, follow the on-screen instructions.







memo

- © After a software update, the product cannot revert to the previous version software.

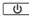
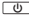
Troubleshooting

Before you assume that the product is malfunctioning, confirm the following contents.

Trouble	Detail	Page
Cannot turn on power	Is the internal battery charged?	P.8
	 (Power button) pressed and held until the notification light turns on?	P.10
Cannot charge the product	Is the AC adapter correctly connected?	P.8
	Is the product at a high or low temperature? The product may stop charging depending on a temperature.	P.9
	Is the accessory (the supplied AC adapter) used for charging?	P.8
Cannot operate/ The screen does not respond/ Cannot turn off the power	Press and hold  (Power button) and  (Volume up button) at the same time for at least 11 seconds to force the product to shut down and restart.	P.10
The power is turned off automatically	Is the internal battery adequately charged?	P.8
The power is turned off while the wake-up logo is displayed	Is the internal battery adequately charged?	P.8

Trouble	Detail	Page
 (out of service area) appears	Is the product in a place where signal is good enough?	—
	Is the built-in antenna covered with finger, etc.?	P.6
Cannot operate button/touch panel	Is the power turned on?	P.10
	Turn off the power and then turn it on again.	P.10
A message indicating that charging is necessary is displayed	The battery is almost empty.	P.8
The product can only be used a short time	Is the battery adequately charged? • Charge until the red charging light turns green.	P.8
	Does the internal battery have adequate service life remaining?	P.37
	Is the product left in the place for a long period where  (out of service area) appears?	—
	Stop using/disabling unused apps or functions.	—
Display is dark	Is the temperature of the product or battery high? The display may become dark depending on the temperature of the product.	—

If you cannot find the solution to your problem in the above items, contact the support center on the back cover.

After-Sales Service

When Asking for Repair

For repair, contact our support center below.

Smile Zemi Support Center

☎ 0120-XXX-XXX

From some IP phones (Call charges must be paid by the customers) **0X-XXXX-XXXX**

Business hours: 10:00 to 20:00

* Except for our special holidays (December 31st, January 1st)

Warranty Policy

1. The terminal will be repaired for free or replaced with the substitute terminal for free if the terminal is malfunctioning under conditions of proper use within the warranty period.
 - * The substitute terminal is a new terminal, or a terminal equal to a new one in performance and reliability.
 - * Contact our support center.
2. Replacements will be charged in principle in the following cases even within the warranty period.
 - When the terminal is malfunctioning or damaged due to fall and so on by careless use
 - When the terminal is malfunctioning or damaged due to use for purposes other than the original intent of the terminal

- When the terminal is malfunctioning or damaged due to use with products that the Company does not permit the use
 - When the terminal is malfunctioning or damaged due to reasons not caused by the product
 - When the terminal is malfunctioning or damaged due to disassembly or modification
 - When the terminal is malfunctioning or damaged due to entry of liquids or foreign objects
 - When the terminal is malfunctioning or damaged due to lightnings, earthquakes, storms, floods or other natural disasters, pollutions, salt damages, smoke damages, abnormal voltages, and so on
 - When the terminal is malfunctioning or damaged due to fault, misuse, and mishandling by the customer
 - Replacement of consumable parts such as battery
 - Abrasion, scratches, or dents on the surface of the terminal resulting from normal use
3. This warranty is valid only in Japan.
 4. Since the warranty will not be reissued, keep it properly.

Others

The warranty does not limit your legal rights. If you have any question out-of-warranty repair, and so on, contact our support center.

Main Specifications

■ Main Unit

Display	Approx. 10.1 inches, approx. 16.77 million colors, Transparent TFT	
	1280 × 800 dots (WXGA)	
Weight	Approx. 550g	
Dimensions (W × H × D)	Approx. 269 × 179 × 10.2 mm	
Internal memory ^{*1}		ROM: Approx. 16 GB RAM: Approx. 2 GB
Charging times (estimate)	Supplied AC adapter	Approx. 360 minutes
Camera image pixel		CMOS
Effective out-camera pixels		Approx. 5 million pixels
Effective in-camera pixels		Approx. 5 million pixels
Wireless LAN (Wi-Fi [®]) function		IEEE802.11a/b/g/n compatible
Bluetooth [®] function	Compatible version	Bluetooth [®] standards Ver.4.2 compatible ^{*2}

Bluetooth [®] function	Output	Bluetooth [®] standards Class 1
	Communication range ^{*3}	Within 10 m with no obstacles in the range
	Supported Bluetooth profile ^{*4}	Generic Access Profile Serial Port Profile Advanced Audio Distribution Profile Audio/Video Remote Control Profile (Version 1.3) Object Push Profile Headset Profile Human Interface Device Profile Phone Book Access Profile Message Access Profile HID over GATT Profile
	Frequency bands	2.4 GHz/5 GHz band

^{*1} Since the storage is shared by data and apps, storage space may be reduced depending on the usage of apps.

^{*2} It is confirmed that the product and all Bluetooth[®] devices are compliant with Bluetooth[®] standards designated by Bluetooth SIG, and they are authenticated. However, procedures may differ or data transfer may not be possible depending on the device's characteristics or specifications.

^{*3} It changes according to objects obstructing devices and signal reception.

^{*4} Specifications provided in Bluetooth[®] standards for making communication between Bluetooth[®]-compatible devices in accordance with their intended use.

■ AC Adapter

Input	100V - 240V AC 0.3A 50/60 Hz
Output	5.0V DC 1.2A
Charging temperature range	5 °C to 35 °C
Dimensions (W × H × D)	AC adapter main unit: Approx. 71 × 30 × 45 mm Cable length: Approx. 1.2 m (except for connector insertion plug)
Weight	Approx. 90g

■ Digitizer Pen

Dimensions	Length: Approx. 141.3 mm Diameter: Approx. 10.5 to 13.5 mm
Weight	Approx. 10g

■ Radio Frequency Specification

Frequency range	Maximum high-frequency power
2,402~2,482 MHz	20mW
5,170~5,330 MHz	6.4mW
5,490~5,710 MHz	10mW



memo

- ◎ The continuous standby time may drop to less than half depending on the battery charging status, usage environment such as temperature, reception condition at the location where the product is used, and the function settings.

General Notes

This model [KC-XXXXX] is confirmed to comply with guidelines relating to effects of radio wave exposure as set forth by the Federal Communications Commission (FCC). Refer to the following.

FCC RF Exposure Information

Your wireless tablet personal computer is a radio transmitter and receiver. It is designed and manufactured not to exceed the emission limits for exposure to radio frequency (RF) energy set by the Federal Communications Commission of the U.S. Government.

The guidelines are based on standards that were developed by independent scientific organization through periodic and thorough evaluation of scientific studies. The standards include a substantial safety margin designed to assure the safety of all persons, regardless of age and health.

The exposure standard for wireless handsets employs a unit of measurement known as the Specific Absorption Rate, or SAR. The SAR limit set by the FCC is 1.6 W/kg. The tests are performed in positions and locations (e.g. worn on the body) as required by the FCC for each model.

The highest SAR value for this model wireless tablet personal computer as reported to the FCC when tested for use worn on the body in a holder or carry case, is 1.381 W/kg. Body-worn Operation; This device was tested for typical body-worn operations with the wireless tablet personal computer kept 0.0 cm from the body. The use of beltclips, holsters and similar accessories should not contain metallic components in its assembly.

The use of accessories that do not satisfy these requirements may not comply with FCC RF exposure requirements, and should be avoided. The FCC has granted an Equipment Authorization for this model wireless tablet personal computer with all reported SAR levels evaluated as in compliance with the FCC RF emission guidelines. SAR information on this model wireless tablet personal computer is on file with the FCC and can be found under the Display Grant section of (<http://www.fcc.gov/oet/ea/>) after searching on FCC ID JOYKB18. Additional information on Specific Absorption Rates (SAR) can be found on the FCC website at (<https://www.fcc.gov/general/radio-frequency-safety-0>).

The World Health Organization has stated that present scientific information does not indicate the need for any special precautions for the use of mobile devices. They note that if you want to reduce your exposure then you can do so by limiting the length of calls or using a hands-free device to keep the mobile phone away from the head and body.

World Health Organization
<http://www.who.int/emf>

FCC Notice

This device complies with part 15 of the FCC Rules. Operation is subject to the following two conditions: (1) This device may not cause harmful interference, and (2) this device must accept any interference received, including interference that may cause undesired operation.

Note:

This equipment has been tested and found to comply with the limits for a Class B digital device, pursuant to part 15 of the FCC Rules. These limits are designed to provide reasonable protection against harmful interference in a residential installation. This equipment generates, uses, and can radiate radio frequency energy and, if not installed and used in accordance with the instructions, may cause harmful interference to radio communications.

However, there is no guarantee that interference will not occur in a particular installation. If this equipment does cause harmful interference to radio or television reception, which can be determined by turning the equipment off and on, the user is encouraged to try to correct the interference by one or more of the following measures:

- Reorient or relocate the receiving antenna.
- Increase the separation between the equipment and receiver.
- Connect the equipment into an outlet on circuit different from that to which the receiver is connected.
- Consult the dealer or an experienced radio/TV technician for help and for additional suggestions.

Warning

The user is cautioned that changes or modifications not expressly approved by the manufacturer could void the user's authority to operate the equipment.

ISED Canada Notice

This device complies with ISED Canada licence-exempt RSS standard(s). Operation is subject to the following two conditions: (1) this device may not cause interference, and (2) this device must accept any interference, including interference that may cause undesired operation of the device.

- This Class B device complies with Canadian ICES-003.

Notice:

- (i) the device for operation in the band 5150-5250 MHz is only for indoor use to reduce the potential for harmful interference to co-channel mobile satellite systems;
- (ii) the maximum antenna gain permitted for devices in the bands 5250-5350 MHz and 5470-5725 MHz shall comply with the e.i.r.p. limit; and
- (iii) the maximum antenna gain permitted for devices in the band 5725-5825 MHz shall comply with the e.i.r.p. limits specified for point-to-point and non point-to-point operation as appropriate.
- (iv) Users should also be advised that high-power radars are allocated as primary users (i.e. priority users) of the bands 5250-5350 MHz and 5650-5850 MHz and that these radars could cause interference and/or damage to LE-LAN devices.

Radiation Exposure Statement:

The product comply with the Canada portable RF exposure limit set forth for an uncontrolled environment and are safe for intended operation as described in this manual. The further RF exposure reduction can be achieved if the product can be kept as far as possible from the user body or set the device to lower output power if such function is available.

Avis de ISED Canada

Le présent appareil est conforme aux CNR d'ISED Canada applicables aux appareils radio exempts de licence. L'exploitation est autorisée aux deux conditions suivantes: (1) l'appareil ne doit pas produire de brouillage, et (2) l'utilisateur de l'appareil doit accepter toute interférence radioélectrique subi, même si le brouillage est susceptible d'en compromettre le fonctionnement.

- Cette appareil de Classe B est conforme à la norme canadienne ICES-003.

Note:

- (i) l'appareil pour une utilisation dans la plage de bande 5150-5250 MHz n'est destiné qu'à un usage en intérieur pour réduire les interférences potentiellement dangereuses pour les systèmes satellites mobiles à canal partagé;
- (ii) le gain d'antenne maximal permis pour les appareils dans les plages de bande 5250-5350 MHz et 5470-5725 MHz doit être conforme à la limite e.i.r.p. ; et
- (iii) le gain d'antenne maximal permis pour les appareils dans la plage de bande 5725-5825 MHz doit être conforme avec les limites e.i.r.p. spécifiées pour les utilisations point à point et nonpoint à point de manière adéquate.
- (iv) Les utilisateurs doivent être avertis que des radars très puissants sont assignés comme utilisateurs primaires (i.e. utilisateurs prioritaires) des bandes 5250-5350 MHz et 5650-5850 MHz et que ces radars peuvent provoquer des interférences et/ou des dégâts aux appareils LE-LAN.

Déclaration d'exposition aux radiations:

Le produit est conforme aux limites d'exposition pour les appareils portables RF pour les Etats-Unis et le Canada établies pour un environnement non contrôlé. Le produit est sûr pour un fonctionnement tel que décrit dans ce manuel. La réduction aux expositions RF peut être augmentée si l'appareil peut être conservé aussi loin que possible du corps de l'utilisateur ou que le dispositif est réglé sur la puissance de sortie la plus faible si une telle fonction est disponible.

European RF Exposure Information

Your mobile device is both a radio transmitter and receiver, and is designed not to exceed limits for exposure to radio waves recommended by international guidelines. These guidelines were produced by independent scientific organization, ICNIRP, and include safety margins designed to protect all persons, regardless of age and condition of health. The guidelines apply a unit of measurement known as the Specific Absorption Rate (SAR). The SAR limit for mobile devices is 2 W/kg, and the highest SAR value for this device was **XXXXX** W/kg*.

As testing measures SAR at the highest transmitting power of a device, actual SAR tends to be lower during ordinary operation. Lower SAR levels are typical during ordinary operation as automatic changes are made within the device to ensure the network can be reached with minimal power.

The World Health Organization (WHO) has stated that present scientific information does not indicate the need for any special precautions to be adopted when using mobile devices. WHO also notes that those wishing to reduce exposure may do so by limiting call length and by using a 'hands-free' device

to distance the phone from the head and body. For further information, please see the WHO website: <http://www.who.int/peh-emf/en/>

* Note that tests are also carried out in accordance with international testing guidelines.

FCC Compliance Information

The product is certified by Federal Communications Commission (FCC).

The FCC ID of this product is JOYKB18.

FCC ID is indicated in the sticker on the back side of this product.

Simplified EU Declaration of Conformity

The simplified EU declaration of conformity referred to in Article 10(9) shall be provided as follows:

Hereby, KYOCERA Corporation declares that the radio equipment type **KC-XXXXX** is in compliance with Directive 2014/53/EU. The full text of the EU declaration of conformity is available at the following internet address:

<http://www.kyoceramobilephone.com/en/XXXX/>

-Note-

The following frequency bands are restricted to indoor use only:

5150 - 5250 MHz (802.11a/n/ac) in US

5150 - 5350 MHz (802.11a/n/ac) in EU



Safety Information

To prevent possible hearing damage, do not listen at high volume levels for long periods.

Product Disposal

Battery:

This product is a unibody (one-piece) device, so the back cover and battery cannot be removed. Please be careful. Observe the following precautions.

- Do not attempt to open the back cover.
- Do not take out the battery, replace it, or dismantle it.
- Do not damage the back cover of the product.
- Do not incinerate the product or dispose of it like you would household rubbish.

Dispose of the product (including the internal battery) in accordance with the environmental regulations of your region.



When cellular devices and accessories bearing this mark have reached the end of their product lives, it is necessary to bring them to a given waste collection point.

- The waste collection box for each part, located at the waste treatment facility in your area
- The waste collection box at the retail store

To prevent these waste products from polluting the environment, they are recycled.

European countries:

Waste collection points are free to use. It is necessary to bring all products bearing this mark to a collection point.

Non-European countries:

If your area lacks suitable waste collection or if it has a recycling facility for the parts of devices bearing this mark, it is necessary to take them to the collection point for recyclables. Do not throw them out with normal rubbish.

Intellectual Property Rights

Trademarks

Company names and product names referred to in this manual are trademarks or registered trademarks of the respective companies.



Google, Android, Google Play and other marks are trademarks of Google LLC.

THIS PRODUCT IS LICENSED UNDER THE MPEG-4 VISUAL PATENT PORTFOLIO LICENSE FOR THE PERSONAL AND NON-COMMERCIAL USE OF A CONSUMER FOR (i)ENCODING VIDEO IN COMPLIANCE WITH THE MPEG-4 VISUAL STANDARD ("MPEG-4 VIDEO") AND/OR (ii) DECODING MPEG-4 VIDEO THAT WAS ENCODED BY A CONSUMER ENGAGED IN A PERSONAL AND NONCOMMERCIAL ACTIVITY AND/ OR WAS OBTAINED FROM A VIDEO PROVIDER LICENSED BY MPEG LA TO PROVIDE MPEG-4 VIDEO. NO LICENSE IS GRANTED OR SHALL BE IMPLIED FOR ANY OTHER USE. ADDITIONAL INFORMATION INCLUDING THAT RELATING TO PROMOTIONAL, INTERNAL AND COMMERCIAL USES AND LICENSING MAY BE OBTAINED FROM MPEG LA, LLC. SEE [HTTP://WWW.MPEGLA.COM](http://www.mpeg-la.com).

THIS PRODUCT IS LICENSED UNDER THE AVC PATENT PORTFOLIO LICENSE FOR THE PERSONAL USE OF A CONSUMER OR OTHER USES IN WHICH IT DOES NOT RECEIVE REMUNERATION TO (i) ENCODE VIDEO IN COMPLIANCE WITH THE AVC STANDARD ("AVC VIDEO") AND/OR (ii) DECODE AVC VIDEO THAT WAS ENCODED BY A CONSUMER ENGAGED IN A PERSONAL ACTIVITY AND/ OR WAS OBTAINED FROM A VIDEO PROVIDER LICENSED TO PROVIDE AVC VIDEO. NO LICENSE IS GRANTED OR SHALL BE IMPLIED FOR ANY OTHER USE. ADDITIONAL INFORMATION MAY BE OBTAINED FROM MPEG LA, LLC. SEE [HTTP://WWW.MPEGLA.COM](http://www.mpeg-la.com)

microSD, microSDHC, and microSDXC are trademarks of SD-3C, LLC.

Bluetooth® and logo are registered trademarks owned by the Bluetooth SIG, Inc., and KYOCERA Corporation is licensed to use those trademarks.

Wi-Fi®, WPA®, Wi-Fi CERTIFIED logo, and Wi-Fi Direct® are registered trademarks of Wi-Fi Alliance.

Wi-Fi CERTIFIED™ is trademarks of Wi-Fi Alliance.

All other company names and product names in this manual are trademarks or registered trademarks of respective companies.

License

Users of the product are authorized to use software installed into the product described in this instruction manual. Pay attention to the following points when using the software.

- (a) The software installed on this product or part of it may not be altered, delivered, modified, analyzed, reverse-engineered, derived, and any such actions are prohibited.
- (b) Illegally importing the software or a part of it is prohibited.
- (c) This Software is provided without implied warranties of merchantability, fitness for a particular purpose and noninfringement of third party rights.

Note that the existing license agreement takes priority for usage of GNU General Public License (GPL), GNU Library/Lesser General Public License (LGPL) included in software, software based on other open source software license and software that KYOCERA Corporation is licensed.

For information on the Open source software, refer to "Open Source Software" as follows;

Open Source Software

Note that the existing license agreement takes priority for usage of GNU General Public License (GPL), GNU Library/Lesser General Public License (LGPL) included in software, software based on other open source software license and software that KYOCERA Corporation is licensed. The exact terms of GPL, LGPL and some other licenses are reproduced in "About tablet" in this product. For details, refer to KYOCERA homepage.

This product includes software copyrighted by KYOCERA Corporation and licensed software.

Copyright of the software designed and developed complying with the open source software standard belongs to KYOCERA Corporation or the third parties, distribution, reproduction, transformation and transmission over public lines without consent of KYOCERA Corporation are prohibited, unless you are authorized or permitted by Copyright Law.

OpenSSL License

[OpenSSL License]

Copyright © 1998-2011 The OpenSSL Project. All rights reserved.

This product includes software developed by the OpenSSL Project for use in the OpenSSL Toolkit. (<http://www.openssl.org/>)

THIS SOFTWARE IS PROVIDED BY THE OpenSSL PROJECT "AS IS" AND ANY EXPRESSED OR IMPLIED WARRANTIES, INCLUDING, BUT NOT LIMITED TO, THE IMPLIED WARRANTIES OF MERCHANTABILITY AND FITNESS FOR A PARTICULAR PURPOSE ARE DISCLAIMED. IN NO EVENT SHALL THE OpenSSL PROJECT OR ITS CONTRIBUTORS BE

LIABLE FOR ANY DIRECT, INDIRECT, INCIDENTAL, SPECIAL, EXEMPLARY, OR CONSEQUENTIAL DAMAGES (INCLUDING, BUT NOT LIMITED TO, PROCUREMENT OF SUBSTITUTE GOODS OR SERVICES; LOSS OF USE, DATA, OR PROFITS; OR BUSINESS INTERRUPTION) HOWEVER CAUSED AND ON ANY THEORY OF LIABILITY, WHETHER IN CONTRACT, STRICT LIABILITY, OR TORT (INCLUDING NEGLIGENCE OR OTHERWISE) ARISING IN ANY WAY OUT OF THE USE OF THIS SOFTWARE, EVEN IF ADVISED OF THE POSSIBILITY OF SUCH DAMAGE.
[Original SSLeay License]
Copyright © 1995-1998 Eric Young (eay@cryptsoft.com) All rights reserved.

This product includes cryptographic software written by Eric Young
(eay@cryptsoft.com)

THIS SOFTWARE IS PROVIDED BY ERIC YOUNG "AS IS" AND ANY EXPRESS OR IMPLIED WARRANTIES, INCLUDING, BUT NOT LIMITED TO, THE IMPLIED WARRANTIES OF MERCHANTABILITY AND FITNESS FOR A PARTICULAR PURPOSE ARE DISCLAIMED. IN NO EVENT SHALL THE AUTHOR OR CONTRIBUTORS BE LIABLE FOR ANY DIRECT, INDIRECT, INCIDENTAL, SPECIAL, EXEMPLARY, OR CONSEQUENTIAL DAMAGES (INCLUDING, BUT NOT LIMITED TO, PROCUREMENT OF SUBSTITUTE GOODS OR SERVICES; LOSS OF USE, DATA, OR PROFITS; OR BUSINESS INTERRUPTION) HOWEVER CAUSED AND ON ANY THEORY OF LIABILITY, WHETHER IN CONTRACT, STRICT LIABILITY, OR TORT (INCLUDING NEGLIGENCE OR OTHERWISE) ARISING IN ANY WAY OUT OF THE USE OF THIS SOFTWARE, EVEN IF ADVISED OF THE POSSIBILITY OF SUCH DAMAGE.

For inquiries, call:

• Any inquiries such as the product, operation procedure, or repair, contact our support center below.

When asking for repair

For repair, prepare the warranty included with the product and contact our support center below.

Support Center

 0120-XXX-XXX

From some IP phones (Call charges must be paid by the customers) 0X-XXXX-XXXX

Business hours: 10:00 to 20:00

* Except for our special holiday (December 31st, January 1st).

* Not available from overseas.



濡れた状態での充電は、
異常な発熱・焼損などの原因となり
大変危険です。