

Logitech®

Bluetooth Keyboard
Y-X5A77



English Turn **ON** computer.

Español Encienda el ordenador.

Français Mettez l'ordinateur sous tension.

Português Ligue o computador.

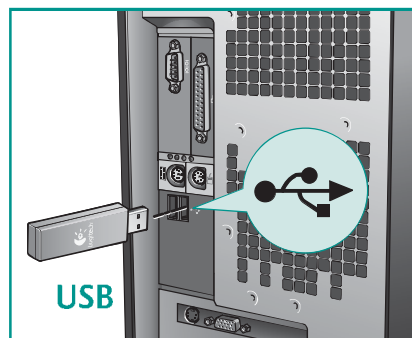

English Plug in USB mini-receiver into computer's USB port.

Español Conecte el minirreceptor USB al puerto USB del ordenador.

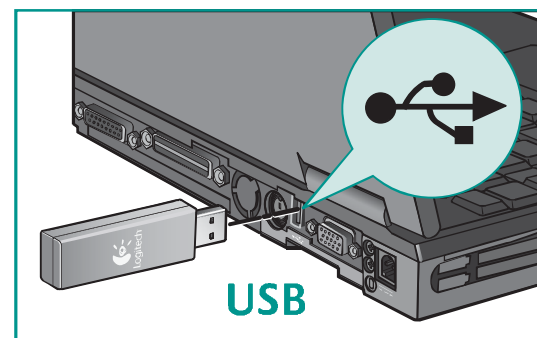

Français Branchez le minirécepteur USB sur le port USB de l'ordinateur.

Português Ligue o mini-receptor à porta USB do computador.



ENGLISH

1. Standby/sleep button 2. System button: press and hold to power PlayStation® on and off 3. E-mail button 4. Media button 5. Mute button 6. Volume down button 7. Volume up button 8. Play/pause button 9. Battery level indicator: green = battery power OK; red = replace batteries 10. Keyboard on/off slider 11. Mouse touch pad: touch and slide up to scroll up; touch and slide down to scroll down 12. Right mouse click 13. Left mouse click

ESPAÑOL

1. Standby/sleep button 2. System button: press and hold to power PlayStation® on and off 3. E-mail button 4. Media button 5. Mute button 6. Volume down button 7. Volume up button 8. Play/pause button 9. Battery level indicator: green = battery power OK; red = replace batteries 10. Keyboard on/off slider 11. Mouse touch pad: touch and slide up to scroll up; touch and slide down to scroll down 12. Right mouse click 13. Left mouse click

FRANÇAIS

1. Standby/sleep button 2. System button: press and hold to power PlayStation® on and off 3. E-mail button 4. Media button 5. Mute button 6. Volume down button 7. Volume up button 8. Play/pause button 9. Battery level indicator: green = battery power OK; red = replace batteries 10. Keyboard on/off slider 11. Mouse touch pad: touch and slide up to scroll up; touch and slide down to scroll down 12. Right mouse click 13. Left mouse click

PORTUGUÊS

1. Standby/sleep button 2. System button: press and hold to power PlayStation® on and off 3. E-mail button 4. Media button 5. Mute button 6. Volume down button 7. Volume up button 8. Play/pause button 9. Battery level indicator: green = battery power OK; red = replace batteries 10. Keyboard on/off slider 11. Mouse touch pad: touch and slide up to scroll up; touch and slide down to scroll down 12. Right mouse click 13. Left mouse click



- ENGLISH** Information: for more information regarding your Logitech® gaming device and Logitech® support, consult the Logitech® Important Information® document, or visit Logitech® online at www.logitech.com
- ESPAÑOL** Información: Para obtener más información relativa al dispositivo de juego Logitech® y a la asistencia ofrecida por Logitech®, consulte el documento de información importante de Logitech® o visite la página Web de Logitech®, www.logitech.com.
- FRANÇAIS** Informations: pour plus d'informations relatives à votre dispositif de jeu Logitech® et au support technique Logitech®, consultez le document intitulé Informations importantes de Logitech® ou visitez le site Web Logitech® à l'adresse www.logitech.com.
- PORTUGUÊS** Informações: Para obter informações adicionais sobre o dispositivo de jogo da Logitech® e a assistência da Logitech®, consulte o documento "Informações importantes da Logitech®" ou visite a Logitech® online no endereço www.logitech.com.

F

Federal Communication Commission Interference Statement

This equipment has been tested and found to comply with the limits for a Class B digital device, pursuant to Part 15 of the FCC Rules. These limits are designed to provide reasonable protection against harmful interference in a residential installation. This equipment generates, uses and can radiate radio frequency energy and, if not installed and used in accordance with the instructions, may cause harmful interference to radio communications. However, there is no guarantee that interference will not occur in a particular installation. If this equipment does cause harmful interference to radio or television reception, which can be determined by turning the equipment off and on, the user is encouraged to try to correct the interference by one of the following measures:

- Reorient or relocate the receiving antenna.
- Increase the separation between the equipment and receiver.
- Connect the equipment into an outlet on a circuit different from that to which the receiver is connected.
- Consult the dealer or an experienced radio/TV technician for help.

FCC Caution: Any changes or modifications not expressly approved by the party responsible for compliance could void the user's authority to operate this equipment.

This device complies with Part 15 of the FCC Rules. Operation is subject to the following two conditions: (1) This device may not cause harmful interference, and (2) this device must accept any interference received, including interference that may cause undesired operation.

This equipment complies with FCC RF radiation exposure limits set forth for an uncontrolled environment. To maintain compliance with FCC RF exposure compliance requirements, please avoid direct contact to the transmitting antenna during transmitting.

Industry Canada Statement

This device complies with RSS-210 of the Industry Canada Rules. Operation is subject to the following two conditions:
1) this device may not cause interference and
2) this device must accept any interference, including interference that may cause undesired operation of the device



www.logitech.com/support



Location	Hotline	Technical Help
United States	+1 702 269 3457	
Argentina	0800 555 3284	
Brazil	0800 891 4173	
Canada	+1 416 207 2782	
Chile	1230 020 5484	
Latin America	+55 11 3444 6761	
Mexico	001 800 578 9619	