

G715 QSG

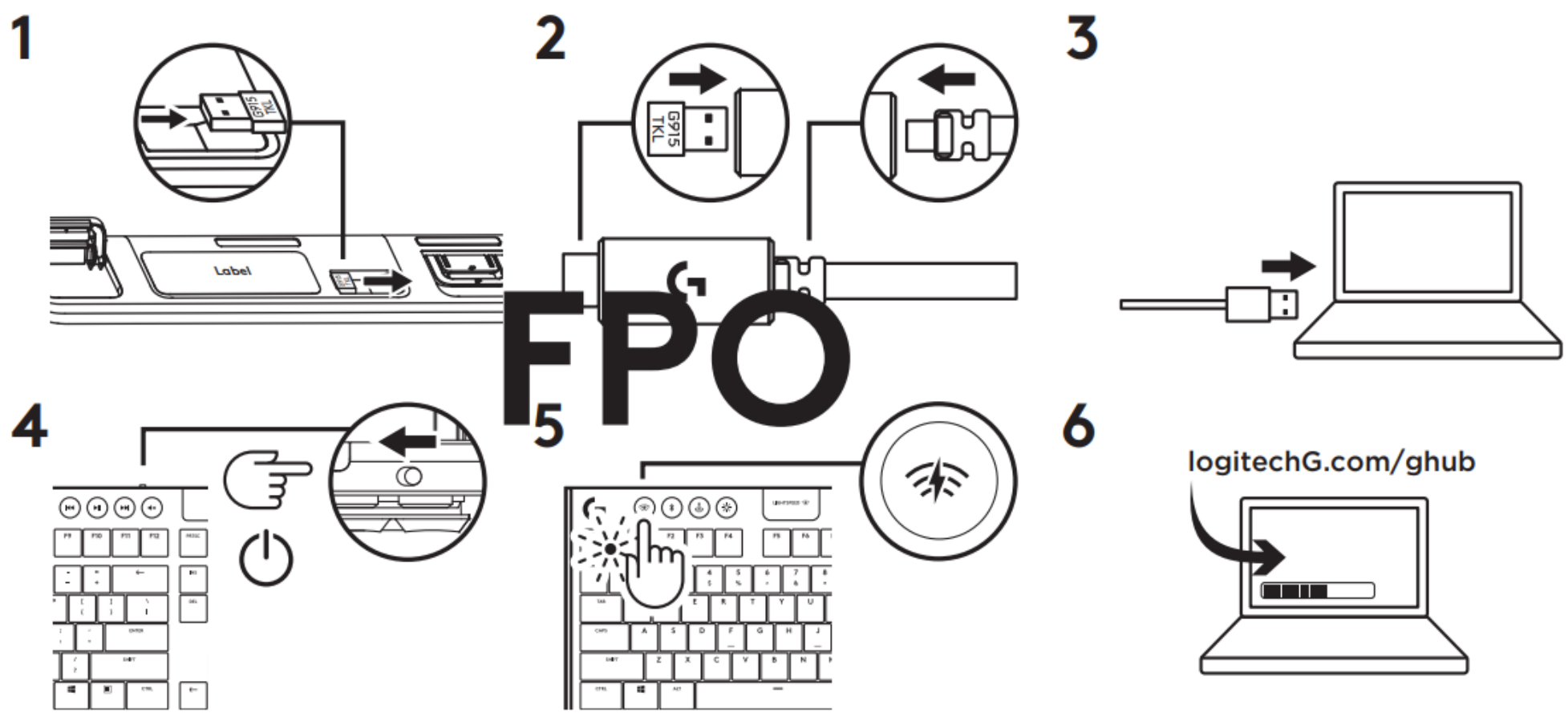

**STEP 1:**

Instructions

Insert Receiver into PC

**STEP 2:**

Instructions Refer to Harpy TKL

Turn on Keyboard

**STEP 3:**

Instructions

Connection button should light - Cyan

**STEP 4:**

Instructions

Download G HUB

**Bluetooth connection****STEP 5:**

Instructions

Turn on Keyboard

**STEP 6:**

Instructions

**Press Connect button to cycle to Bluetooth. Light should blink BLue**

**STEP 7:**

Instructions

**Follow device instructions to pair G715 to your Bluetooth device**