

Safety

In order to ensure safe and correct use, please read these precautions carefully.

1.1 General precaution

- Your phone is only suitable for the battery and charger approved by our company otherwise it may cause battery leakage, overheating, explosion and fire.
- Do not knock, shake or throw the phone to avoid damaging the phone or causing it to malfunction or overheat.
- If there is any battery damage such as rising temperature, change of color, distortion during use or charging, please stop using it and replace it with a new battery.
- Battery leakage can burn skin or clothes. In the event of any contact please rinse with plenty of clean water immediately and seek medical attention.
- Please keep the battery away from fires to avoid fire and explosion.
- Do not expose the battery to water or moisture otherwise it may cause overheating and corrosion.
- Do not use or place the battery directly under sunlight, or in hot places otherwise it may cause leakage and overheat, thus reducing the performance and shorten its lifetime.
- Do not charge the battery for over 24 hours continuously.

1.2 Precaution for use of the charger

- Do not short circuit the charger otherwise it may cause electric shock and damage to the charger.
- Do not use the charger if the power cord is broken or it may cause fire and electric shock.
- Please remove any accumulated dust on the power plug.
- Do not put water or liquid containers next to the power to avoid accidents that may cause overheating, fire, electric shock and malfunctioning
- Do not disassemble or tamper with the charger otherwise it may cause personal injury, electric shock, fire and the damage of the charger.
- Do not use the charger in places of high humidity otherwise it may cause electric shock, fire and damage to the charger.
- Do not touch the charger, power cord or power plug with wet hands otherwise it can cause an electric shock.
- Do not put heavy objects on the power cord or change the power cord.
- Please unplug the power socket before cleaning and maintenance.
- Please hold the charger when unplugging the socket otherwise it may damage the power cord and cause an electric shock and fire.

1.3 Cleaning and maintenance

- The phone, battery and charger are not waterproof so please do not use them in places of high humidity and avoid use in the rain.

- Please clean the battery and charger with a soft dry cloth.
- Never use alcohol, thinner or solutions like benzene, to wipe the phone.
- Please clean the sockets periodically as dirty sockets can cause poor contact and power down the phone. It can also prevent recharging.

1.4 Common Precaution

Mobile Phone:

- Please use the phone in environments with temperature between 5°C and 40°C and humidity between 35% and 38%.
- Please do not use the handset near telephones, TV sets, radios and office automation equipment to avoid affecting the normal use of these equipment and the mobile phone.

Battery:

- Keep the battery in cool and ventilated places away from direct sunlight.
- The battery has a limited lifespan. The use of the battery will be shortened progressively due to frequent charging. Once the battery is out of use it means that its lifespan has expired and it will need to be replaced.
- Do not dispose of old batteries as household waste.

Charger:

- Do not charge under the following conditions:
 - in direct sunlight
 - in temperature less than 5°C or over 40°C
 - wet or dusty places
 - near electrical appliances like TVs and radios (it may affect the image and sound).

Getting to know your touch phone



1. Earphone port
2. Power on/off key
3. Telephone receiver
4. Display screen
5. Up/down side key
6. From left to right: Menu /Home /Back key
7. Camera
8. Battery cover
9. USB port
10. Speaker

Starting up the device

1. To remove the back cover

- Make sure your device is turned off.
- Firmly hold the device with both hands with the front panel facing down.
- Open the panel from the bottom corner.
- The inside bottom of the phone has a notch. Lift the battery by the notch to remove it.

To install the SIM card

- Remove the battery if it is installed.
- Locate the SIM card slot, and then insert the SIM card with its gold contacts facing down and its cut-off corner facing the card slot.
- Slide the SIM card completely into the slot (See picture1).



Note: • The phone can be supported the double SIM cards. The card slot 1/2 will be both supported 3G SIM card (WCDMA), but one SIM card can use 3G networks only.

If you need to use 3G operation, please insert 3G card in the card slot 1(Default SIM1 card, defined in the menu Settings/More.../Mobile networks/3G service), the SIM2 card will be supported 2G network only (If insert 3G card in the card slot 2, you can also use 2G operation only).

• Some legacy SIM cards may not function with your device. You should consult with your service provider

for a replacement SIM card. There may be fees for this service.

To install a memory card

To have additional storage for your images, videos, music, and files, you can purchase a memory card and install it into your device.

Locate the memory card slot on the upper part of the exposed right panel. Insert the memory card into the slot with its gold contacts facing down until it clicks into place (See picture2).

(add picture)

To install the battery

1. Align the battery's exposed copper contacts with the battery connectors at the bottom part of the battery compartment.
2. Insert the contacts side of the battery first and then gently push the battery into place. Replace the back cover.



Charging the Battery

New batteries are shipped partially charged. Before you start using your device, it is recommended that you install and charge the battery. Some batteries perform best after several full charge/discharge cycles.

Note: Only the AC adapter and USB sync cable provided

with your device must be used to charge the device.
Connect the USB connector of the AC adapter to the sync connector on your device, and then plug in the AC adapter to an electrical outlet to start charging the battery. As the battery is being charged while the device is on, a charging icon appears in the title bar of the Home screen. After the battery has been fully charged, a full battery icon appears in the title bar of the Home screen.

Warning:

- Do not remove the battery from the device while you are charging it using the AC or car adapter.
- As a safety precaution, the battery stops charging before it overheats.

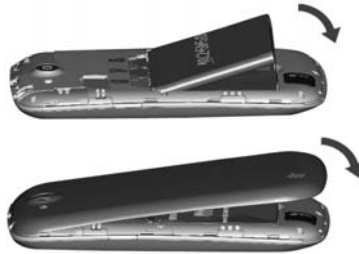

Power on/off

To power off your phone, press & hold POWER. On release, the Phone options menu opens. Select 'Power off' and confirm.

To power on again, press & hold POWER.

1. Switch Main Menu style

(1) In default Home screen, slide your fingertip left and right along the screen to reveal the Home screen.



(2) On the Home screen, click icon on the bottom of the screen to enter the main menu screen, slide your fingertip left and right along the screen to reveal more applications.



2. Home screen

(1) Read your notifications

When you see a notification in the status bar, touch the bar and slide your finger down the screen to open the list of notifications displayed in the sliding window.

Ongoing notifications report activities such as call forwarding ON, current call status, music playing.

Notifications report the arrival of new messages, calendar events, and alarms. You can clear the notifications list by selecting 'Clear' notifications at the top of the notifications window.

To open a message, reminder, or other notification, you can touch the item. To close the notifications window, slide your finger up the screen.

(2) Create Home screen shortcuts and widgets:

From the Home screen, click icon on the bottom of the screen to enter the main menu screen, slide your fingertip left along the screen to reveal the widgets.

Select an Application shortcut, a Shortcut to some of

your saved information (such as a playlist), a Widget (a clock or picture frame) for your Home screen.

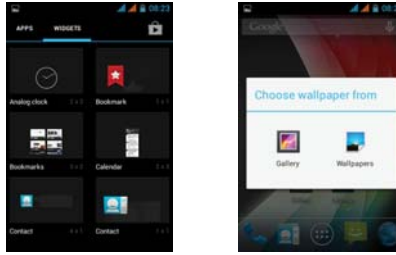

(3) Create Home screen wallpaper:

From the Home screen, touch and hold the blank screen, or click MENU Key and select 'Wallpaper', the menu opens. Select a wallpaper for your Home screen.

(4) Move objects on the Home screen

- To move an icon or other item on the Home screen, you must first touch and hold it to enter move mode. The object will magnify when it's ready to be moved.
- Without lifting your finger (or you'll drop out of move mode), drag the object to the new position. To move an item to a section of the Home screen not in view, move it to the edge of the screen and hold it there for a moment. The screen view will shift; position the object and release.

3. Camera

All the pictures you can capture or view on your phone are stored on the memory card, which must be installed in your phone. Before you can use the Camera or view pictures in Pictures, make sure you have a card installed.



4. GPRS/WLAN network

Your device's networking capabilities allow you to access the Internet or your corporate network through WLAN, GPRS, EDGE (if available), or WCDMA (if SIM card supported).

You can also add and set up a VPN or proxy connection.

To use WLAN on your device, you need access to a wireless access point or "hotspot".

Note: The availability and range of your device's WLAN signal depends on the number, infrastructure, and other objects through which the signal passes.

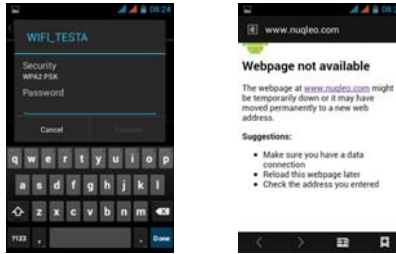

If you are in a 3G service area, a 3G mobile network will be displayed in the status bar.

5. U-disk storage

This phone supports movable storage, i.e., the U-disk function.

When the phone is switched on, you will see this icon  in the status bar on the top of the screen showing that the device is connected to a PC by a data line. Touch the bar and slide your finger down the screen to open the list of notifications displayed in the sliding window. Select [USB connected] and touch [Turn on USB storage] to confirm, you can use the phone as a U-disk.

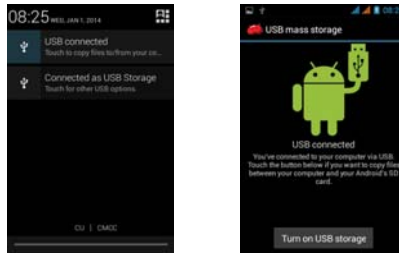

6. Music

Your music is organized into four categories: Artists, Albums, Songs, and Playlists. Select a category to view the lists within each. Once in a category, keep selecting until you reach the music you want to play.

7. Bluetooth

The phone supports Bluetooth functions; you can establish a wireless connection between the phone and other compatible devices with a distance of up to 10 meters. Bluetooth connections may be affected by obstacles such as walls or other electronic devices.

(1) Enter Settings menu, touch Bluetooth to open the function. The idle screen will display the Bluetooth icon in the status bar, select BT discoverable and other devices can search for the phone.

-Ensure your phone has Bluetooth-enabled;

-Select "Scan for devices" and Bluetooth devices within

the range of the phone will start appearing;
-Select the device you want to pair, confirm the password
to complete the pairing.
You can use Bluetooth to share pictures, videos or music
files.

Technical Specifications

Weight: 101.3g (Including battery)

Dimensions: 122*65*10.5mm

Band: GSM900MHz / DCS1800MHz / GSM850MHz / PCS1900MHz

WCDMA850MHz / 1900MHz

Battery Capacity: 1250mAh

Talk Time: about 5h

Standby Time: about 460h

Battery Time (No prior or separate notice is required for capacity changes)

Battery Time (No prior or separate notice is required for capacity changes)

Note: Actual operating conditions depend on the local network environment, SIM and user behavior.

Announcement: The manufacturer reserves the right to change or upgrade specifications or software versions without prior or separate notice.

Warning marks**Specific Absorption Rate (SAR) information**

SAR tests are conducted using standard operating positions accepted by the FCC with the phone transmitting at its highest certified power level in all tested frequency bands, although the SAR is determined at the highest certified power level, the actual SAR level

of the phone while operating can be well below the maximum value.

Before a new model phone is available for sale to the public, it must be tested and certified to the FCC that it does not exceed the exposure limit established by the FCC. Tests for each phone are performed in positions and locations as required by the FCC.

For body worn operation, this model phone has been tested and meets the FCC RF exposure guidelines when used with an accessory designated for this product or when used with an accessory that contains no metal.

This device complies with part 15 of the FCC Rules. Operation is subject to the following two conditions: (1) This device may not cause harmful interference, and (2) this device must accept any interference received, including interference that may cause undesired operation. Any Changes or modifications not expressly approved by the party responsible for compliance could void the user's authority to operate the equipment.

Note: This equipment has been tested and found to comply with the limits for a Class B digital device, pursuant to part 15 of the FCC Rules. These limits are designed to provide reasonable protection against harmful interference in a residential installation. This equipment generates uses and can radiate radio

frequency energy and, if not installed and used in accordance with the instructions, may cause harmful interference to radio communications. However, there is no guarantee that interference will not occur in a particular installation. If this equipment does cause harmful interference to radio or television reception, which can be determined by turning the equipment off and on, the user is encouraged to try to correct the interference by one or more of the following measures:

- Reorient or relocate the receiving antenna.
- Increase the separation between the equipment and receiver.
- Connect the equipment into an outlet on a circuit different from that to which the receiver is connected.
- Consult the dealer or an experienced radio/TV technician for help.