

Quick Start Guide

HyperX ChargePlay™ Clutch for Mobile

Overview

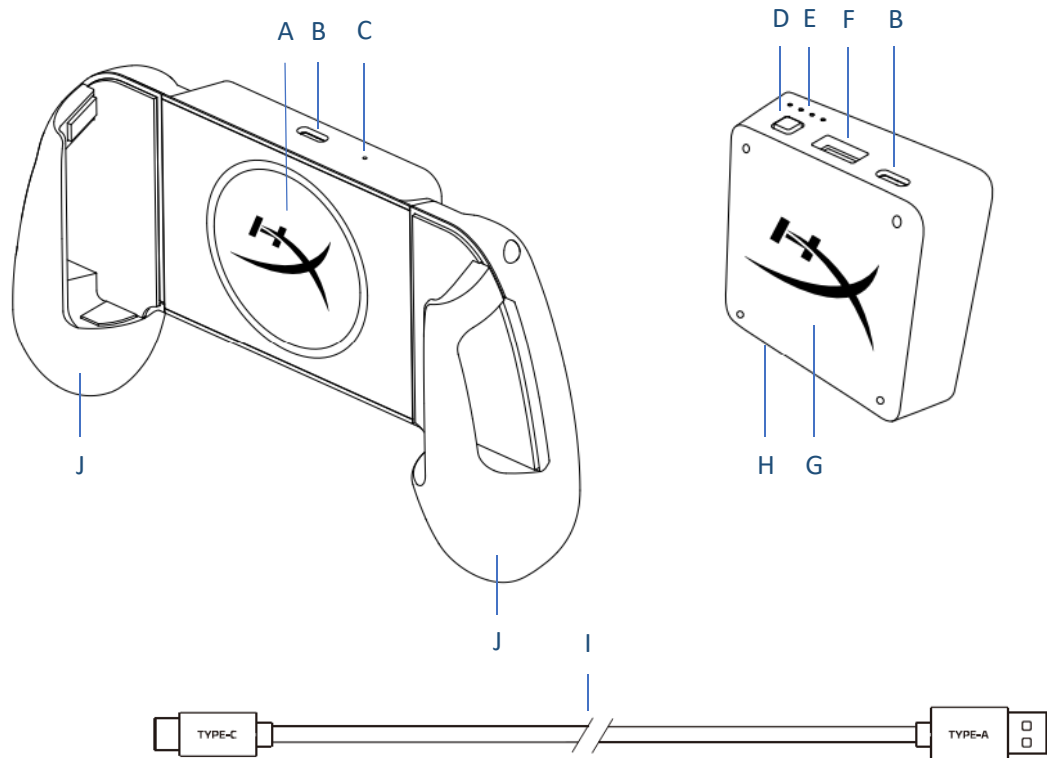

[Reference ChargePlay Clutch Nintendo Switch QSG for above USB cable asset]

- A. Qi Wireless Transmitter
- B. USB Type-C Port
- C. Qi Charging Status LED
- D. Power Button
- E. Battery Status Indicators
- F. USB Type-A Port
- G. Qi Wireless Receiver
- H. Removable Battery Pack
- I. Charging Cable
- J. Controller Grips

Charging

It is recommended to fully charge the battery before first use.

All four battery status indicators will illuminate solid when fully charged.

Wired Charging

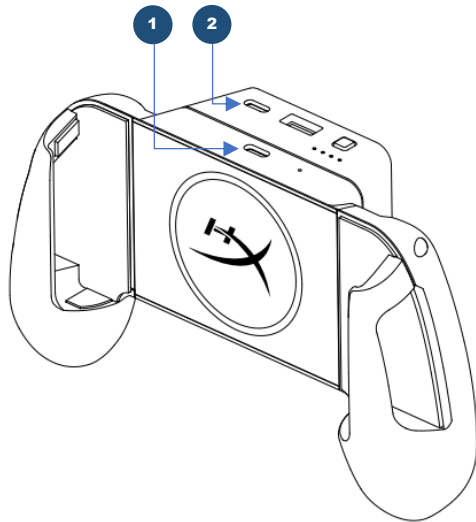

Connect USB Type-C to **1** or **2** to charge battery pack.

[Add arrows and labels to USB Type-C ports as mocked up in above]

Qi Wireless Charging

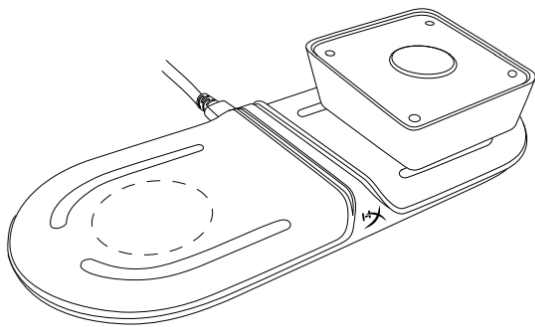

Place battery pack on Qi wireless charging base.

Usage

1.

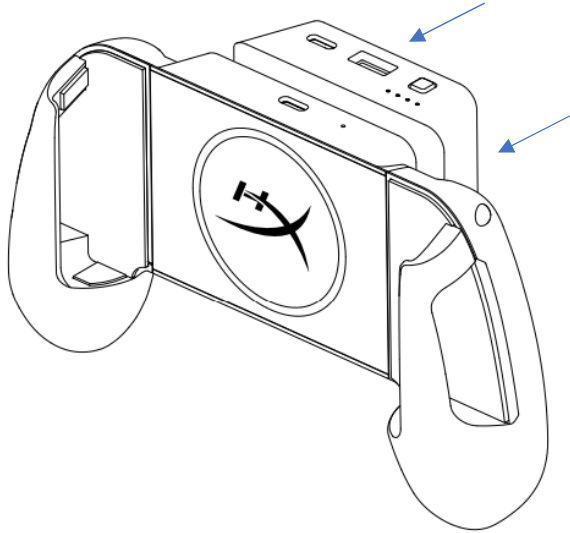

[Arrows pointing from battery pack to controller grips to illustrate direction of installation]

2.

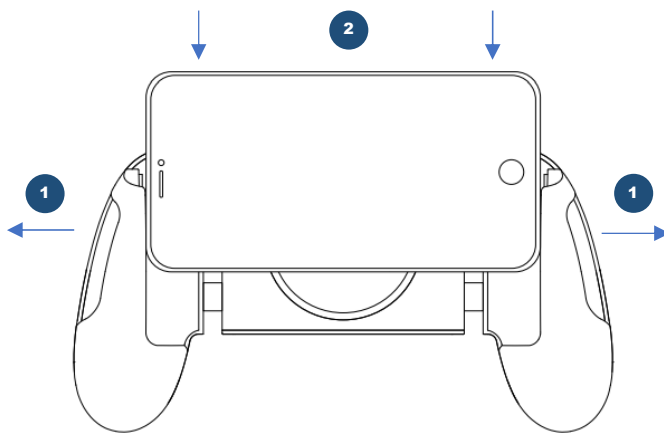

[Arrows point outward from grips. Arrows point in down direction showing phone installation. Label arrows numerically to indicate order of operations]

3.

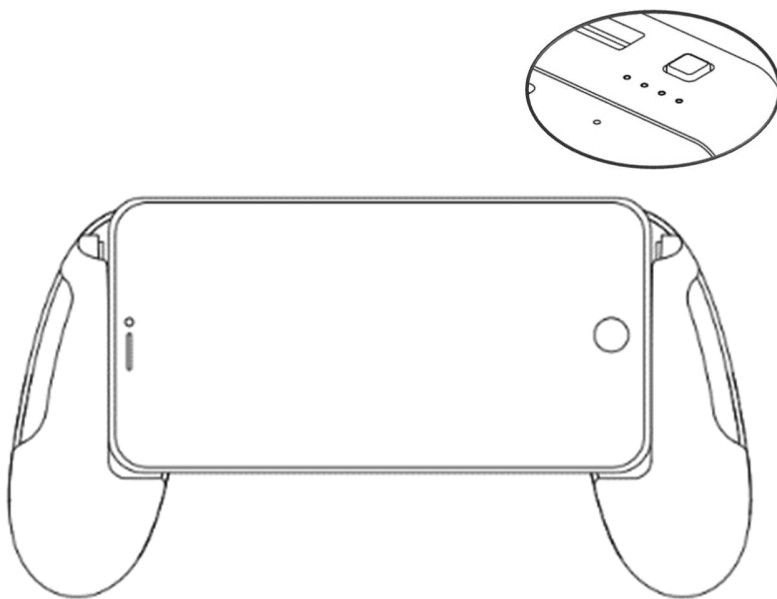

Power Button

Power on – Press to power on

Power off – Press and hold

Qi Charging Status LED

LED STATUS	QI CHARGING STATUS
ON	Charging
OFF	Not Charging

[Bubble call out of the power button and charging status indicators as mocked up in the above]

Battery Info

Battery Information

Capacity: 3000mAh/11.1Wh Li-ion Battery

Input: 5V=1.5A Max

Output: 5V=2A Max

Cannot be replaced by user

Questions or Setup issues?

Contact the HyperX Support Team at: <http://www.hyperxgaming.com/support>

This device complies with part 15 of the FCC Rules. Operation is subject to the following two conditions:

- (1) This device may not cause harmful interference, and
- (2) this device must accept any interference received, including interference that may cause undesired operation.

NOTE: This equipment has been tested and found to comply with the limits for a Class B digital device, pursuant to part 15 of the FCC Rules. These limits are designed to provide reasonable protection against harmful interference in a residential installation.

This equipment generates, uses and can radiate radio frequency energy and, if not installed and used in accordance with the instructions, may cause harmful interference to radio communications. However, there is no guarantee that interference will not occur in a particular installation.

If this equipment does cause harmful interference to radio or television reception, which can be determined by turning the equipment off and on, the user is encouraged to try to correct the interference by one or more of the following measures:

- Reorient or relocate the receiving antenna.
- Increase the separation between the equipment and receiver.
- Connect the equipment into an outlet on a circuit different from that to which the receiver is connected.
- Consult the dealer or an experienced radio/TV technician for help.

Changes or modifications not expressly approved by the party responsible for compliance could void the user's authority to operate the equipment.

This device contains licence-exempt transmitter(s) that comply with Innovation, Science and Economic Development Canada's licence-exempt RSS(s). Operation is subject to the following two conditions:

- (1) this device may not cause interference,
- (2) this device must accept any interference, including interference that may cause undesired operation of the device.

L'émetteur exempt de licence contenu dans le présent appareil est conforme aux CNR d'Innovation, Sciences et Développement économique Canada applicables aux appareils radio exempts de licence. L'exploitation est autorisée aux deux conditions suivantes :

- 1) L'appareil ne doit pas produire de brouillage;
- 2) L'appareil doit accepter tout brouillage radioélectrique subi, même si le brouillage est susceptible d'en compromettre le fonctionnement.