

UHF

MASCOT

# USER'S MANUAL

WIRELESS MICROPHONE SYSTEM

RS-51B / RS-55B

RS-31B / RS-33B

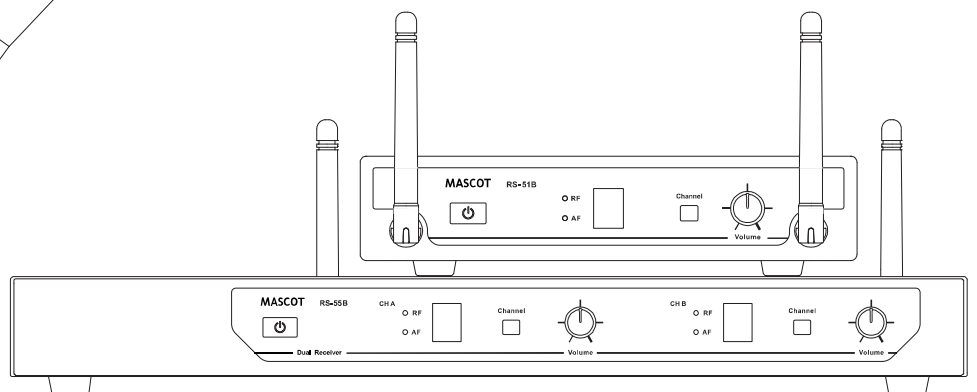
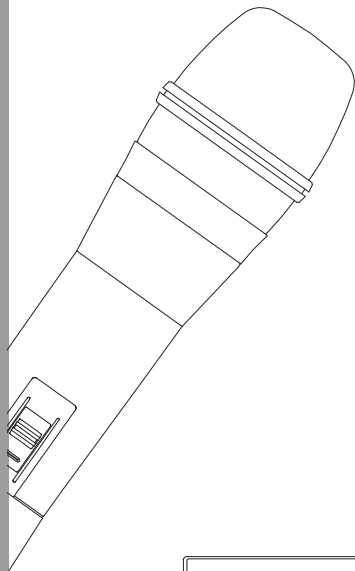
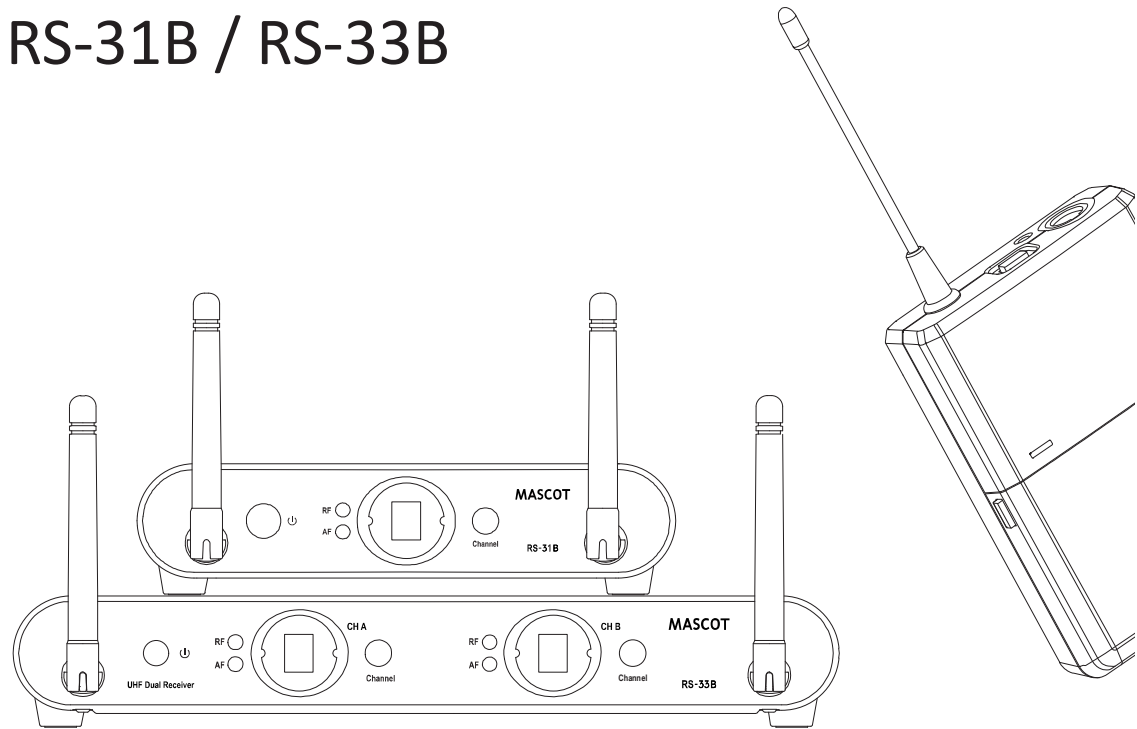

**Contents:**

Introduction .....	1
Quick Start Guide .....	2
Product Description .....	4
System Operation.....	10
Color Label Identification .....	13
Trouble Shooting .....	14
Specification .....	15

## ● Introduction

Thank you for purchasing our product. This PLL synthesized wireless microphone system operates in UHF band frequency with 8 selectable channels. Please read this instruction manual carefully before operating the system. This manual covers the function and operation of the wireless microphone system.

### ◆ FCC Statement

This device complies with part 15 of the FCC rules. Operation is subject to the following two conditions: (1) This device may not cause harmful interference and (2) This device must accept any interference received, including interference that may cause undesired operation.

Notice : The changes or modifications not expressly approved by the party responsible for compliance could void the user's authority to operate the equipment.

**IMPORTANT NOTE:** To comply with the FCC RF exposure compliance requirements, no change to the antenna or the device is permitted. Any change to the antenna or the device could result in the device exceeding the RF exposure requirements and void user's authority to operate the device.

### ◆ Safety

- Do not spill liquid on the appliance and do not drop it on a hard concrete floor.
- Do not place the equipment near heat sources such as radiators, heating ducts, amplifier, etc.
- Do not expose the equipment to direct sunlight, extremely dust, excessive moisture, rain, mechanical vibrations, or shock.
- Take out the battery from transmitter, if the appliance has been not used for a longer period. This will avoid the damage resulting from a defective leaking battery.
- If the equipment is not going to be used for a long time, disconnect the AC adapter from the power outlet. Please note that if you turn the equipment off while leaving the AC adapter plugged in, it is not fully isolated from the power supply.
- **WARNING:** To reduce the risk of fire or electric shock, do not use the products near water and do not expose them to rain or moisture.
- No guarantee claims for the equipment and no liability for any resulting personal damage or material damage will be accepted if the equipment is used for other purpose than originally intended, if the equipment is not correctly connected or operated, or if the equipment is not repaired in an expert way.

### ◆ Environment

- Do not throw used batteries into a fire or garbage bin with domestic rubbish. Be sure to dispose of used batteries in accordance with local waste disposal rules.
- When disposing the equipment, remove the batteries, separate the case, circuit boards, and cables, and dispose of all components in accordance with local waste disposal rules.

# Quick Start Guide

## 1. Connected Receiver Power Cable

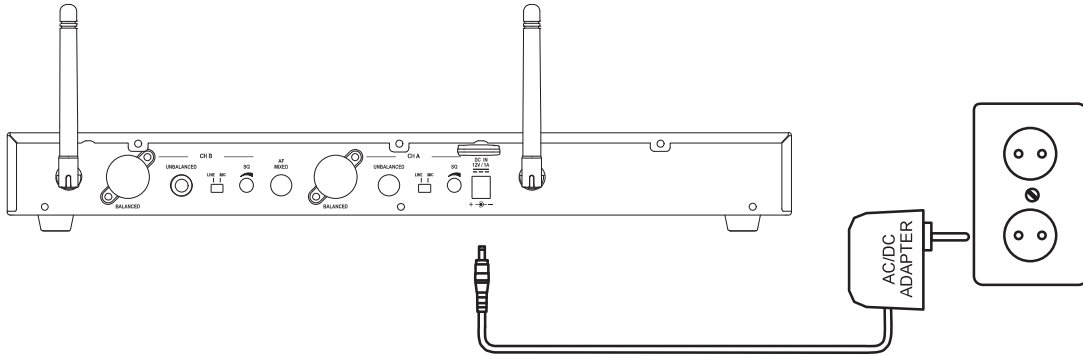

## 2. Connect Mixer or Amplifier

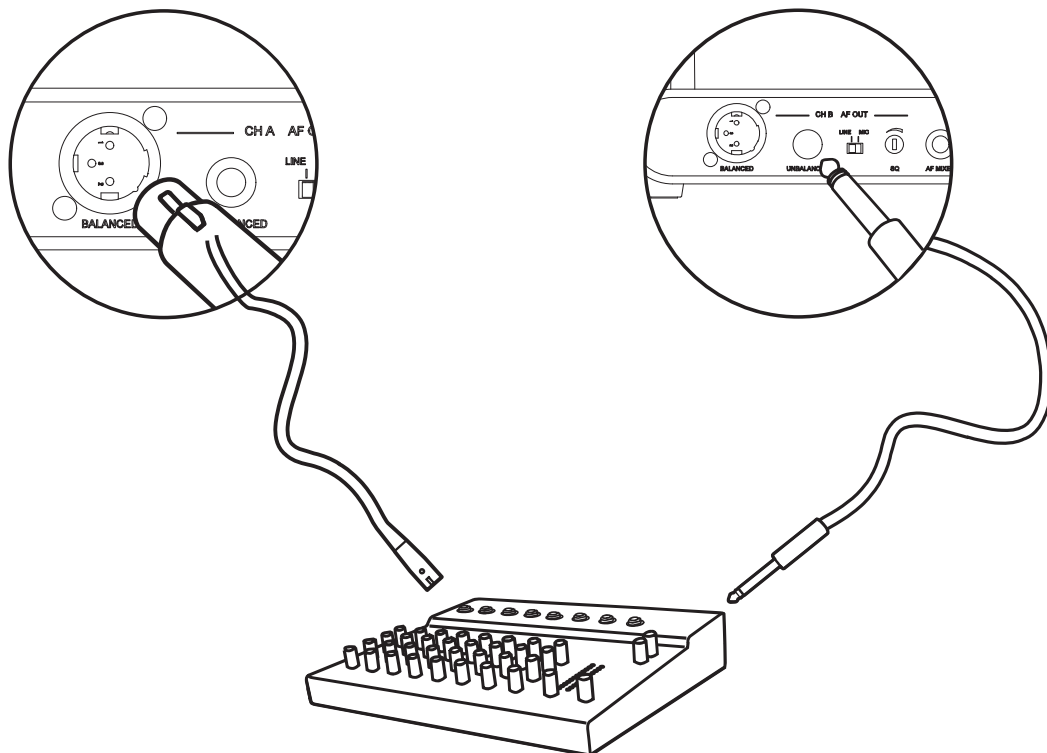

# Quick Start Guide

## 3. Insert Batteries

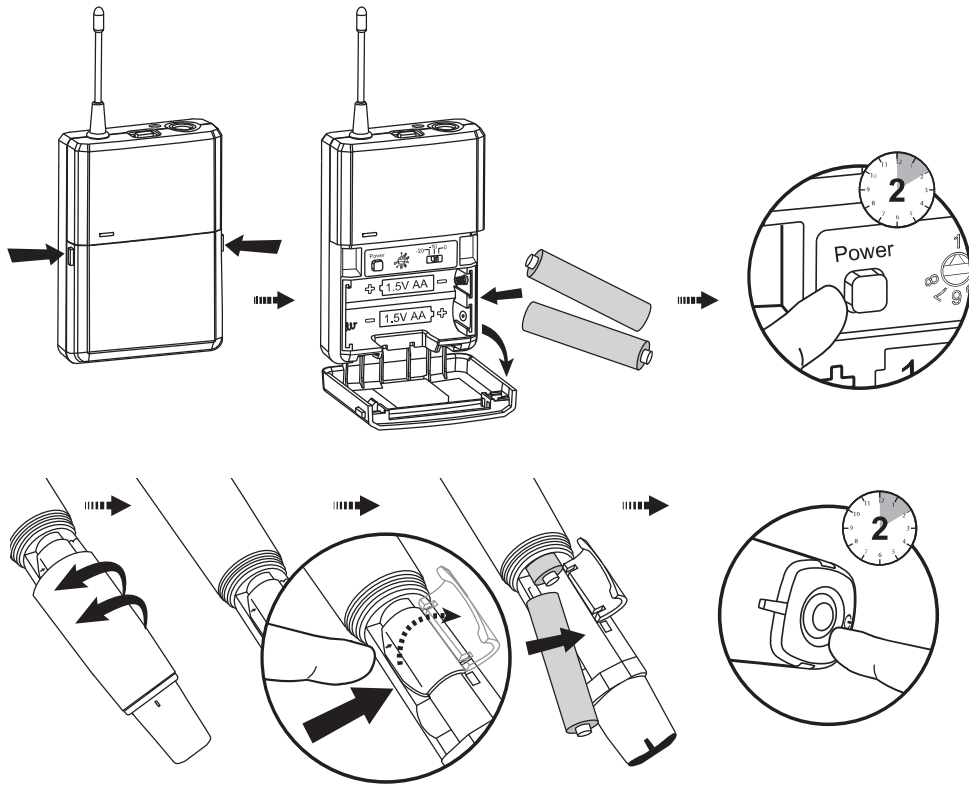

## 4. Select channel

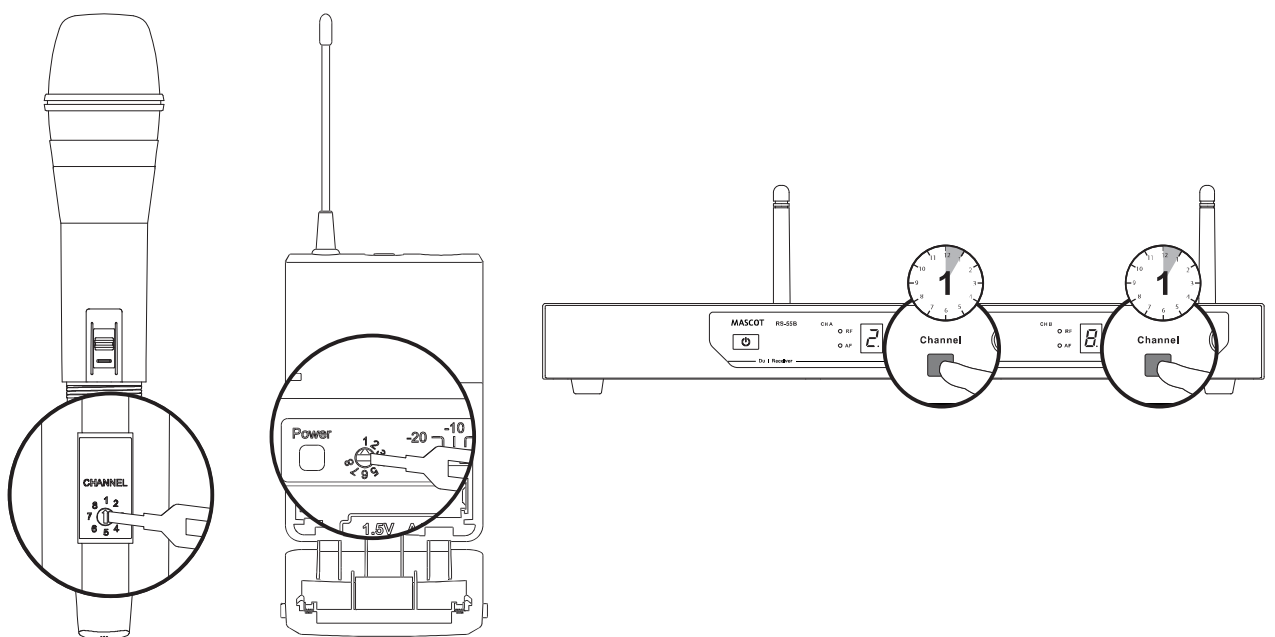

● **Receiver**

Front :

**RS-51B: Diversity Receiver**

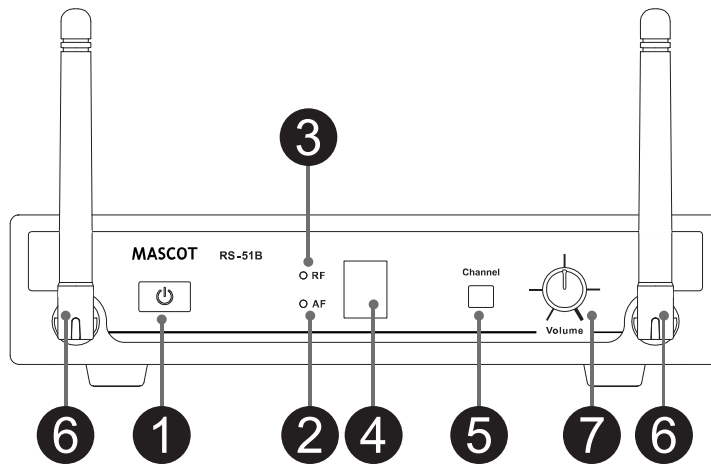

1. Power Button: Press and hold for 2 sec. to turn the power on. Press and hold for 2 sec. to turn the power off.
2. AF Indicator: The indicator glows to indicate that audio signal has been received.
3. RF Indicator: The indicator glows to indicate that RF signal has been received.
4. LED Display: The 7 segment LED display shows the selected preset channel.
5. Channel Selector: Press and hold for 1 sec. to select the operating channels.
6. Antenna: Fixed UHF antenna.
7. Volume Control: Adjust the receiver output level.

Rear :

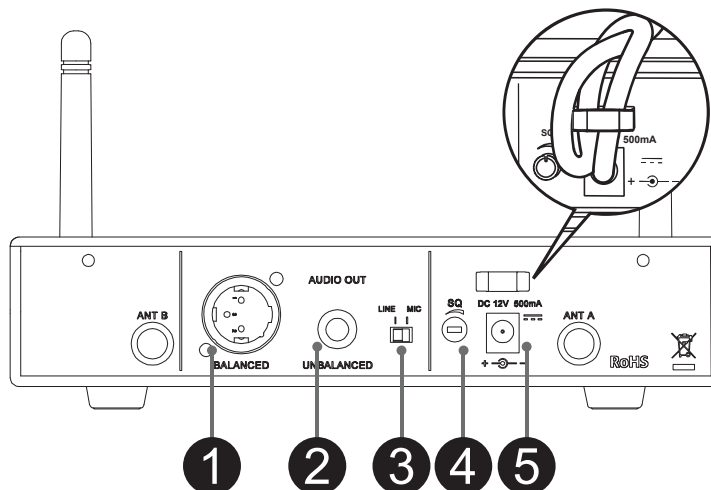

1. Balanced XLR Audio Output
2. Unbalanced 6.35mm Audio Output
3. MIC/LINE Switch: Use this switch to adjust audio output level for MIC level (-20dB) or LINE level (0dB).
4. Squelch: Turn the knob to adjust the noise floor level.
5. DC Input Jack

● **Receiver**

Front :

RS-55B: Diversity Receiver

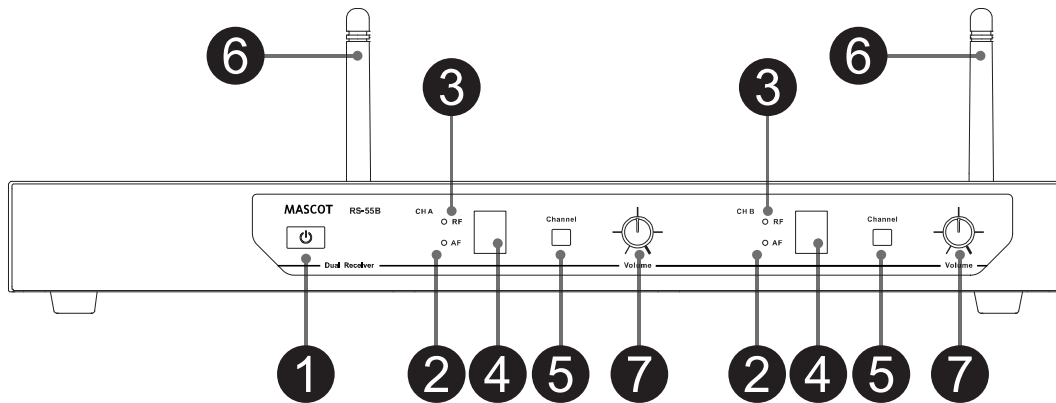

1. Power Button: Press and hold for 2 sec. to turn the power on. Press and hold for 2 sec. to turn the power off.
2. AF Indicator: The indicator glows to indicate that audio signal has been received.
3. RF Indicator: The indicator glows to indicate that RF signal has been received.
4. LED Display: The 7 segment LED display shows the selected preset channel.
5. Channel Selector: Press and hold for 1 sec. to select the operating channels.
6. Antenna: Fixed UHF antenna.
7. Volume Control: Adjust the receiver output level.

Rear :

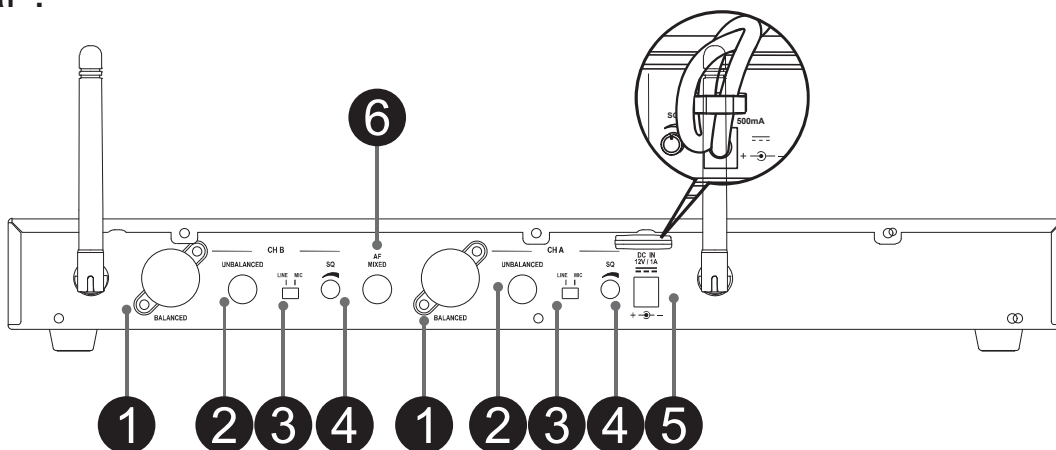

1. Balanced XLR Audio Output
2. Unbalanced 6.35mm Audio Output
3. MIC/LINE Switch: Use this switch to adjust audio output level for MIC level (-20dB) or LINE level (0dB).
4. Squelch: Turn the knob to adjust the noise floor level.
5. DC Input Jack
6. Mix Out: The audio output for CH A and CH B is mixed.

● **Receiver**

Front :

**RS-31B: Diversity Receiver**

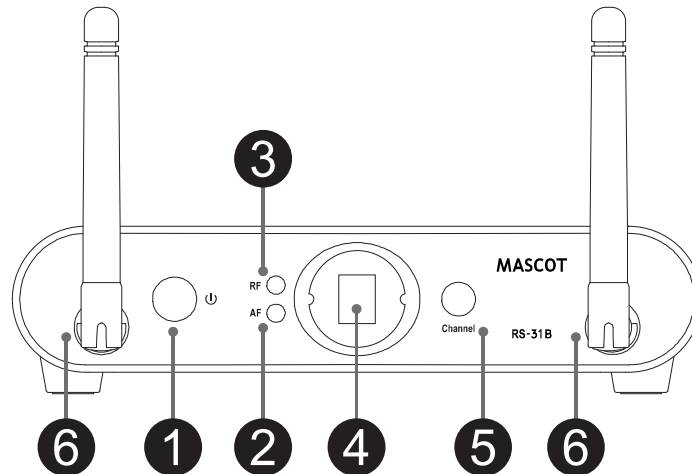

1. Power Button: Press and hold for 2 sec. to turn the power on. Press and hold for 2 sec. to turn the power off.
2. AF Indicator: The indicator glows to indicate that audio signal has been received.
3. RF Indicator: The indicator glows to indicate that RF signal has been received.
4. LED Display: The 7 segment LED display shows the selected preset channel.
5. Channel Selector: Press and hold for 0.5 sec. to select the operating channels.
6. Antenna: Fixed UHF antenna.

Rear :

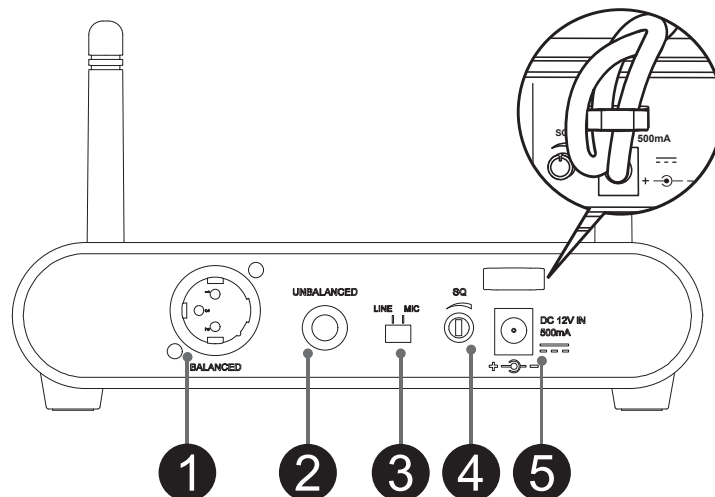

1. Balanced XLR Audio Output
2. Unbalanced 6.35mm Audio Output
3. MIC/LINE Switch: Use this switch to adjust audio output level for MIC level (-20dB) or LINE level (0dB).
4. Squelch: Turn the knob to adjust the noise floor level.
5. DC Input Jack



PRODUCT DESCRIPTION	<b>WIRELESS</b>
---------------------	-----------------

● **Receiver**

Front :

**RS-33B: Diversity Receiver**

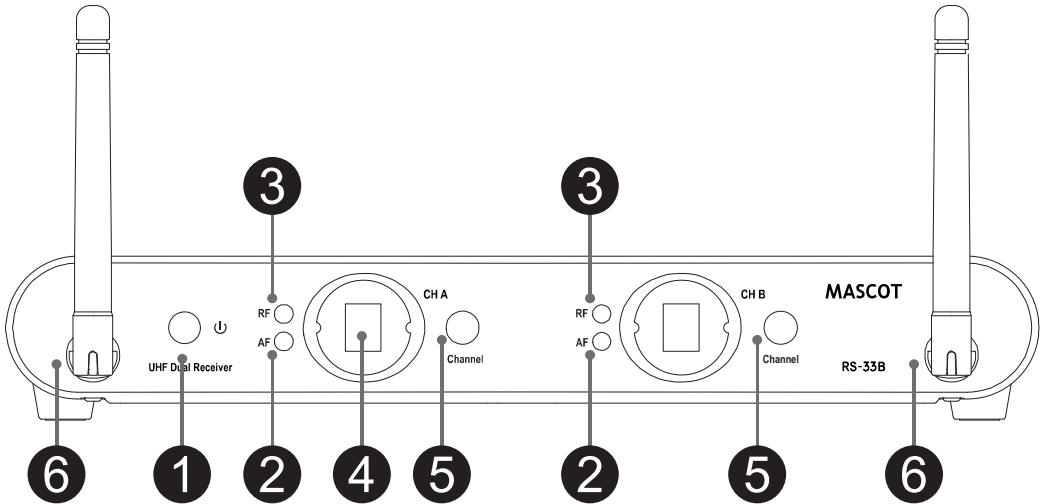

1. Power Button: Press and hold for 2 sec. to turn the power on. Press and hold for 2 sec. to turn the power off.
2. AF Indicator: The indicator glows to indicate that audio signal has been received.
3. RF Indicator: The indicator glows to indicate that RF signal has been received.
4. LED Display: The 7 segment LED display shows the selected preset channel.
5. Channel Selector: Press and hold for 0.5 sec. to select the operating channels.
6. Antenna: Fixed UHF antenna.

Rear :

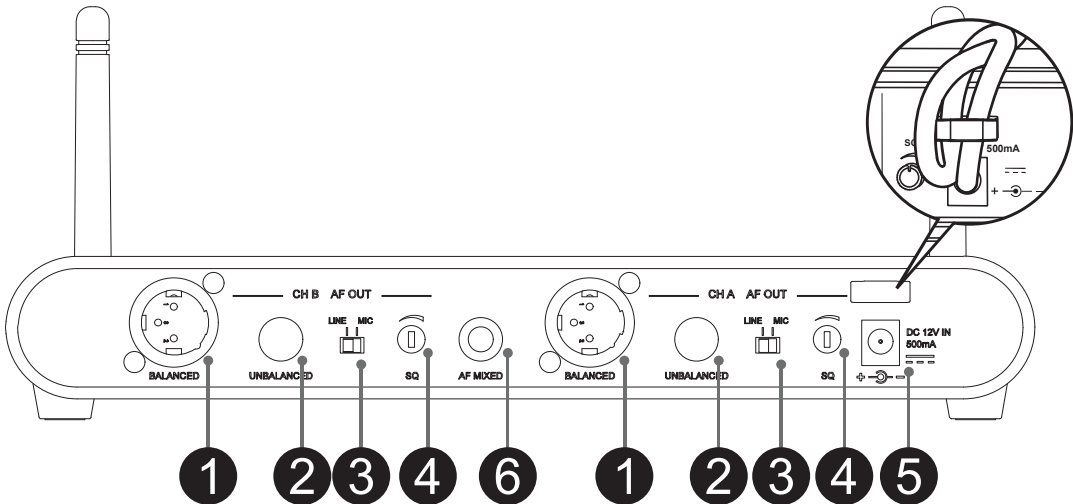

1. Balanced XLR Audio Output
2. Unbalanced 6.35mm Audio Output
3. MIC/LINE Switch: Use this switch to adjust audio output level for MIC level (-20dB) or LINE level (0dB).
4. Squelch: Turn the knob to adjust the noise floor level.
5. DC Input Jack
6. Mix Out: The audio output for CH A and CH B is mixed.

● **UF-31B Handheld Microphone**

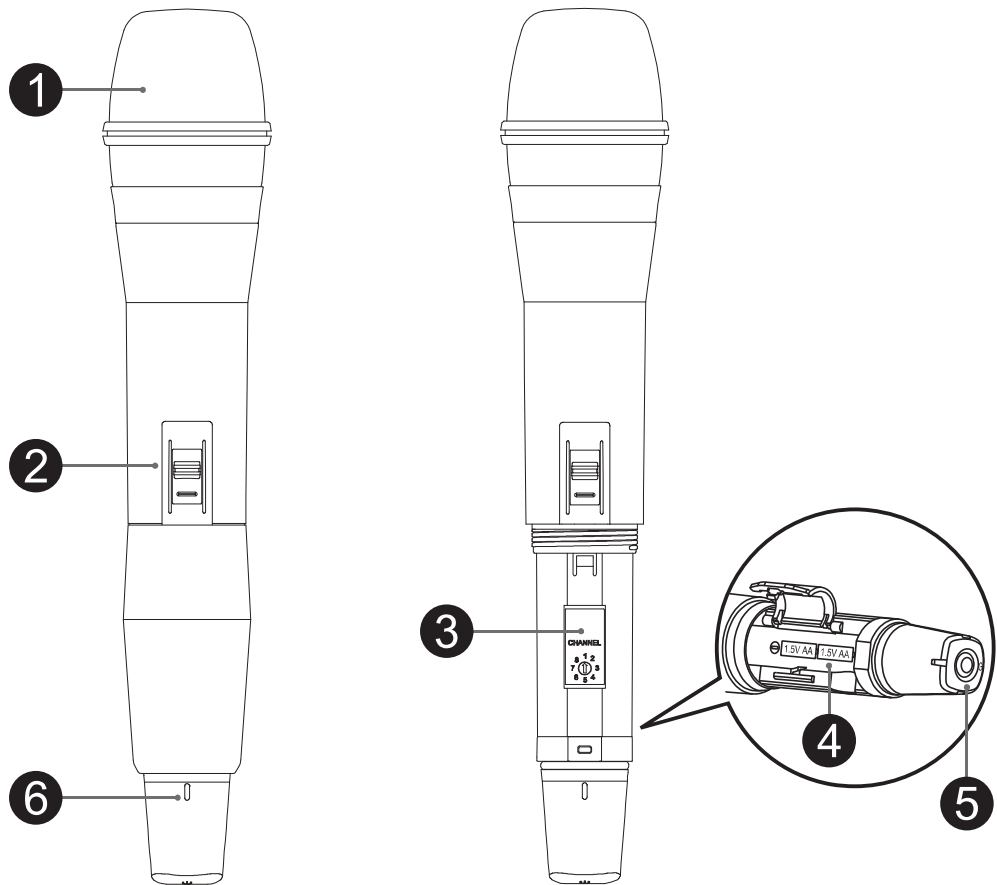

1. Grille: Protects the microphone capsule and helps reduce breath sounds and wind noise.
2. Talk Switch: Slide up the switch to talk and slide down to mute.
3. Channel Selector: 8 different selectable channels.
4. Battery Compartment: Insert two AA batteries here and make sure that the polarity of batteries is correct.
5. Power Button: Press and hold for 2 sec. to turn the power on or off.
6. Power LED: Indicate the power / low battery level status.

LED Indicator	Status
Green	Ready
Flashing Red	Low battery / power when less than 10 minutes operation

● **UT-51B Bodypack Transmitter**

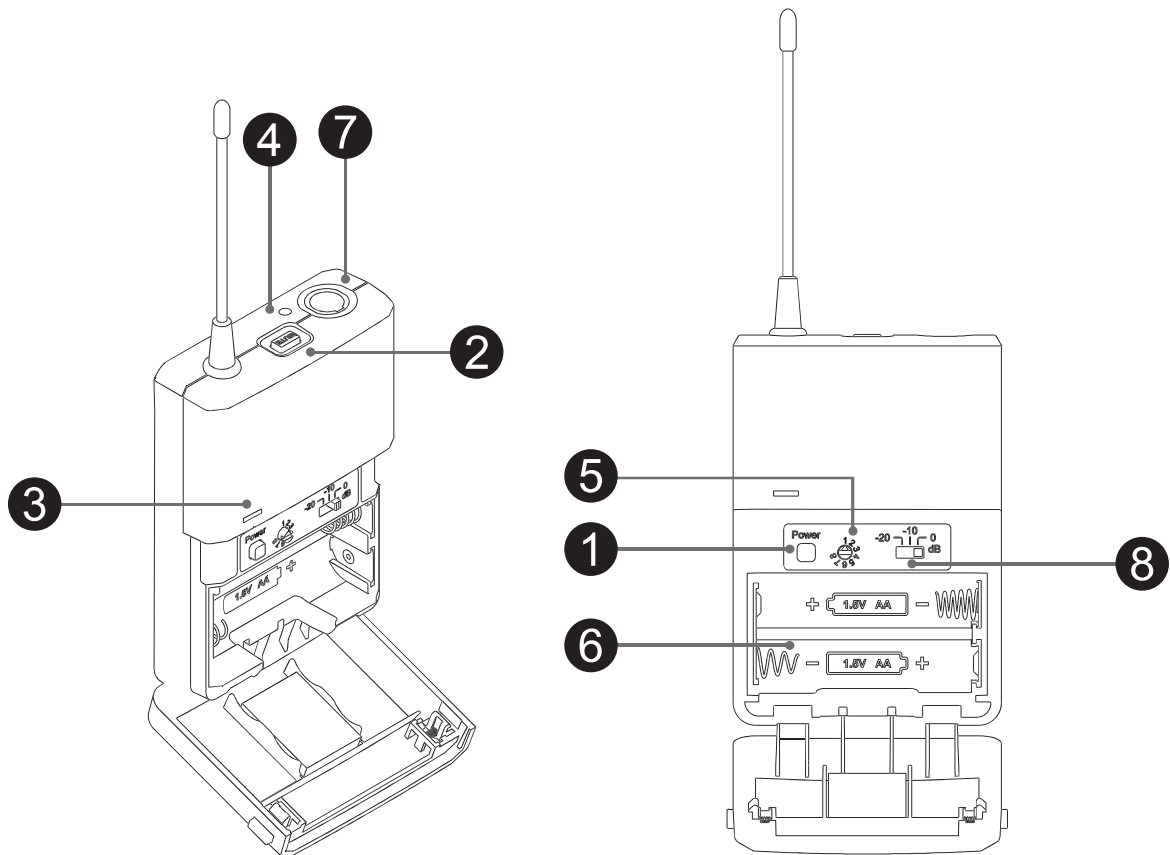

1. Power Button: Press and hold for 2 sec. to turn the power on or off.
2. Mute Button: With the transmitter on, a slight press for button will toggle between mute and unmute function.
3. Power LED: Indicate the power / low battery level status.

LED Indicator	Status
Green	Ready
Flashing Red	Low battery / power when less than 10 minutes operation

4. Mute LED: Blue LED light on in mute status.
5. Channel Selector: Select the channel.
6. Battery Compartment: Insert two AA batteries here and make sure that the polarity of batteries is correct.
7. Mini XLR Connector: Connect to the lapel microphone or headset microphone.
8. Gain Switch: The switch sets the audio input to -20dB, -10dB, 0dB

● **Connecting the receiver**

Prior to setting up, please check that the transmitter and receiver are tuned to the same frequency or channel. Two or more transmitters operating in the same frequency can not be used at the same time and area.

1

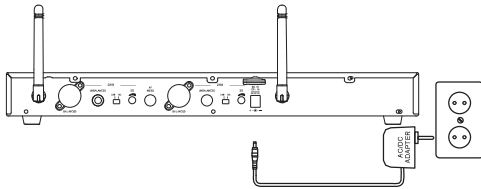

- Connected the provided DC power supply to the receiver power input with an appropriate AC power source. The LCD display will light and the receiver is on.

2

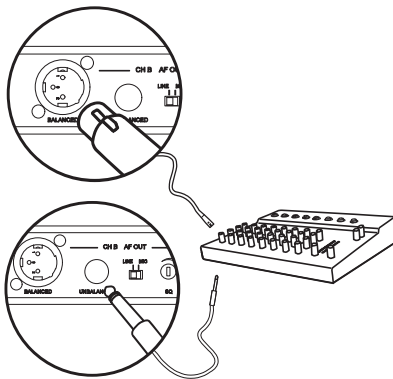

- Using a standard audio cable with 3-pin XLR connectors or 6.3mm phone plugs to connect the mixer or amplifier.
- ✧ Never use the balanced and unbalanced audio outputs at the same time! This may cause signal loss or increased noise.

3

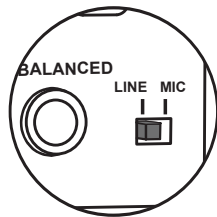

- Set the audio output level for  
MIC: -20dB  
LINE: 0dB (Default Setting)

4



- Using the Volume Controller to adjust the AF audio level to the input of the amplifier or mixer.
- ✧ Default Setting: In minimum VOLUME position.

5

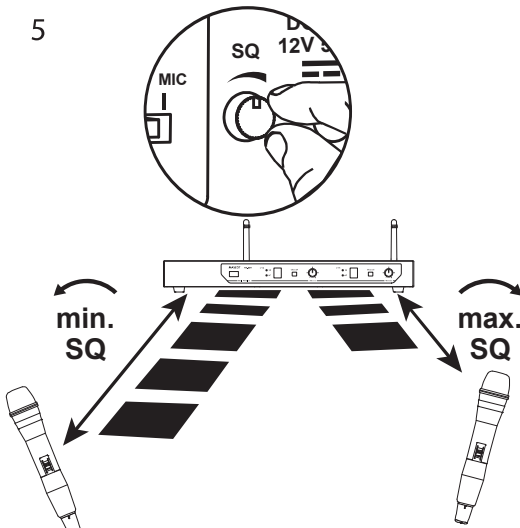

- Use squelch to eliminate or suppress the ambient RF noise.
- ✧ Defaulting Setting: In properly position.

- **Set up the handheld microphone / bodypack transmitter**

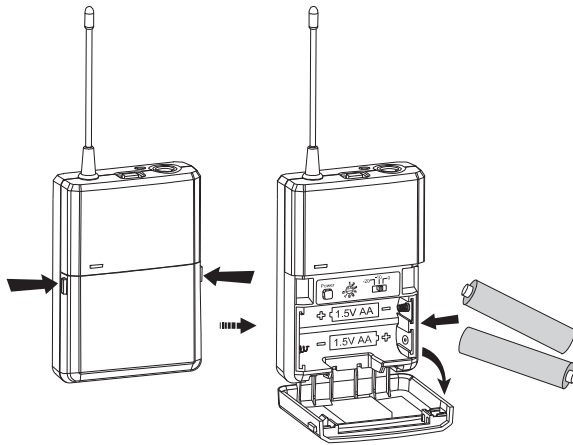

- Open the battery cover and insert batteries into the battery compartment conforming to the polarity (+)(-) marks.

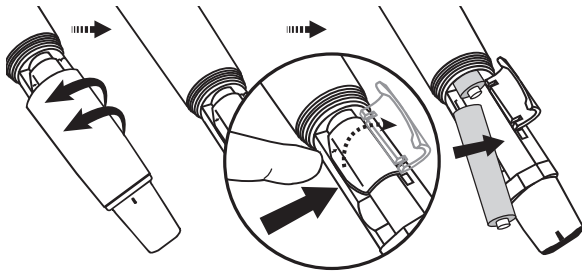

- Unscrew the handheld Mic and open the battery cover to insert the battery into the battery compartment and confirm the marks of the polarity (+) (-).

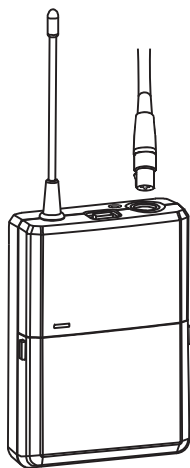

- Connect to the lavalier microphone, headset microphone or guitar cable.

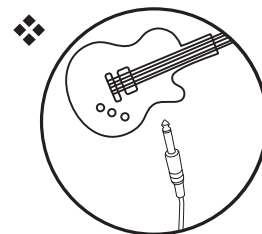
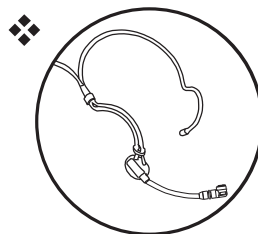
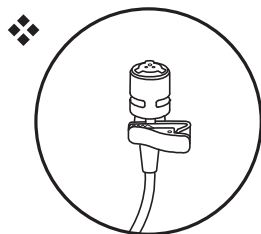

NOTE: When you don't use this device for a long term period, please switch the power switch to "off" mode to save more electric power.

● **Set up the handheld microphone / bodypack transmitter**

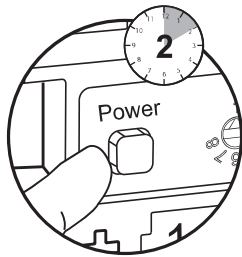

Bodypack

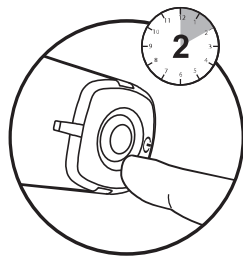

Handheld

- Press for 2 seconds to turn the Handheld/ Bodypack transmitter on.
- ✧ If the LED stays flashing, it indicates that the battery will run out of power soon and should be changed.

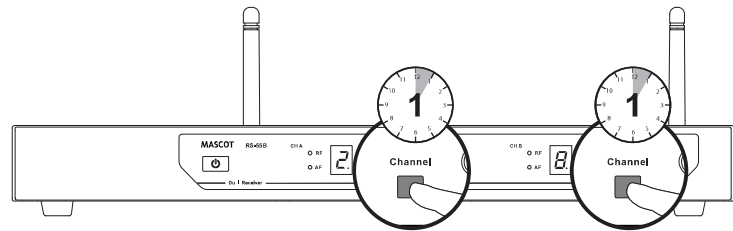
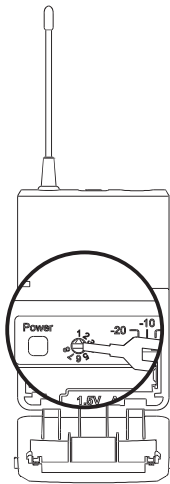
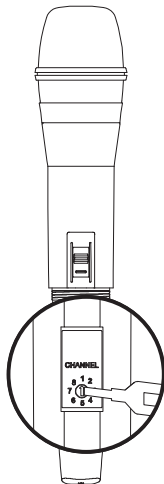

- Press Channel button on the receiver to select for the clear channel.
- Use the adjust pin to set the channel of the transmitter.

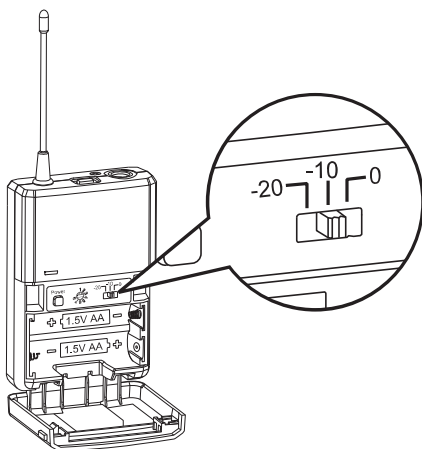

- Adjust the audio input level.
  - 0dB
  - -10dB (Default Setting)
  - -20dB



• 0dB



• -10dB

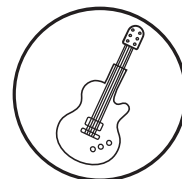

• -20dB

NOTE: When you don't use this device for a long term period, please switch the power switch to "off" mode to save more electric power.

● **Color Label Identification**

You can also stick the color label on the receiver and transmitter for quickly identify the pair system.

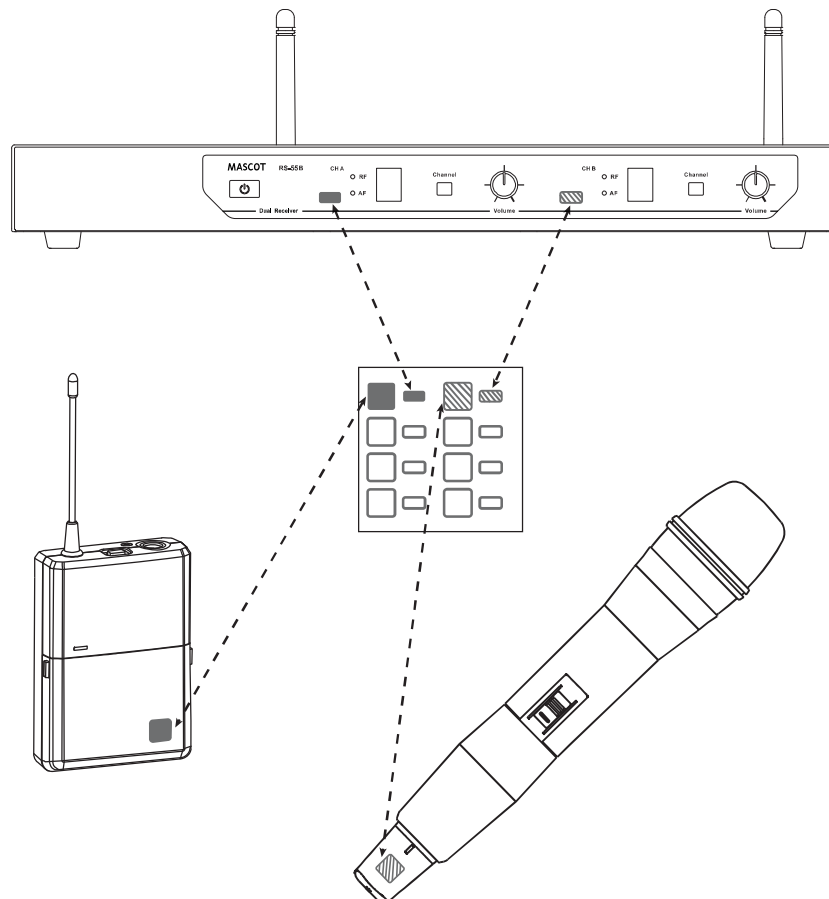
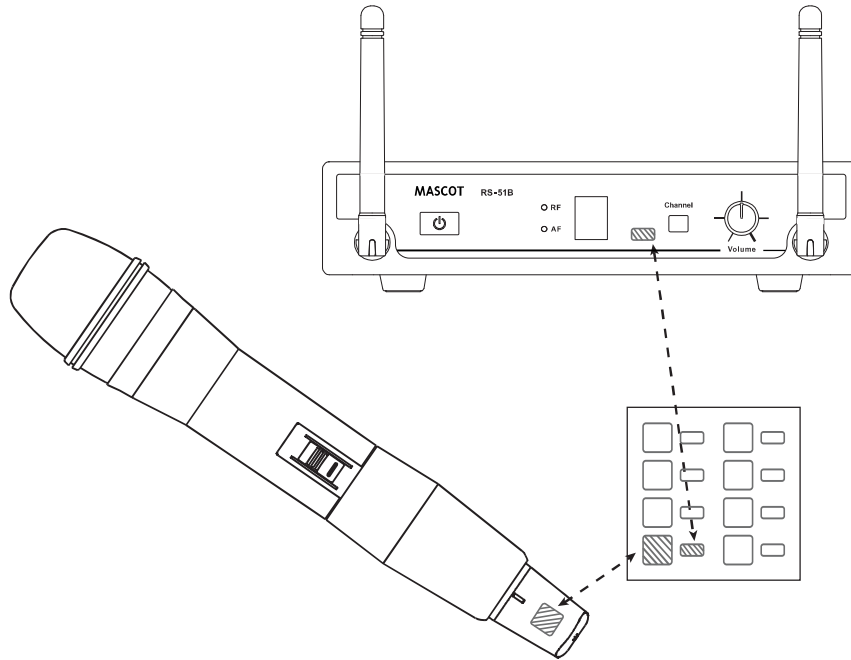

## ● Trouble Shooting

<b>Problem</b>	<b>Solution</b>
No sound	<ul style="list-style-type: none"><li>➤ Check the power supply of the microphone and receiver.</li><li>➤ Check that the transmitter and receiver are tuned to the same frequency.</li><li>➤ Check whether the hi-fi appliance is switched on and the receiver output is connected to audio mixer or amplifier input.</li><li>➤ Check whether transmitter is too far away from receiver or SQUELCH control set too high.</li><li>➤ Check whether receiver is located too near metal object or there are obstructions between transmitter and receiver.</li></ul>
Sound interference	<ul style="list-style-type: none"><li>➤ Check the antenna location.</li><li>➤ When using 2 or above microphone sets simultaneously, make sure that the chosen frequencies are not interfered.</li><li>➤ Check whether the interference comes from other wireless microphones, TV, radio and etc.</li></ul>
Distortion	<ul style="list-style-type: none"><li>➤ Check the receiver volume level whether is set too high or too low.</li><li>➤ Check whether the interference comes from other wireless microphones, TV, radio and etc.</li></ul>



## ● System Performance

### Receiver

- Frequency Range : UHF520 ~ 937.5MHz (Regionally Selected)
- Case : RS-51B : Half 19" EIA Rack Case  
RS-55B : 19" EIA Rack Metal Case  
RS-31B : Mini Case  
RS-33B : Mini Case
- Oscillator : PLL Synthesized
- Modulation : FM
- S/N Ratio : >100dB, at 20KHz deviation and 60dBμV antenna input
- Image & Spurious Rejection : 70dB minimum
- Receiving Sensitivity : At 5μV over 70dB S/N ratio
- AF Response : 50Hz to 18KHz
- T.H.D. : <1% (at 1KHz)
- IF Frequency : 1st: 243.95MHz 2nd: 10.7MHz
- Dynamic Range : >100dB
- Tone Signal : 32.768KHz
- Audio Output : Balanced & Unbalanced
- Power Supply : DC12V
- Current Consumption : RS-51B : 150±10mA / RS-55B : 350±10mA  
RS-31B : 120±10mA / RS-33B : 350±10mA
- Dimension(MM) WxHxD : RS-33B : 262x42x102  
RS-31B : 170x42x102  
RS-55B : 400x42x183  
RS-51B : 200x42x122
- Weight : RS-51B : 365g / RS-55B : 1445g  
RS-31B : 260g / RS-33B : 375g

### Handheld/Bodypack Transmitter

- Frequency Range : UHF520 ~ 937.5MHz (Regionally Selected)
- Channel Select : Rotary switch
- Display : LED shows the battery status
- RF Power Output : 10mW (max.)
- Frequency Stability : ±0.005%
- Spurious Emission : >60dB below carrier frequency
- Gain Setting : **Bodypack** : 0dB, -10dB, -20dB (3 settings)
- Mic Unit : **Handheld** : Uni-Direction dynamic unit or  
Uni-Direction electret condenser unit  
**Bodypack**: Lavalier Mic / Headset Mic
- Battery : DC3V (1.5V x 2AA size batteries)
- Current Consumption : 120±10mA
- Dimension(mm) WxHxD : **Handheld** : 260x54Φ  
**Bodypack** : 65x97x25
- Weight : **Handheld** : 240g      **Bodypack** : 84g

\*The specifications are subject to change without notice.

# MASCOT ELECTRIC CO.,LTD

## Warranty card

Product Model: \_\_\_\_\_ Product Serial Number: \_\_\_\_\_

Purchaser : \_\_\_\_\_ Phone: \_\_\_\_\_

Address: \_\_\_\_\_

Warranty Period: One year from purchase Date of purchase: \_\_\_\_\_

### Warranty & Service Terms:

- ◆ Please read the instruction manual carefully before operation.
- ◆ The period of warranty shall start from the date of purchase of the product and shall cover a period of one year. If our product has malfunctioned under proper operation, we will repair it without any charge.
- ◆ During the warranty period, we may charge you maintenance cost if the following situations have happened:
  1. Improper usage or self-disassembly of the machine and accessories which cause product damage.
  2. Any damage due to natural disaster or force majeure.
  3. Consumable parts are excluded from warranty (e.g. microphone capsule, grille, etc.)
- ◆ Please well keep this warranty card.  
It will not be re-issued if lost or damaged.

MASCOT ELECTRIC CO.,LTD  
No.85, Changxing 1st St., Rende Dist., Tainan City 717, Taiwan  
Service Number 886-6-2710171



**MASCOT**



