

17 Antenna Drawing

2.1033 (c) (12)

NAME: EFCUSER OBJECT: CV90-88112 DATE: 23-May-00 16:50:05

ALL DATA AND INFORMATION CONTAINED IN OR DISCLOSED BY THIS DOCUMENT IS CONFIDENTIAL AND PROPRIETARY INFORMATION OF QUALCOMM INCORPORATED AND ALL RIGHTS THEREIN ARE EXPRESSLY RESERVED. BY ACCEPTING THIS MATERIAL THE RECIPIENT AGREES THAT THIS MATERIAL AND THE INFORMATION CONTAINED THEREIN IS HELD IN CONFIDENCE AND IN TRUST AND WILL NOT BE USED, COPIED, REPRODUCED IN WHOLE OR IN PART, NOR ITS CONTENTS REVEALED IN ANY MANNER TO OTHERS WITHOUT THE EXPRESS WRITTEN PERMISSION OF QUALCOMM INCORPORATED. EXPORT OF THIS TECHNOLOGY MAY BE CONTROLLED BY THE U.S. GOVERNMENT. VIOLATION CONTRARY TO U.S. LAW PROHIBITED.

DWG NO.	CV90-88112	SH	14	REV	B
REVISIONS					
REV	DESCRIPTION	DATE	APPROVED		
B	SEE SHEET 1	---	-----		

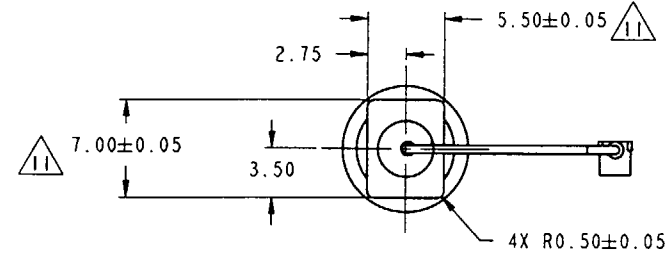
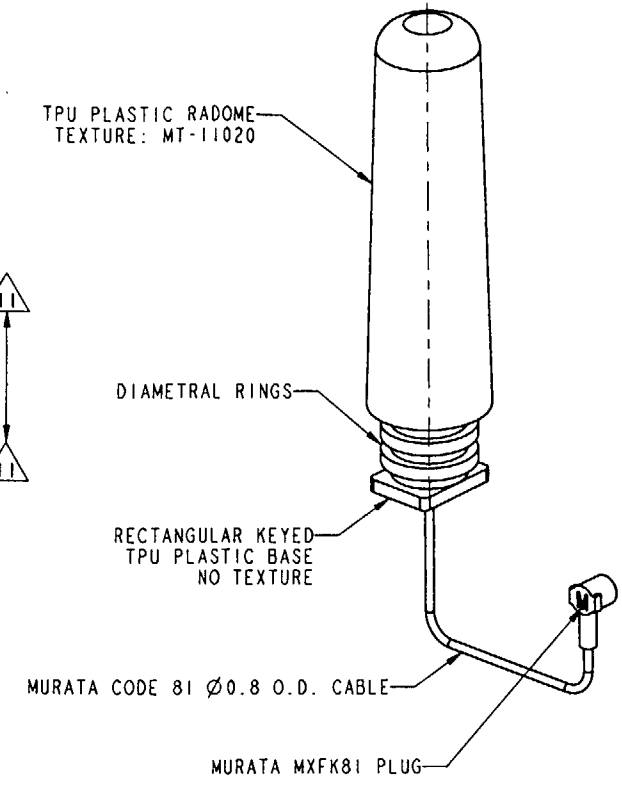
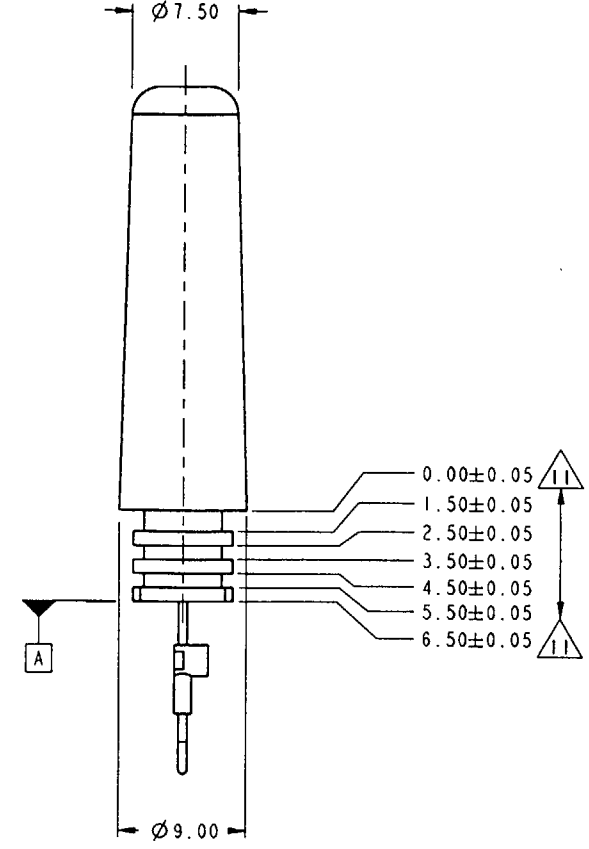
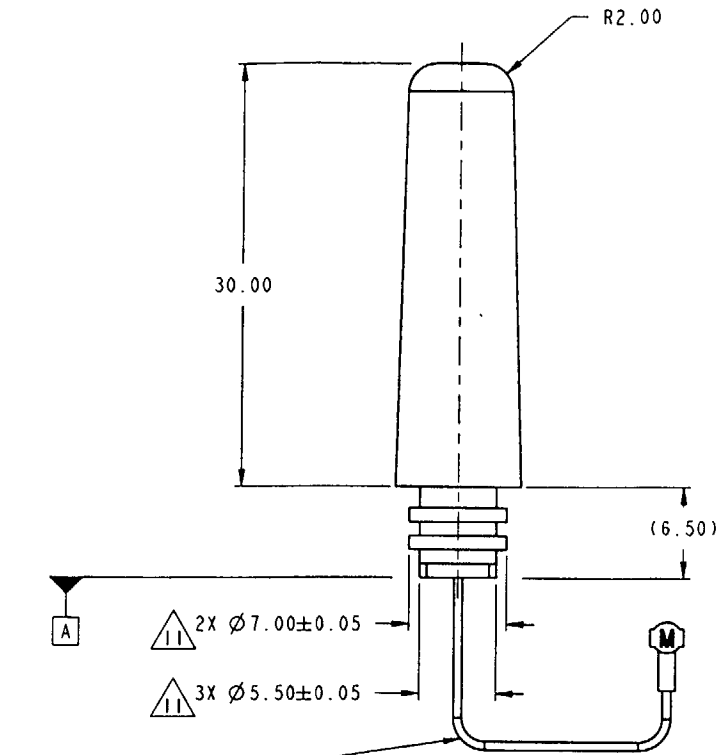

-1

- 14. CORNERS MODELED AS SHARP SHALL HAVE A RADIUS OF 0.15 ± 0.05 MAXIMUM.
- 13. COSMETIC SURFACES SHALL BE FREE OF EJECTOR PIN MARKS, SINK MARKS, SPLAY, VOIDS, TOOL MARKS, BLEMISHES, HAZING, BLUSHING, DISCOLORATION AND OTHER DEFORMITIES.
- 12. LOCATION OF SLIDES, SPRUES, GATES, VENTS, RISERS, FLASH, PARTING LINES AND EJECTOR PINS SHALL BE AT VENDOR'S DISCRETION AND SHALL BE APPROVED BY QUALCOMM PRIOR TO TOOL DEVELOPMENT.
- 11. DIMENSION DEFINED TO BE FUNCTIONAL AND CRITICAL.
- 10. DIMENSIONS INCLUDE SURFACE TREATMENT AND/OR TEXTURE.
- 9. FINISH: SHALL MEET REQUIREMENTS OF QUALCOMM MECHANICAL WORKMANSHIP STANDARD 80-10767-6.

- 8. MATERIAL: RADOME: BF GOODRICH ESTANE 58133 TPU COLOR: BLACK
BASE: BF GOODRICH ESTANE 58133 TPU COLOR: BLACK
- 7. ONLY ITEM(S) DESCRIBED ON THIS DRAWING ARE APPROVED FOR USE IN THE APPLICATIONS WHERE SPECIFIED. A SUBSTITUTE ITEM SHALL NOT BE USED WITHOUT PRIOR APPROVAL BY QUALCOMM INCORPORATED.
- 6. IDENTIFICATION OF THE APPROVED ITEM(S) HEREON IS NOT TO BE CONSTRUED AS A GUARANTEE OF PRESENT OR CONTINUED AVAILABILITY.
- 5. BAG AND TAG ITEM IN ACCORDANCE WITH QUALCOMM PRODUCT IDENTIFICATION MARKING SPECIFICATION GS80-31042-1, MARKING CODE 101, CONTENT/FORMAT OPTION 1 AND RELEASE NUMBER.
- 4. WORKMANSHIP SHALL BE IN ACCORDANCE WITH QUALCOMM MECHANICAL WORKMANSHIP STANDARD 80-10767-1.
- 3. INTERPRET DIMENSIONS AND TOLERANCES PER ASME Y14.5M-1994.
- 2. ALL DIMENSIONS SHOWN ON THIS DRAWING ARE IN MM (MILLIMETERS). INCH DIMENSIONING IS NOT USED ON THIS DRAWING.
- 1. INTERPRET DRAWING PER MIL-STD-100.

NOTES: UNLESS OTHERWISE SPECIFIED

SOURCE CONTROL DRAWING

QUALCOMM PROPRIETARY
COPYRIGHT (C) 2000 QUALCOMM INCORPORATED
ALL RIGHTS RESERVED.

METRIC ONLY

STZ	CAGE CODE	DRAWING NO	REV	VER
D	IDN14	CV90-88112	B	1+
5775 MOREHOUSE DRIVE		SAN DIEGO, CA 92121-1714		SCALE 4/1
		DOC ID: 374a59		SHEET 14 OF 14