

	1	2	3	4	5	6	7
P/NIC OPTION							
	Jeep Jewel Scale: 1:1						
		05028454XX 3335, 3101	05028453XX 3335, 3301	05028456XX 3335, 3201	05028455XX 3335, 3401	05028497XX 3335, 3501	05028544XX 3335, 3601
NO P/NIC OPTION							
	Chrysler Jewel Scale: 1:1						
		05028568XX 3335, 1501				05028687XX 3335, 2601	05028688XX 3335, 2701

(1) TYPICAL SPACE (2) TYPICAL TEXT

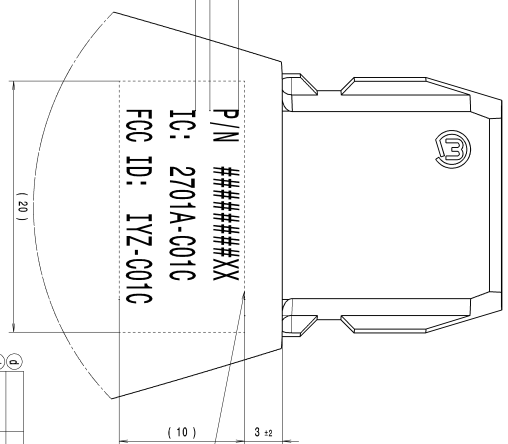

DETAIL B
SCALE: 5:1
LABEL DETAIL

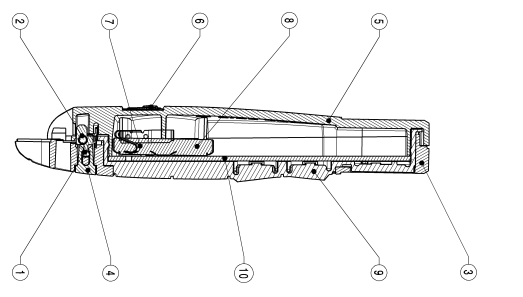
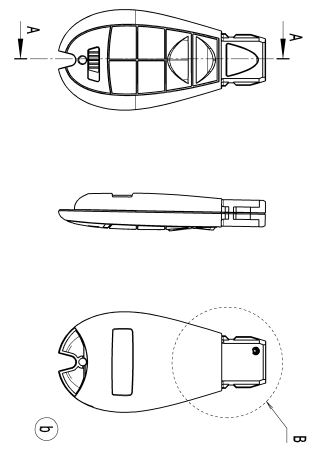

SECTION A-A
SCALE 2:1

CUSTOMER PART NUMBER, IC, AND FCC ID SHOULD BE LASER MARKED IN THIS AREA. TEXT TO BE 2MM HIGH, 6PTAL FONT. TEXT LOCATION AND APPEARANCE CONTROLLED BY MASTER SAMPLES.

Part No.	Part Name	Material	Finish	Quantity	Unit Price	Total Price
050284537AE	JEOP JEWEL P/NIC OPTION	3030	1420-02	3335	1420-02	
050285687AE	JEOP JEWEL NO P/NIC OPTION	3030	1410-02	3335	1410-02	
050285547AE	JEOP JEWEL P/NIC OPTION	3030	3601-02	3335	3601-02	
050284977AE	JEOP JEWEL P/NIC OPTION	3030	3501-02	3335	3501-02	
050284557AE	JEOP JEWEL P/NIC OPTION	3030	3401-02	3335	3401-02	
050284537AE	JEOP JEWEL P/NIC OPTION	3030	3301-02	3335	3301-02	
050284567AE	JEOP JEWEL P/NIC OPTION	3030	3201-02	3335	3201-02	
050284547AE	JEOP JEWEL P/NIC OPTION	3030	3101-02	3335	3101-02	
050288877AD	JEOP JEWEL P/NIC OPTION	3030	2701-02	3335	2701-02	
050288867AD	JEOP JEWEL P/NIC OPTION	3030	2601-02	3335	2601-02	
050289327AE	JEOP JEWEL P/NIC OPTION	3030	2501-02	3335	2501-02	
050283177AE	JEOP JEWEL P/NIC OPTION	3030	2401-02	3335	2401-02	
050289307AE	JEOP JEWEL P/NIC OPTION	3030	2301-02	3335	2301-02	
050283777AE	JEOP JEWEL P/NIC OPTION	3030	2201-02	3335	2201-02	
050284587AE	JEOP JEWEL P/NIC OPTION	3030	1601-02	3335	1601-02	
050285667AE	JEOP JEWEL P/NIC OPTION	3030	1501-02	3335	1501-02	

©Alle Rechte bei Marquardt GmbH, auch hier den Fall von Schutzrechtsverletzungen. Jede Verfertigung, Vervielfältigung, Verbreitung, auch auszugsweise, ist ohne schriftliche Genehmigung der Marquardt Group of Companies.

CONFIDENTIAL
 VERTRAULICH

- NOTES:
- FOR DIMENSIONAL INFORMATION NOT SHOWN ON THIS DRAWING ANALYZE THE 3D MODEL.
 - TOLERANCES OF THE 3D MODEL ARE ACCORDING TO THE UNTOLERANCED DIMENSIONS OF THIS DRAWING.
 - ANY CHANGE OR CREATION OF THE PARTING LINE, INJECTION POINT, EJECTOR PIN AND DRAFT MUST BE APPROVED BY DEVELOPMENT DEPARTMENT.
 - NO BURRS, TOOL MARKS, SINK OR COSMETIC FLAWS ON APPEARANCE SURFACE.
 - FLASH / PARTING LINE OFFSET NOT TO EXCEED 0.15mm OR EFFECT FIT, FORM, OR FUNCTION.
 - X.XX STATISTICAL CONTROL DIMENSION REQUIRES AS DESCRIBED IN TLB 941.000.019.

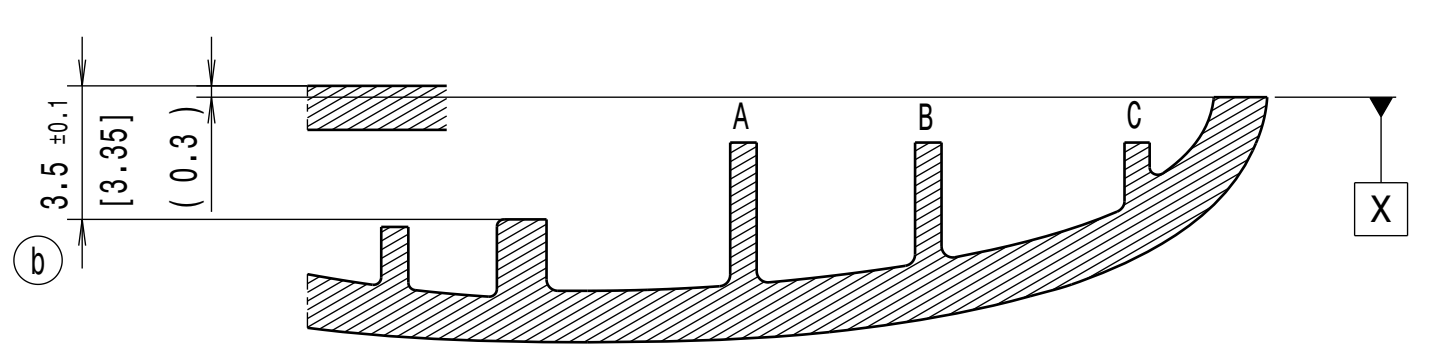
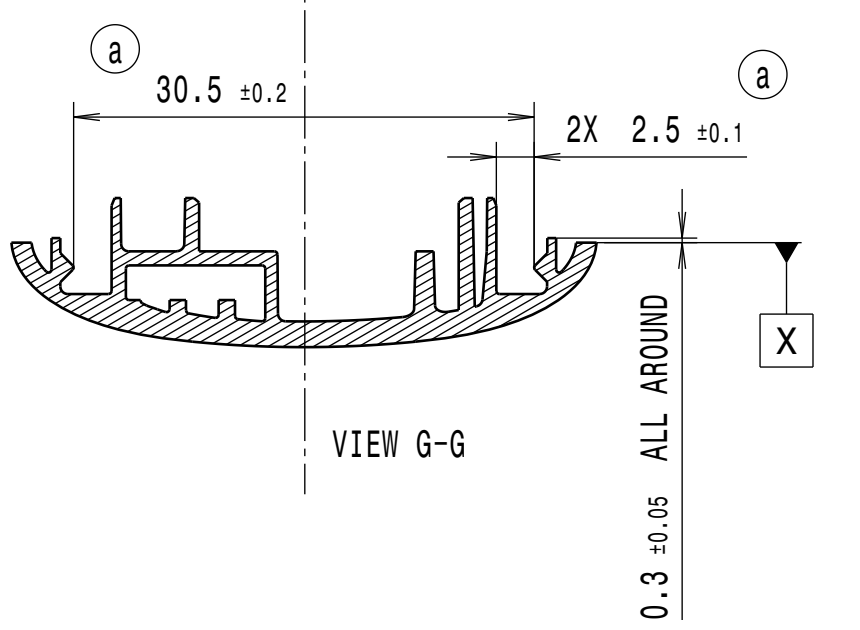
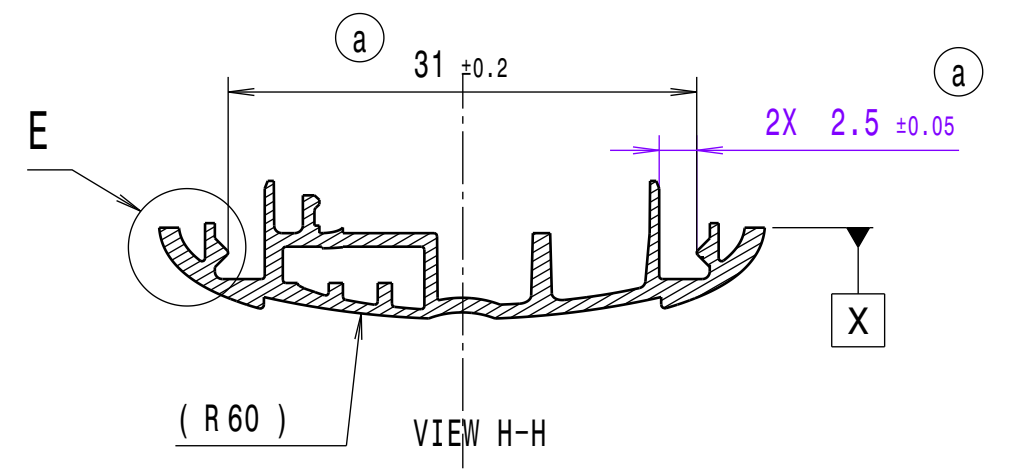
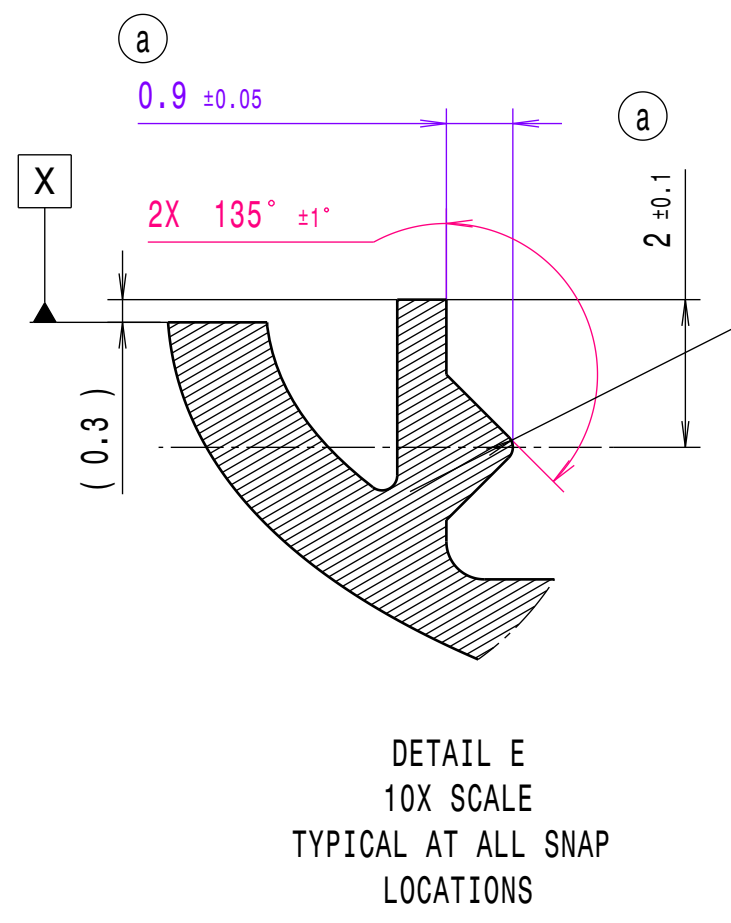

CROSS HATCHED AREA ALL ONE SURFACE MUST BE FREE OF TOOL MARKS

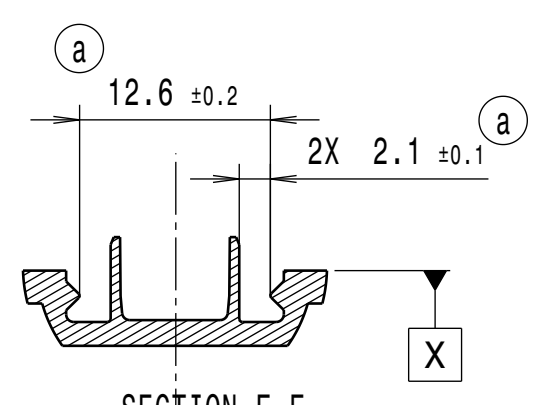
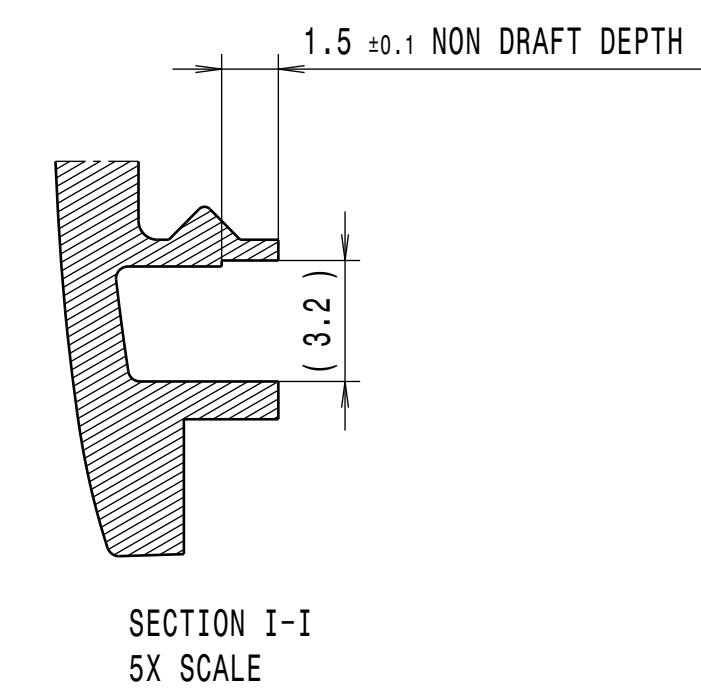
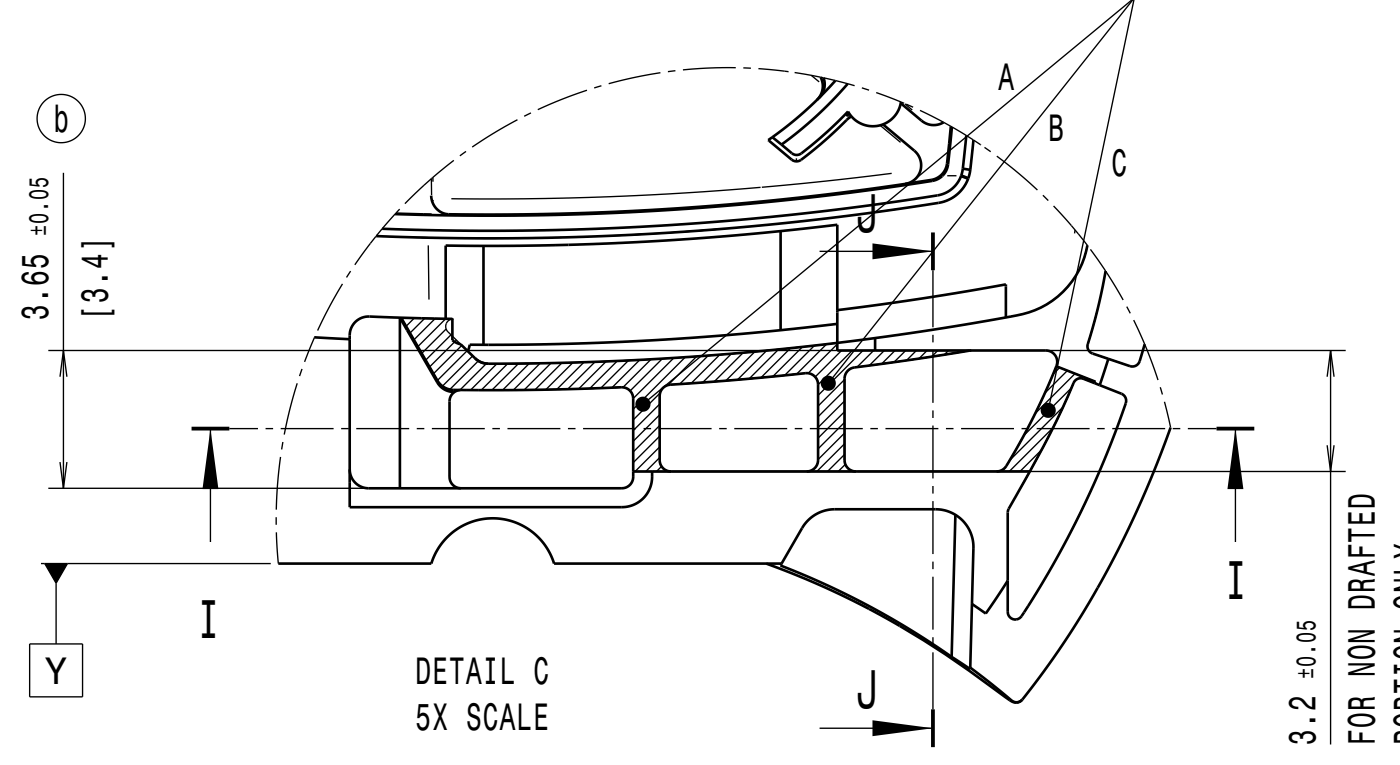

CAVITY ID IN THIS AREA 0.2mm HIGH MAX STYLE ACCORDING TO TOOL MAKER

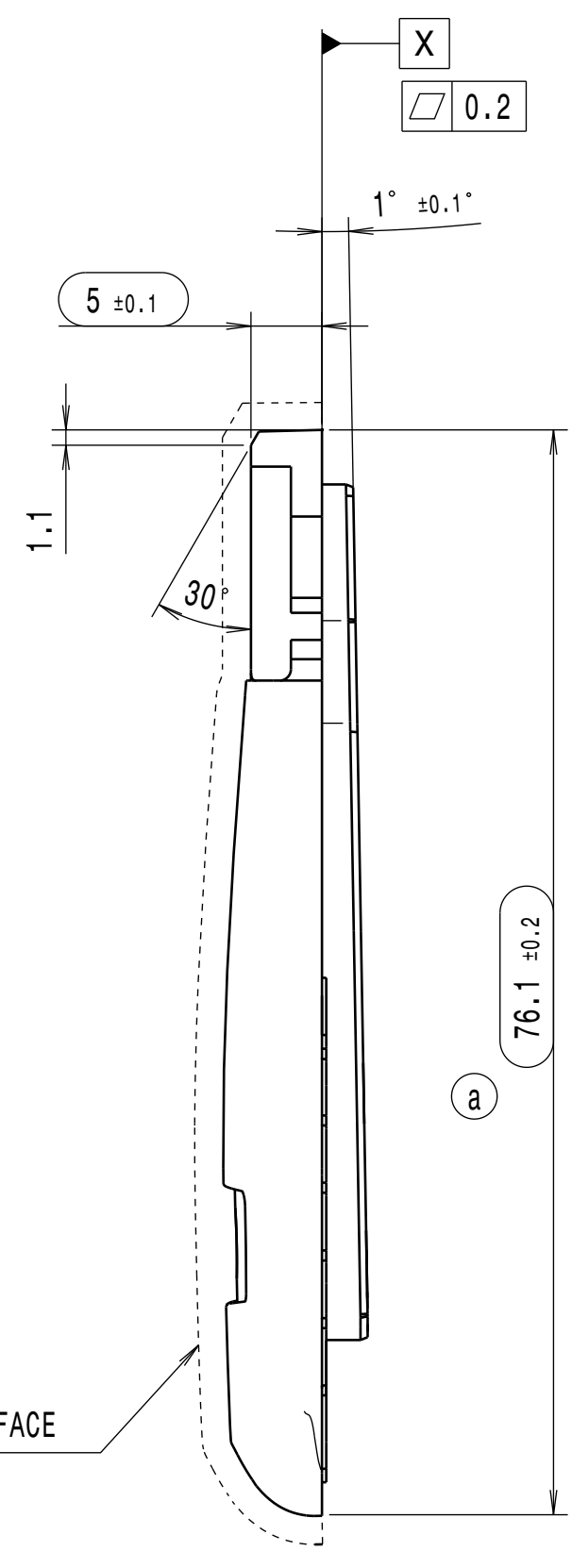
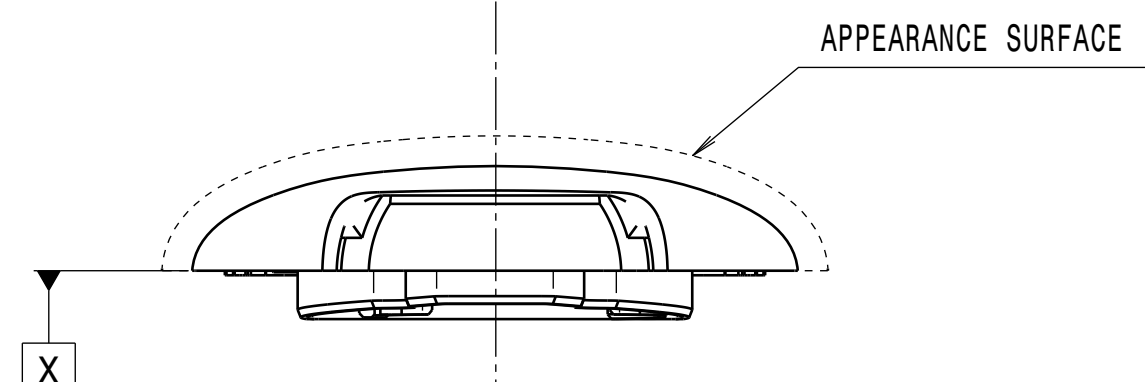
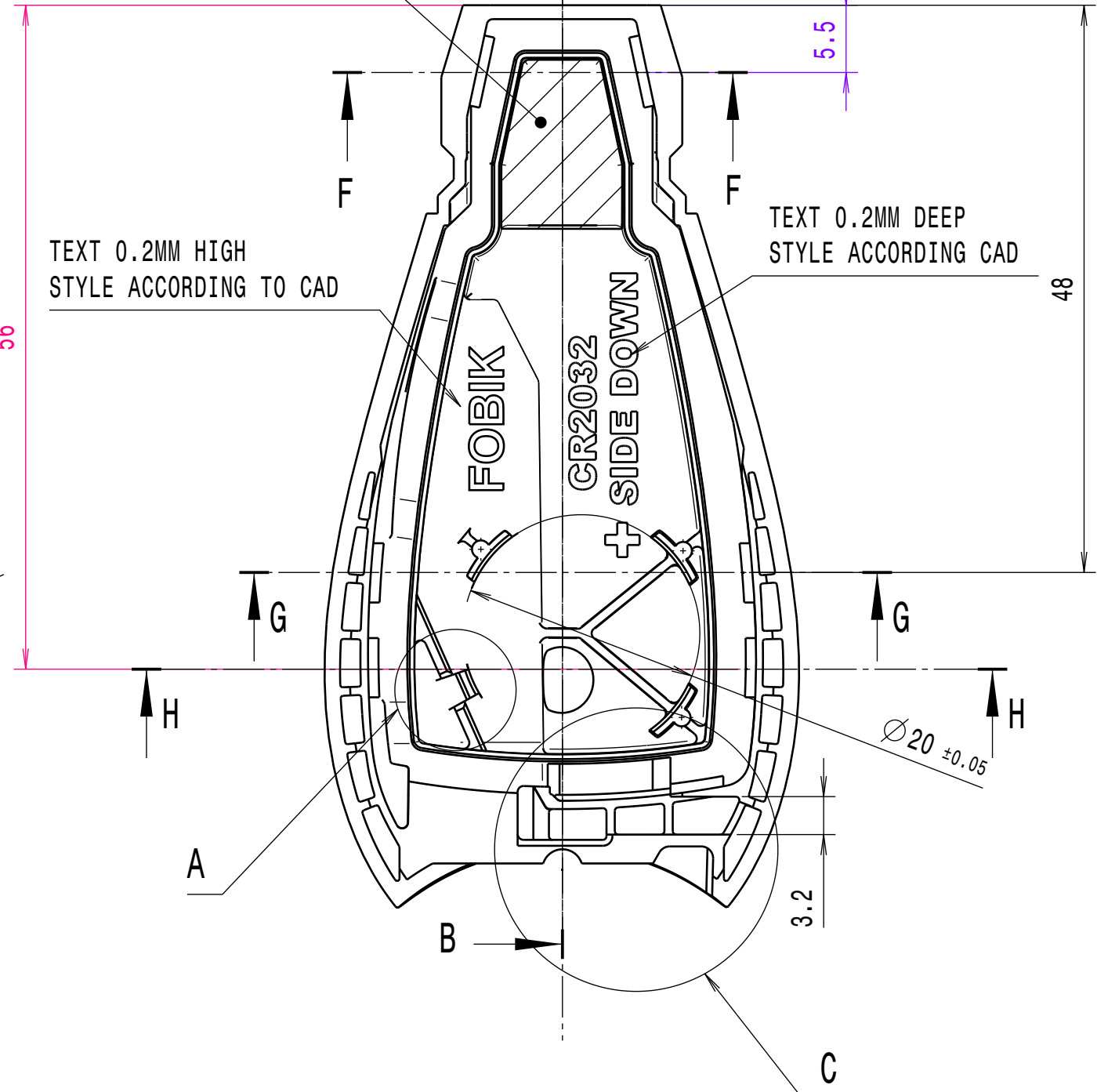
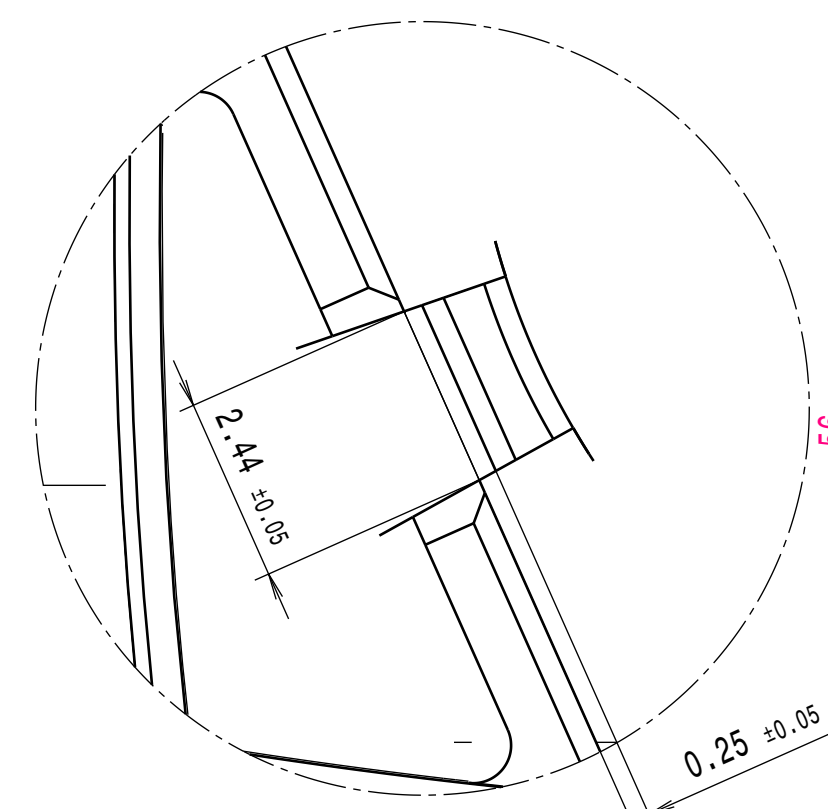

APPEARANCE SURFACE

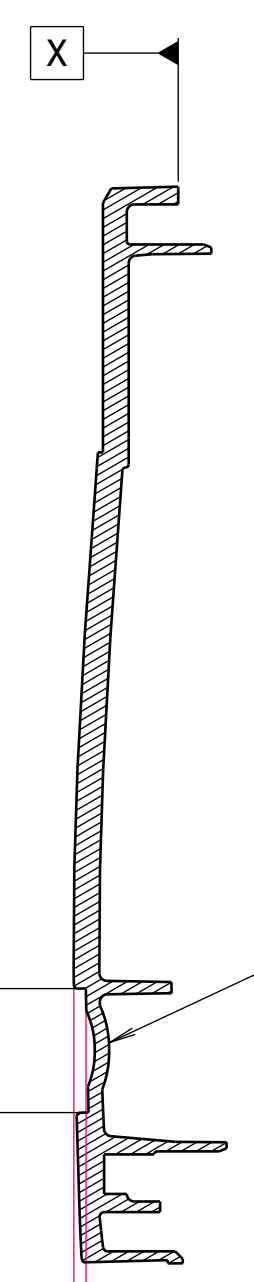

THIS DIMENSION SHOULD BE ADJUSTABLE BETWEEN 0.8mm AND 0.3mm

SECTION B-B

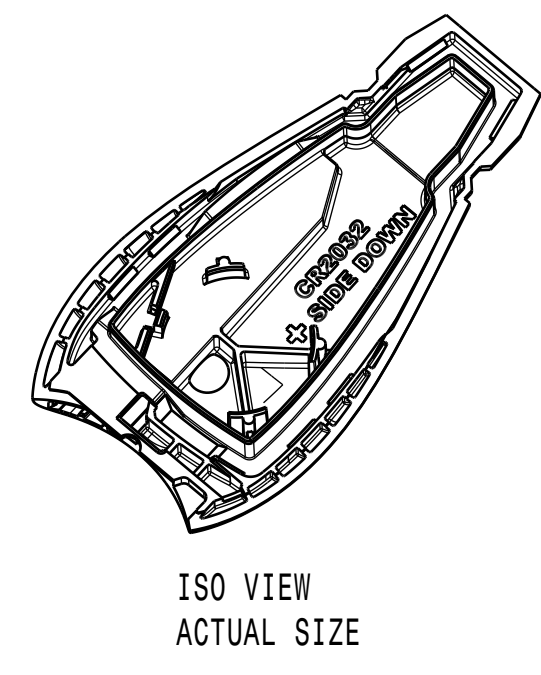
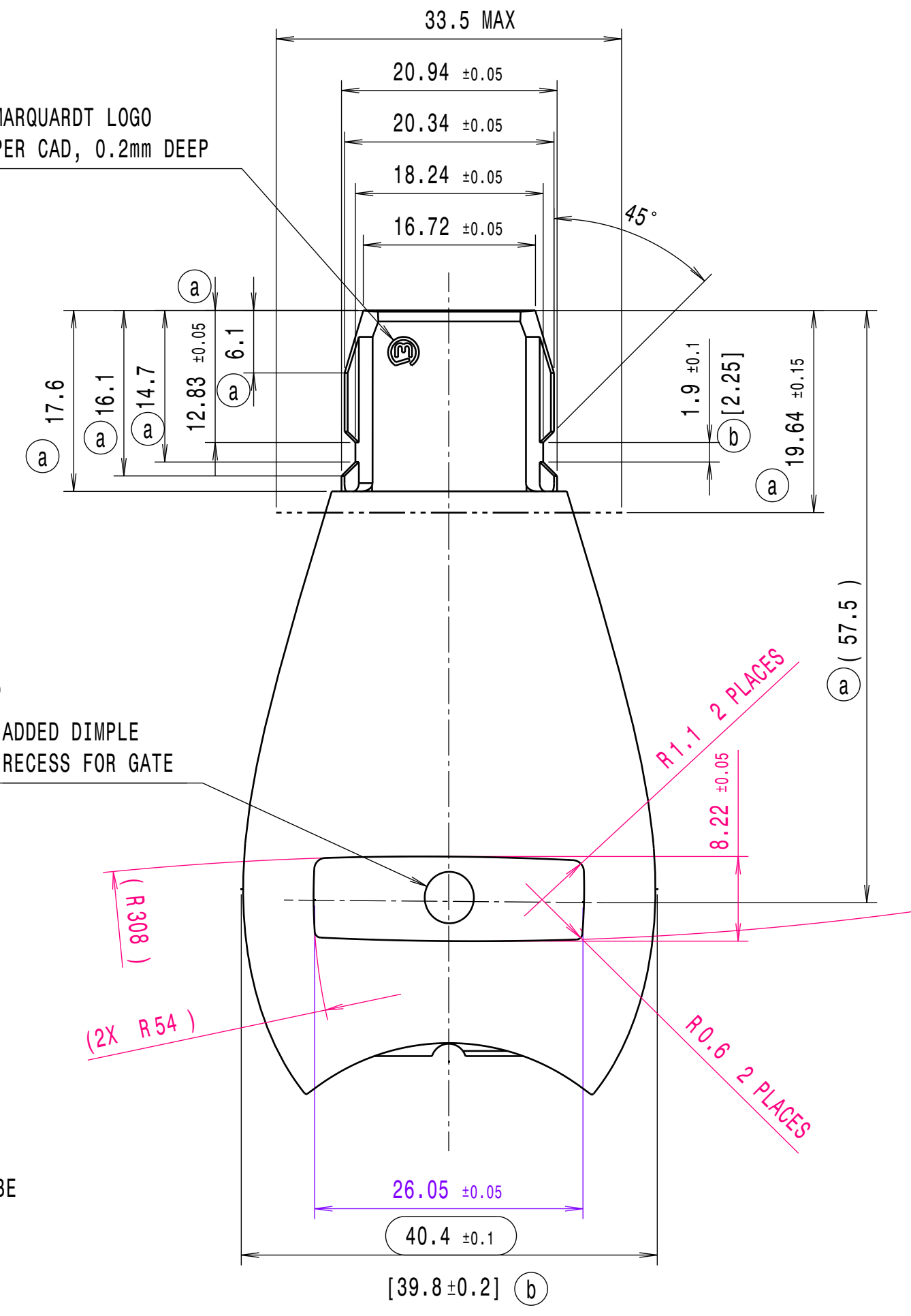

ISO VIEW ACTUAL SIZE

NO REGRIND PERMITTED

Aufschrift		Build	Surface Finish	Material	Material-Nr.	I. Used	
I				PA6 25% GF L1 TRAMID B3WG5 CHRYSLER BLACK PK3-DX9	999.814.208	3335 011	
für Form und Lage	0.1	Allgemeintoleranzen UNTOLERANCED DIMENSIONS		Pause COPY	Blatt SHEET		
für Winkel	0	Abmasse und Längen	±0.15 ±0.15 ±0.15 ±0.15	Original DIN A1	Typ Zeichn./DRAWING NO. Index		
für Winkel	-0.2	Abstände	±0.15 ±0.15 ±0.15 ±0.15	Original DIN A1	F 217702011 b		
für Winkel	±0.1	Alle Dimensionen	±0.15 ±0.15 ±0.15 ±0.15	Original DIN A1	2:1 SCALE 30mm		
für Winkel	±0.1	Alle Dimensionen	±0.15 ±0.15 ±0.15 ±0.15	Original DIN A1	HOUSING		
Ausg. / Änderung / REVISION				CAD: CATIA V5		Ersatz fuer/REPLACEMENT OF	
57384 04/08/08 REYN				gez./DRAWN BY 04/10/07 REYN		MARQUARDT	
56643 02/11/08 REYN				gepr./CHECKED BY			
51958 11/07/07 REYN							