

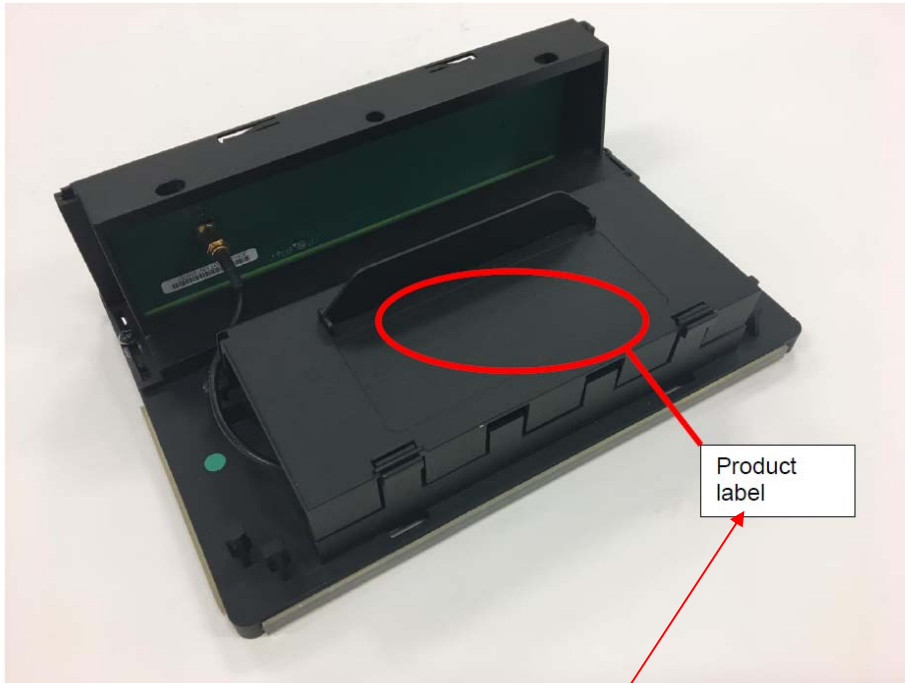



Lexmark International, Inc  
740 West New Circle Road  
Lexington, KY 40550  
U.S.A.  
Contact: Thomas Bugbee  
859-825-4432  
bugbee@lexmark.com

**Label Location and Content**  
FCC ID:IYL0528RFU  
IC:2376A-0528RFU



	UHF RFID MODULE FCC ID:IYL0528RFU IC:2376A-0528RFU
<p>This device complies with Part 15 of the FCC Rules. Operation is subject to the following two conditions: (1) this device may not cause harmful interference, and (2) this device must accept any interference received, including interference that may cause undesired operation.</p>	
<p>Manufactured for Lexmark International, Inc. Programs © Lexmark International, Inc. All Rights Reserved 2015</p>	

Sincerely,

Thomas C. Bugbee  
Regulatory Manager