

NetLink Wireless Telephone Keypad & Indicators



Function	Button	Action
Power on	PWR	Press and hold PWR until double chirp, then release
Power off	PWR	Press and hold PWR until single chirp, then release
Answer call	START	Press START
Hang up	END	Press END
Place call	START	Press START , dial number and tear of normal use; however, avoid dropping the Wireless Telephone or knocking it against hard surfaces.
Select line	START LINE	Press START then press LINE , then select line number (1-9)
Adjust volume	VOL	Press VOL while you are talking to toggle between base volume level and a louder volume level
Put call on hold	HOLD	Press HOLD
Mute/Unmute microphone	FCN	Press FCN then 1

Indicator	Description
NO SVC	The Wireless Telephone cannot receive or place calls. You may be outside of the coverage area. Walk back into the covered area. A restore tone indicates service re-established.
BATT	Your Battery Pack charge is low. You will also hear a beep in the earpiece. Your Battery Pack needs to be recharged.
Beep	You have a voice mail message.

This section applies to the Wireless Telephone. Dual Charging Stand and the Quick Charger equally.

The Wireless Telephone and Chargers have been designed to withstand the wear and tear of normal use; however, avoid dropping the Wireless Telephone or knocking it against hard surfaces. Carrying the Wireless Telephone in a holster or carrying case will help to protect it.

Wiping the handset surface with a mild detergent solution may be used. Be sure to wipe away any detergent residue with a clean water-dampened cloth.

The Wireless Telephone may be cleaned with any general-purpose household glass and surface-type cleaner. DO NOT spray alcohol on and off. The **START** and **END** keys begin and end calls. When you finish a call, press the **END** key, not the **PWR** key.

You can only use the Wireless Telephone with your facility's telephone system. It is not a public cellular phone.

If the Wireless Telephone's Battery Pack is low, you will hear a soft beep and see the **BATT** or **LOW BATTERY** message in the display.

Improper disposal of Battery Packs can damage the environment. Dispose of Battery Packs properly.

You can control the Wireless Telephone's volume level and the type of ringing. See Setting User Preferences.

To protect the Wireless Telephone, use a carrying case.

Turn off the Wireless Telephone and unplug the Charger before you clean them. Never immerse either in water. Clean the exterior surfaces, including the charging contacts, with a cloth that has been slightly moistened with water. Take care not to exert undue pressure on the Charger electrical contacts while wiping.

Headset and Battery Packs

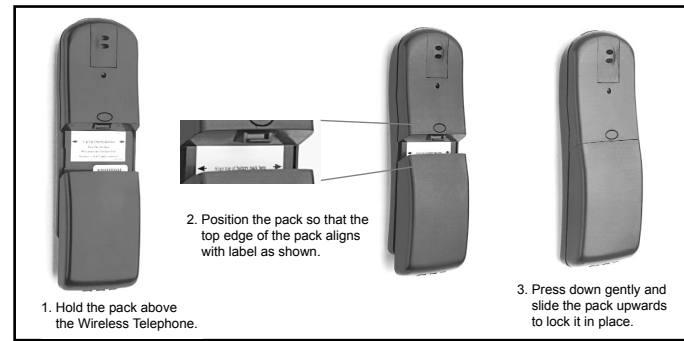

The Dual Charging Stand should not be used to charge Nickel-Cadmium (NiCd) Battery Packs.

When you are not using your Wireless Telephone keep it turned off and in the Stand.

Do not place anything in the Dual Charging Stand other than the Wireless Telephone. You might damage the contacts. Bent contacts can keep the Wireless Telephone from charging.

Place the Wireless Telephone in the front compartment facing forward. It may be on or off during charging. A single spare Battery Pack may be placed in the rear slot. Either slot can be chosen to take priority. The first Battery Pack placed into either slot is charged first.

There are two indicator lights, one for each charging slot. A solid light indicates the Battery Pack in the corresponding slot is charging. The light turns off when the Charger is finished charging the Battery Pack. A flashing light indicates the Battery Pack is not charging and must be replaced. If the light is off, it indicates that the slot is empty, not charging or the unit is powered off.

Older Battery Packs with a GREEN label will not charge. If the indicator light is fast flashing with a Battery Pack or handset in the slot, check to make sure the Battery Pack has a YELLOW label.

talk time or 80 hours of stand-by time. Stand-by time is when the Wireless Telephone is turned on, but you are not using it.

The Wireless Telephone also supports a Nickel-Cadmium (NiCd) battery pack, which supports two hours talk time and 40 hours stand-by.

Indications of Low Battery

The Wireless Telephone will notify you when the charge on the Battery Pack becomes low. If the Wireless Telephone is in use, the **BATT** message will display and you will hear a soft beep through the earpiece every six seconds. You have two minutes to complete the call or change the Battery Pack

The Battery Pack can be changed while the call is still in progress. Do not press **END**. Quickly remove the discharged Battery Pack and replace with a charged Battery Pack, press **PWR**, and then press **START** to resume the call in progress.

If the Wireless Telephone is idle, you will hear a brief modulated ring signal and the Low Battery message will display. Your Wireless Telephone will not operate until you replace the Battery Pack. Depending on the charging equipment you have purchased, you will either place the Wireless Telephone in a Charging Stand to charge the Battery Pack, or you will remove the Pack from the Wireless Telephone and install it in the charger.

Removing and Replacing the Battery Pack on the Wireless Telephone

To remove the Battery Pack, press down on the oval button above the Battery Pack on the back of the Wireless Telephone. Slide the Pack toward the bottom of the Wireless Telephone until it stops, then lift up.

To replace the Battery Pack, first properly align the top of the Battery Pack with the arrows on the label on the back of the Wireless Telephone. Gently press and slide the Pack toward the top of the Wireless Telephone until it snaps into place. You should not have to force it against the Wireless Telephone.

Take care not to short the battery contacts on the pack with metal objects such as coins, keys or paper clips. Shorting the contacts can cause permanent damage.

Charging the Wireless Telephone

Chargers are shipped with the appropriate power supply for the site's location. Connect the Stand

Wireless Telephone and Chargers General Care of the Maintenance

Wiping the handset surface with a mild detergent solution may be used. Be sure to wipe away any detergent residue with a clean water-dampened cloth.

The Wireless Telephone may be cleaned with any general-purpose household glass and surface-type cleaner. DO NOT spray alcohol on and off. The **START** and **END** keys begin and end calls. When you finish a call, press the **END** key, not the **PWR** key.

You can only use the Wireless Telephone with your facility's telephone system. It is not a public cellular phone.

If the Wireless Telephone's Battery Pack is low, you will hear a soft beep and see the **BATT** or **LOW BATTERY** message in the display.

Improper disposal of Battery Packs can damage the environment. Dispose of Battery Packs properly.

You can control the Wireless Telephone's volume level and the type of ringing. See Setting User Preferences.

To protect the Wireless Telephone, use a carrying case.

Turn off the Wireless Telephone and unplug the Charger before you clean them. Never immerse either in water. Clean the exterior surfaces, including the charging contacts, with a cloth that has been slightly moistened with water. Take care not to exert undue pressure on the Charger electrical contacts while wiping.

Tips For Use

Setting User Preferences

When the Wireless Telephone is on but not in use, press and briefly hold **FCN** to display menus. Check with your system administrator for specific features supported by your Wireless Telephone.

PRESS		RIGHT ARROW	to display next menu item.
PRESS	#	LEFT ARROW	to display previous menu item.
PRESS	0	ZERO	to select or change item.
PRESS	FCN	FCN	to return to previous menu level.
PRESS	END	END	to exit menus.

Menu	Description	User Entry
Volume level	Sets audio volume level.	Use keypad to select a level from 1 (softest) to 8 (loudest).
Ring Type	Select Telephone Ring to set the standard ring on the Wireless Telephone. Normal is factory default. Vibrator Ring works only if your Wireless Telephone has the optional vibrating ringer. Auxiliary Ring is used only by external applications.	Press 0 to select desired ring type. The ring type currently set displays with an asterisk.
High Noise Mode	Adjusts the Wireless Telephone to account for background noise.	Select an option that describes the noise in your environment.
Extension	Sets extension number associated with your Wireless Telephone.	Use keypad to enter extension number.

Switch Volume Levels

The Wireless Telephone has two volume levels, low and high. Set the low volume level by pressing **FCN** until **VOLUME** displays. Use keypad to select a level from 1 (softest) to 8 (loudest). High volume is automatically set two levels higher than low volume. Toggle between high and low volume by pressing the **VOL** key while in a call.

User Guide



NetLink Wireless Telephone



Using The NetLink Wireless Telephone

Turn the Wireless Telephone On

Press the **PWR** key for about 1 second. You will hear a double chirp. Your extension will display. The NO SVC message will display briefly. When it goes out, you are ready to make and receive calls.

Answer A Call

The Wireless Telephone will ring or vibrate to alert you. Additionally, a line indicator on the display may flash, and the display may show information about the call, such as caller's name and extension.

To answer a call, press the **START** key and hold the earpiece to your ear.

If you are on a call and hear subdued ringing, a call is coming in on a second line. To answer this call, put your first call on hold and press the line key then the line number of the second call.

Place A Call

Press the **START** key, wait for dial tone, then dial the number. Dial calls with the Wireless Telephone exactly as with your desk phone. Your telephone system may require you to select a line by pressing the **LINE** key, followed by a line number.

To hang up when you've finished the call, press the **END** key.

Do not use the **PWR** key to end a call, because that will turn your Wireless Telephone off and you will not receive calls until you turn the Wireless Telephone back on.

Because softkey and system features vary, your system administrator will explain them for your telephone system.

FCN Information

This device complies with part 15 of the FCC Rules. Operation is subject to the following two conditions: (1) This device may not cause harmful interference, and (2) this device must accept any interference that may cause undesired operation.

It is recommended that standard acceptance procedures be followed prior to operating this equipment in proximity of life-support systems. To minimize risk of interference, pacemaker users should not carry the Wireless Telephone next to the pacemaker.

Operation of the Wireless Telephone may produce an audible noise noticed by hearing aid users. It is recommended that a SpectraLink headset be used by hearing aid users.

© 2001, SpectraLink Corporation
PN 72-0064-00 Rev. D
SpectraLink Corporation
Boulder, Colorado USA
www.spectralink.com

The Wireless Telephone and Chargers have been designed to withstand the wear and tear of normal use; however, avoid dropping the Wireless Telephone or knocking it against hard surfaces. Carrying the Wireless Telephone in a holster or carrying case will help to protect it.

Wiping the handset surface with a mild detergent solution may be used. Be sure to wipe away any detergent residue with a clean water-dampened cloth.

The Wireless Telephone may be cleaned with any general-purpose household glass and surface-type cleaner. DO NOT spray alcohol on and off. The **START** and **END** keys begin and end calls. When you finish a call, press the **END** key, not the **PWR** key.

You can only use the Wireless Telephone with your facility's telephone system. It is not a public cellular phone.

If the Wireless Telephone's Battery Pack is low, you will hear a soft beep and see the **BATT** or **LOW BATTERY** message in the display.

Improper disposal of Battery Packs can damage the environment. Dispose of Battery Packs properly.

You can control the Wireless Telephone's volume level and the type of ringing. See Setting User Preferences.

To protect the Wireless Telephone, use a carrying case.

Turn off the Wireless Telephone and unplug the Charger before you clean them. Never immerse either in water. Clean the exterior surfaces, including the charging contacts, with a cloth that has been slightly moistened with water. Take care not to exert undue pressure on the Charger electrical contacts while wiping.