

Safety Precautions

- Adult supervision required.
- Always install the propeller guards before flying.
- Calibrate the Flitt accelerometers before each flying session.
- Do not touch the spinning propellers.
- Keep your face and body as well as all spectators away from the propellers.
- Stay clear of buildings, high voltage wires, trees, shrubbery or groups of people.
- Don't fly in bad weather conditions, such as in high wind, rain, or snow.
- Operating Temperature Range: 32°F to 104°F (0°C to 40°C).
- Always keep Flitt in your line of sight.
- Maintain a safe pilot-to-device distance while flying.
- Flitt is not a toy. If not operated correctly, it could possibly cause injury to you or spectators and damage to property.
- Do not alter or modify, as doing so may make it unsafe or unflyable.
- You must check the operation of Flitt before every flight to insure that it has remained structurally sound.

flitt™

Quick Start Guide



See setup and Flying instructions inside.
flittcamera.com

Battery Precautions

The Flitt is equipped with a rechargeable 3.7V Lithium Polymer (LiPo) battery. Please pay attention to the following cautions for safe use:



- KEEP OUT OF REACH OF CHILDREN.
- LiPo batteries must be recycled or disposed of properly.
- Do not use this product if the Flitt was severely crashed and the battery possibly damaged.
- Never disassemble, puncture or modify the Flitt battery.
- Always turn off Flitt power after each use.
- Only charge using a USB 5.0V 2A max power supply.
- Do not charge inside your car.
- Do not leave unattended while charging.
- Allow Flitt to cool for 30 minutes before recharging.
- Always place Flitt on a fireproof surface while charging.
- Keep away from combustible materials while charging.
- Unplug the charger immediately if it or the battery becomes hot! However, it is normal for the charger and battery to get warm. Disconnect from the charger and quickly move to a fireproof location if the battery begins to get hot or smoke!
- Keep a supply of sand accessible when charging. Dumping sand on the battery will extinguish a LiPo chemical fire.
- Always disconnect the charger after charging is complete.

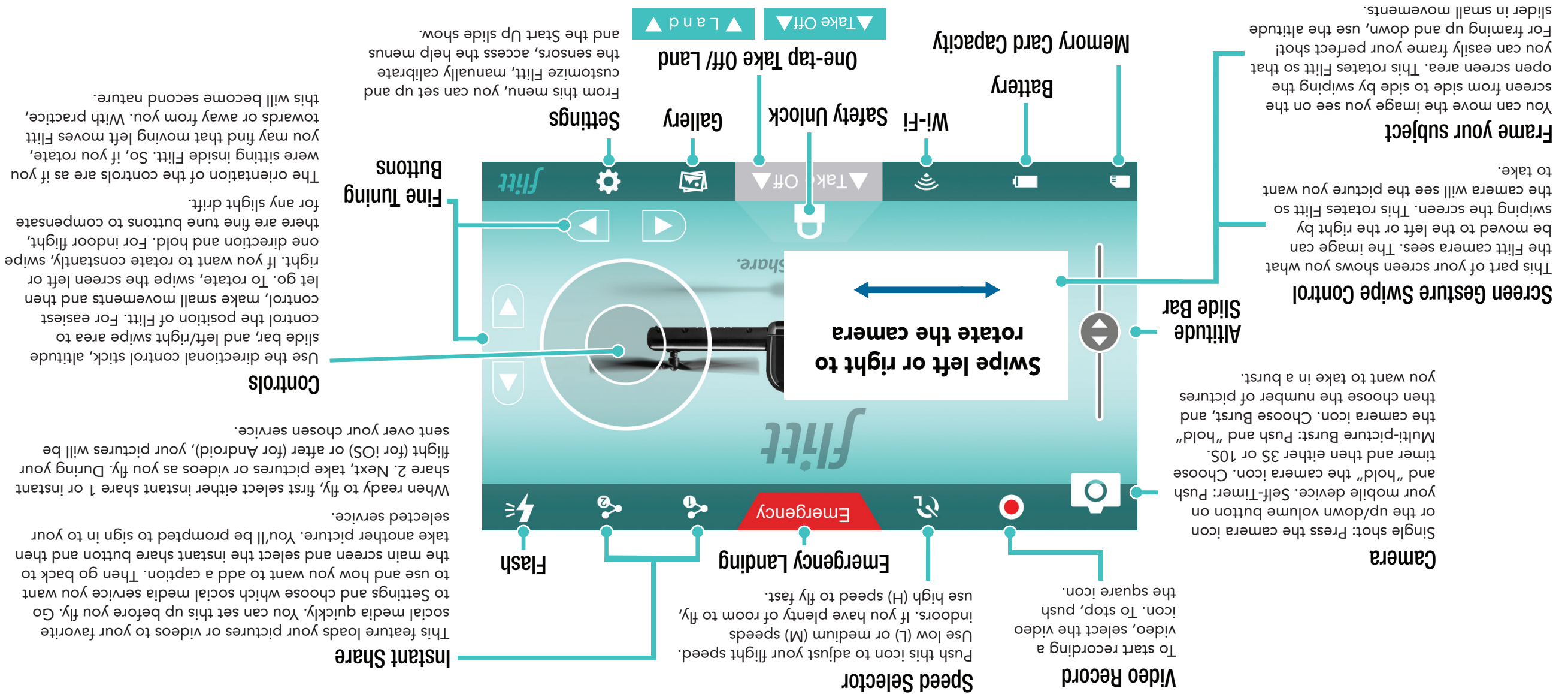

Setup

1: Charge the battery

Unlock the battery.

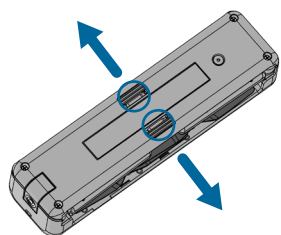

Grip the battery from the sides and push up.

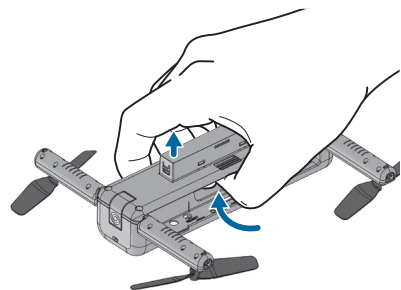

Plug the charger into any standard USB power source.

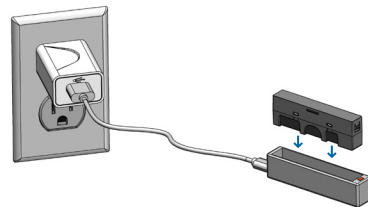

The LED will be solid while charging.
The LED will flash when finished.
Always disconnect when finished.

Insert the battery and lock in place.

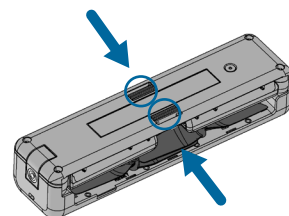

2: Download the app

Search the app store for "Flitt."



Apple and the Apple logo are trademarks of Apple Inc., registered in the U.S. and other countries. App Store is a service mark of Apple Inc. Android and Google Play are trademarks of Google Inc.

3: Turn on

Push the power button and hold for a few seconds until the LED stays on.

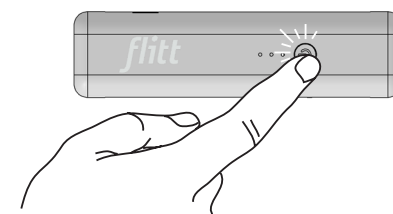

4: Open the arms

Open the arms fully.

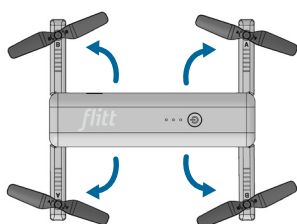

5: Attach the propeller guards

Install a prop guard into the end of each arm.
Match A guards to A arms and B guards to B arms.

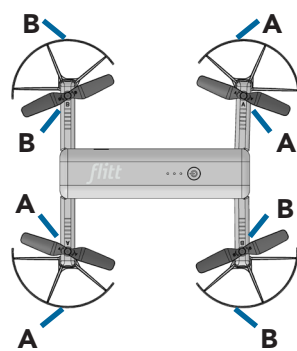

6: Connect your phone

Go to Wi-Fi Settings on your phone and look for the network Flitt-*****.
Connect and enter Password: 12345678

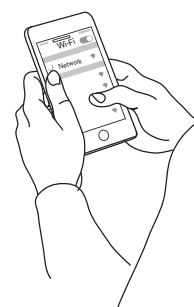

7: Open the app

Watch the slide show to learn about the controls and features.

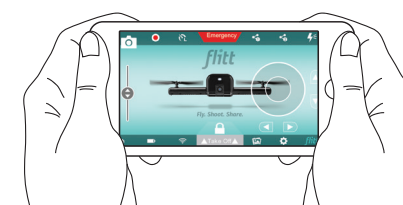

Fly

1: Get Ready.

Position Flitt on a level surface with the camera facing you.

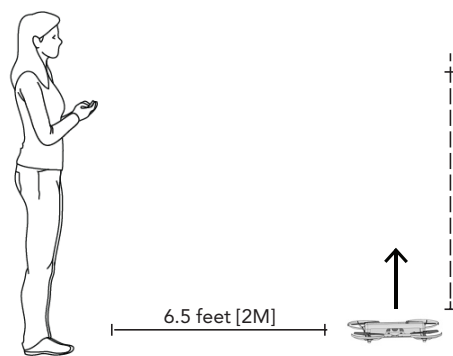

In settings, you can set the camera to face away from you to capture scenery.

Push "unlock" and hold for 2 seconds



Calibrate the sensors if prompted.



Push "Take off" when green.
For your safety, Flitt will re-lock after five seconds to prevent unintentional takeoffs.

We recommend recalibrating the sensors after a hard landing or crash.
Access this feature through the settings menu.

2: Controls

Move slider to change altitude.

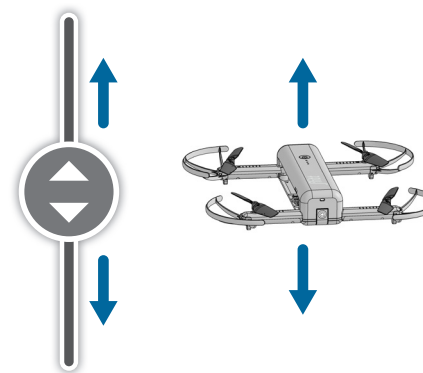

Move controls in the direction you want to travel.

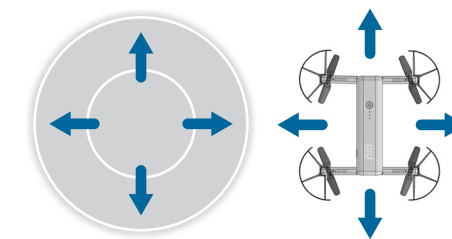

3: Land

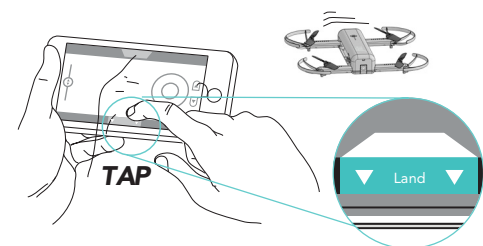

To land immediately, push **EMERGENCY**

4: Power off

Push and hold until the LED turns off.

It's easiest to fold up Flitt starting with the back arms first.
Now head out to your next photo shoot!

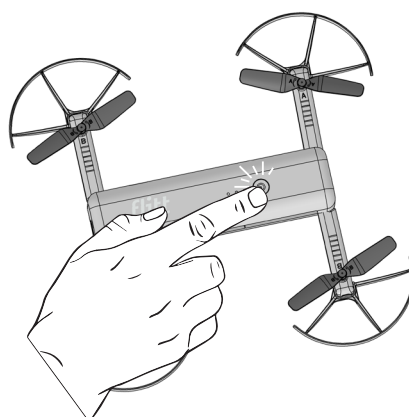

FCC Statement

This device complies with part 15 of the FCC rules. Operation is subject to the following two conditions.

- (1) This device may not cause harmful interference.
- (2) This device must accept any interference received, including interference that may cause undesired operation.

ANY CHANGES OR MODIFICATIONS NOT EXPRESSLY APPROVED BY THE PARTY RESPONSIBLE FOR COMPLIANCE COULD VOID THE USER'S AUTHORITY TO OPERATE THE EQUIPMENT.

This equipment has been tested and found to comply with the limits for a Class B digital device, pursuant to Part 15 of the FCC Rules. These limits are designed to provide reasonable protection against harmful interference in a residential installation. This equipment generates, uses and can radiate radio frequency energy and, if not installed and used in accordance with the instructions, may cause harmful interference to radio communications. However, there is no guarantee that interference will not occur in a particular installation.

If this equipment does cause harmful interference to radio or television reception, which can be determined by turning the equipment off and on, the user is encouraged to try to correct the interference by one or more of the following measures:

- Reorient or relocate the receiving antenna.
- Increase the separation between the equipment and receiver.
- Connect the equipment into an outlet on a circuit different from that to which the receiver is connected.
- Consult the dealer or an experienced radio/TV technician for help.

FCC Radiation Exposure Statement:

- This equipment complies with FCC radiation exposure limits set forth for an uncontrolled environment.
- This transmitter must not be co-located or operating in conjunction with any other antenna or transmitter.
- This equipment should be installed and operated with minimum distance 20cm between the radiator & your body.

ISED RSS Warning

This device complies with ISED licence-exempt RSS standard (s). Operation is subject to the following two conditions:

- (1) This device may not cause interference.
- (2) This device must accept any interference, including interference that may cause undesired operation of the device.

Le présent appareil est conforme aux CNR d'ISED applicables aux appareils radio exempts de licence. L'appareil doit accepter tout brouillage radioélectrique subi, même si le brouillage est susceptible d'en compromettre le fonctionnement.

(1) l'appareil ne doit pas produire de brouillage, et

(2) l'utilisateur de l'appareil doit accepter tout brouillage radioélectrique subi, même si le brouillage est susceptible d'en compromettre le fonctionnement.

ISED Radiation Exposure Statement:

- This equipment complies with ISED RF radiation exposure limits set forth for an uncontrolled environment.
- This transmitter must not be co-located or operating in conjunction with any other antenna or transmitter.
- This equipment should be installed and operated with minimum distance 20cm between the radiator & your body.

- Cet appareil est conforme aux limites d'exposition de rayonnement RF ISED établies pour un environnement non contrôlé.
- Cet équipement doit être installé et utilisé avec une distance minimale de 20cm entre le radiateur & votre corps.

FCC ID: IYFFLITT IC: 11104A-FLITT