

Instruction:

- 1.Product Description.
- 2.2Wire Product Number.
- 3.MAC Addr:XXXXXXXXXXXX
- 4.Barcode of MAC addr.
- 5.Serial Number:YYPPMMWWXXXX  
 YY-Year,EX:2006-06  
 PP-Factory Plant:EX:UT-USI Taiwan  
 MM-Machine ID,EX:99-Engineering sample  
 WW-Week  
 XXXX-start to count from 0001 per week.
- 6.Barcode of S/N.
- 7.Country Code of Origin:TW,CN...
- 8.Tracking Numbers:xxxxxxxx
- 9.Barcode of TN
- 10.PLANT:(1)Taiwan:NK,TT,TT2;(2)Shanghai:SH..

Note1:

- 1.Material: POLY, MATT;USI PN:59-512627-X1
- 2.Label color: white
- 3.Thickness: 0.1mm
- 4.Barcode format:Code39,Ratio:1/3,X-Expantion:1,Height:2.5mm
- 5.Font:Arial Narrow,6pt



Universal Scientific Industrial Co.,Ltd.

TITLE  
 LBL MDE, CD39, PLY, WHT, 40\*20, USB, 2WIRE, R:A

SOURCE ORGANIZATION  
 TAIWAN/SPCM/COM/MD

MODEL NO

DESIGNER DATE

DWG NO

**2B-013030**

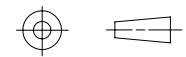

Edmond Hsieh 03/24\*06

SCALE: 2:1

UNIT: MM

Unless otherwise tolerance specified

APP BY DATE

USI P/N

SHEET REV

$\pm 0.1$

Michael Chang 03/24\*06

**59-455322-01**

1/1 A2

A9		
A8		
A7		
A6		
A5		
A4		
A3		
A2	TN & Regulatory mark	06"5/1
NO	DESCRIPTION	DATE