

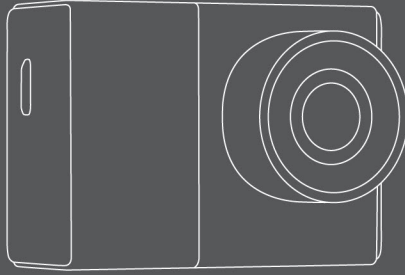

GARMIN DASH CAM™



GARMIN®

2

Set Up • Configuration • Configurazione • Einrichtung • Configurar

garmin.com/driveapp



Manuals and Regulatory Information • Manuels et informations réglementaires • Manuali e note legali
Handbücher und Regulierungsinformationen • Manuales e información legal



garmin.com/manuals/dashcamX7

Data Transfer • Transfert de données • Trasferimento dati • Datenübertragung • Transferencia de datos

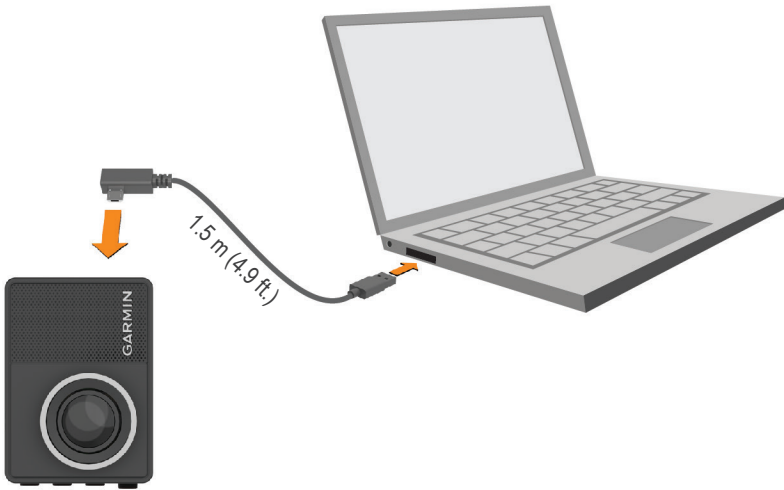

support.garmin.com

© 2021 Garmin Ltd. or its subsidiaries

Garmin® and the Garmin logo are trademarks of Garmin Ltd. or its subsidiaries, registered in the USA and other countries. Garmin Dash Cam™ is a trademark of Garmin Ltd. or its subsidiaries. These trademarks may not be used without the express permission of Garmin.

The microSD™ logo is a trademark of SD-3C, LLC.

2.4 GHz @ 16 dBm Maximum

El número de registro COFETEL/IFETEL puede ser revisado en el manual a través de la siguiente página de internet.



Printed in Taiwan
January 2021
190-02805-02_0A





1

Installation • Installation • Installazione • Installation • Instalación

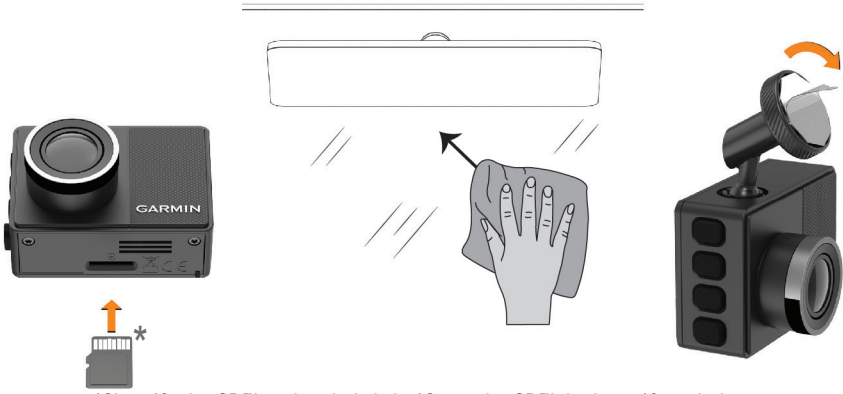

*Class 10 microSD™ card not included *Carte microSD™ de classe 10 non incluse
 *Scheda microSD™ di classe 10 non inclusa *microSD-Karte der Klasse 10 nicht im Lieferumfang enthalten
 *Tarjeta microSD™ de clase 10 no incluida



TIP: To hide the 4 m (13 ft.) cable, route it behind the vehicle trim along the windshield, doorframe, or dash.

ASTUCE : pour masquer le câble de 4 m (13 pi), faites-le passer sous le ciel de toit le long du pare-brise, de la portière ou du tableau de bord.

SUGGERIMENTO: per nascondere il cavo da 4 m (13 piedi), passarlo dietro all'allestimento del veicolo lungo il parabrezza, lo sportello o il cruscotto.

TIPP: Verlegen Sie das 4 m (13 Fuß) lange Kabel hinter der Verkleidung des Fahrzeugs entlang der Windschutzscheibe, des Türrahmens oder des Armaturenbretts, damit es nicht zu sehen ist.

SUGERENCIA: Para ocultar el cable de 4 m (13 ft), colócalo a lo largo de la moldura del parabrisas del vehículo, del marco de la puerta o del salpicadero.

