

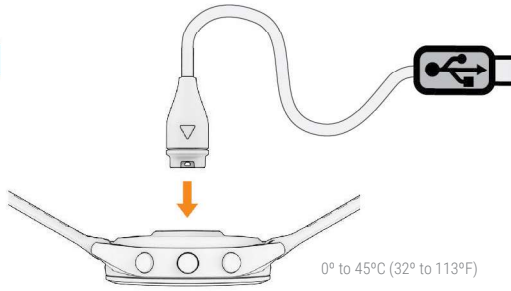

1



2

garmin.com/connectapp

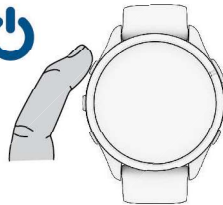
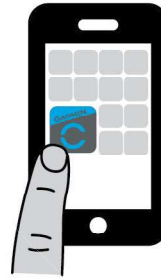

3



garmin.com/fitandcare

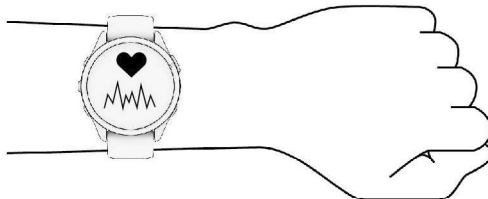

garmin.com/manuals/

Manuals and Regulatory Information · Manuels et informations réglementaires
Manuali e note legali · Handbücher und Regulierungsinformationen
Manuales e información legal · Manuais e informações regulatórias

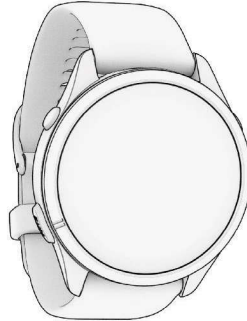

GARMIN®

support.garmin.com

© 2022 Garmin Ltd. or its subsidiaries

Garmin®, the Garmin logo, ANT+® and Garmin Connect® are trademarks of Garmin Ltd. or its subsidiaries, registered in the USA and other countries. These trademarks may not be used without the express permission of Garmin. The BLUETOOTH® word mark and logos are owned by the Bluetooth SIG, Inc. and any use of such marks by Garmin is under license.

M/N: A04452, A04453
-20 to 50°C (-4° to 122°F)
2.4 GHz @ 17.3 dBm max.
0.32 W/kg torso, 0.32 W/kg limb



El número de registro COFETEL/IFETEL puede ser revisado en el manual a través de la siguiente página de internet.



190-02985-90_0A

September 2022

Printed in Taiwan

