

GARMIN.

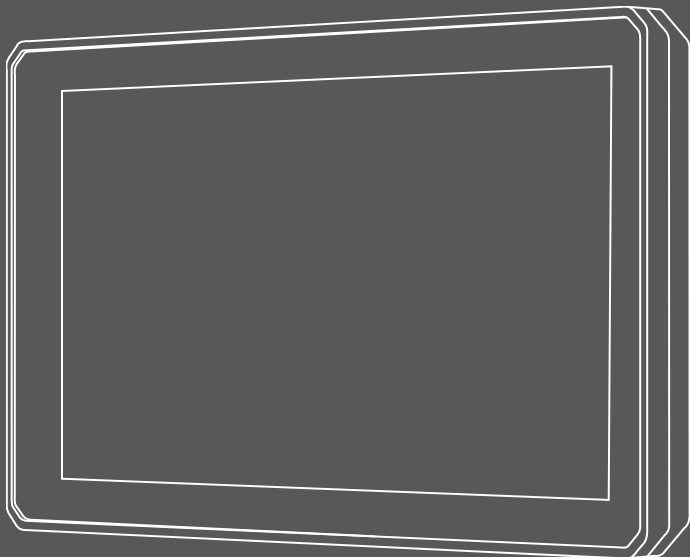

GROUP RIDE RADIO

Quick Start Manual

Installing the Antenna on the Group Ride Radio Mount

NOTE: The mounted antenna must be at least 4 cm (1.57 in.) away from the nearest roll bar or metal surface to avoid radio interference.

You can mount the antenna directly onto the Group Ride Radio mount. For the best results, use this method only in vehicles that do not have a roll cage.

Screw down and tighten the antenna onto the Group Ride Radio mount.



Relocating the Antenna

NOTE: The mounted antenna must be at least 4 cm (1.57 in.) away from the nearest roll bar or metal surface to avoid radio interference.

You can use the antenna relocation kit to mount your antenna in a more suitable location for your vehicle, such as a roll bar at the rear of your vehicle, to receive better radio reception. For the best results, use this method for vehicles that have a roll cage.

- 1 Screw down and tighten the antenna cable ① onto the Group Ride Radio mount ②.



- 2 Find a suitable location for the antenna.
- 3 Using a flat head screwdriver or $\frac{5}{16}$ in. (8 mm) nut driver, loosen the bolt ③ on the antenna relocation mount until the ring separates.

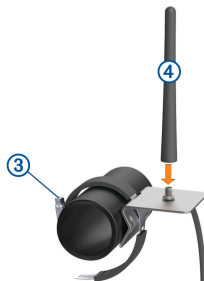

- 4 Place the mount around the roll bar.
- 5 Tighten the bolt on the mount until the ring is secure.
- 6 Screw down and tighten the antenna ④ onto the antenna relocation plate.
- 7 Route the antenna cable along a suitable path in your vehicle, and secure it using the included zip ties.

Installing the Fist Microphone and Mount

Before you can attach the fist microphone mount to your dashboard, you must select a suitable location on the dashboard.

⚠ WARNING

It is your responsibility to ensure the mounting location complies with all applicable laws and ordinances, and does not block your view of the road during the safe operation of your vehicle.

NOTICE

Avoid wires, gauges, air bags, air bag covers, HVAC, and other items when drilling pilot holes and attaching the mount to the vehicle. Garmin® is not responsible for any damages or consequences arising from the installation.

- 1 Align and insert the connector on the fist microphone onto the Group Ride Radio mount.



- 2 Tighten the collar around the connected cable.
- 3 Place the mount ① on the selected location.

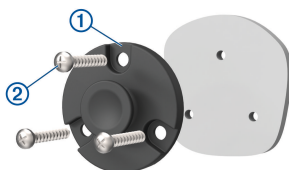

- 4 Using the mount as a template, mark the three screw locations.
- 5 Drill pilot holes (optional).
For some types of mounting material, drilling pilot holes is necessary.
- 6 Securely fasten the mount to the surface using the supplied screws ②.
- 7 Slide the fist microphone ③ onto the mount.

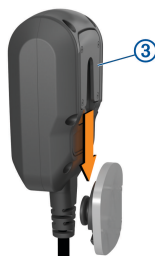

Group Ride Radio Specifications

Water resistance	IEC 60529 IPX7 ¹
Operating temperature range	From -20° to 55°C (from -4° to 131°F)
Charging temperature range	From 0° to 45°C (from 32° to 113°F)

¹ The device withstands incidental exposure to water of up to 1 m for up to 30 min. For more information, go to www.garmin.com/waterrating.

Power input (vehicle power cable, motorcycle, or external power)	From 12 to 24 Vdc
Battery type	Lithium-ion battery
Battery voltage range	From 3.5 to 4.1 V
Wireless frequencies (United States)	From 151.82 to 154.6 MHz @ 31.7 dBm
Wireless frequencies (EMEA)	From 169.4125 to 169.4625 MHz @ 29.5 dBm
Wireless frequencies (New Zealand)	From 160.175 to 160.5750 MHz @ 22 dBm
Wireless frequencies (Australia)	From 151.15 to 152.15 MHz @ 17.3 dBm





support.garmin.com

© 2020 Garmin Ltd. or its subsidiaries

Garmin® and the Garmin logo are trademarks of Garmin Ltd. or its subsidiaries, registered in the USA and other countries. These trademarks may not be used without the express permission of Garmin.

The BLUETOOTH® word mark and logos are owned by the Bluetooth SIG, Inc. and any use of such marks by Garmin is under license. Wi-Fi® is a registered mark of Wi-Fi Alliance Corporation.



Printed in Taiwan
October 2020
I90-02649-92_01

