

SCOSCHE® RHYTHM

WIRELESS PULSE MONITOR For iPhone, iPad, iPod touch and Android

QUICK START GUIDE

IMPORTANT

- This is a quick start guide only. Please read the complete owner's manual before use. The complete owner's manual can be found by visiting the product page of the SCOSCHE® RHYTHM at scosche.com
- DISCLAIMER:** This is not a medical device and is intended for recreational use only. Consult a physician prior to use to determine appropriate heart rate zones.

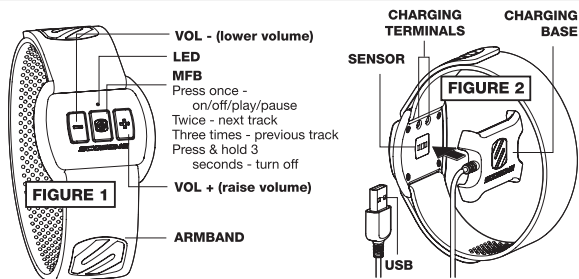

CHARGING

Charge the SCOSCHE® RHYTHM for 2 hours or until a solid blue light indicates the unit is fully charged.

- Attach the charging base to the SCOSCHE® RHYTHM unit (Figure 3).
- Connect the USB to a wall charger or your computer.
- A red flashing LED indicates that the unit is charging.
- Remove the charging base as shown (Figure 4).

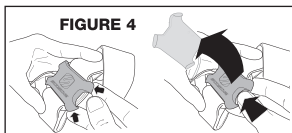
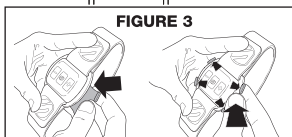

IMPORTANT!

DO NOT RETURN PRODUCT TO THE RETAILER
IF YOU NEED ASSISTANCE OR REPLACEMENT PARTS
CALL US TOLL FREE: 1-800-621-3695 X3
HOURS MON-FRI 8AM-5:30PM (PST) SATURDAY 8AM-2PM (PST)

©2012 SCOSCHE INDUSTRIES, INC.

SI 300RTHM (QS) 6/12

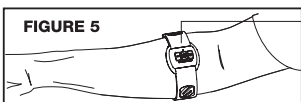

Wear armband on the upper portion of the forearm. Sensor should be on the inside or top of forearm. It should be worn snug enough not to move on your arm, but NOT so tight that it restricts arm circulation.

INITIAL SETUP FOR APPLE iOS

- Go to Settings > General > Bluetooth.
- Turn on the SCOSCHE® RHYTHM
- Once paired, you will be asked to download the SCOSCHE® RHYTHM App. If you are not prompted, open the App Store, and search for "Scosche RHYTHM".

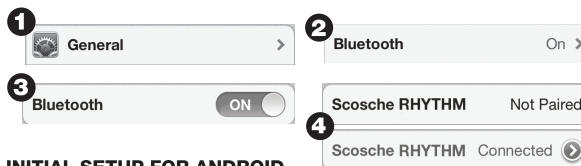

INITIAL SETUP FOR ANDROID

- Go to Settings > Wireless & networks > Bluetooth settings.
- Turn on the SCOSCHE® RHYTHM
- Go to Google play store and search for "Scosche RHYTHM".

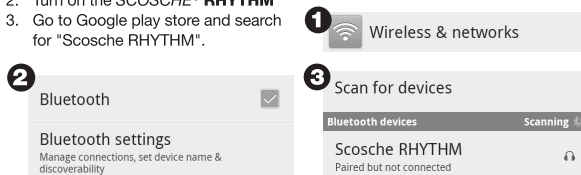

LIMITED WARRANTY

Scosche Industries Inc. warrants this product to be free from defects in material and workmanship for a period of 1 year from purchase. This Scosche product is sold with the understanding that the purchaser has independently determined the suitability of this product. This warranty is offered to the original purchaser of the product only. This warranty does not cover the product if physically damaged, subject to negligence or misuse, abuse, alteration, accident, or an act of GOD. This warranty does not apply to product which has water or physically damaged by accident or which has been misused, disassembled or altered.

The original dated sales slip or proof of purchase will establish warranty eligibility. If the product should prove defective within the warranty period, return the product with proof of purchase to Scosche Industries Inc. Scosche, at its option, will replace or repair the product free of charge and return the product postage paid.

In no event shall Scosche Industries, Inc. be responsible for claims beyond the replacement value of the defective product, or in any way be liable or responsible for consequential or incidental damages. No express warranties and no implied warranties, whether for fitness or any particular use or otherwise, except as set forth above (which is made expressly in lieu of all other warranties) shall apply to products sold by Scosche. Scosche Industries cannot be held responsible for discrepancies/inconsistencies that may occur due to automotive manufacturing changes or option.

iPhone, iPad and iPod touch are trademarks of Apple Inc., registered in the US and other countries.

2

FCC INFORMATION:

This device complies with Part 15 of the FCC Rules. Operation is subject to the following two conditions:

- This device may not cause harmful interference, and
- This device must accept any interference received, including interference that may cause undesired operation.

This equipment has been tested and found to comply with the limits for a Class B Digital Device, pursuant to Part 15 of the FCC Rules. These limits are designed to protect against interference that may be caused by this equipment in a typical residential environment. However, there is no guarantee that interference will not occur in a particular installation. If this equipment does cause harmful interference to radio or television reception, which can be determined by turning the radio or television off and on, the user is encouraged to try to correct interference by one or more of the following measures:

- Reorient or relocate the receiving antenna.
- Increase the separation between the equipment and receiver.
- Connect the equipment into an outlet on another circuit.
- Consult the dealer or an experienced radio/TV technician for help.

Caution: Any changes or modifications not expressly approved by the party responsible for compliance could void the user's authority to operate this equipment.