

BOTTOM DOCK BLUETOOTH® TRANSMITTER FOR IPOD

Congratulations on your purchase of the IPBTT. This unit incorporates the latest Bluetooth® technology for seamless integration with most Bluetooth® A2DP enabled products. Before using, please read this manual carefully.

FEATURES/SPECS

Lithium-ion 10 hour Rechargeable Battery (450mAh capacity)
 Designed with 30-pin iPod bottom dock (All iPods EXCEPT Shuffle, Gen 1, Gen 2)
 Wireless Range: Up to 30 Feet (10 Meters)
 Bluetooth® V1.2
 Transmitter Power < 3dbm
 Receiver Sensitivity: -78+4dm
 Supported Profiles: Advanced Audio Distribution Profile (A2DP) / Audio Video Remote Control Profile (AVRCP)
 Frequency Range: 2.4Ghz - 2.4835Ghz
 Dimensions: 55x40x10mm
 Weight: 16 grams
 Certifications: FCC

IPBTT OVERVIEW

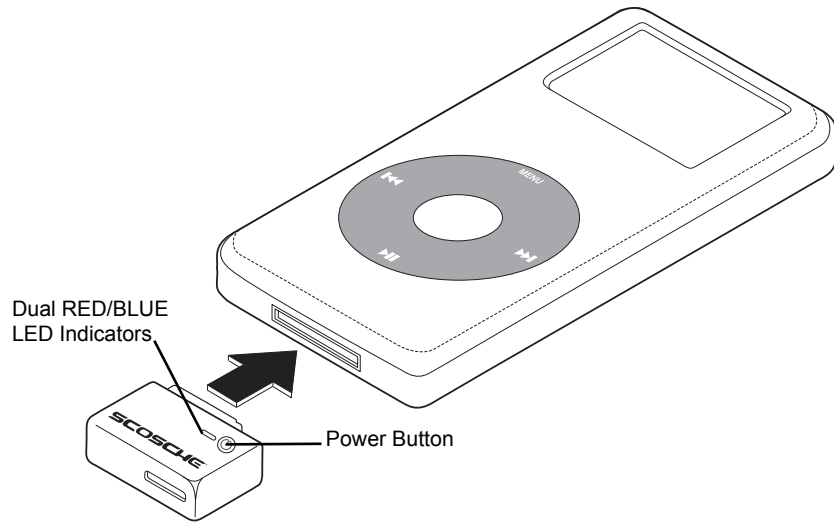

This device complies with FCC Rules Part 15. Operation is subject to the following two conditions: 1) This device may not cause interference, and 2) this device must accept any interference that may be received, including interference that may cause undesired operation. The manufacturer is not responsible for any radio or TV interference caused by unauthorized modification to this equipment. Such modification could void the user's authority to operate the equipment.



CHARGING THE BATTERY

NOTE:

Before using the IPBTT for the first time, charge the battery a full 3 hours. The IPBTT will also charge your iPod battery through the IPBTT power port.

1. Plug the Mini Connector on charger into the charging jack as shown in illustration.
2. Connect USB Cable to an available PC or Laptop USB port.
3. Charge Battery for 3 hours (LED will illuminate RED when charging)
4. The RED LED will turn off when charging is complete. Unplug the IPBTT and enjoy up to 10 hours of use.
5. Purchase wall and car adapters to charge at home and/or on the road. (IPPWR / IP2IN1 - Sold Separately)

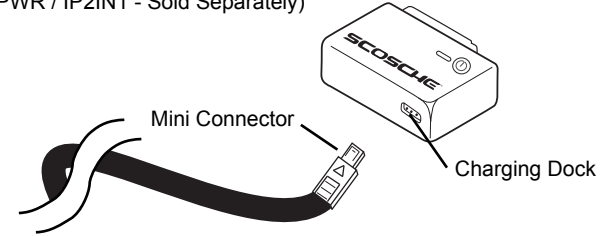

PAIRING THE TRANSMITTER WITH BLUETOOTH® DEVICES

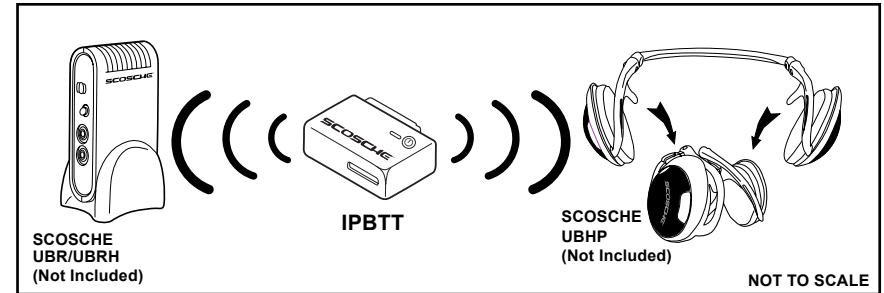

PAIRING NOTES:

- * The IPBTT transmitter must be paired with a Bluetooth® receiving device before use.
- * It is designed for AUTO-Pairing functionality. (Passcode = 0000)
- * Keep the IPBTT and Bluetooth® receiving device within a distance of 3ft. (1 Meter) during pairing.
- * Compatible devices must be Bluetooth® V1.2 supporting A2DP profile.

1. Power up your Bluetooth® receiving device (such as Scosche wireless headphones or Scosche Bluetooth® receiver) to place it into pairing mode. If needed, consult your Bluetooth® products manual for information on pairing or discovering other Bluetooth® devices.
2. While the Bluetooth® receiver LED is flashing, press and hold the power button on the IPBTT for 3 seconds. The Blue LED indicator light will flash indicating the unit is in pairing mode.
3. Initial pairing can take a few minutes. If pairing is successful, the IPBTT's LED will switch from flashing quickly to flashing slowly.
4. Test the connection by plugging the IPBTT into your iPods bottom dock connection with an audio selection playing. You should hear the audio through your Bluetooth® receiving device.
5. If pairing is not successful, repeat steps 1-4 above. Make sure both devices enter pairing mode at or near the same time. Power off any other Bluetooth® device that you do not intend to pair with the IPBTT as these units may interfere or prevent pairing of other nearby devices. If you still cannot successfully pair two devices, call **Tech Support at (1-800-621-3695 Ext.3)**

OPERATION

POWER ON/OFF

Press the Power Button for 3 seconds to turn the transmitter ON or OFF.

CONNECTION

Connect IPBTT to the bottom dock of your iPod. Turn the IPBTT on, then turn on your Bluetooth® headphones or receiving device. Once the two devices are paired, enjoy the audio.

REMOTE CONTROL SOURCE FUNCTIONS

ONLY when used with a receiving device that also supports the AVCRP profile for remote control functions. (Scosche Bluetooth® headphones - UBHP)

- PLAY/PAUSE

Press the power button on your Bluetooth® headphones (or other receiving devices) to PLAY or PAUSE the current track. Do not hold down the power button for more than 1 second or it may turn off the pwer.

(NOTE: Volume control will no longer be controlled through iPod wheel, only through Bluetooth® device controls).

- TRACK UP/DOWN

1. Press and hold the volume up button to skip forward to the next track.
2. Press and hold the volume down button to skip back to the beginning of the song.
3. Press and hold the volume down button a second time to skip backward to the previous track.

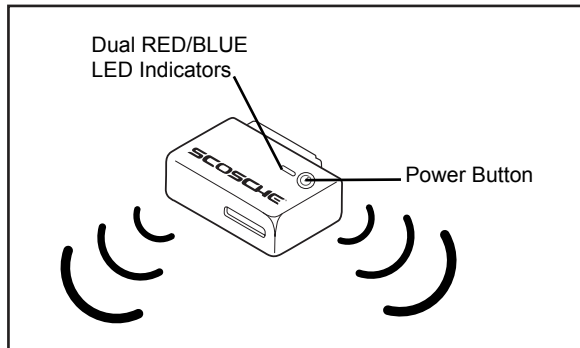

This product may not be compatible with all Bluetooth® features on all Bluetooth® enabled devices. This may or may not include send/end control functions, volume adjustment and voice dialing. Please consult your Bluetooth® enabled cell phone operation manual for specific features and instructions.

CARE AND MAINTENANCE

1. Keep this IPBTT unit away from moisture. Sources of humidity and all types of liquids will corrode electronic circuits.
2. Keep this IPBTT unit away from high heat. Extreme temperatures will shorten the life of electronic circuits and could possibly melt the plastic case. For example, do not store unit in direct sunlight on a vehicle dashboard.
3. Do not attempt to open or repair the transmitter. Non-expert handling may damage it and void any all possibly warranty claims.
4. Don't use harsh chemicals, cleaning solvents or detergents to clean the unit.

LED CHART

LED COLOR	STATUS
Blue LED fast blinking	Pairing Mode
Blue LED slow blinking	Connected with Bluetooth® device
Red ON and/or Blue Slowly Blinking	Charging and/or connected with Bluetooth® device
Red LED Solid	Battery is currently charging or LOW on battery life
Red LED off	Charging Complete

PROBLEM

TIPS/SOLUTION

Red LED indicator light is bright	Low Battery - Recharge Necessary
Unit drops wireless link	The connection range varies on the surrounding environment. Range is not guaranteed to be 30 feet in all situations. Range can be reduced by other electronic devices, include cordless phones, microwaves and typical household electronics.
Unit loses wireless for no reason	Check for other competing Bluetooth® or 2.4Ghz electronic devices in close proximity to the IPBTT. Power down these devices.
IPBTT won't pair with my device	Make sure both devices enter pairing mode at or near the same time. Make sure your Bluetooth® device allows auto-pairing. Make sure your Bluetooth® device uses a Passcode of "0000" and has A2DP profile enabled.
No audio heard from transmitter	Check to make sure the two products successfully pair and both devices are powered ON. Make sure you are within range of the IPBTT. Make sure source volume is not muted.

LIMITED WARRANTY

Scosche Industries Inc. warrants this product to be free from defects in material and workmanship for a period of 90 days from purchase. This Scosche product is sold with the understanding that the purchaser has independently determined the suitability of this product. This warranty is offered to the original purchaser of the product only. This warranty does not cover the product if physically damaged, subject to negligence or misuse, abuse, alteration, accident, or an act of GOD. This warranty does not apply to product which has water or physically damaged by accident or which has been miss used, disassembled or altered.

The original dated sales slip or proof of purchase will establish warranty eligibility. If the product should prove defective within the warranty period, return the product with proof of purchase to Scosche Industries Inc. Scosche, at its option, will replace or repair the product free of charge and return the product postage paid.

In no event shall Scosche Industries, Inc. be responsible for claims beyond the replacement value of the defective product, or in any way be liable or responsible for consequential or incidental damages. No express warranties and no implied warranties, whether for fitness or any particular use or otherwise, except as set forth above (which is made expressly in lieu of all other warranties) shall apply to products sold by Scosche. Scosche Industries cannot be held responsible for discrepancies/inconsistencies that may occur due to automotive manufacturing changes or option.