

TROUBLE SHOOTING

PROBLEM	TIP/SOLUTION
Red LED Indicator Light is bright	LOW Battery - recharge necessary
Unit drops wireless link less than 30 feet away	The Connection range varies on the surrounding environment. Range is not guaranteed to be 30 feet in all cases. Range can be reduced by other competing electronic devices include cordless telephones, microwaves and typical household electronic. Range can also be reduced by low battery power.
Unit loses wireless link for no reason	Check for other competing Bluetooth® or 2.4Ghz electronic devices in close proximity to the IUBTT. Power down these competing devices
IUBTT wont pair with my device	Make sure both devices enter pairing mode at or near the same time. Make sure your Bluetooth® device allows auto-pairing. Make sure your Bluetooth® device uses a Pass code of "0000" and has A2DP profile enabled.
No audio heard from transmitter	Check to make sure the two products are successfully paired and both devices are powered ON. Make sure you are within range of the IUBTT. Make sure source volume is not muted. Ensure BT receiver cables are securely hooked to steeo and stereo is in AUX/input mode.

LIMITED WARRANTY

Scosche Industries Inc. warrants this product to be free from defects in material and workmanship for a period of 90 days from purchase. This Scosche product is sold with the understanding that the purchaser has independently determined the suitability of this product. This warranty is offered to the original purchaser of the product only. This warranty does not cover the product if physically damaged, subjected to negligence or misuse, abuse, alteration, accident, or an act of God. This warranty does not apply to product which has been water or physically damaged, damaged by accident or which has been misused, disassembled or altered.

The original dated sales slip or proof of purchase will establish warranty eligibility. If the product should prove defective within the warranty period, return the product with proof of purchase to Scosche Industries Inc. Scosche, at it's option, will replace or repair the product free of charge and return the product postage paid.

In no event shall Scosche Industries, Inc. be responsible for claims beyond the replacement value of the defective product, or in any way be liable or responsible for consequential or incidental damages.

No express warranties and no implied warranties, whether for fitness or any particular use, or otherwise, except as set forth above (which is made expressly in lieu of all other warranties) shall apply to products sold by Scosche. Scosche Industries cannot be held responsible for discrepancies/inconsistencies that may occur due to automotive manufacturing changes or options.

This device complies with FCC Rules Part 15. Operation is subject to the following two conditions: 1) This device may not cause interference, and (2) this device must accept any interference that may be received, including interference that may cause undesired operation. The manufacturer is not responsible for any radio or TV interference caused by unauthorized modification to this equipment. Such modification could void the user's authority to operate the equipment.

SCOSCHE®

IUBTT

IPOD / UNIVERSAL BLUETOOTH® TRANSMITTER

Congratulations on your purchase of the Scosche IUBTT. This unit incorporates the latest Bluetooth® technology for seamless integration with most Bluetooth® A2DP enabled products. Before using, please read this manual carefully.

FEATURES:

- Lithium-ion 8 hour Rechargeable Battery
- 3.5mm to 2.5mm micro jack adapter
- 3.5mm to ¼" HiFi headphone jack adapter
- Wireless Range: Up to 30 feet (10 Meters)
- Bluetooth® V1.2 (Class 2)
- Works with Scosche Bluetooth® Receivers:
 - IUBCKH -UBRH
 - IPBCK -UBCK
 - UBR -UBHP
- Supported Profile: Advanced Audio Distribution Profile (A2DP)
- Frequency Range: 2.4GHz-2.4835GHz
- Dimensions 55x40x10mm
- Weight 30 grams
- Certifications: BQB / FCC

IUBTT OVERVIEW

1. Dual RED/BLUE LED Indicators
2. Power Button
3. 3.5MM Audio Input cable
4. Charging jack

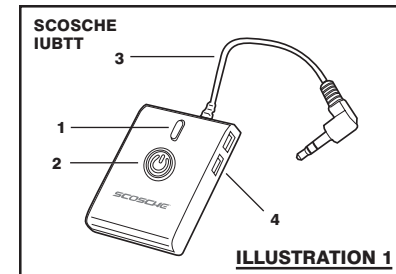

CHARGING THE BATTERY

NOTE:

Before using the IUBTT for the first time, charge the battery for a full 2 hours.

1. Plug the mini cable charger into charging jack as shown in Illustration 2.
2. Connect USB Cable to an available PC or LAPTOP USB port
3. Charge Battery for 2 hours (LED will illuminate RED when charging)
4. The Red LED will turn off when charging is complete. Unplug the IUBTT and enjoy up to 7.5 hours of use.

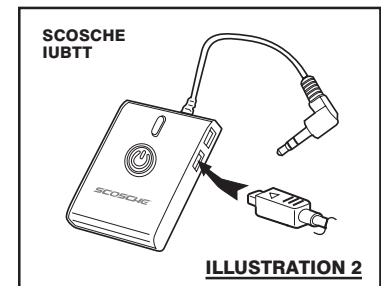

This product may not be compatible with all Bluetooth® features on all Bluetooth® enabled products. Please consult your Bluetooth® A2DP enabled product operation manual for specific features and instructions.



If you have any further questions, all our TOLL-FREE number:
TECHNICAL HELP line 1-800-621-3695 x3

©2006 SCOSCHE INDUSTRIES, INC.
OXNARD, CA 93033
300IUBTT5/06 Rev A

PAIRING THE TRANSMITTER WITH BLUETOOTH DEVICES

INITIAL PAIRING:

1. Power on your Bluetooth® receiving device [such as Wireless Headphones or Scosche IUBCKH/UBRH Bluetooth® receiver]. Make sure your Bluetooth® device is in pairing mode [look for nearby Bluetooth® devices]. If needed, consult your Bluetooth® products manual for information on pairing or discovering other Bluetooth® devices.
2. Press and hold the Power button on the IUBTT for approximately 1-3 seconds. The Blue LED indicator light will begin to flash indicating the unit is in pairing mode.
3. Initial pairing can take up to 2 minutes. If pairing is successful, the IUBTT's LED will stop flashing and illuminate solid Blue. If unsuccessful, the IUBTT will time out for 10 seconds and then go back into pairing mode automatically. (LED with flash 2x/off/2x/off with timed out)
 - A. If you are prompted for a passcode, then enter "0000".
4. Test the connection by plugging the IUBTT into your portable device's headphone jack with an audio selection playing. You should hear the audio through your Bluetooth® receiving device such as Stereo Wireless Headphones.
5. If you are not successful pairing devices, repeat steps 1-4 above. Make sure both devices enter pairing mode at or near the same time. Power off any other Bluetooth® mobile devices you do not intend to use with the IUBTT as these units may interfere or prevent pairing of other nearby devices. If you still cannot successfully pair two devices, call Tech Support at (800) 621-3695 Ext 3.

RE-CONNECTING (Normal use for components already PAIRED)

IUBTT WITH SCOSCHE RECEIVER (Only):

1. Power on your Scosche IUBCKH/UBRH receiver.
2. Start tone will be heard (if AUX source is selected on stereo system).
3. Wait 35 seconds before turning on the IUBTT (When Scosche IUBCKH/UBRH Bluetooth receivers initialize, they are looking for Bluetooth® cell phones 1st resulting in a 35 second delay if just using the IUBTT).
4. After the 35 second elapsed time, the IUBTT should establish connection with the Scosche receiver within 5 seconds. The IUBTT LED will illuminate solid Blue when connection is established.

IUBTT WITH CELL PHONE and SCOSCHE RECEIVER

1. Have Bluetooth® power enabled on your cell phone.
2. Power on your Scosche IUBCKH/UBRH receiver. It will connect with your cell phone first.
3. Once the IUBCKH/UBRH re-establishes connection with your phone, power on the IUBTT.
4. The IUBTT should re-connect within 5-10 seconds. The IUBTT LED will illuminate solid Blue when connection is established.

NOTE: Some Bluetooth® cellular phones may not auto-reconnect with other previously connected Bluetooth® devices. You may need to turn on Bluetooth® each time the Scosche receiver is powered on. Consult your Cell phone owner manual for details on Bluetooth® operation for your particular phone.

IUBTT WITH OTHER BLUETOOTH® (Auto-pairing) PRODUCTS

1. Power on Bluetooth® headphones or Bluetooth® receiving device first.
2. Power on your Scosche IUBTT transmitter.
3. The two Bluetooth® devices should re-connect within 5-10 seconds.
4. The IUBTT LED will illuminate solid Blue when connection is established.

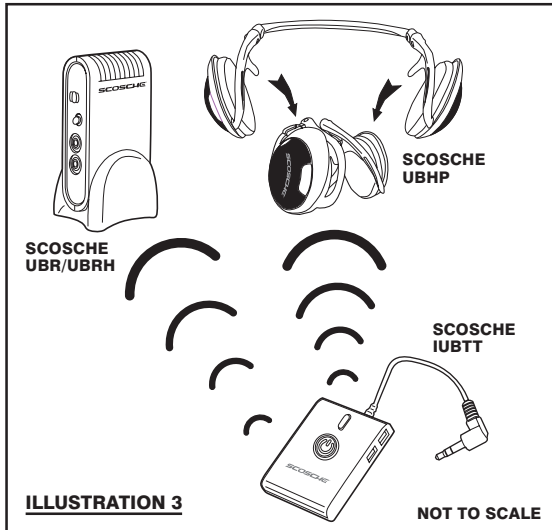

OPERATION

POWER ON/OFF:

Press the Power Button 1-3 seconds to turn the transmitter ON or OFF.

CONNECTION:

Connect the 3.5mm IUBTT input jack to the headphone or line output plug of your iPod, MP3 or other portable media device. Turn on the IUBTT first, then turn on your Bluetooth® Headphones or receiving device and enjoy the audio.

CONNECTION ADAPTERS:

The IUBTT include adapters for use with the following applications:

3.5mm Male to 2.5mm Male (90 degree bend, gold-plated):

This adapter allows the IUBTT to connect with various cellular phones or PDA devices that include a micro 2.5mm stereo headphone jack. (See Illustration 4)

3.5mm Male to ¼ HiFi headphone Male (gold-plated)

This adapter allows the IUBTT to connect with home HiFi stereo receivers or devices that use 1/4" headphone jack. (See Illustration 4).

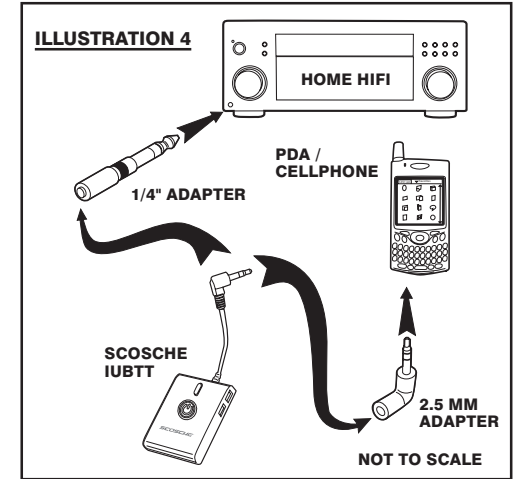

CARE AND MAINTENANCE

1. Keep your IUBTT unit away from moisture. Sources of humidity and all types of liquids will corrode electronic circuits
2. Keep this IUBTT unit away from high heat. Extreme temperatures will shorten the life of electronic circuits and could possibly melt the plastic case. For example, do not store the unit in direct sunlight on a vehicle dashboard.
3. Don't attempt to open or repair the transmitter. Non-expert handling may damage it and void any / all possible warranty claims.
4. Don't use harsh chemicals, cleaning solvents or detergents to clean the unit.

LED CHART

LED/COLOR	STATUS
Blue LED Blinking	Pairing Mode
Blue LED Solid	Connected with Bluetooth® Headphones or Bluetooth® Receiving Device
Red and Blue LED on Solid	Charging and Connected with Bluetooth® Device
Red LED Solid	Battery is Currently Charging or LOW Battery
Red LED Off	Charging Complete
2 flash 2 X / Off / 2 X	Time out from Pairing