

Model No.: WT-4677

FUNCTIONS AND CONTROLS

1. Pen Button
2. Push-to-talk Button
3. Pen Clip
4. Earphone Jack
5. On/Off Switch (Walkie Talkie)
6. Battery Door
7. Battery Door Screw
8. Microphone
9. Speaker
10. Pen

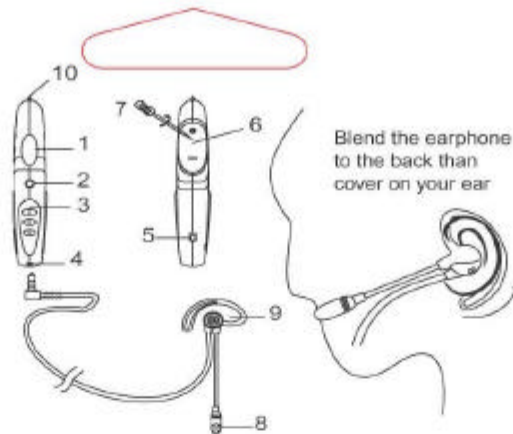

BATTERY INSTALLATION

Each walkie talkie unit operates on 4 pcs
DC1.5V button cell (AG13 OR LR44) batteries.

1. Remove the battery door (#6) with (+) screwdriver.
2. Follow the polarity diagram inside the battery compartment, install the 4 batteries with positive (+) terminals as shown.
3. Replace the battery door (#6) and tighten the battery door screw (#7).
4. For better performance and longer operating time, we recommend the use of alkaline-type batteries.
5. (a) Non-rechargeable batteries are not to be recharged;
(b) Rechargeable batteries are to be removed from the toy before being charged;
(c) Different types of batteries or new and used batteries are not to be mixed;
(d) Only batteries of the same or equivalent type as recommended are to be used;
(e) Batteries are to be inserted with the correct polarity;
(f) Exhausted batteries are to be removed from the toy;
(g) Do not mix alkaline, standard (carbon-zinc) or rechargeable (nickel-cadmium) batteries;
(h) The supply terminals are not to be short-circuited;
6. When the sound of the unit becomes weak, it is the time to replace batteries.
7. If the unit is not to be used for an extended period of time, remove the batteries. Old and leaking batteries can cause damage to the unit.

OPERATION FOR WALKIE TALKIES

1. Batteries are included with your new Walkie talkies. To prevent accidental battery drain during shipment, a protective insulator has been put between the battery contacts. To activate your unit, remove the battery insulation tab from the battery compartment by pulling on the tab. There is no need to remove the battery cover.
2. Put on the earphone onto your left ear as shown.
3. Switch on the unit by sliding the On/Off switch (#5) to "ON".
4. Adjust the position of the Flexible Microphone (#8) so that it is about 1/2 inch from your mouth.
5. To Transmit a message. Push "Push-to-talk" Button (#2) and talk clearly to the microphone (#8) towards your mouth about 6-7cm away.
6. To receive a message, release the Push-to-talk switch (#2).
7. To switch off the unit, slide the On/Off switch (#5) to "OFF".

OPERATION FOR PEN

1. Push the pen button (#1).

CARE AND MAINTENANCE

1. Clean your unit with a damp (never wet) cloth. Solvent or detergent should never be used.
2. Avoid leaving your unit in direct sunlight or in hot, humid or dusty places.
3. Keep your unit away from heating appliances and sources of electrical noise such as fluorescent lamps or motors.

THE MANUFACTURER IS NOT RESPONSIBLE FOR ANY UNAUTHORIZED MODIFICATIONS TO THE EQUIPMENT, SUCH MODIFICATIONS COULD VOID THE USER'S GUARANTEE.
SPECIFICATIONS AND COLORS OF CONTENTS MAY VARY FROM PHOTO.
SPECIFICATIONS ARE SUBJECT TO CHANGE WITHOUT NOTICE.

KEEP THIS INFORMATION FOR FURTHER REFERENCE.

Made in China

