

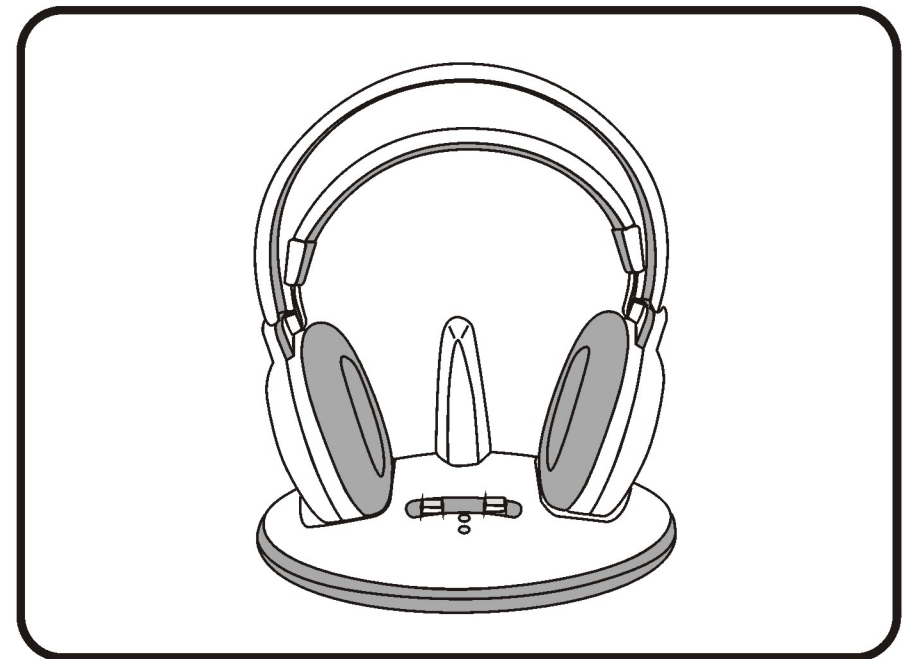

**HIGH FREQUENCY MODULATION**

# ***Digital Wireless Headphone System***



***RFS-6800D***

## How to use

1. Turn on the audio/video equipment connected to the transmitter.

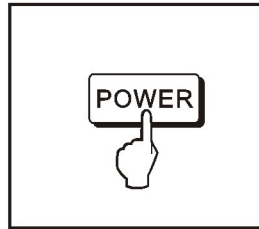

2. Press tuning button for best possible transmission

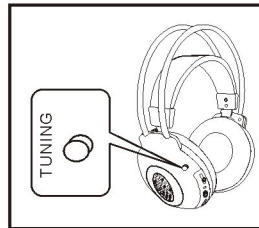

3. Switch to "SURR" for surround sound or "ST" for stereo sound.

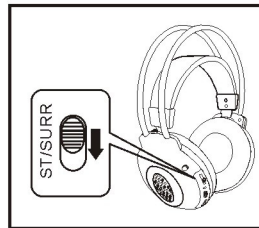

4. Turn on the power switch for headphone.

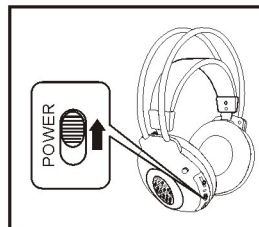

5. Adjust volume control on the left side.

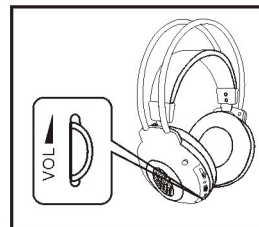

## TRANSMITTER

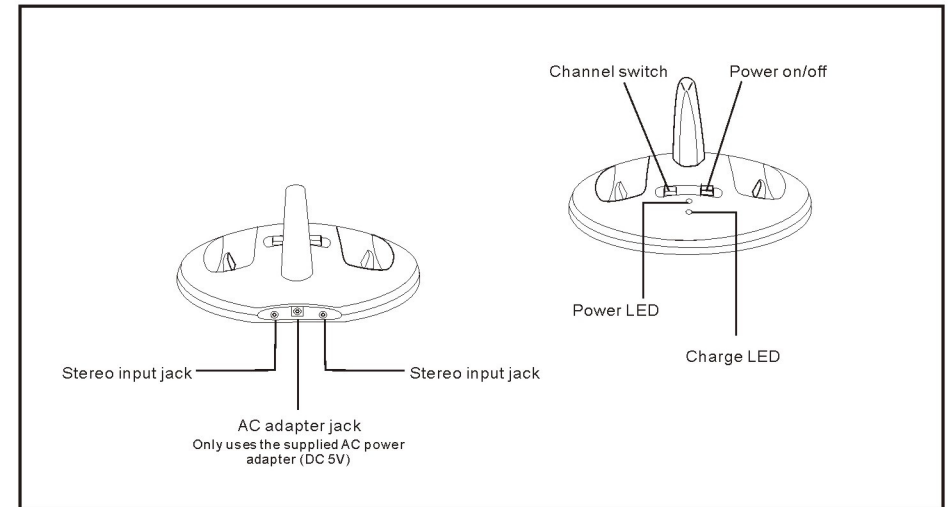

## Specifications

### GENERAL

Power source	DC 1.5V x 2 (size "AAA" x 2)
Tuning range	2.410 ~ 2.473 GHz.
Max. Sensitivity	48dB $\pm$ 5dB
Image rejection	20 ~ 28dB
Max. Indicator sensitivity	20 ~ 28dB

### RFS-6800 TRANSMITTER

Power requirement	AC adapter O/P DC 5V 300mA
Transmission frequency	2.410 ~ 2.473 GHz.
Output impedance	50 Ohm
Input impedance	20K Ohm
Channel balance	45dB Max.
Channel separation	$\pm$ 2dB
Output power	6 $\pm$ 1mW
Effective range	About 180 feet
Weight	About 220g (Ex. adapter & audio cable)

### RFS-6800 RF STEREO HEADPHONE

Speaker	40mm Mylar cone
Frequency response	20Hz ~ 22KHz
Sensitivity	50mW x 2 105dB
Max. Output Power	About 48 hours (at 10mW output)
Batter life (at 10mW)Weight	About 210g (Ex. Batteries)

Notice : The changes or modifications not expressly approved by the party responsible for compliance could void the user's authority to operate the equipment.

**IMPORTANT NOTE:** To comply with the FCC RF exposure compliance requirements, the antenna(s) used for this transmitter must not be co-located or operating in conjunction with any other antenna or transmitter. No change to the antenna or the device is permitted. Any change to the antenna or the device could result in the device exceeding the RF exposure requirements and void user's authority to operate the device.

## FCC INFORMATION

The Federal Communication Commission Radio Frequency Interference Statement includes the following paragraph:

The equipment has been tested and found to comply with the limits for a Class B Digital Device, pursuant to part 15 of the FCC Rules. These limits are designed to provide reasonable protection against harmful interference in a residential installation. This equipment generates, uses and can radiate radio frequency energy and, if not installed and used in accordance with the instruction, may cause harmful interference to radio communication. However, there is no grantee that interference will not occur in a particular installation. If this equipment does cause harmful interference to radio or television reception, which can be determined by turning the equipment off and on, the user is encouraged to try to correct the interference by one or more of the following measures:

- Reorient or relocate the receiving antenna.
- Increase the separation between the equipment and receiver.
- Connect the equipment into an outlet on a circuit different from that to which the receiver is connected.
- Consult the dealer or an experienced radio/TV technician for help.

The user should not modify or change this equipment without written approval  
Form BRIGHT HEADPHONE ELECTRONICS CO. Modification could void authority to use this equipment.