

4. Replace the new batteries

Please replace a pair of new batteries and follow the previous instructions. (2, 3)

Note

- The blue LED on the wheel bar of the mouse is a low batteries power indicator. It indicates that batteries inside the mouse need to be replaced.

❖Trouble shooting

- (1) Make sure you have connected the receiver correctly to the computer's USB or PS2 port.
- (2) For the supreme performance, we suggest you locate the receiver with a distance from other electrical devices, such as the computer, the computer monitor or external storage drives.
- (3) Make sure you have set the communication between the receiver and the mouse. Refer to the channel setting instruction in this manual.
- (4) Some system devices might conflict with the mouse. Confirm the IRQ/address settings of these devices for conflicts, and change the settings as required.
- (5) Try unplugging then reconnecting the receiver cable to your computer.
- (6) When the battery power is low, the mouse's performance or the transmission distance may not be good. Please replace the new battery.

❖Battery use reminders

- (1)Keep all batteries (used or new) out of the reach of children.
- (2)To have the batteries with a regular check and replace new batteries if not used for a long time.
- (3)Remove batteries from the electrical device if the device is not going to be used for a long time.
- (4)If the performance of the batteries decrease substantially, it is time to replace the batteries.
- (5)Do not mix different types of batteries (e.g. NiMH, NiCd, alkaline, etc) in the mouse.

FCC statement

This equipment has been tested and found to comply with the limits for a class B digital device, pursuant to Part 15 of the FCC Rules. These limits are designed to provide reasonable protection against harmful interference in a residential installation.

This equipment generates uses and can radiate radio frequency energy and, if not installed and used in accordance with the instructions, may cause harmful interference to radio communications. However, there is no guarantee that interference will not occur in a particular installation if this equipment does cause harmful interference to radio or television reception, which can be determined by turning the equipment off and on, the user is encouraged to try to correct the interference by one of the following measures:

- Reorient or relocate the receiving antenna.
- Increase the separation between the equipment and receiver.
- Connect the equipment into an outlet on a circuit different from that to which the receiver is connected.

To assure continued compliance, any changes or modifications not expressly approved by the party responsible for compliance could void the user's authority to operate this equipment. (Example-use only shielded interface cables when connecting to computer or peripheral devices).

This device complies with Part 15 of the FCC Rules. Operation is subject to the following two conditions:

- (1) This device may not cause harmful interference. and
- (2) This device must accept any interference received, including interference that may cause undesired operation.



This symbol on the product or in the instructions means that your electrical and electronic equipment should be disposed at the end its life separately from your household waste. There are sparate collection system for recycling in the EU.

For more information, please contact the local authority or your retailer where you purchased the product.

Wireless Optical Mouse



User's Guide

Introduction

Congratulations on your purchase of the most innovative wireless optical mouse. With an incredible sensitivity to surface details and high tracking speed than other mice, the mouse can track reliably even on tricky polished or wood-grain surfaces. It offers even more advance that will make you more productive and more comfortable.

Features

- 2.4GHz RF (distance 6~8m)
- Using state-of-art technology. High tracking speed and sensitivity.
- Longer battery life
- 16 Channels/4096 ID per channels
- Auto-Link, Plug and Play! No need to set the channel ID.
- Power on/off button
- 2*AA Alkaline batteries included
- 800 dpi

Mouse

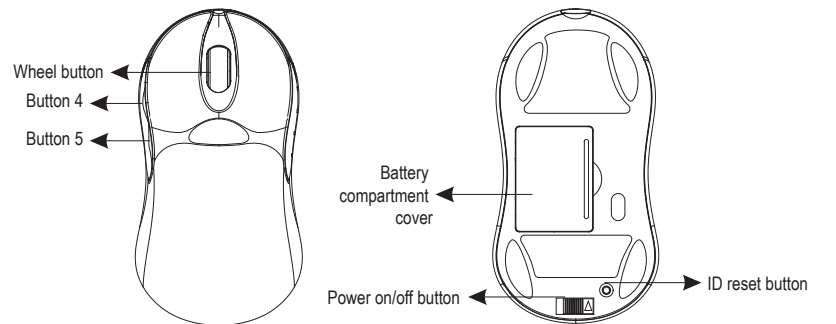

A. Hardware Installation

1. Insert the batteries

- Press the battery cover switch on the bottom of the mouse to open the battery compartment.
- Fit in the batteries accordingly to the diagram indicated in the battery cabinet.
- Close the battery compartments cover properly.
- The Low Power LED on the wheel bar will blink 3 seconds if the mouse power is on.

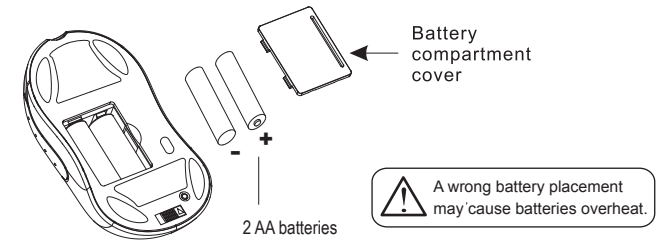

Note

- The Cordless Wheel Mouse unit offers a strong power saving management function. Once the mouse accesses the sleeping mode, "to click any button of the mouse" is compulsory to wake it up.

2. Connect the receiver

- Turn on your PC.
- Connect the receiver to USB port on PC

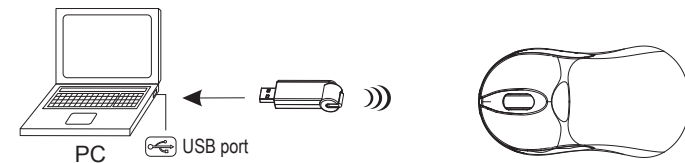

3. Communication : The mouse

The 2.4Ghz RF mouse features a dual-way transmission technology which enables the mouse and the receiver auto-communication.

A. Auto-link mode

- Make sure the Power On-Off Switch on the bottom of the mouse is ON.
- Operate the mouse, and the LED in the receiver will blink fast. Now the mouse and the receiver is auto-linked successfully.

B. Manual mode

If you find the communication channel does not connect well, you can use following steps

