

EX5512-T0

AX6000 WiFi6 Multi-Gigabit Ethernet Gateway

Package Contents

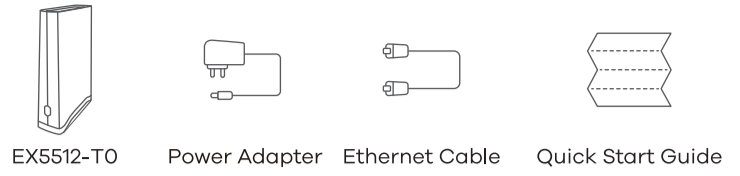

A member of the Zyxel MPro Mesh solution family.
MPro Mesh Solution:

- EX5512-T0
- WX5512-T0
- MPro Mesh App

Visit www.zyxel.com/us/en for updated information.

Quick Start Guide

US Importer

Zyxel Communications, Inc
1130 North Miller Street Anaheim, CA 92806-2001
<https://www.zyxel.com/us/en/>

Copyright © 2022 Zyxel and/or its affiliates. All Rights Reserved.

Step 1 Hardware Installation

- 1 Use the included blue cable to connect the xDSL/cable/fiber modem's LAN port to the EX5512-T0's WAN port as illustrated.

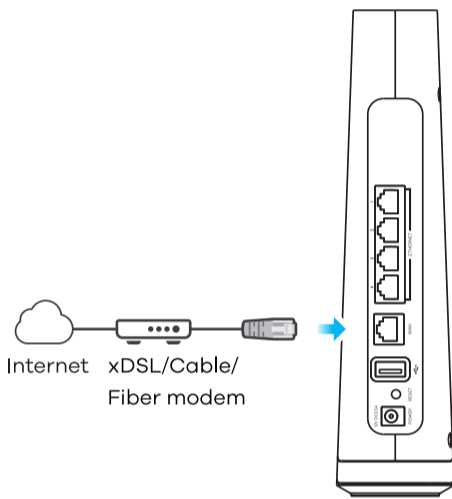

- 2 Connect the power adapter to the EX5512-T0 and wait for 2 minutes. Check the EX5512-T0 front panel.

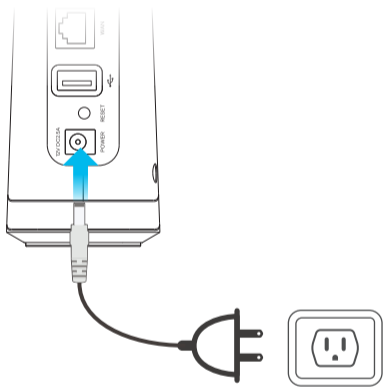

- 3 The Power /Internet /WAN /2.4G /5G LEDs will light up green as below when the setup is complete.
Note: If the lights do not turn on green, please retry ① ② ③ or contact your service provider for assistance.

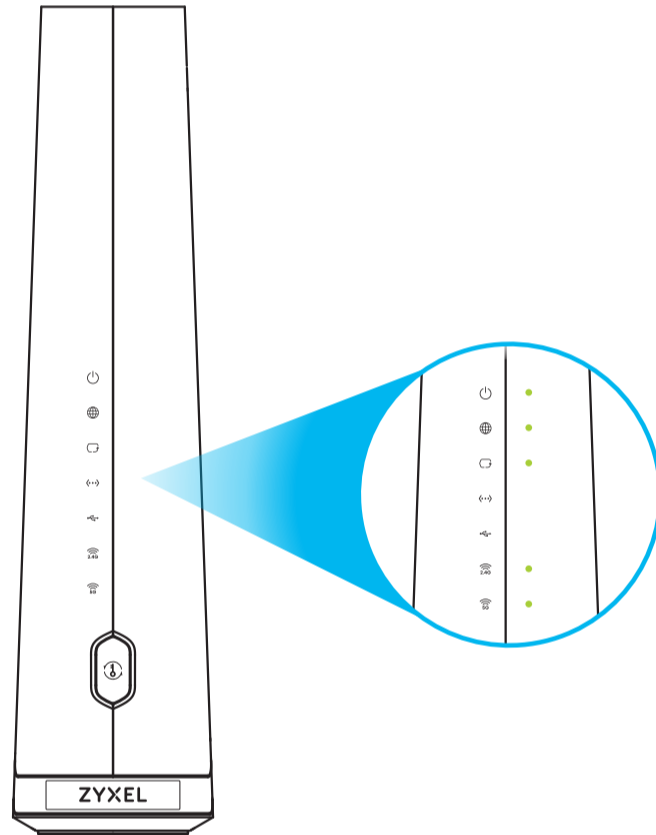

POWER	Green	On - Power is on. Blinking - Starting up.
	Red	On - System failure. Blinking - Upgrading firmware.
INTERNET	Green	On - Internet is ready. Blinking - Transmitting/receiving internet data.
	Red	On - Attempt to get an IP address failed.
WAN	Green	On - Link up. Off - Link down.
LAN	Green	On - Link up. Off - Link down.
USB	Green	On - Link up. Off - Link down.
2.4G	Green	On - 2.4GHz WiFi is ready. Blinking - Transmitting/receiving data.
5G	Green	On - 5GHz WiFi is ready. Blinking - Transmitting/receiving data.

Step 2 WiFi Connection A or B

The label on the side of the EX5512-T0 provides 2 ways to connect your wireless device to WiFi:
Method A: Scan QR code or Method B: Using SSID

Method A: SCAN QR code to connect WiFi

- 1 Check the QR code on the EX5512-T0's side label, and use your wireless device to scan this QR code.
- 2 After scanning the QR code, join this SSID and you can surf the internet.

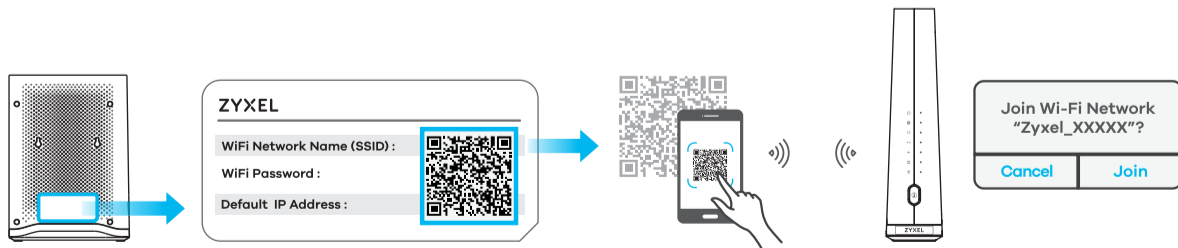

B. Using the SSID method to connect WiFi

- 1 The WiFi SSID is on the EX5512-T0's side label.
- 2 On your wireless device, find this SSID and enter the WiFi Password on your wireless clients and you can surf the internet.

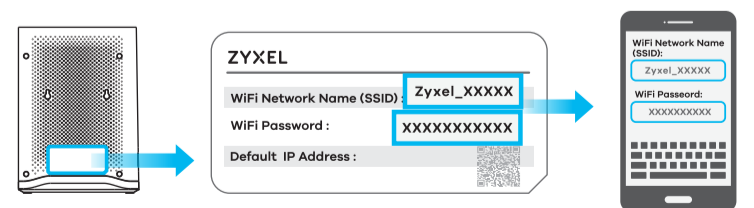

Step 3 App Management

- 1 After successfully surfing the internet, please download the MPro Mesh app to your wireless device to manage your MPro Mesh.



- 2 Open this app and enter the EX5512-T0's serial number. The serial number is on the bottom label as below.

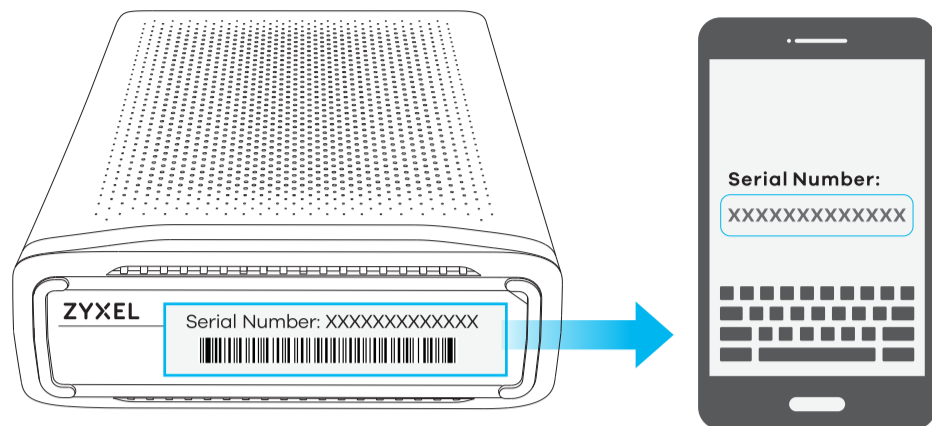

- 3 Use this app to enjoy the following features:

- Remote Management
- View Home Devices
- Guest Wi-Fi
- Manage Home Wi-Fi Name
- Internet Instant Block
- Add Mesh Extender
- Push Notification

Adding a Wireless Extender

WPS button: If you have a wireless extender you want to add to your EX5512-T0's WiFi network, press the EX5512-T0 button once, and press the WPS button on your extender within 120 seconds to start the WPS process.

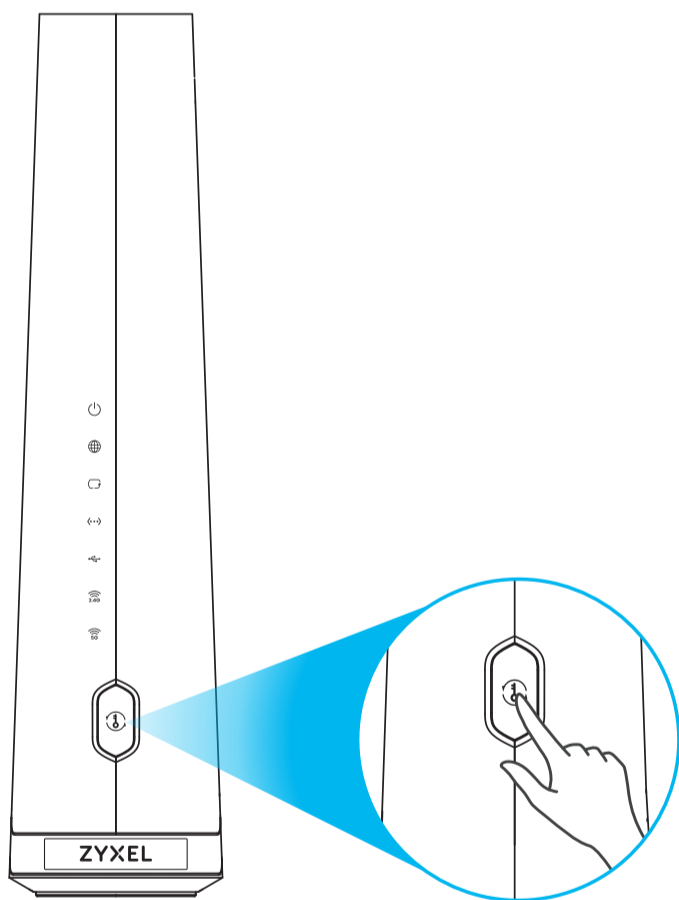

Safety Warnings

- DO NOT use this product near water, for example, in a wet basement or near a swimming pool.
 - DO NOT expose your device to dampness, dust or corrosive liquids.
 - DO NOT store things on the device.
 - DO NOT install, use, or service this device during a thunderstorm. There is a remote risk of electric shock from lightning.
 - Connect ONLY suitable accessories to the device.
 - DO NOT open the device or unit. Opening or removing covers can expose you to dangerous high voltage points or other risks.
 - ONLY qualified service personnel should service or disassemble this device. Please contact your vendor for further information.
 - Make sure to connect the cables to the correct ports.
 - Place connecting cables carefully so that no one will step on them or stumble over them.
 - Always disconnect all cables from this device before servicing or disassembling.
 - Please use the provided or designated connection cables/power cables/ adaptors. Connect it to the right supply voltage (for example, 110V AC in North America or 230V AC in Europe). If the power adaptor or cord is damaged, it might cause electrocution. Remove it from the device and the power source, repairing the power adaptor or cord is prohibited. Contact your local vendor to order a new one.
 - DO NOT remove the plug and connect it to a power outlet by itself; always attach the plug to the power adaptor first before connecting it to a power outlet.
 - DO NOT allow anything to rest on the power adaptor or cord and do NOT place the product where anyone can walk on the power adaptor or cord.
 - DO NOT use the device outside, and make sure all the connections are indoors. There is a remote risk of electric shock from lightning.
 - CAUTION: Risk of explosion if battery (on the motherboard) is replaced by an incorrect type. Dispose of used batteries according to the instructions. Dispose of them at the applicable collection point for the recycling of electrical and electronic equipment. For detailed information about recycling of this product, please contact your local city office, your household waste disposal service or the store where you purchased the product.
 - DO NOT obstruct the device ventilation slots, as insufficient airflow may harm your device.
- For example, do not place the device in an enclosed space such as a box or on a very soft surface such as a bed or sofa.
- The following warning statements apply, where the disconnect device is not incorporated in the equipment or where the plug on the power supply cord is intended to serve as the disconnect device,
 - for permanently connected devices, a readily accessible disconnect device shall be incorporated external to the equipment;
 - for pluggable devices, the socket-outlet shall be installed near the equipment and shall be easily accessible.
 - Caution! The RJ-45 jacks are not used for telephone line connection.

Regulatory Statements

UNITED STATES of AMERICA



The following information applies if you use the product within the USA.

FCC EMC Statement

- The device complies with Part 15 of FCC rules. Operation is subject to the following two conditions:
 - (1) This device may not cause harmful interference, and
 - (2) This device must accept any interference received, including interference that may cause undesired operation.
- Changes or modifications not expressly approved by the party responsible for compliance could void the user's authority to operate the device.
- This device has been tested and complies with the specifications for a Class B digital device, pursuant to Part 15 of the FCC Rules. These limits are designed to provide reasonable protection against harmful interference in a residential installation. This device generates, uses, and can radiate radio frequency energy and, if not installed and used according to the instructions, may cause harmful interference to radio communications. However, there is no guarantee that interference will not occur in a particular installation.

- If this device does cause harmful interference to radio or television reception, which is found by turning the device off and on, the user is encouraged to try to correct the interference by one or more of the following measures:

- Reorient or relocate the receiving antenna
- Increase the separation between the devices
- Connect the equipment to an outlet other than the receiver's
- Consult a dealer or an experienced radio/TV technician for assistance

This device meets all the other requirements specified in Part 15E, Section 15.407 of the FCC Rules.

The following information applies if you use the product with RF function within the USA.

FCC Radiation Exposure Statement

- This device complies with FCC RF radiation exposure limits set forth for an uncontrolled environment.
- This transmitter must be at least 20 cm from the user and must not be co-located or operating in conjunction with any other antenna or transmitter.
- FCC regulations restrict the operation of this device to indoor use only.

CANADA

The following information applies if you use the product within Canada area

Innovation, Science and Economic Development Canada ICES statement

CAN ICES-003(B) / NMB-003(B)

Innovation, Science and Economic Development Canada RSS-GEN & RSS-247 statement

- This device contains licence-exempt transmitter(s)/receiver(s) that comply with Innovation, Science and Economic Development Canada's licence-exempt RSS(s). Operation is subject to the following two conditions: (1) This device may not cause interference; and (2) This device must accept any interference, including interference that may cause undesired operation of the device.
- This radio transmitter (2468C-EX5512T0) has been approved by Innovation, Science and Economic Development Canada to operate with the antenna types listed below, with the maximum permissible gain indicated. Antenna types not included in this list that have a gain greater than the maximum gain indicated for any type listed are strictly prohibited for use with this device.

Antenna information

MODEL NAME	TYPE	MANUFACTURER	GAIN	CONNECTOR
56-001-000240Z	Dipole	M.gear	2.6 dBi (2.4~2.4835 GHz)	ipex (MHF)
56-001-000241Z	Dipole	M.gear	3.3 dBi (2.4~2.4835 GHz)	ipex (MHF)
56-001-000247Z	Dipole	M.gear	3.1 dBi (2.4~2.4835 GHz)	ipex (MHF)
56-001-000242Z	Dipole	M.gear	3.2 dBi (2.4~2.4835 GHz)	ipex (MHF)
56-001-000243Z	Dipole	M.gear	4.0 dBi (5.15~5.895 GHz)	ipex (MHF)
56-001-000244Z	Dipole	M.gear	3.2 dBi (5.15~5.895 GHz)	ipex (MHF)
56-001-000245Z	Dipole	M.gear	4.2 dBi (5.15~5.895 GHz)	ipex (MHF)
56-001-000246Z	Dipole	M.gear	3.4 dBi (5.15~5.895 GHz)	ipex (MHF)

- For indoor use only.

If the product with 5G wireless function operating in 5150-5250 MHz and 5725-5850 MHz, the following attention must be paid,

- The device for operation in the band 5150-5250 MHz is only for indoor use to reduce the potential for harmful interference to co-channel mobile satellite systems.
- For devices with detachable antenna(s), the maximum antenna gain permitted for devices in the band 5725-5850 MHz shall be such that the equipment still complies with the e.i.r.p. limits as appropriate; and
- Where applicable, antenna type(s), antenna models(s), and the worst-case tilt angle(s) necessary to remain compliant with the e.i.r.p. elevation mask requirement set forth in Section 6.2.2.3 of RSS 247 shall be clearly indicated.
- If the product with 5G wireless function operating in 5250-5350 MHz and 5470-5725 MHz, the following attention must be paid.
- For devices with detachable antenna(s), the maximum antenna gain permitted for devices in the bands 5250-5350 MHz and 5470-5725 MHz shall be such that the equipment still complies with the e.i.r.p. limit
- L'émetteur/récepteur exempt de licence contenu dans le présent appareil est conforme aux CNR d'Innovation, Sciences et Développement économique Canada applicables aux appareils radio exempts de licence. L'exploitation est autorisée aux deux conditions suivantes : (1) L'appareil ne doit pas produire de brouillage; (2) L'appareil doit accepter tout brouillage radioélectrique subi, même si le brouillage est susceptible d'en compromettre le fonctionnement.
- Le présent émetteur radio (2468C-EX5512T0) a été approuvé par Innovation, Sciences et Développement économique Canada pour fonctionner avec les types d'antenne énumérés ci-dessous et ayant un gain admissible maximal. Les types d'antenne non inclus dans cette liste, et dont le gain est supérieur au gain maximal indiqué pour tout type figurant sur la liste, sont strictement interdits pour l'exploitation de l'émetteur.

Informations antenne

MODEL NAME	TYPE	MANUFACTURER	GAIN	CONNECTOR
56-001-000240Z	Dipole	M.gear	2.6 dBi (2.4~2.4835 GHz)	ipex (MHF)
56-001-000241Z	Dipole	M.gear	3.3 dBi (2.4~2.4835 GHz)	ipex (MHF)
56-001-000247Z	Dipole	M.gear	3.1 dBi (2.4~2.4835 GHz)	ipex (MHF)
56-001-000242Z	Dipole	M.gear	3.2 dBi (2.4~2.4835 GHz)	ipex (MHF)
56-001-000243Z	Dipole	M.gear	4.0 dBi (5.15~5.895 GHz)	ipex (MHF)
56-001-000244Z	Dipole	M.gear	3.2 dBi (5.15~5.895 GHz)	ipex (MHF)
56-001-000245Z	Dipole	M.gear	4.2 dBi (5.15~5.895 GHz)	ipex (MHF)
56-001-000246Z	Dipole	M.gear	3.4 dBi (5.15~5.895 GHz)	ipex (MHF)

- Pour une utilisation en intérieur uniquement.

Lorsque la fonction sans fil 5G fonctionnant en 5150-5250 MHz and 5725-5850 MHz est activée pour ce produit, il est nécessaire de porter une attention particulière aux choses suivantes

- Les dispositifs fonctionnant dans la bande de 5 150 à 5 250 MHz sont réservés uniquement pour une utilisation à l'intérieur afin de réduire les risques de brouillage préjudiciable aux systèmes de satellites mobiles utilisant les mêmes canaux;
- Pour les dispositifs munis d'antennes amovibles, le gain maximal d'antenne permis (pour les dispositifs utilisant la bande de 5 725 à 5 850 MHz) doit être conforme à la limite de la p.i.r.e. spécifiée, selon le cas;
- Lorsqu'il y a lieu, les types d'antennes (s'il y en a plusieurs), les numéros de modèle de l'antenne et les pires angles d'inclinaison nécessaires pour rester conforme à l'exigence de la p.i.r.e. applicable au masque d'élévation, énoncée à la section 6.2.2.3 du CNR-247, doivent être clairement indiqués.

Lorsque la fonction sans fil 5G fonctionnant en 5250-5350 MHz et 5470-5725 MHz est activée pour ce produit, il est nécessaire de porter une attention particulière aux choses suivantes

- Pour les dispositifs munis d'antennes amovibles, le gain maximal d'antenne permis pour les dispositifs utilisant les bandes de 5 250 à 5 350 MHz et de 5 470 à 5 725 MHz doit être conforme à la limite de la p.i.r.e.

Industry Canada radiation exposure statement

This equipment complies with ICSED radiation exposure limits set forth for an uncontrolled environment. This equipment should be installed and operated with a minimum distance of 29 cm between the radiator and your body.

Déclaration d'exposition aux radiations:

Cet équipement est conforme aux limites d'exposition aux rayonnements ICSED établies pour un environnement non contrôlé. Cet équipement doit être installé et utilisé avec un minimum de 29 cm de distance entre la source de rayonnement et votre corps.