

ZYXEL

C4000LZ

Dual-Band Wireless AX VDSL2 Gigabit Gateway

Version 1.1
Edition 1, 01/2020

DRAFT

Quick Start Guide

Default Login Details

LAN IP Address	http://192.168.0.1
User Name	admin
Password	Check the device label

Device Panels



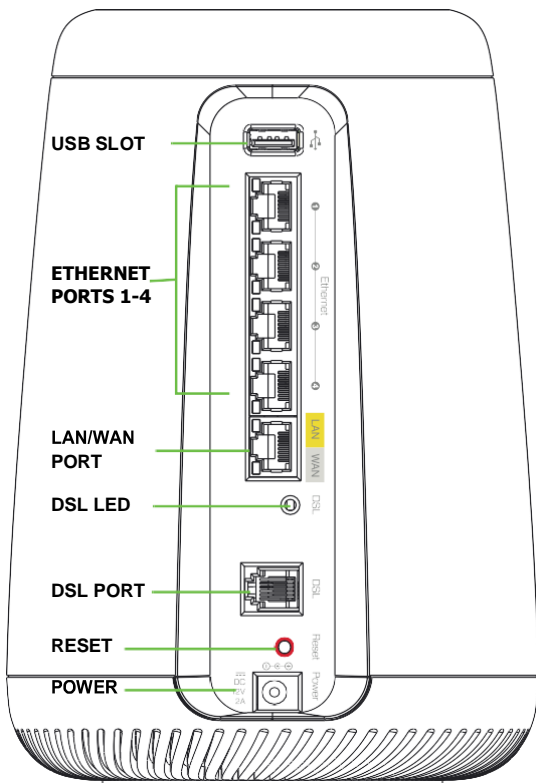

Overview

The Device is a Wi-Fi 802.11ax 4-port combo WAN VDSL gateway. The Device allows wired and wireless clients to safely access the Internet. Additionally, the Device includes a Gigabit Ethernet LAN port that can also serve as a WAN connection to support a dual WAN function. The USB port allows you to connect a USB memory stick or USB hard drive for storing or sharing files through the network.

Requirements

Make sure you have the following things before you start.

- Internet access - account information provided by your ISP, such as user name, password, and so on.
- A browser that supports HTML5, such as Internet Explorer 11, Mozilla Firefox, or Google Chrome.

Hardware Connections

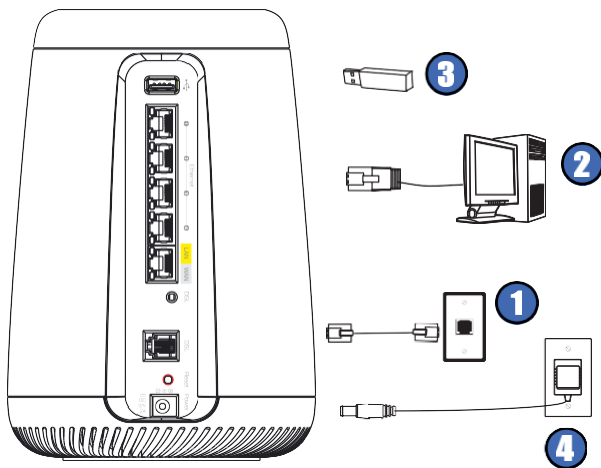

1. Use a telephone cable to connect your Device's **DSL** port to a telephone jack (or the DSL or modem jack on a splitter if you have one).
2. **ETHERNET:** Use an Ethernet cable to connect a computer to a LAN port for initial configuration and/or Internet access.
3. **USB:** You can connect a USB memory stick or a USB hard drive for file sharing. The Device automatically detects the USB device. Alternatively, use a USB cable (not provided) to connect a USB printer to this port.

4. **POWER**: Use the provided power adaptor to connect the **POWER** socket to an appropriate power source. Make sure the power at the outlet is on. Look at the LED lights on the front and rear panels.
 - The front LED light blinks while your Device starts up and is solid blue once it is ready.
 - The **DSL** light on the rear panel is solid green after your Device has a DSL connection.
 - Each **ETHERNET** light is on if the corresponding LAN port is properly connected and blinks when there is traffic.
 - The front LED light blinks white when WPS is enabled and blinks white/green while WPS is in process.

 *If the lights do not come on, check your connections and inspect your cables for damage. If the lights are still off, contact technical support.*

Internet Connection Setup

Your Device can automatically detect and configure your Internet connection once the hardware is connected properly.

Automatic Connection

1. Open your web browser to a website. Wait while your Device tries to detect your DSL connection to your ISP. This may take a few minutes.
2. After it detects the connection, the **DSL** light and front LED light are green on your Device and it is ready for you to use. If you have a PPPoE connection, you will have to enter the user name and password provided by your ISP.
3. Go to [Set Up a Wireless Network](#) if you wish to configure your wireless settings.

4. If the automatic connection is not successful, check your connections and restart the Device. Also, make sure you have entered the user name and password correctly. If you still cannot access the Internet, follow the steps in the next section to manually configure the Internet connection.

Manual Connection

You can also manually log into the Device's Web Configurator and configure the Internet connection.

1. In your browser, if the Device does not automatically re-direct you to the login screen, go to <http://192.168.0.1>.



2. Enter the default user name **admin** and password (see the Device's label). Click **Apply**.

1. Enter the administrator username and password below.

Administrator Username:

Administrator Password:

Show Password

The default administrator username and password can be found on the sticker located under the modem.

2. Click "Apply" to log in.

Apply

 *If the login screen does not open, make sure you allow web browser pop-up windows, JavaScripts and Java permissions. Your computer should be also set to get an IP address automatically from a DHCP server.*

3. The main screen appears. Click **Quick Setup** to configure the Device's Internet access.



4. Enter the user name and password provided by your ISP. Click **Apply** to finish the configuration.

1. Enter the PPP username and PPP password.

PPP Username:	<input type="text" value="connect@centurylink.com"/>	Custom Realm <input type="button" value="v"/>
PPP Password:	<input type="password" value="....."/>	
Confirm Password:	<input type="password" value="....."/>	
<input checked="" type="checkbox"/> Hide Password		

2. Click "Apply" to save your settings.

5. The **DSL** light and front LED light are green on your Device when the Internet is ready for you to use. If you still cannot access the Internet, contact your ISP.

Set Up a Wireless Network

You can set up a wireless network using the following methods:

Using Wireless Protected Setup (WPS)

Press the **WPS** button on the Device's front panel for more than 5 seconds to turn the WPS function on.

Follow these steps to add a WPS-enabled device to the wireless network using the **WPS** button.



- 1** Place the devices you want to connect near one another.
- 2** Press the WPS button on the Device.
- 3** Press the WPS button on a compatible device within 2 minutes of pressing the button on the Device.
The front LED light on the Device blinks white when connection is in progress and blinks white and green when connected.

Set Up a Wireless Network Manually

The wireless LAN on your Device is enabled by default. To add a wireless client to the network, use the settings found on the bottom panel of your Device.

Configure wireless devices that you want to connect to the wireless network to use the same wireless settings as the Device.

The default wireless settings vary for each Device. Refer to the label of your Device and use the provided information.

Federal Communications Commission (FCC):

This device complies with part 15 of the FCC Rules. Operation is subject to the following two conditions:

- (1) This device may not cause harmful interference, and
- (2) This device must accept any interference received, including interference that may cause undesired operation.

NOTE: This equipment has been tested and found to comply with the limits for a Class B digital device, pursuant to part 15 of the FCC Rules. These limits are designed to provide reasonable protection against harmful interference in a residential installation. This equipment generates, uses and can radiate radio frequency energy and, if not installed and used in accordance with the instructions, may cause harmful interference to radio communications. However, there is no guarantee that interference will not occur in a particular installation. If this equipment does cause harmful interference to radio or television reception, which can be determined by turning the equipment off and on, the user is encouraged to try to correct the interference by one or more of the following measures:

- Reorient or relocate the receiving antenna.
- Increase the separation between the equipment and receiver.
- Connect the equipment into an outlet on a circuit different from that to which the receiver is connected.
- Consult the dealer or an experienced radio/TV technician for help.

Caution

Changes or modifications not expressly approved by the party responsible for compliance could void the user's authority to operate the equipment.

For product available in the USA/Canada market, only channel 1~11 can be operated. Selection of other channels is not possible.

This device and its antenna(s) must not be co-located or operating in conjunction with any other antenna or transmitter except in accordance with FCC multi-transmitter product procedures.

IMPORTANT NOTE:

Radiation Exposure Statement:

This equipment complies with FCC RF radiation exposure limits set forth for an uncontrolled environment. This equipment should be installed and operated with minimum distance 25 cm between the radiator and your body.

Operation of this device is restricted to indoor use only.

FCC REQUIREMENTS:

This equipment complies with TIA-968-B of FCC Rules. On the bass unit of this equipment is a label that contains, among other information, the FCC Registration Number and Ringer Equivalence Number (REN) for this equipment. IF REQUESTED, THIS INFORMATION MUST BE GIVEN TO THE TELEPHONE COMPANY.

The REN is useful to determine the quantity of devices you may connect to your telephone line and still have all of those devices ring when your telephone number is called. In most, but not all areas, the sum of the REN of all devices connected to one line should not exceed five (5.0). To be certain of the number of devices you may connect to you line, as determined by the REN, you should contact your local telephone company to determine the maximum REN for your calling area. If your equipment causes harm to the telephone network, the telephone company may discontinue your service temporarily. If possible, they will notify you in advance. But if advance notice is not practical, you will be notified as soon as possible. You will be informed of your right to file a complaint with the FCC. Your telephone company may make changes in it is facilities, equipment, operations or procedures that could affect the proper functioning of your equipment. If they do, you will be notified in advance to give you an opportunity to maintain uninterrupted telephone service.

A Plug and jack used to connect this equipment to the premises wiring and telephone network must comply with the applicable FCC Part 68 rules and requirements adopted by the ACTA. A compliant telephone cord and modular plug is provided with this product. It is designed to be connected to a compatible modular jack that is also compliant. See installation instructions for details.

The telephone company may make changes in its facilities, equipment, operations or procedures that could affect the operation of the equipment. If this happens, the telephone company will provide advance notice in order for you to make necessary modifications to maintain uninterrupted service.

This equipment could be repair by users, there is not any component can be removed or changed.

Connection to party line service is subject to state tariffs. Contact the state public utility commission, public service commission or corporation commission for information.

If you experience trouble with this telephone equipment, please contact the following address and phone number for information on obtaining service or repairs.

The telephone company may ask that you disconnect this equipment from the network until the problem has been corrected or until you are sure that the equipment is not malfunctioning.

This equipment may not be used on coin service provided by the telephone company. Connection to party lines is subject to state tariffs.

COMPANY: ZYXEL Communications Inc.
ADDRESS: 1130 N. Miller St., Anaheim CA, 92806 USA
TEL NO.: 714-6320882

Safety Warnings

- Do NOT expose your device to dampness, dust or corrosive liquids.
- Do NOT store things on the device.
- Do NOT install, use, or service this device during a thunderstorm. There is a remote risk of electric shock from lightning.
- Connect ONLY suitable accessories to the device.
- Do NOT open the device or unit. Opening or removing covers can expose you to dangerous high voltage points or other risks. ONLY qualified service personnel should service or disassemble this device. Please contact your vendor for further information.
- Make sure to connect the cables to the correct ports.
- Place connecting cables carefully so that no one will step on them or stumble over them.
- Always disconnect all cables from this device before servicing or disassembling.
- Use ONLY an appropriate power adaptor or cord for your device.
- Connect the power adaptor or cord to the right supply voltage (for example, 110V AC in North America or 230V AC in Europe).
- Do NOT allow anything to rest on the power adaptor or cord and do NOT place the product where anyone can walk on the power adaptor or cord.
- Do NOT use the device if the power adaptor or cord is damaged as it might cause electrocution.
- If the power adaptor or cord is damaged, remove it from the device and the power source.
- Do NOT attempt to repair the power adaptor or cord. Contact your local vendor to order a new one.
- Do not use the device outside, and make sure all the connections are indoors. There is a remote risk of electric shock from lightning.
- Do NOT obstruct the device ventilation slots, as insufficient airflow may harm your device.
- Antenna Warning! This device meets ETSI and FCC certification requirements when using the included antenna(s). Only use the included antenna(s).

Your product is marked with this symbol, which is known as the WEEE mark. WEEE stands for Waste Electronics and Electrical Equipment. It means that used electrical and electronic products should not be mixed with general waste. Used electrical and electronic equipment should be treated separately.



IMPORTANT SAFETY INSTRUCTIONS

- Caution! The RJ-45 jacks are not used for telephone line connection.
- Caution! To reduce the risk of fire, use only No. 26 AWG or larger (e.g., 24 AWG) UL Listed or CSA Certified Telecommunication Line Cord.
- Caution! Do not use this product near water, for example a wet basement or near a swimming pool.
- Caution! Avoid using this product (other than a cordless type) during an electrical storm. There may be a remote risk of electric shock from lightning.
- Caution! Always disconnect all telephone lines from the wall outlet before servicing or disassembling this product.
- Attention: Les prises RJ-45 ne sont pas utilisés pour la connexion de la ligne téléphonique.
- Attention: Pour réduire les risques d'incendie n'utiliser que des câbles de type 26 AWG ou des câbles de connexion plus épais.
- Attention: Ne pas utiliser ce produit près de l'eau, par exemple un sous-sol humide ou près d'une piscine.
- Attention: Évitez d'utiliser ce produit (autre qu'un type sans fil) pendant un orage. Il peut y avoir un risque de choc électrique de la foudre.
- Attention: Toujours débrancher toutes les lignes téléphoniques de la prise murale avant de réparer ou de démonter ce produit.

EU Importer: ZYXEL Communications A/S | Generatorvej 8D, 2730 Herlev, Denmark | <http://www.zyxel.com/dk/da/>

US Importer: ZYXEL Communications, Inc | 1130 North Miller Street Anaheim, CA 92806-2001 | <https://www.zyxel.com/us/en/>