

SMART DOOR/WINDOW SENSOR

EASY START GUIDE



Thank you for using Aztech KylaS product! Please keep this Easy Start Guide for future use. For support or help, visit kyla.aztech.com

PACKAGE CONTENTS

- Door/Window Sensor
- Double-sided Tape
- User Guide
- Warranty Card
- CR2032 Battery

PRODUCT DESCRIPTION

The Smart Door/Window Sensor can be installed on a door, window and any other open/close object. Working with Smart Zigbee Hub and Aztech KylaS App, it provides your home a security defense and creates scene with other devices.

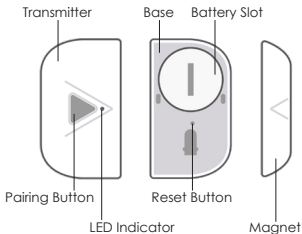

LED STATUS

Red LED Blinks Once per Second

Device is searching for network, or in pairing mode.

NOTE:

The battery standby time is approximately 8-12 months.

OPERATION GUIDE

Step 1:

Download Aztech Kyla App from Google Play/ App Store and follow the setup guide on the app.



Aztech KylaS App



Step 2:

Login to Aztech KylaS App, then add "Smart Door/Window Sensor" to device list to enable the device.

Step 3:

Open the battery slot cover by turning it counterclockwise and insert the battery. The device will start up immediately.

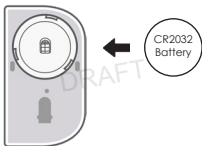

Step 4:

Install the transmitter on a door frame, the magnet on the door or window. The magnet should be installed closer to the right side of the transmitter.

Use double-sided tape to paste transmitter and magnet on the installation location.

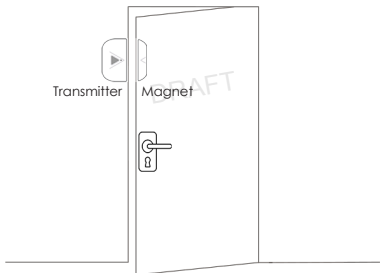

RESTORE DEFAULT SETTING

Press the Reset button. The Red LED turns off means the sensor is disconnected from the Hub. Follow the setup guide on the app to pair with the Hub.



TECHNICAL SPECIFICATIONS

Power Supply

3V DC

Battery Type

CR2032

Operating Temperature

-10~50°C

Operating Humidity

10%~90% RH

Sensor Type

Reed Switch

DRAFT

Connectivity

Zigbee

Material of Housing

PC and ABS, White

Communication Distance

10m to Hub (indoor)

Product Dimensions

W 42 x H 69.7 x D 13 (mm)

Aztech

FCC Statement

1. This device complies with Part 15 of the FCC Rules. Operation is subject to the following two conditions:

(1) This device may not cause harmful interference.

(2) This device must accept any interference received, including interference that may cause undesired operation.

2. Changes or modifications not expressly approved by the party responsible for compliance could void the user's authority to operate the equipment.

NOTE:

This equipment has been tested and found to comply with the limits for a Class B digital device, pursuant to Part 15 of the FCC Rules. These limits are designed to provide reasonable protection against harmful interference in a residential installation.

This equipment generates uses and can radiate radio frequency energy and, if not installed and used in accordance with the instructions, may cause harmful interference to radio communications. However, there is no guarantee that interference will not occur in a particular installation. If this equipment does cause harmful interference to radio or television reception, which can be determined by turning the equipment off and on, the user is encouraged to try to correct the interference by one or more of the following measures:

Reorient or relocate the receiving antenna.

Increase the separation between the equipment and receiver.

Connect the equipment into an outlet on a circuit different from that to which the receiver is connected.

Consult the dealer or an experienced radio/TV technician for help.