

Rhein Tech Laboratories
360 Herndon Parkway
Suite 1400
Herndon, VA 20170
<http://www.rheintech.com>

Client: Zebra Technologies Corp.
Model Name/#: ZBR-3/EYSF2CAXX
FCC ID: I28MD-BTC2TY2
FCC: 15.247
IC: RSS-210

APPENDIX G: LABEL AND LABEL LOCATION

Please see the following pages for representative samples of the FCC and Industry Canada Identification Labels, and label locations, on some typical Zebra printers.

This drawing contains confidential and other data of a proprietary nature owned by Zebra Technologies Corporation. and may not be used or disclosed to others without the prior written consent of Zebra Technologies Corporation.

MATERIAL: 2 MIL [.05 mm] WHITE POLYESTER W/ 1 MIL [.025 mm] VELVET TEXTURED OVERLAMINATE. ADHESIVE BACKED. ADHESIVE TO BOND TO POLYCARBONATE/ABS (CYCOLOY®) SUBSTRATE. DIE IS IDENTICAL TO AA16403-Tab ARTWORK PER "A16711. eps" FILE SUPPLIED BY ZEBRA.
 -1 COLORS: BACKGROUND BLACK. TEXT & LOGOS AS INDICATED.
 COLORS: -2 thru -7: BACKGROUND COLOR TO MATCH G.E. COLOR GY1460, (SAMPLE CAN BE SUPPLIED BY ZEBRA.) TEXT & LOGO AS INDICATED.

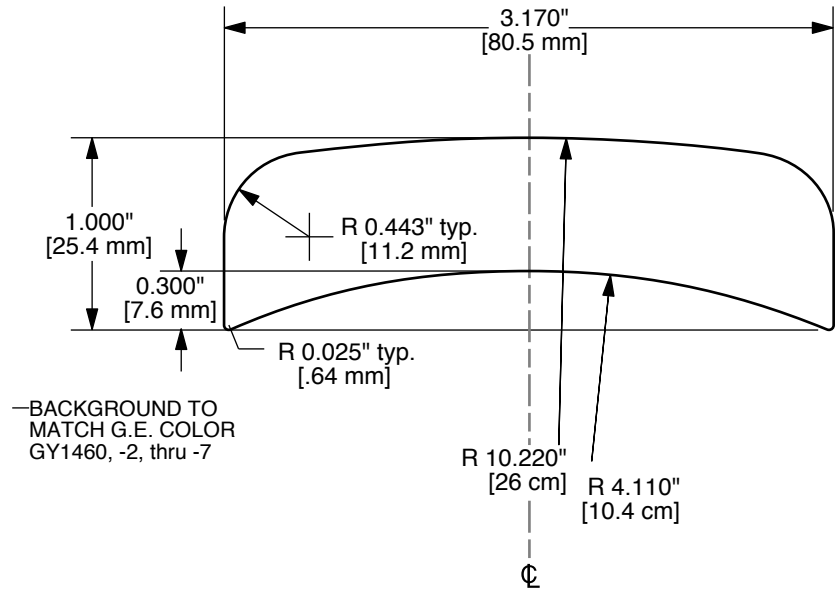

AA16711-9

J	ECO 20632	gf		12/15/03
H	ECO 20469	gf	AAR	10/20/03
G	ECO 20335	gf	AAR	9/24/03
F1	ECO 20225	gf	AAR	8/28/03
F	ECO 19931	gf	AAR	6/30/03
E	ECO 19332	gf	AAR	4/15/03
D	ECO 19586	gf	AAR	3/3/03
C	ECO 19427	gf	AAR	2/20/03
B	ECO 19286	gf	AAR	1/14/03
A	ECO 19191	gf	AAR	12/13/02
2	revised dash #s	gf		12/3/02
1	initial distribution	gf		11/19/02
Rev.	ECO #	Dwn	Appvd.	Date.



Zebra Technologies Corporation
 30 Plan Way Warwick, RI 02886.1012 U.S.A.
 Telephone +1.401.739.5800 Facsimile +1.401.732.0145
 www.zebra.com

Description: LABEL, PRODUCT I.D. QL SERIES
 Part Number: AA16711-tab File: A16711JT.pdf

Rev. J

INSTALL LABELS



The following operations should be performed at a grounded workstation, and the operator must wear an ESD strap.

Product I.D. Label
p/n AA16403-tab
refer to table

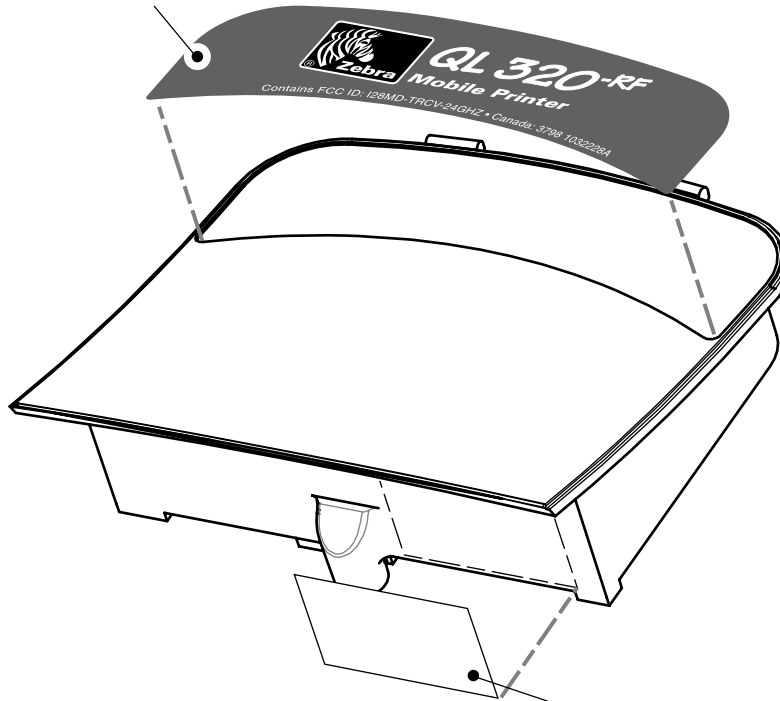

S/N Label
p/n AC16328-tab
refer to table

Perform this step for all assemblies

Apply Product ID Label

Peel adhesive backing off the **Product ID Label** (p/n per table) and apply to the recess on the top of the Module housing.

Apply Serial Number Label

Print the **Serial Number Label** called out in the table. (Refer to drawing AC16328-tab)

Assembly#	I.D. Label	S/N Label
CC16225-1	AA16403-6	AC16328-1
CC16226-1	AA16403-5	AC16328-2
CC16227-1	AA16403-4	AC16328-3
CC16232-1	AA16403-8	AC16328-4

Apply the Serial Number Label approximately where shown on the Module Housing.

This completes the QL Series Wireless Module assembly. Completed assemblies should be stored in static proof bags or containers and handled only by personnel at a properly grounded work station.

This drawing contains confidential and other data of a proprietary nature owned by Zebra Technologies Corporation, and may not be used or disclosed to others without the prior written consent of Zebra Technologies Corporation.

LD-D5ZF5N

LD-D8UG7B

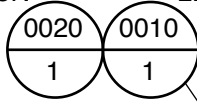

Typical all dash numbers

Rev. level per M.O.

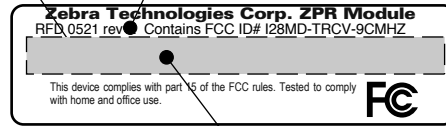

Actual size

Print bar-coded serial number here all dash numbers

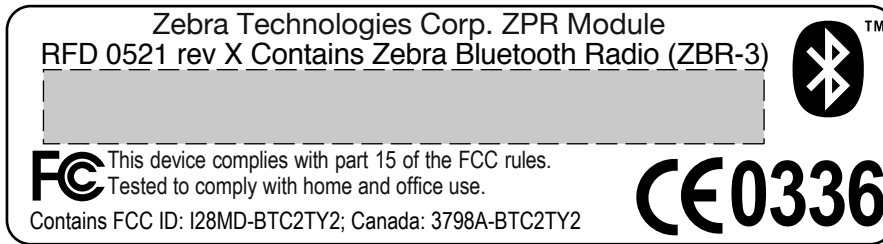

AC15841-4
Bluetooth (ZBR-2)
Scale: 2x

PRELIMINARY

H	PER ECO	gf		
G	PER ECO 18914	gf		9/27/02
F	PER ECO 18667	gf	AAR	7/19/02
E	PER ECO 17951	gf	AAR	1/25/02
D	PER ECO 17840	gf	AAR	1/03/02
C	PER ECO 17368	gf	AAR	7/31/01
B	PER ECO 17105	gf	AAR	4/20/01
A	PER ECO 16781	gf	AAR	1/18/01
1		gf		1/9/01
Rev.	ECO #	dwn	app	Date



Zebra Technologies Corporation
30 Plan Way Warwick, RI 02886.1012 U.S.A.
Telephone +1.401.739.5800 Facsimile +1.401.732.0145
www.zebra.com

Description: Label, S/N, Symbol Pod
Part Number: AC15841-tab

File: C15841HT.pdf

Rev H

ZPR MODULE - FINAL ASSEMBLY

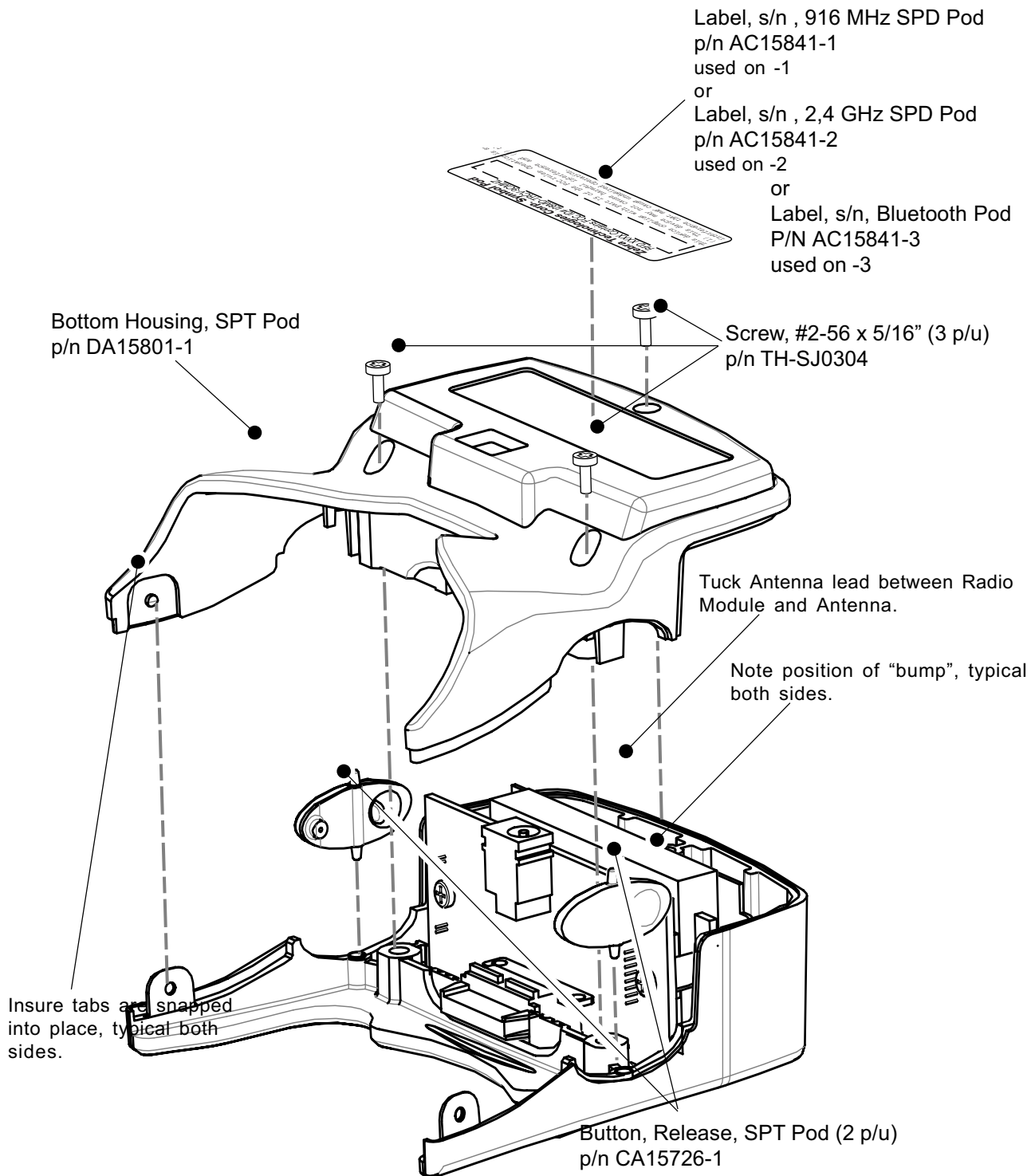

Use ESD Wrist Strap at a properly grounded workstation for all operations.