

**Zebra® ZXP Series 8™
Card Printer
with Laminator**

User's Manual

Draft - July 1, 2009



Copyright Notice

© 2009 ZIH Corp.

This document contains information proprietary to Zebra Technologies Corporation. This document and the information contained within is Copyrighted by Zebra Technologies Corporation and may not be duplicated in full or in part by any person without written approval from Zebra.

While every effort has been made to keep the information contained within current and accurate as of the date of publication, no guarantee is given that the document is error-free or that it is accurate with regard to any specification. Zebra Technologies Corporation reserves the right to make changes, for the purpose of product improvement, at any time.

Trademarks

ZXP Series 8 is a trademark and Zebra is a registered trademark of Zebra Technologies Corporation. Windows is a registered trademark of Microsoft Corporation in the United States and other countries. All other trademarks or registered trademarks are marks of their respective holders.

Product Disposal



Product Disposal Information • Do not dispose of this product in unsorted municipal waste. This product is recyclable, and should be recycled according to your local standards. For more information, please see our web site at:
<http://www.zebra.com/environment>

Contents



1 • Introduction	1
Printer Features	2
Controls, Connectors, and Indicators	3
Icons	4
Zebra Supplies	4
2 • Installation and Setup	5
General Information	5
Unpacking the Printer	6
Installing the Card Hoppers	8
Loading Cards	9
Opening the Printer Door	10
Installing the Cleaning Cartridge	11
Installing the Cleaning Roller	12
Loading the Transfer Film	13
Loading a Print Ribbon	15
Loading the Laminate	17
Connecting Power	23
Connecting the Printer to your Computer	24
Installing the Windows Printer Driver	26
3 • Operation	37
Introduction	37
Card Type Selection	38
Printing a Sample Card	39
Manual Card Feed	40
Operator Control Panel (OCP)	42
Ethernet Indicators -- Detail	49

4 • Printer Settings and Adjustments	51
Introduction	51
Properties	52
Printing Preferences	59
5 • ZXP Series Toolbox	65
Introduction	65
ZXP Series Toolbox Access	66
Printer Configuration	67
Print Test Card	76
Technology	77
Advanced Security	79
Print Viewer	82
6 • Cleaning	83
Cleaning the Printer	83
Cleaning the Printhead	87
Card Cleaning Cartridge	88
Cleaning Roller	88
7 • Troubleshooting	89
OCP Error Messages	90
OCP Test Card Images	93
Test Card Descriptions	94
Ethernet Issues	95
8 • Technical Specifications	97
Standard Features	97
Specifications	98
Declarations of Conformity	101
Appendix A • Printer Configurations	103
Appendix B • Connecting to a Network	105
Appendix C • Magnetic Card Encoder	107
Appendix D • Smart Card Options	111
Appendix E • Packing the Printer for Shipment	117
Appendix F • Worldwide Support	119



Introduction

This manual contains installation and operation information for the Zebra ZXP Series 8 Card Printer manufactured by Zebra Technologies Corporation.

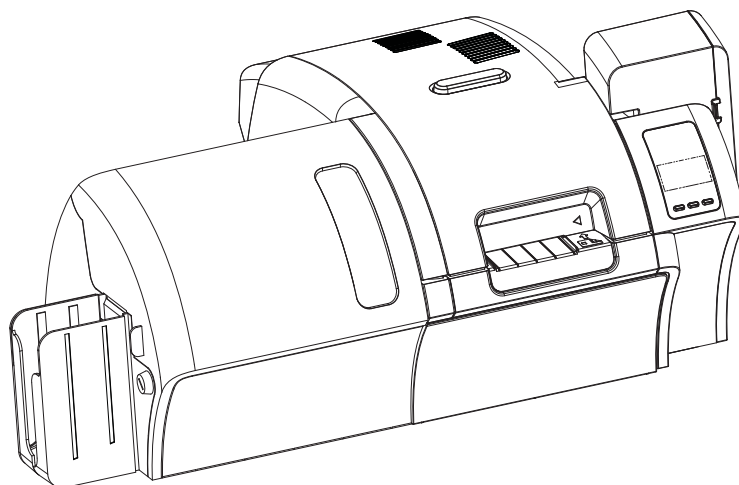

The Zebra ZXP Series 8 card printers use reverse transfer printing technology to create photo-quality and over-the-edge images on plastic identification cards. Zebra's reverse transfer printers provide fast throughput and a range of encoding options for a variety of markets and applications.

The difference between the Z83 and the Z84 is that the Z83 has a single-sided laminator (i.e., it lays down and seals a laminating film on the top surface of the printed card), while the Z84 has a dual-sided laminator (i.e., it lays down and seals laminating film on both surfaces of the printed card).

References in this document that refer to either or both of the models will be in the form of "the printer" or "the Z83/Z84 Printer"; references that are specific to one or the other will be in the form of "the Z83 Printer" or "the Z84 Printer."

Components

Printer

The following figure shows components of the Printer.

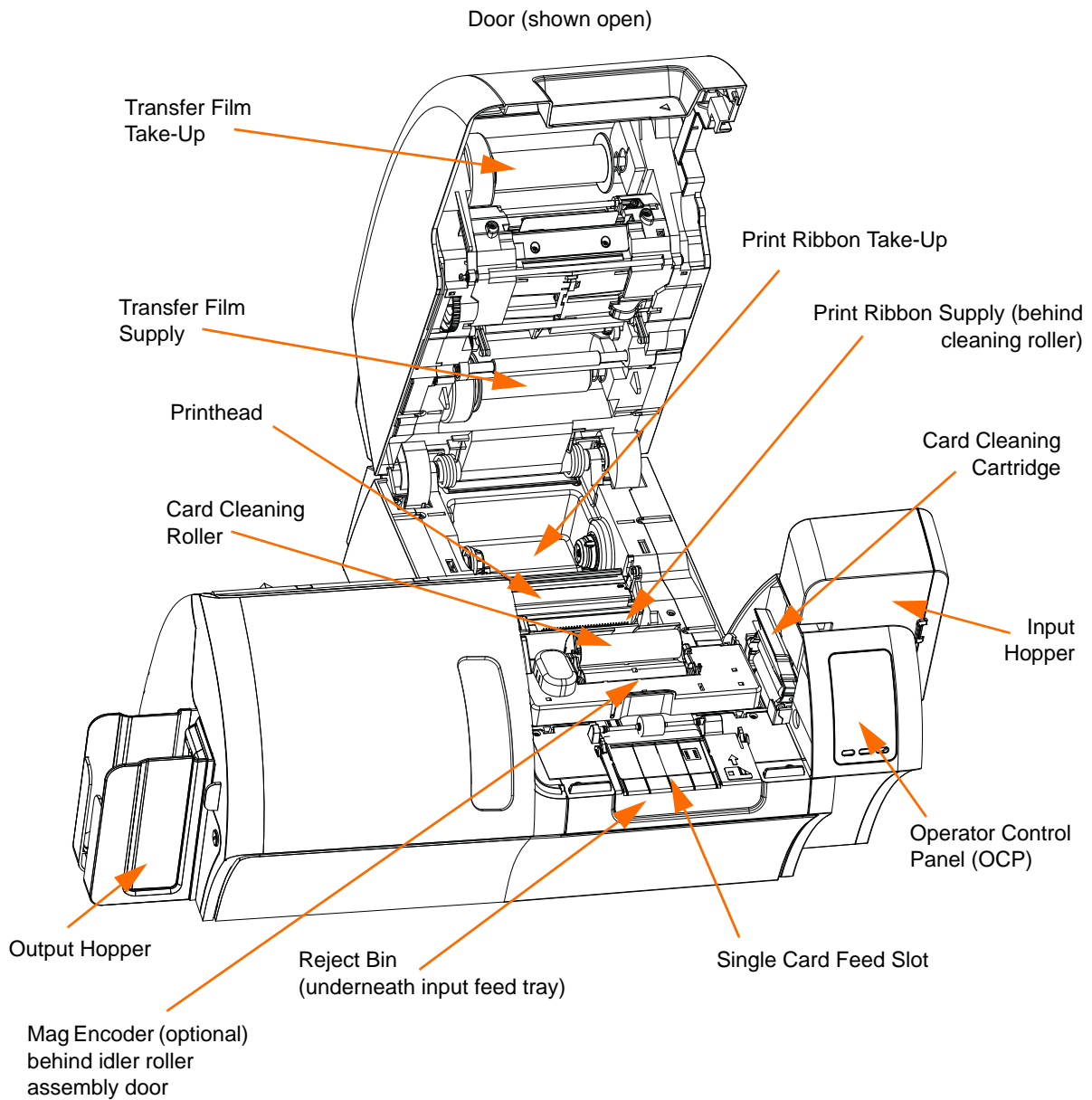

Laminator

The following figure shows components of the Laminator.

Door (shown open)

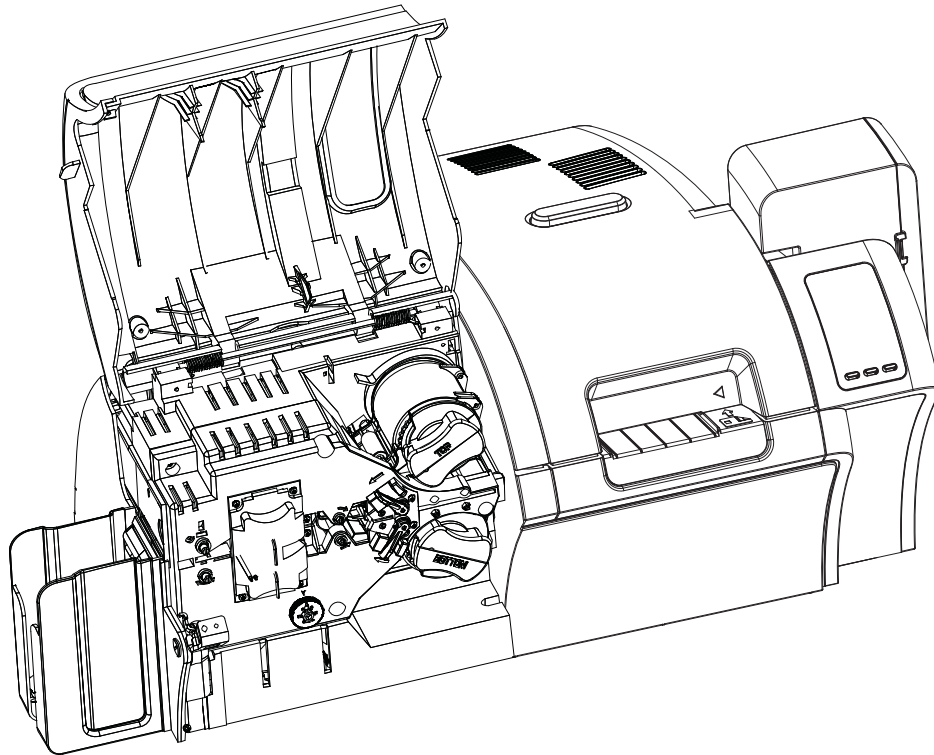

Controls, Connectors, and Indicators

Your printer has an LCD Display Panel and three Panel Buttons on the front and a power connector, power switch, and interface connector(s) on the rear panel.

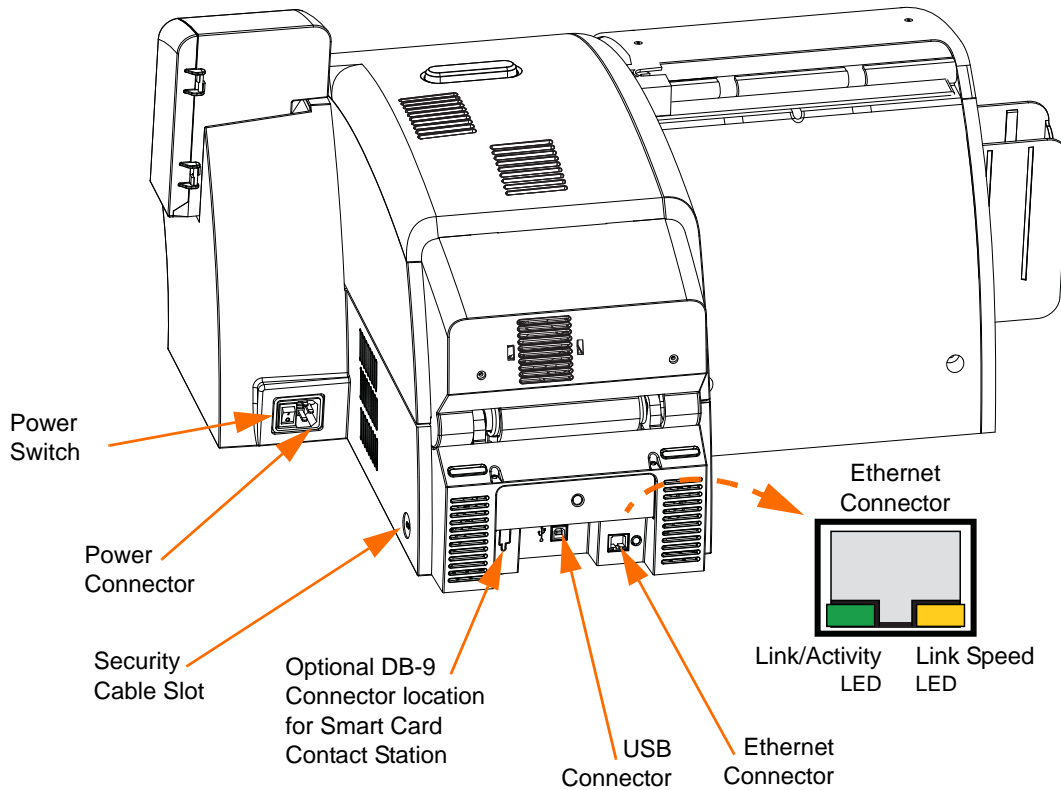
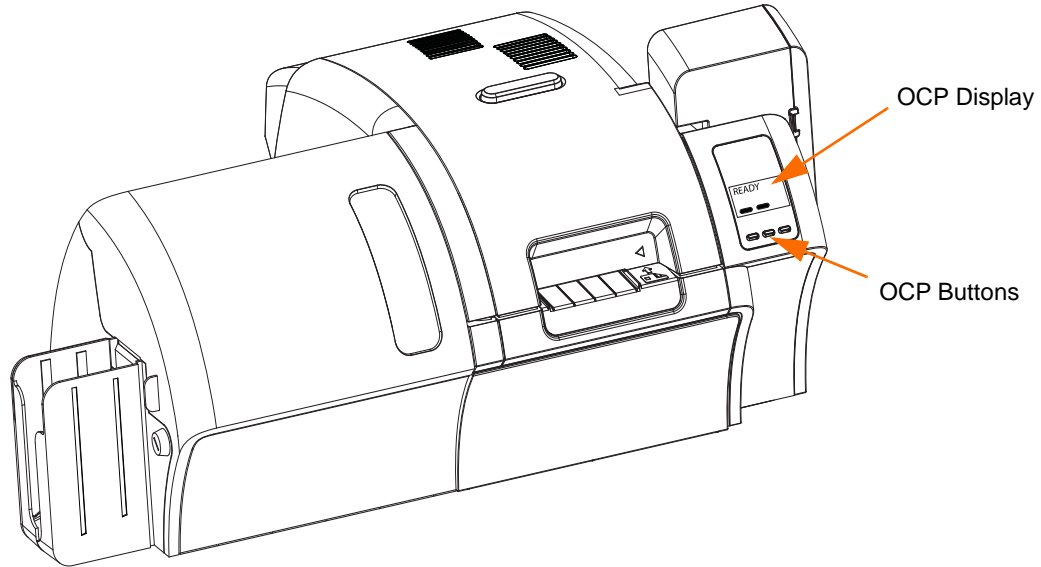

Icons

Throughout this manual, different icons highlight important information, as follows:



Note • Indicates information that emphasizes or supplements important points of the main text.



Important • Advises you of information that is essential to complete a task, or points out the importance of specific information in the text.



Provides an example or scenario to demonstrate or clarify a section of text.



Electrostatic Discharge Caution • Warns you of the potential for electrostatic discharge.



Electric Shock Caution • Warns you of a potential electric shock situation.



Hot Surface • Warns you of a situation where excessive heat could cause a burn.



Caution • Advises you that failure to take or avoid a specific action could result in physical harm to you, or could result in physical damage to the hardware.

Zebra Supplies

Genuine Zebra supplies meet stringent quality standards and are recommended for optimal printing quality and proper printer performance. The ZXP Series 8 printer is designed to work only with Zebra True Colours® i Series™ Ribbons and True Colours™ i Series™ Transfer Film.

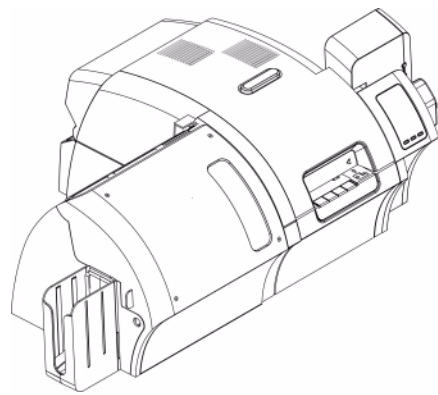



Installation and Setup

General Information

This section will guide you through the installation and setup of your Card Printer. This consists of the following procedures, which should be performed in the order presented.

- Unpacking the Printer..... 6
- Installing the Card Hoppers 8
- Loading Cards 9
- Opening the Printer Door..... 10
- Installing the Cleaning Cartridge..... 11
- Installing the Cleaning Roller 12
- Loading the Transfer Film 13
- Loading a Print Ribbon 15
- Connecting Power 27
- Connecting the Printer to your Computer 28
- Installing the Windows Printer Driver 30

The procedure to be followed for Packing the Printer for Shipment is given at the end of this section.

Unpacking the Printer

- Step 1.** Inspect the shipping container to ensure that no damage has occurred during shipment. If any damage is apparent, file a claim with the shipper.
- Step 2.** Open the shipping container.
- Step 3.** Remove the packing material and accessories from around the top of the Printer.



Important • Save all the packing material and the shipping carton in case the Printer needs to be moved or shipped. If the original material is lost or damaged, a replacement Shipping Kit can be ordered from Zebra.

- Step 4.** Make sure the following items are included with your Printer:

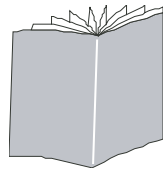

Quick Start Guide

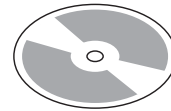

CD-ROM with InstallWizard

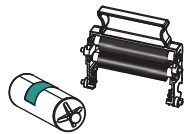

Cleaning Cartridge



Cleaning Roller

USB



USB Cable

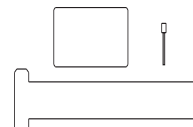

Cleaning Kit



Power Cable

If any items are missing, please contact your dealer. To reorder, please refer to [Appendix F](#) of this manual.



Caution • The Printer weighs approximately 27.5 lbs (12.5 kg).

Step 5. Lift the Printer out of the carton by holding it with both hands.

Step 6. Place the Printer in a location that meets the following requirements:

- A reasonably dust- and dirt-free environment.
- Flat surface at least 27 in (686 mm) x 28 in (711 mm) that can support the weight of the Printer; additional space preferred. Allow a 4-inch clearance, minimum, on all sides.
- Vertical clearance at least 32 in (813 mm).
- Temperature within the range of 59° to 95°F (15° to 35°C).
- Relative Humidity 20 to 80% inclusive, non-condensing.
- AC power accessible.

Step 7. Remove the protective plastic bag from the Printer.

Installing the Card Hoppers

Input Hopper

The Input Hopper is positioned on the right side of the Printer and holds the cards to be printed.

Step 1. Install the Input Hopper by sliding the hopper into the receptacle on the right side of the Printer.

Step 2. Ensure that the Input Hopper locks securely in place.

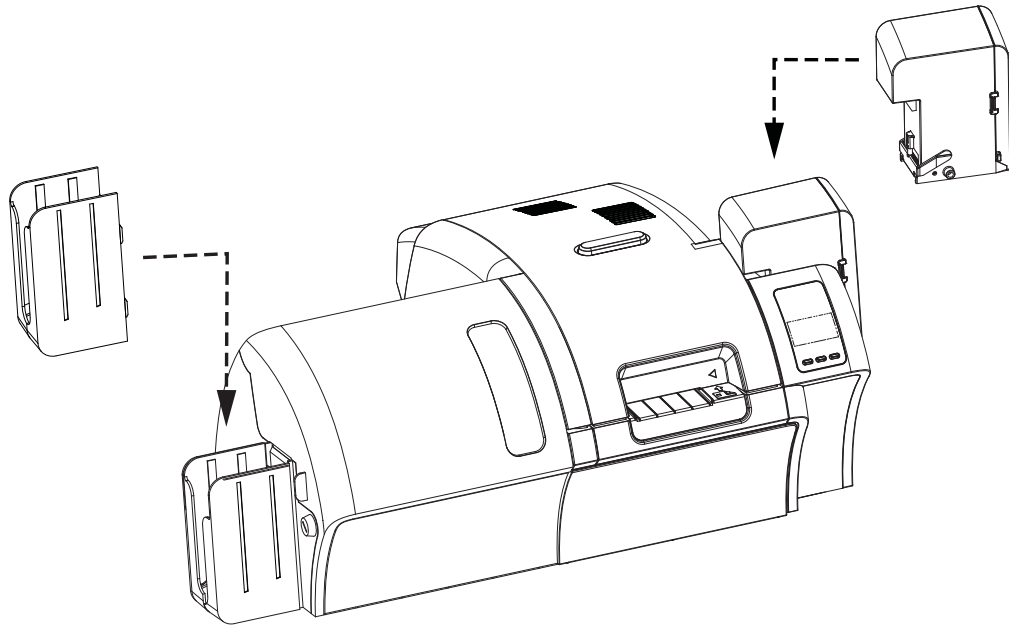

Output Hopper

The Output Hopper is positioned on the left side of the Printer and receives the printed cards.

Step 1. Install the Output Hopper by inserting the four tabs on the right side of the hopper into the four slots on the left side of the Printer.

Step 2. Ensure that the Output Hopper locks securely in place.

Loading Cards

Step 1. Open the Input Hopper Door.

Step 2. Remove the wrapping from the card deck.

Step 3. Holding the card deck by the sides, hold it vertically against a flat surface such as a desktop. If the deck is too thick for your hand to hold it comfortably, use about half a deck at a time.

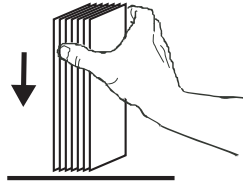

Step 4. Push the stack back and forth to an angle of about 45° from vertical, so as to separate all of the cards.

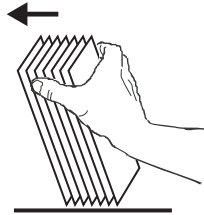

Note • Static charges and edge burrs from the card die-cutting process can render individual cards stuck together with significant adhesion force. These cards *must be* physically separated from each other before inserting into the feeder; if not separated, feeding or printing problems may occur.

Step 5. Restore the card stack to its original squared-off condition.

Step 6. Place the cards in the Input Hopper in the correct orientation as shown. Ensure that the cards are seated flat on the bottom of the hopper.

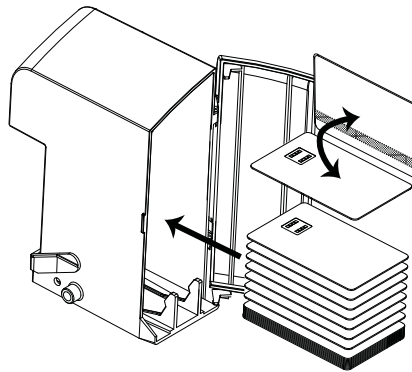

Step 7. Close the Input Hopper Door.

Opening the Printer Door

Step 1. Press the Door Release button on the top of the Printer.

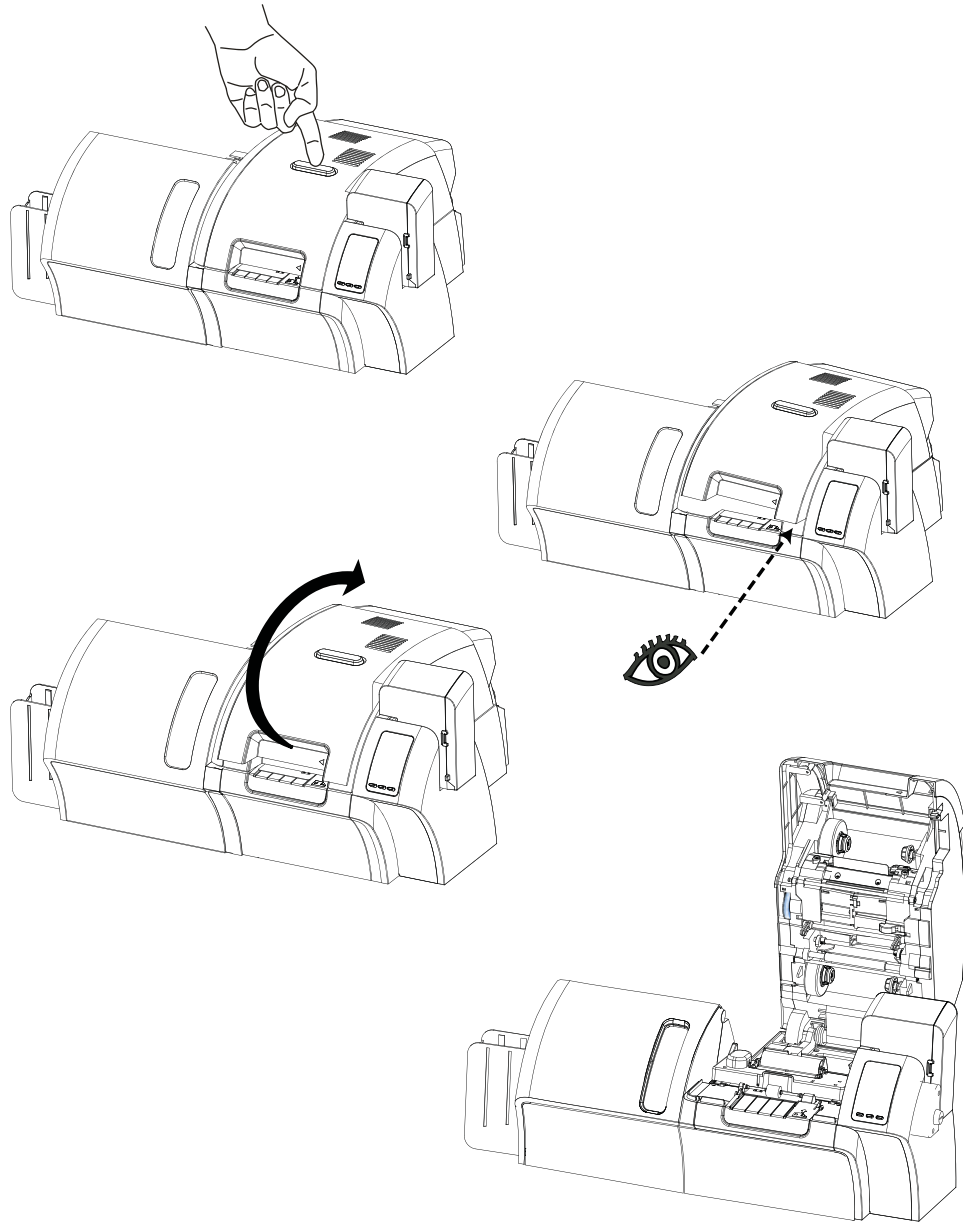

Step 2. Observe that the Door releases and pops up approximately half an inch.

Step 3. Grasp the Door at the bottom front.

Step 4. Lift the Door to its upright position. It will remain in that position.

Installing the Cleaning Cartridge

The Cleaning Cartridge cleans the cards entering the Printer from the Input Hopper. The Cleaning Cartridge consists of a Cartridge Frame and an Adhesive Roller, which are packed together.

- Step 1.** Remove the Cartridge Frame and the Adhesive Roller from their packaging.
- Step 2.** Insert the Adhesive Roller into the Cartridge Frame. To avoid contamination, always hold the frame and the roller by the ends.
- Step 3.** Peel the protective wrapper from the Adhesive Roller.
- Step 4.** Open the Printer Door by pressing the Door Release button on the top of the Printer.
- Step 5.** Locate the area where the Cleaning Cartridge will be installed (adjacent to the Input Hopper); circled below.

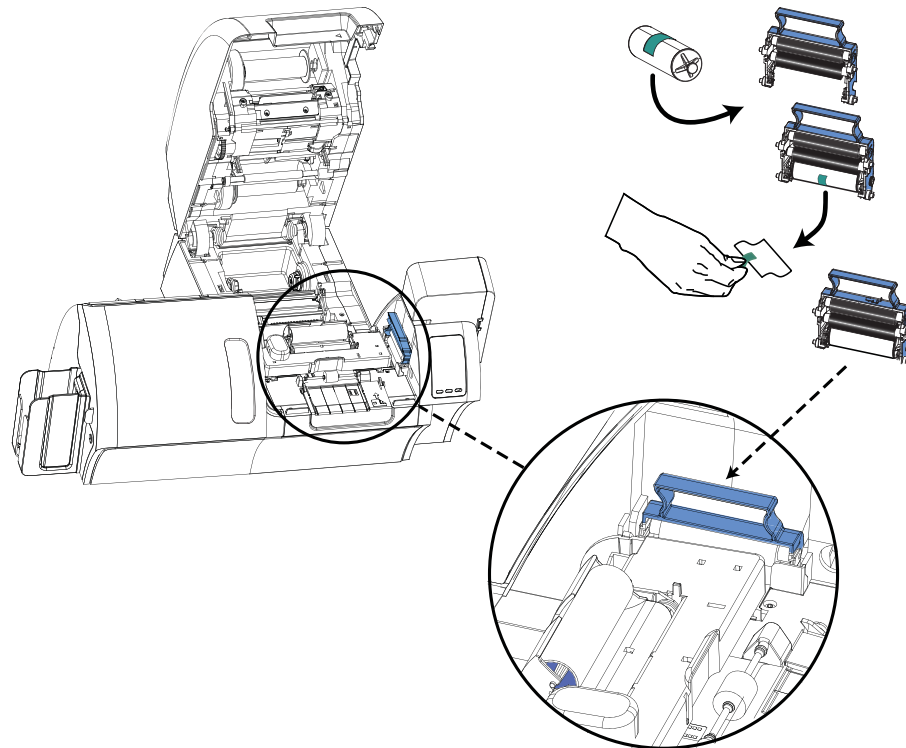

- Step 6.** Hold the Cleaning Cartridge by the extended handle.
- Step 7.** With the cartridge at about a 30° angle (pointing downward), insert the lip of the cartridge into the slot, until the cartridge seats against the back wall.
- Step 8.** Press the front of the cartridge down until it seats all the way down and latches with an audible click.
- Step 9.** Close the Printer's Door.

Installing the Cleaning Roller

The Cleaning Roller cleans the cards entering the Printer from either the Input Hopper or the Single-Feed Input.

- Step 1.** Remove the Cleaning Roller from its packaging. To avoid contamination, always hold the roller by the ends.
- Step 2.** Peel the protective wrapper from the Cleaning Roller.
- Step 3.** Open the Printer Door by pressing the Door Release button on the top of the Printer.
- Step 4.** Locate the area where the Cleaning Roller will be installed; circled below.

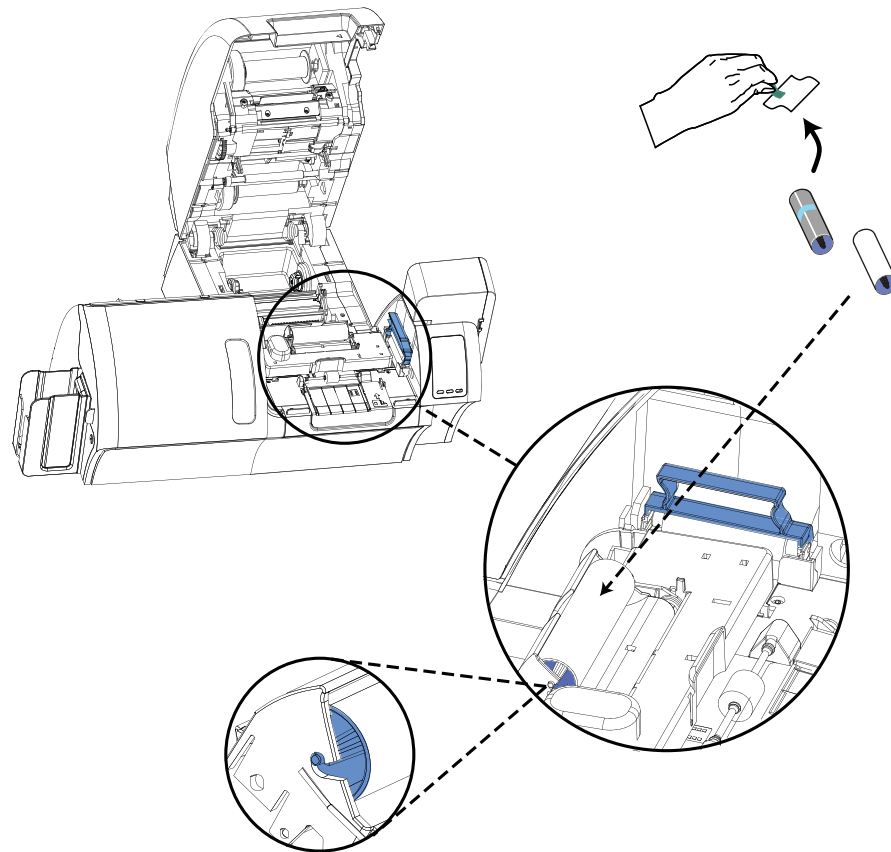

- Step 5.** Hold the Cleaning Roller by the ends.
- Step 6.** Position the ends of the Cleaning Roller in the slots. Push down until the roller fully seats and latches.
- Step 7.** Close the Printer's Door.

Loading the Transfer Film

The ZXP Series 8 printer is designed to work only with Zebra True Colours™ i Series™ Transfer Film for near photographic print resolution and over-the-edge printing.

Step 1. Locate the transfer film supply spindles and the transfer film take-up spindles.

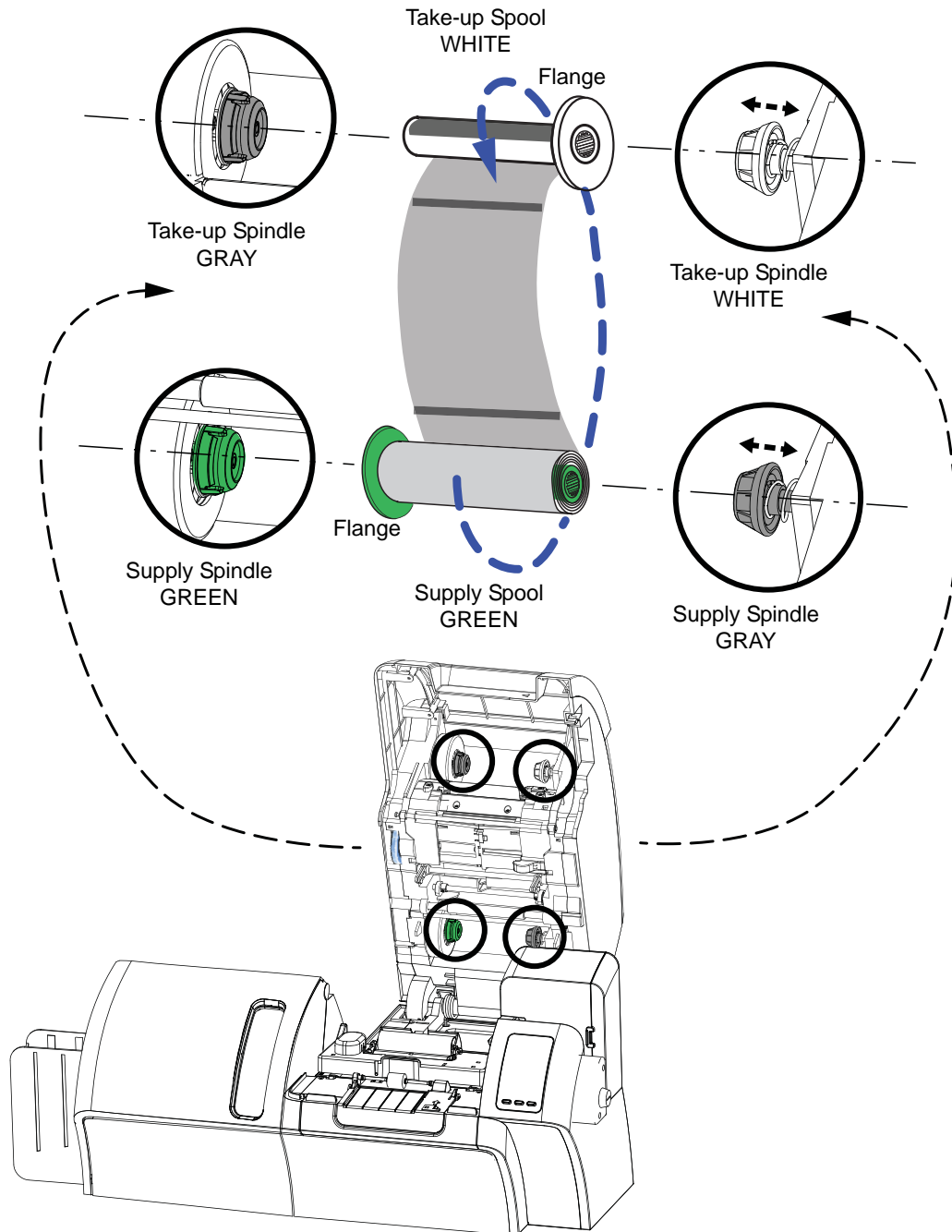

Step 2. Unroll about one foot from the full roll of transfer film (supply spool), and wind it (2 wraps) onto the empty take-up spool.