

Lenovo Precision Pen

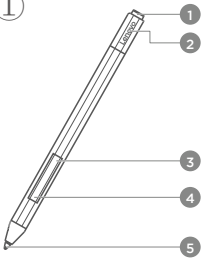

Lenovo[™]

①



②

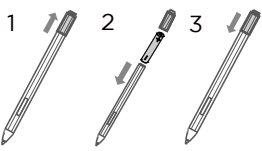

③

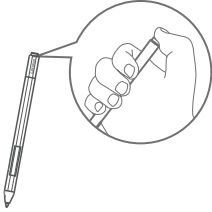

④



Quick Start Guide

With 4096 levels pressure and the hover function, you can use Lenovo Precision Pen as your fingers for more great experiences.

① Overview

- 1 Bluetooth button
- 2 Indicator LED
- 3 Upper side button
- 4 Lower side button
- 5 Tip

② Installing a battery

1. Remove the cap in the direction shown in the figure.
2. Place an AAAA alkaline battery into the body of the pen with the negative end down.
3. Put the cap back on the pen. Make sure the flat surface of the pen body is aligned with the flat surface of the cap.

Note: AAAA alkaline batteries may only be available in some countries and regions.

③ Pairing a pen

1. Enable Bluetooth pairing on your Yoga Book C930 to discover and pair the pen.
2. Press and hold the Bluetooth button on the pen for at least 3 seconds until the LED indicator blinks white.
3. On your device, select Lenovo Precision Pen and start pairing.
4. After pairing, press the Bluetooth button on the pen to access more functions. To access other functions, double press the Bluetooth button.

④ Using the magnetic pen holder

The Lenovo Precision Pen has a magnet allowing it to attach to the specific area of your device, making the pen very portable.

With the tip of the pen pointed toward the hinge, align the body of the pen with the right/left edge of the device cover.

How to obtain Warranty Service

If the product does not function well, you may obtain warranty service by contacting your Lenovo dealer where it was purchased.

快速入门指南

触控笔可以代替手指方便地进行操作，也拥有 4096 级压感、悬浮触控等功能，给您带来更多精彩体验。

① 触控笔外观

- 1 蓝牙按键
- 2 LED 指示灯
- 3 侧上键
- 4 侧下键
- 5 笔尖

② 安装电池

1. 按照如图所示的方向取下笔帽。
2. 将电池（型号：AAAA 9 号电池）负极朝下，正极朝上装入笔内。
3. 装回笔帽。注意笔身平面区域与笔帽平面区域对齐。

注意：AAAA 9 号电池仅在部分国家和地区提供。

③ 触控笔配对

1. 启用 Yoga Book C930 的蓝牙配对功能，发现触控笔并进行配对。
2. 按住触控笔的蓝牙按键三秒以上，直至 LED 指示灯白色闪烁，启用蓝牙配对功能。
3. 在您的设备上选择“Lenovo Precision Pen”，并进行配对。
4. 完成配对后，请按一次或连接两次蓝牙按键以访问更多功能。

④ 触控笔收纳

触控笔笔身具有磁性，可以轻松吸附在您的设备的指定位置上，非常便于携带。

将触控笔笔尖朝前，笔身平面部分紧贴设备上盖左/右侧边沿。

服务支持信息

您可直接联系购买的经销商获取保修服务。



Lenovo and the Lenovo logo are trademarks of Lenovo in the United States, other countries, or both.

Other company, product, or service names may be trademarks or service marks of others.

LIMITED AND RESTRICTED RIGHTS NOTICE: If data or software is delivered pursuant a General Services Administration "GSA" contract, use, reproduction, or disclosure is subject to restrictions set forth in Contract No. GS-35F-05925.

V1.0_20180515



XXXXXPN