

田原 414
 2008/04/14 田原 414
 2008/04/14 田原 414
 2008/04/14 田原 414

| 版次 | 年 | 月 | 日 | 担当者 | 内容 |
|----|----|----|----|-----|------------------|
| A | 97 | 10 | 16 | 田原 | 5V電源/EMI/電圧変動の修正 |
| B | 98 | 02 | 25 | 田原 | 5V電源/EMI/電圧変動の修正 |
| C | 98 | 04 | 02 | 田原 | 5V電源/EMI/電圧変動の修正 |

名称: CI 0105-U
 仕様: A3K-210A404
 製造: 田原
 検査: 田原
 承認: 田原
 1/1

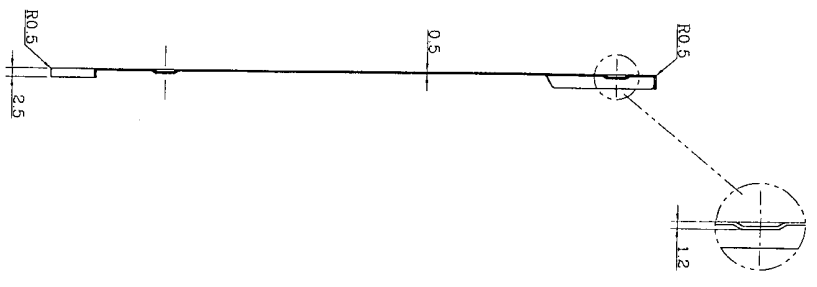
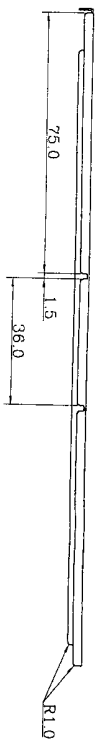
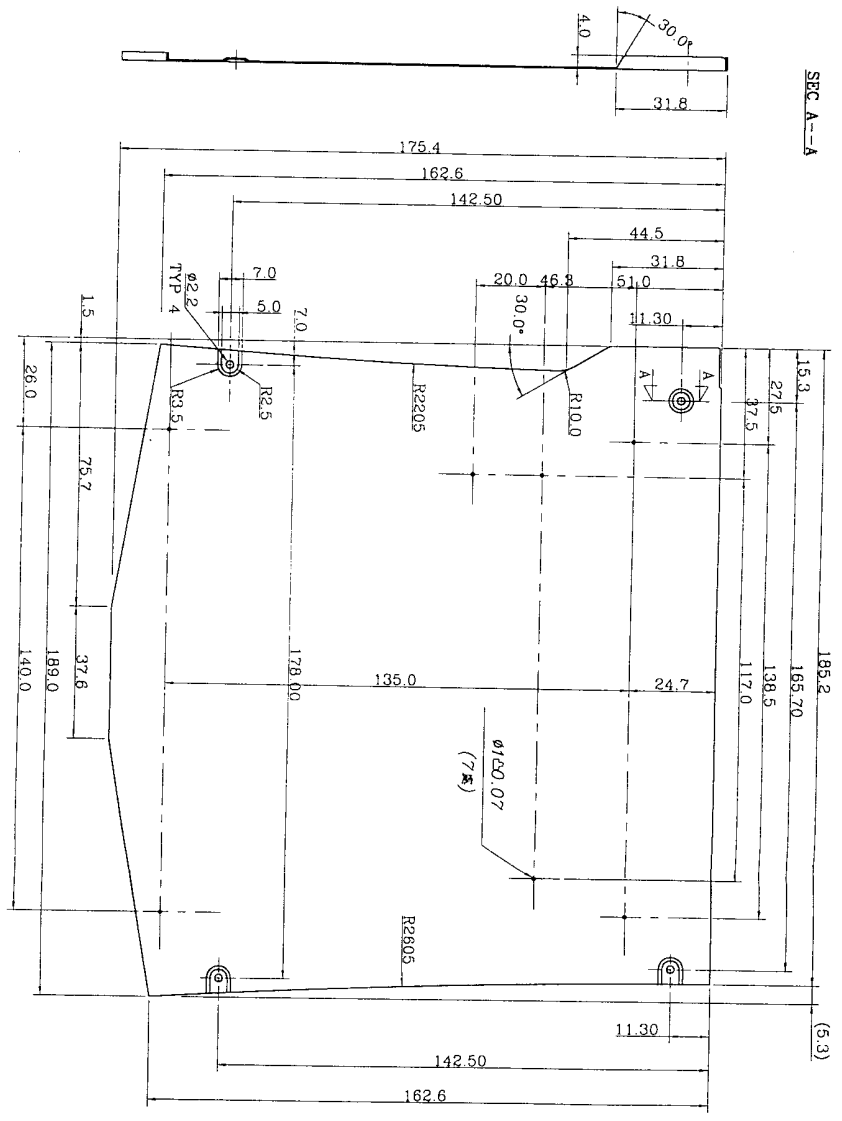
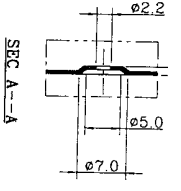

- NOTES:
1. UNLESS OTHERWISE SPECIFIED, 1-1 TOLERANCES TO BE ±0.08. ANGLE TO 5°
 2. MATERIAL: ZINC P/B-PLATED STEEL. FROM THICKNESS
 3. FINISH: TO BE TEXTURED, LIQUID SPRAY PAINTED. R.4091 OR OUTER SURFACE ONLY.
 4. MARRIAGE DISTORTION AND/OR BENDING TO BE WITHIN 0.005mm PER LINEAR MM.

| | | |
|---|----------------------------------------|--------|
| B | ADD NOTE 4 | 061597 |
| A | ADD P/N 50-00374-01 & 1/2N 50-00442-01 | 052997 |
| 0 | RELEASE FOR PRODUCTION | 052997 |
| | DESCRIPTION | DATE |
| | REVISIONS | |

| | | |
|-------------------------------------------------------------------|----------------------------|-------------------|
| 50-00442-01 | PAINTED PER NEG'S | CREV |
| 50-00374-01 | PAINTED PER WAGON'S | CREV |
| | COLOR CHIP NO. A091 | REMARKS |
| | COLOR CHIP NO. A091 | |
| | FINISH | |
| | OTHERWISE SPECIFIED | |
| | UNLESS OTHERWISE SPECIFIED | |
| USI 環隆電氣股份有限公司 UNIVERSAL SCIENTIFIC INDUSTRIAL CO. LTD. | | |
| TITLE: LOWER CASE FOR 4*5 HOMEPAD | | |
| DESIGN BY: Chang | DATE: 04/29/97 | SCALE: FULL |
| DATE: 05/29/97 | DATE: 05/29/97 | DWG NO.: 50-00374 |
| DATE: 05/29/97 | DATE: 05/29/97 | SIZE: A2 |
| DATE: 05/29/97 | DATE: 05/29/97 | SHEET: 1 |
| DATE: 05/29/97 | DATE: 05/29/97 | REV: B |