

View 1

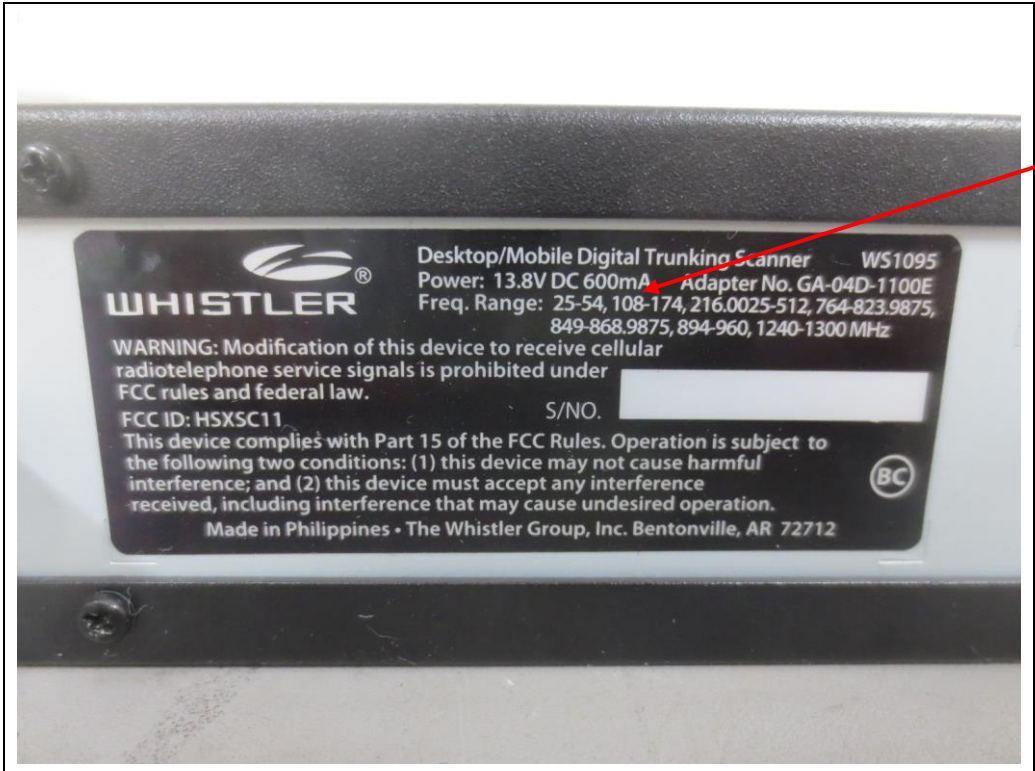

REAR

Label Location



Product Label

LABEL

  
**WHISTLER**

**WS1095**  
**Remote Head Unit**

**FC**

**S/N**

**Made in Philippines • The Whistler Group, Inc.**  
**Bentonville, AR 72712**

**35.0 x 13.0\_R0.5**

View 1

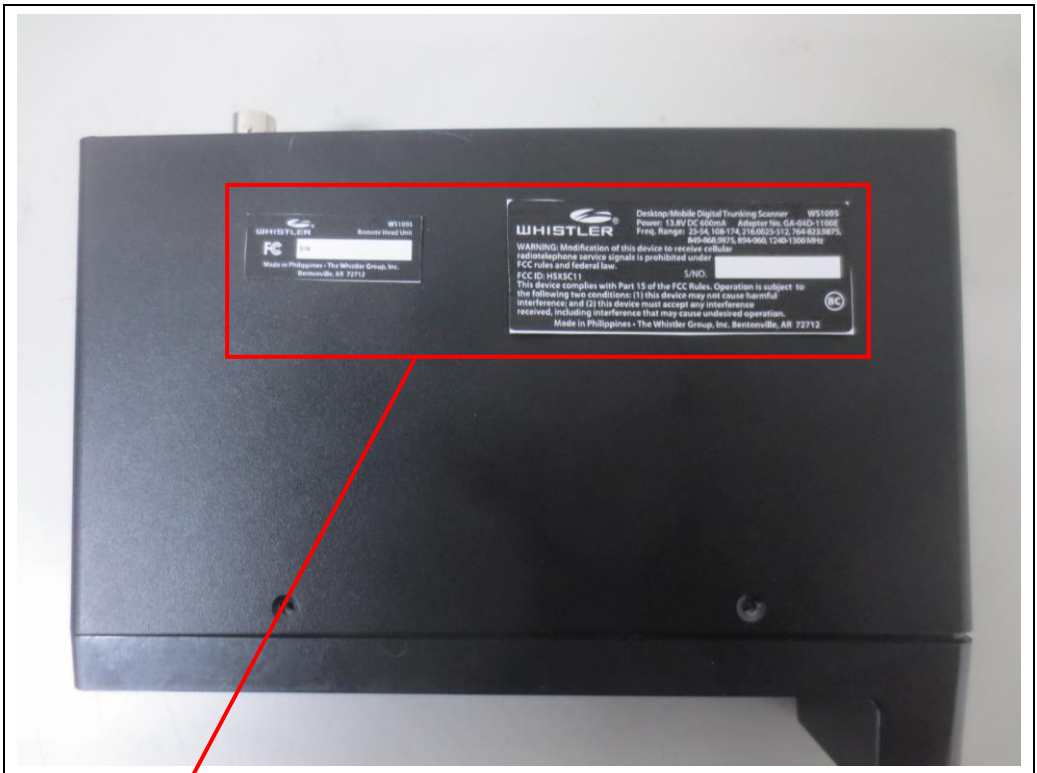

Label Location

TOP

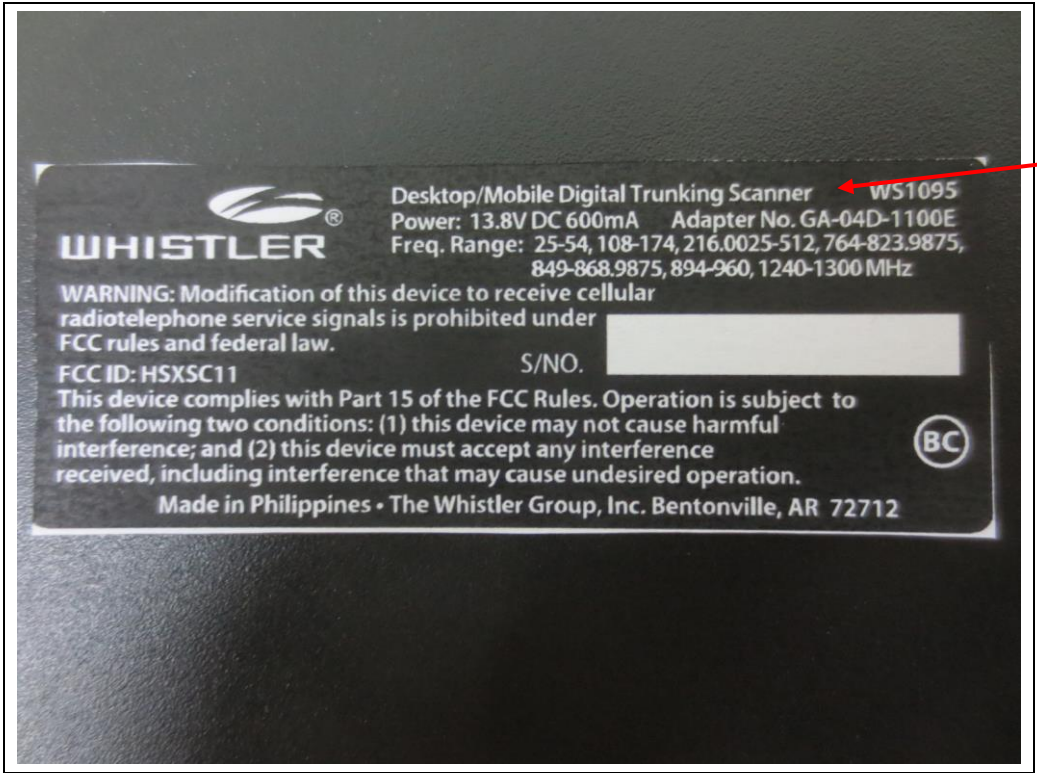

Product Label

LABEL

---

**View 1**

---

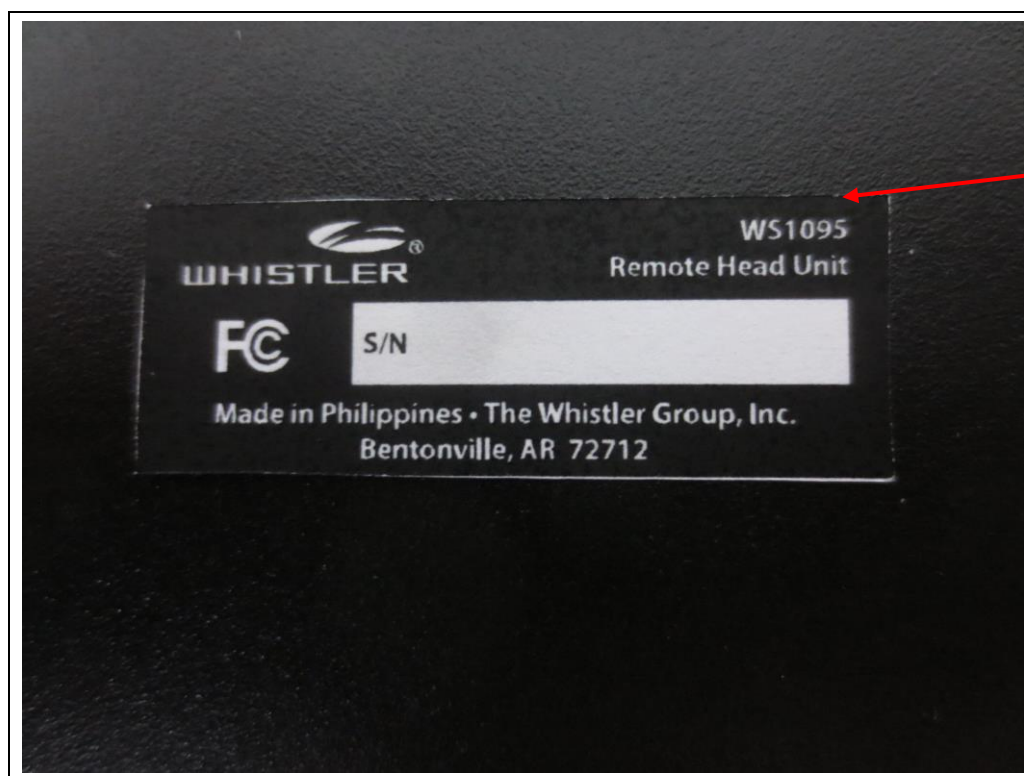

Product  
Label

**LABEL**



Desktop/Mobile Digital Trunking Scanner      WS1095  
Power: 13.8V DC 600mA      Adapter No. GA-04D-1100E  
Freq. Range: 25-54, 108-174, 216.0025-512, 764-823.9875,  
849-868.9875, 894-960, 1240-1300 MHz

WARNING: Modification of this device to receive cellular  
radiotelephone service signals is prohibited under  
FCC rules and federal law.

FCC ID: HSXSC11

S/NO. 

This device complies with Part 15 of the FCC Rules. Operation is subject to  
the following two conditions: (1) this device may not cause harmful  
interference; and (2) this device must accept any interference  
received, including interference that may cause undesired operation.



Made in Philippines • The Whistler Group, Inc. Bentonville, AR 72712

67.0 x 26.0\_R1.5

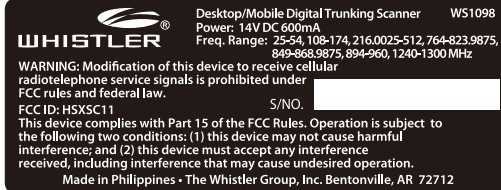

67.0 x 26.0\_R1.5



67.0 x 26.0\_R1.5

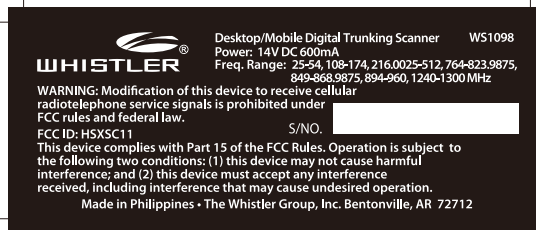

67.0 x 26.0\_R1.5

COMPANY	RDX	DATE	15/10/15
MODEL	WS-1098	PART	MODEL LABEL "B"
ART NO.			

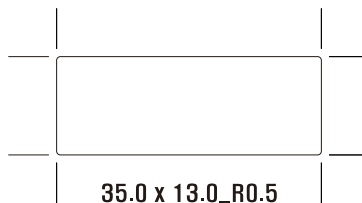

COMPANY	RDX	DATE	15/09/24
MODEL	WS-1098	PART	MODEL LABEL "R"
ART NO.			