

SAFETY INSTRUCTIONS

Read all installation, safety instruction and review all illustrations before installing the sensor. For reasons of safety and for optimal function, Sysgraion recommends that any maintenance and repair work is carried out by trained experts only and according to the guidelines of the vehicle manufacturer. The valves are safety-relevant parts which are intended for professional installation only. Failure to follow installation instructions may result in the failure of the motor vehicle TPMS sensor to operate properly. Sysgration does not assume any liability in case of faulty or incorrect installation of the product.

CAUTION

- The RSI06 sensor assemblies are replacement or maintenance parts for vehicles that have a factory installed TPMS.
- Make sure to program sensor by RSI06 programming tool for your specific vehicle make, model and year before installation.
- In order to guarantee optimal function, the sensor may only be installed with valves and accessories by Syagracion.
- Upon completion of installation, test the vehicles TPMS system using procedures described in the original manufacturer's user guide to confirm proper installation.

WARRANTY

Sysgration warrants that the TPMS sensor complies with RSI06 Sensor product specifications and shall be free from defects in workmanship and material for a period of twenty-four (24) months or 24,000 miles of use, whichever occur first. RSI06 Sensor will at its discretion replace any merchandise during the warranty period. The warranty shall be void if any of the following occur:

1. Improper installation of products
2. Improper usage
3. Induction of defect by other products
4. Mishandling of product
5. Incorrect application
6. Damage due to collision or tire failure
7. Racing or competition

This is the sole and exclusive warranty and liability to customers.

Sysgration expressly disclaims and other warranty including the warranties of merchantability. Fitness for purpose of other implied or express warranties. Under no circumstance shall RSI06 Sensor be liable to customer for any other amounts including labor charges for installation or reinstallation of products nor shall RSI06 Sensor liable under any theory for any other damages including but not limited to direct, indirect, special, consequential and incidental damages.

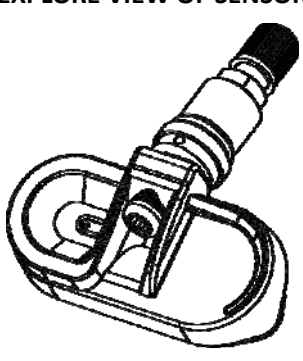
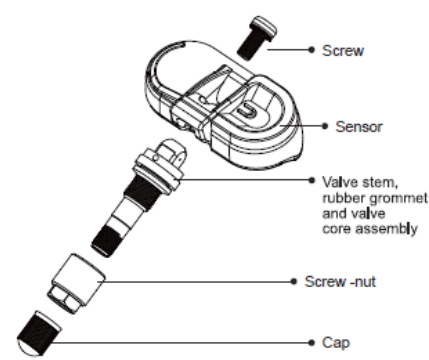
EXPLORE VIEW OF SENSOR 	EXPLORE VIEW OF SENSOR  <table border="1" data-bbox="742 1713 1284 1825"><tr><td>Weight of sensor without valve:</td><td>27.8g</td></tr><tr><td>Dimension:</td><td>L61.7Xw33.3x20.4mm</td></tr><tr><td>Max. pressure range:</td><td>130 psi</td></tr></table>	Weight of sensor without valve:	27.8g	Dimension:	L61.7Xw33.3x20.4mm	Max. pressure range:	130 psi
Weight of sensor without valve:	27.8g						
Dimension:	L61.7Xw33.3x20.4mm						
Max. pressure range:	130 psi						

INSTALLATION GUIDE

	WARNING: FAILURE TO FOLLOW INSTALLATION INSTRUCTIONS OR THE USE OF IMPROPER TPMS SENSORS MAY RESULT IN THE MOTOR VEHICLE TPMS SYSTEM FAILURE CAUSING PROPERTY DAMAGE, PERSONAL INJURY OR DEATH
Each time a tire is serviced or dismounted or if sensor is removed, it is MANDATORY to replace the nut , and value to ensure	

proper sealing. The TPMS sensor nut must be properly installed and tightened for Proper installation. Carefully follow instructions and use a torque wrench to ensure proper installation. Failure to torque the TPMS sensor nut properly will void the warranty and the TPMS may not function properly.

STEP 1: Loosening the tire

Remove the valve cap and core and deflate the tire. Use the bead loosener to unseat the tire bead.



STEP 2: Dismounting the tire



STEP 3: Dismounting the original sensor

With a screwdriver remove the fastening screw and sensor from the valve stem. Then loosen the nut and remove the valve.



STEP 4: Mounting the Sensor and valve

Slide the valve stem through the valve hole of the rim. Tighten the crew nut with 4.0 Nm with the help of the positioning pin. Assemble the sensor and the valve against the rim and tighten the screw.



STEP 5 Mounting the tire

Clamp the rim onto the assembly machine so that the valve faces the assembly head at an angle of 180°

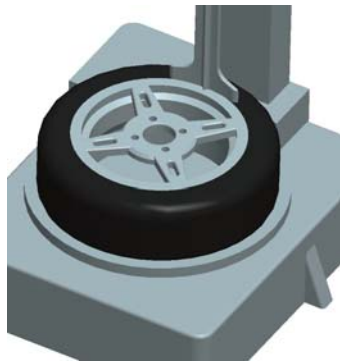

WARNING:

Correct nut torque: 40 inch-pounds; 4.6 Newton-meters. TPMS SENSOR AND/OR VALVE BROKEN BY OVERTORQUE ARE NOT COVERED UNDER WARRANTY. FAILURE TO ACHIEVE THE NECESSARY TPMS SENSOR NUT TORQUE MAY RESULT IN AN INADEQUATE AIR SEAL, RESULTING IN TIRE ARI LOSS.

WARRANTY INFORMATION

Professional installer: When replacing an entire TPMS sensor assembly, please Complete the following TPMS sensor warranty information giving one copy to the Customer and send the duplicate copy to indicated address.

RSI06 sensor customer Information Card

Place of Repair: _____
Address: _____ phone: _____
Vehicle owner: name _____ sensor installation date:(M) ____/(D)____/(Y)____
Address: _____
Motor Vehicle: Make _____ Model: _____ Year: _____
VIN Number: _____ Sensor ID: _____

IMPORTANT WARRANTY INFORMATION TO ACTIVATE WARRANTY,

Please complete the following section and send to :

RSI06 Sensor. 6F.,No.1,Tiding Blvd.,Neihu Dist.,Taipei City 11494, Taiwan

Place of Repair: _____
Address: _____ phone: _____
Vehicle owner: name _____ sensor installation date:(M) ____/(D)____/(Y)____
Address: _____
Motor Vehicle: Make _____ Model: _____ Year: _____
VIN Number: _____ Mileage: _____
Sensor ID: _____
Part number of sensor being replaced: Front Left _____ Front Right _____
Rear Left _____ Rear Right _____ Memo _____
Manufacture of sensor being replaced: _____

This device complies with Part 15 of the FCC Rules. Operation is subject to the following two conditions:

(1) This device may not cause harmful interference, and (2) This device must accept any interference received, including interference that may cause undesired operation.

SYSGRATION. Ltd

6F.,No.1,Tiding Blvd.,Neihu Dist.,Taipei City 11494, Taiwan

Tel: + 886 2 2790-0088

Email:sales@max-autoparts.com

Web :www.max-autoparts.com