

ENP GPS Pocket PC User Manual

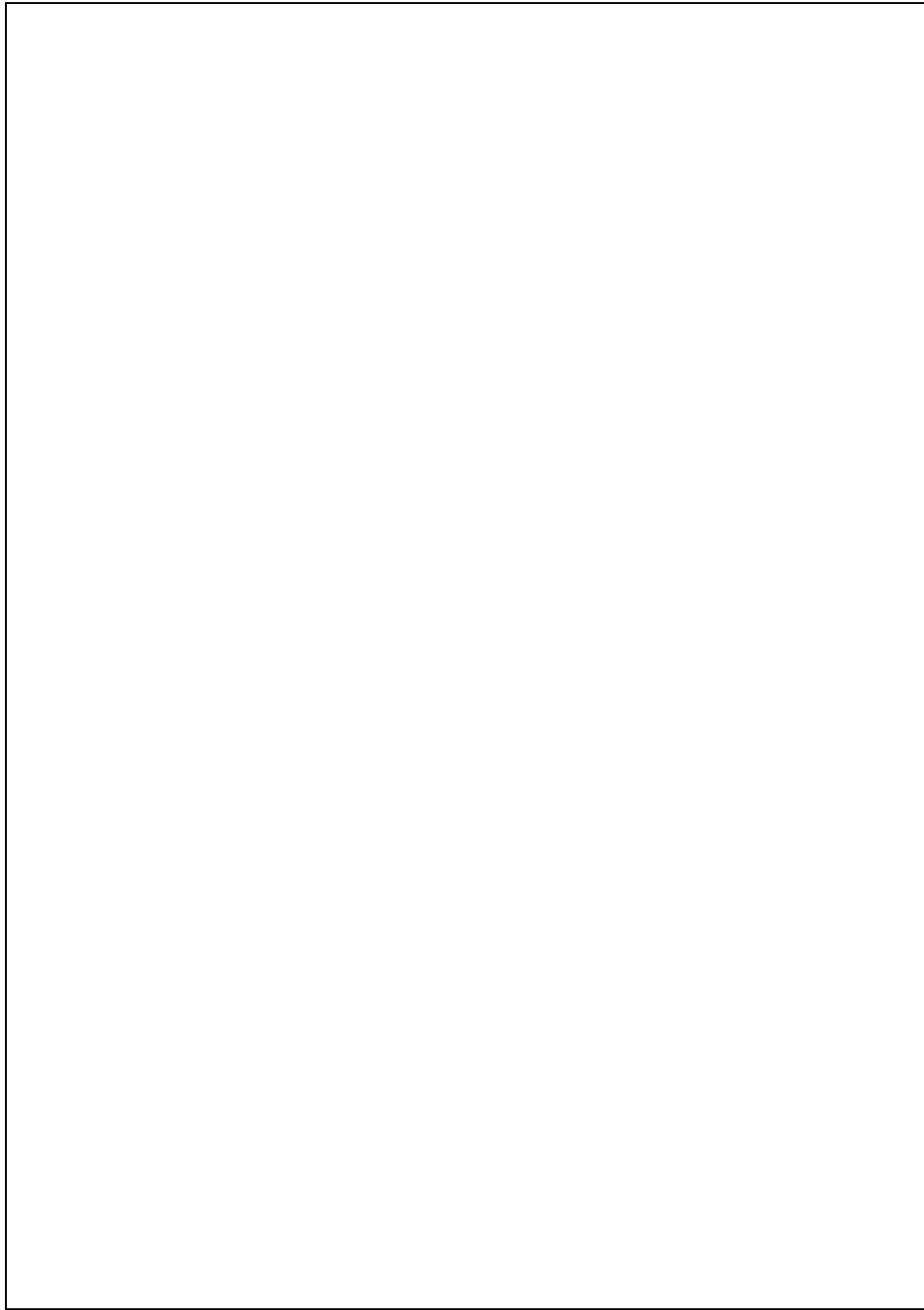

Cautions

In August 1996 the Federal Communications Commission (FCC) of the United States with its action in Report and Order FCC 96-326 adopted an updated safety standard for human exposure to radio frequency electromagnetic energy emitted by FCC regulated transmitters. Those guidelines are consistent with the safety standard previously set by both U.S. and international standards bodies. The design of this phone complies with the FCC guidelines and these international standards. Use only the supplied or an approved antenna. Unauthorized antennas, modifications, or attachments could impair call quality, damage the phone, or result in violation of FCC regulations. Do not use the phone with a damaged antenna. If a damaged antenna comes into contact with the skin, a minor burn may result. Please contact your local dealer for replacement antenna.

Body-worn operation

This device was tested for typical body-worn operations with the back of the phone kept 1.5cm from the body. To maintain compliance with FCC RF exposure requirements, use only belt-clips, holsters or similar accessories that maintain a 1.5cm separation distance between the user's body and the back of the phone, including the antenna. The use of belt-clips, holsters and similar accessories should not contain metallic components in its assembly. The use of accessories that do not satisfy these requirements may not comply with FCC RF exposure requirements, and should be avoided.

Body-worn operations are restricted to the specific body worn accessories specified in this manual or belt-clips, holsters or similar accessories that have no metallic component in the assembly and which provide at least 1.5 cm separation between the device and the users body. The Holster model use is PZX28.

FCC Regulations

- This device complies with part 15 of the FCC Rules. Operation is subject to the following two conditions: (1) This device may not cause harmful interference, and (2) this device must accept any interference received, including interference that may cause undesired operation.
- This device has been tested and found to comply with the limits for a Class B digital device, pursuant to Part 15 of the FCC Rules. These limits are designed to provide reasonable protection against harmful interference in a residential installation. This equipment generates, uses and can radiated radio frequency energy and, if not installed and used in accordance with the instructions, may cause harmful interference to radio communications. However, there is no guarantee that interference will not occur in a particular installation. If this equipment does cause harmful interference to radio or television reception, which can be determined by turning the equipment off and on, the user is encouraged to try to correct the interference by one or more of the following measures:
 - Reorient or relocate the receiving antenna.
 - Increase the separation between the equipment and receiver.
 - Connect the equipment into an outlet on a circuit different from that to which the receiver is connected.
 - Consult the dealer or an experienced radio/TV technician for help.

Changes or modifications not expressly approved by the party responsible for compliance could void the user's authority to operate the equipment.

RF Exposure Information (SAR)

This device meets the government's requirements for exposure to radio waves. This device is designed and manufactured not to exceed the emission limits for exposure to radio frequency (RF) energy set by the Federal Communications Commission of the U.S. Government.

The exposure standard for wireless devices employs a unit of measurement known as the Specific Absorption Rate, or SAR. The SAR limit set by the FCC is 1.6W/kg. Tests for SAR are conducted using standard operating positions accepted by the FCC with the device transmitting at its highest certified power level in all tested frequency bands. Although the SAR is determined at the highest certified power level, the actual SAR level of the device while operating can be well below the maximum value. This is because the device is designed to operate at multiple power levels so as to use only the power required to reach the network. In general, the closer you are to a wireless base station antenna, the lower the power output.

The FCC has granted an Equipment Authorization for this device with all reported SAR levels evaluated as in compliance with the FCC RF exposure guidelines. SAR information on this device is on file with the FCC and can be found under the Display Grant section of <http://www.fcc.gov/oet/fccid> after searching on FCC ID: HFS-GPS600.

For body worn operation, this device has been tested and meets the FCC RF exposure guidelines for use with an accessory that contains no metal and the positions the handset a minimum of 1.5 cm from the body. Use of other enhancements may not ensure compliance with FCC RF exposure guidelines. If you do not use a body-worn accessory and are not holding the device at the ear, position the handset a minimum of 1.5 cm from your body when the device is switched on.

Safety Instructions

- ♥ Please Read Before Proceeding.
- ♥ This product is not charged when shipped from the factory. When you use this product the first time, we recommend that you install the battery as illustrated and fully charge it for about 8 hours before use.
- ♥ Before you install the SIM card, make sure that tap the **ALL OFF Button** in **Wireless Manager** to turn off your Pocket PC's mobile phone, Bluetooth, and wireless LAN functions. And press the "Power Button" of the Pocket PC to turn off the screen. Otherwise, abnormal disconnection problems will occur.
- ♥ When you are on a plane, in a medical facility or at a gas station where wireless communications devices are not allowed and must be turned off, please go to **Wireless Manager** and select the **ALL OFF Button** to turn off your Pocket PC's mobile phone, Bluetooth, and wireless LAN functions. By pressing the "Power Button" of the Pocket PC, you only turn off the display.
- ♥ In case the Pocket PC is damaged, send it back to the dealer for repair. Do not attempt to disassemble the Pocket PC on your own; otherwise the warranty will be void.

Where to Find Information

For information on:	See this source:
Programs on your Pocket PC	This User's Guide and Pocket PC Help. To view Help, tap  and then Help .
Additional programs that can be installed on the Pocket PC	The Pocket PC Getting Started CD.
Connecting to and synchronizing with a desktop computer	Check the user's guide that comes with this product or look for the online help relevant to ActiveSync on the desktop PC or the Pocket PC.
Up-to-date information on your Pocket PC	http://www.microsoft.com/windowsmobile/

- This document lists the functions, specifications, and illustrations for reference only. The actual purchased product should be taken as the standard.

User Manual

CAUTIONS.....	3
BODY-WORN OPERATION.....	3
FCC REGULATIONS.....	4
RF EXPOSURE INFORMATION (SAR).....	5
SAFETY INSTRUCTIONS.....	6
WHERE TO FIND INFORMATION.....	6
1 Voice Command Satellite Navigation //.....	1-1
NAVIGATION DEVICE INSTALLATION.....	1-1
GPS NAVIGATION SOFTWARE INSTALLATION.....	1-2
CONDITIONS FOR USING GPS CAR NAVIGATION.....	1-2
2 Getting Started //.....	2-1
PACKAGE CONTENT.....	2-1
EXTERNAL VIEWS.....	2-2
<i>Hardware Hotkey Functions.....</i>	<i>2-3</i>
<i>Rear Side.....</i>	<i>2-4</i>
USING THE POCKET PC FOR THE FIRST TIME.....	2-5
<i>Charging Power and Power Supply.....</i>	<i>2-5</i>
<i>Re-installation or Replacing the Battery.....</i>	<i>2-7</i>
POWER ON AND OFF.....	2-8
<i>Sleep Mode.....</i>	<i>2-8</i>
<i>Turn on the Screen.....</i>	<i>2-9</i>

<i>Restarting the Pocket PC</i>	2-10
Reset.....	2-11
Clean Boot	2-12
3 Using the Pocket PC //	3-1
START.....	3-1
<i>Screen</i>	3-1
<i>Today Screen</i>	3-3
<i>Programs</i>	3-5
<i>System Application Programs</i>	3-7
ENTER INFORMATION ON YOUR POCKET PC.....	3-9
<i>Enter Text Using the Input Panel</i>	3-9
Type with the Soft Keyboard.....	3-11
Use Letter Recognizer	3-11
Use Block Recognizer	3-11
Use Transcriber.....	3-12
Select Typed Text	3-12
<i>Write on the Screen</i>	3-13
Write on the Screen	3-13
Select Writing	3-14
Convert Writing to Text.....	3-14
<i>Draw on the Screen</i>	3-16
Create a Drawing	3-16
Select a Drawing.....	3-17
<i>Record a Message</i>	3-17
Create a Recording	3-18
<i>Use My Text</i>	3-19

4	Using the Phone //	4-1
	INSTALLING AND REMOVING THE SIM CARD	4-2
	USING THE PHONE	4-4
	<i>Adjusting the Phone Volume</i>	4-5
	TURNING THE PHONE ON OR OFF AND MAKING CALLS	4-6
	<i>Toolbar</i>	4-8
	<i>Call from Contacts</i>	4-9
	<i>Call from Speed Dial</i>	4-9
	<i>Call from the Call History</i>	4-10
	CUSTOMIZE YOUR PHONE	4-11
	PHONE APPLICATION PROGRAMS	4-13
	<i>SIM Tool Kit</i>	4-13
	<i>SMS Sender</i>	4-14
5	Customize Your Pocket PC //	5-1
	ADJUSTING SETTINGS	5-1
	NOTIFICATIONS	5-2
	POWER PREFERENCE SETTINGS	5-3
	BACKLIGHT	5-4
	MICROPHONE	5-5
	ADJUST VOLUME	5-6
	FIND AND ORGANIZE INFORMATION	5-7
	NAVIGATION BAR AND COMMAND BAR	5-8
	POP-UP MENUS	5-9
	REDEFINE HOT KEYS	5-10

6	Microsoft ActiveSync //	6-1
	INSTALLING AND USING ACTIVE SYNC	6-2
	<i>ActiveSync Frequently Asked Questions</i>	6-4
	USB SYNCHRONIZATION.....	6-4
	SYNCHRONIZING USING BLUETOOTH	6-7
7	Connections //	7-1
	CONNECTING TO THE INTERNET	7-1
	<i>Connection Wizard</i>	7-1
	<i>Setting the GPRS Connection</i>	7-3
	<i>Starting GPRS Connection</i>	7-5
	<i>Disconnecting GPRS</i>	7-6
	USING BLUETOOTH.....	7-7
	<i>Bluetooth Connection Wizard</i>	7-7
	<i>Bluetooth Connection Setting</i>	7-9
	Service	7-10
	Serial Port	7-11
	Bluetooth Headset.....	7-12
	FTP Sharing	7-12
	CSD TYPE	7-13
	CONNECTING WITH A PERSONAL COMPUTER	7-14
	WIRELESS LAN TRANSMISSION	7-14
8	Using Wireless LAN //	8-1
	CONNECTING TO WIRELESS LAN.....	8-1
	CONFIGURE YOUR WIRELESS NETWORK	8-3
	<i>Configure Your Wireless Network (Reference</i> <i>for a normal network setup)</i>	8-3

	<i>Configure Your Wireless Network (Reference for Proxy setup)</i>	8-7
9	Sending and Receiving Messages //	9-1
	E-MAILS AND SMS MESSAGES	9-1
	<i>Synchronizing E-mail Messages</i>	9-2
	<i>Connecting Directly to the Mail Server</i>	9-3
	<i>E-mail Server Setup</i>	9-4
	<i>Using E-mails and SMS</i>	9-5
	<i>Direct Push Technology Alert</i>	9-8
	Direct Push Technology Alert Settings	9-8
	MSN MESSENGER	9-10
	<i>Setting Up</i>	9-11
	<i>Working with Contacts</i>	9-12
	<i>Chatting with Contacts</i>	9-13
10	Multimedia //	10-1
	USING CAMERA	10-1
	<i>Camera Mode</i>	10-2
	Camera Mode Using Wizard	10-3
	<i>Managing Pictures Shot by Continuous Shutter</i>	10-4
	<i>Digital Video Mode</i>	10-5
	Digital Video Mode Using Wizard	10-6
	<i>Speed Shooting Using the Hardware Hotkeys</i>	10-7
	MULTIMEDIA MANAGER	10-8
	<i>Preview Multimedia Information</i>	10-8

<i>Slide Show Function</i>	10-9
<i>Multimedia Manager Tools</i>	10-10
FM TUNER.....	10-11
11 Companion Programs //	11-1
CALENDAR: SCHEDULING APPOINTMENTS AND MEETINGS	11-2
<i>Create an Appointment</i>	11-3
<i>Use the Summary Screen</i>	11-4
<i>Create Meeting Requests</i>	11-4
Schedule a Meeting.....	11-5
CONTACTS: TRACKING FRIENDS AND COLLEAGUES	11-6
<i>Create a Contact</i>	11-7
<i>Find a Contact</i>	11-8
<i>Use the Summary Screen</i>	11-9
TASKS: KEEPING A TO DO LIST.....	11-10
<i>Create a Task</i>	11-11
<i>Use the Summary Screen</i>	11-12
NOTES: CAPTURING THOUGHTS AND IDEAS	11-13
<i>Create a Note</i>	11-14
WORD MOBILE	11-15
EXCEL MOBILE.....	11-18
<i>Tips for Working in Excel Mobile</i>	11-20
POWERPOINT MOBILE	11-21
WINDOWS MEDIA PLAYER	11-22
INTERNET EXPLORE.....	11-24
<i>Using Internet Explore</i>	11-24
Browse the Internet.....	11-25
View Mobile Favorites and Channels	11-26
<i>The Mobile Favorites Folder</i>	11-26

<i>Favorite Links</i>	11-27
<i>Synchronize Mobile Favorites</i>	11-27
Create a Mobile Favorite	11-27
Save Pocket PC Memory	11-28
12 Maintaining the Pocket PC //	12-1
ADDING OR REMOVING PROGRAMS	12-1
<i>Add Programs Using ActiveSync</i>	12-1
<i>Add a Program Directly from the Internet</i>	12-2
<i>Add a Program to the Start Menu</i>	12-3
<i>Remove Programs</i>	12-4
MANAGE MEMORY	12-5
<i>View Memory Status</i>	12-5
<i>Find Available Memory</i>	12-6
SYSTEM INFORMATION	12-9
13 Specifications //	13-1
14 Regulation Notice and Safety Declaration //	14-1
SAR INFORMATION	14-1
HEALTH AND SAFETY INFORMATION	14-2
15 FAQ //	15-1

1 Voice Command Satellite Navigation

Navigation Device Installation

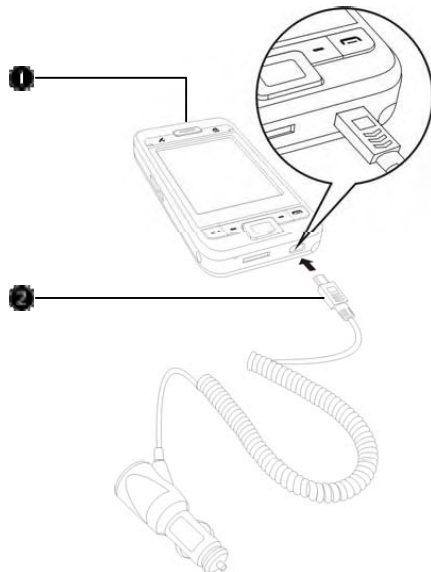

1 Pocket PC

2 Car Charger (* optional): when Pocket PC is low on power, recharge by connecting one end to the car cigarette lighter/12 volt power outlet and the other end to the socket on base of Pocket PC.

Attention: The GPS signal receiver is built into the Pocket PC. If car windscreen has heat reflective metallic film, or Pocket PC is obstructed by objects, then the receptivity of the GPS will be adversely affected.

GPS Navigation Software Installation

Please follow your car navigation system operating manual's instructions on software installation in order to use the navigation function.

Conditions for Using GPS Car Navigation

By using this system you are agreeing to the following conditions:

1. When using this device, please use with matching car mount. Affix device securely to the car mount. Please be aware that installation in the areas depicted below is forbidden and is strictly prohibited.

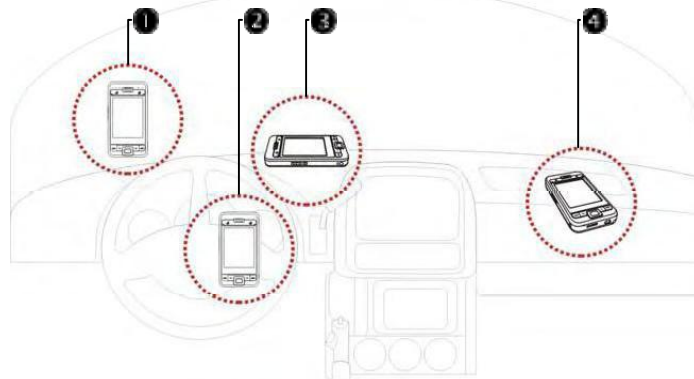

- ❶ Do not place where it will obstruct driver vision
- ❷ Do not place over air bag
- ❸ Do not place where it can not be securely attached
- ❹ Do not place in path of activated air bag

- 2. Please set navigation destination before driving. Do not operate this system while driving.**
- 3. Please use this system with care. If any harm results from careless use of this system, the responsibility for safe driving resides with the driver.**
- 4. GPS positioning is limited by weather and usage location (tall buildings, tunnels, underpasses, trees, bridges). Most GPS do not work indoors, nor can GPS signals penetrate buildings, car sun shades and heat reflective film with metallic content. Please install GPS outdoors with clear line of sight. Beneath the windshield at the front of the car is a common choice, and the windshield should be free of heat reflective film.**
- 5. If reception is poor, an external GPS antenna may give better signal reception.**
- 6. The GPS system is built and operated by the U.S. Department of Defense which is also responsible for its maintenance and calibration. Any changes made by them may affect the operation and accuracy of the GPS system.**
- 7. Wireless devices (mobile phones, speed radar detectors) will all interfere with the satellite signal and cause unreliable signal reception.**
- 8. The GPS position fix is provided only for the driver's reference and should not affect actual driver behavior.**
- 9. The electronic map data provided in the navigation system is for normal reference only and not intended for high precision applications. The user should determine their exact location based on actual road conditions.**

- 10. The route provided by the navigation system, the audio cues and intersection data are derived from recommended optimal route calculated using the electronic map data. This is provided for the driver's reference only, the driver should decide their chosen route according to actual road conditions.**
- 11. When not in use, please do not leave the device inside the car. If exposed directly to sunlight, the battery may overheat and cause damage to this device. This may endanger the vehicle as well.**

2 Getting Started /

Package Content



Pocket PC, stylus, Battery, Getting Started CD, User Guide, AC adapter, USB cable, headset and Leather case.



- | | | | |
|--------------|-------------|--------------|----------------------|
| ❶ Pocket PC | ❷ Stylus | ❸ Battery | ❹ Getting Started CD |
| ❺ User Guide | ❻ USB Cable | ❼ AC Adapter | |

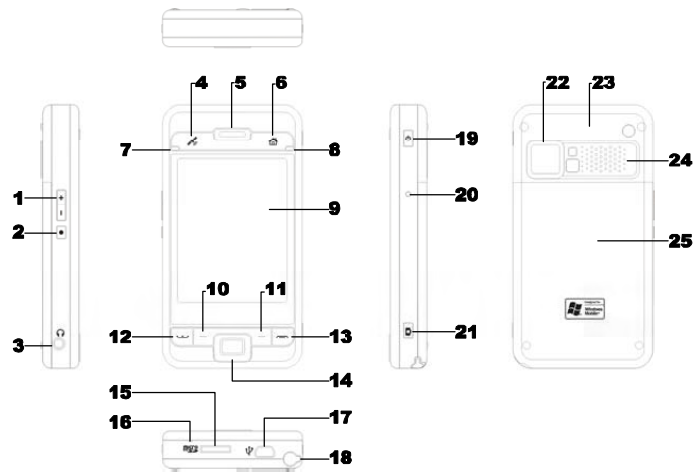

External Views

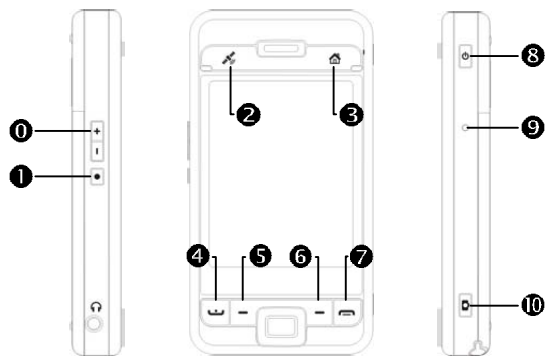

- | | |
|--|---|
| 1 Volume control key | 2 Notes hot key |
| 3 Earphone and microphone jack | 4 Hot key reserved for GPS AP |
| 5 Cell Phone speaker | 6 Today Screen hot key |
| 7 WLAN Active LED (Orange) | 8 Power Charging LED (Red) |
| Bluetooth Active LED | Cell phone Active LED (Green) |
| (Blue, blinks once) | |
| GPS Active LED (Blue, blinks twice) | |
| 9 Touch screen | 10 Left Soft-Key |
| 11 Right Soft-Key | 12  Send button |
| 13  End button | 14 Navigation button. Press the center of the button to set as launch key. |
| 15 MicroSD Slot | 16 Microphone |
| 17 Mini USB port | 18 Stylus holder. Slide the stylus out of the holder. This is a two-stage push-pull stylus. |
| 19 Power button | 20 Reset button |
| 21 Camera Shutter | 22 Built-in camera lens/ preview mirror |
| 23 Hidden antenna for Cell Phone | 24 Speaker |
| 25 Back cover. Battery is inside. | |

Hardware Hotkey Functions



Hardware Button	Short Press (Press once and release)	Long Press (Press for a few seconds and release)
①	<ul style="list-style-type: none"> ■ Adjust volume ■ Zoom in/out during camera mode 	—
①	Connect to Notes	—
②	Hot key reserved for GPS AP	—
③	Connect to Today Screen	—
④ 	Connect to Phone/dial/redial/answer	Telephone hold
⑤	Left Soft-Key: Soft-keys on left and right to operate function buttons at bottom of display.	—
⑥	Right Soft-Key	—
⑦ 	<ul style="list-style-type: none"> ■ Hang up during call ■ Disconnect during GPRS connection ■ Skip to Today's screen while in other programs 	<ul style="list-style-type: none"> ■ Turn off phone if it is on ■ Turn on phone when it is off
⑧	Power Button = open or close screen	—
	Power Button + Reset Button = Cold boot	—
⑨	Reset Button	—
⑩ 	Camcorder	Video recorder

Rear Side

- 1** Insert the SIM card into the SIM card slot with its golden contacts facing down. Follow the picture indicated on the Pocket PC.
- 2** Main battery
- 3** Back cover
- 4** Follow the direction in the illustration to install the main battery.
- 5** Main battery lock

■ Installing the SIM Card

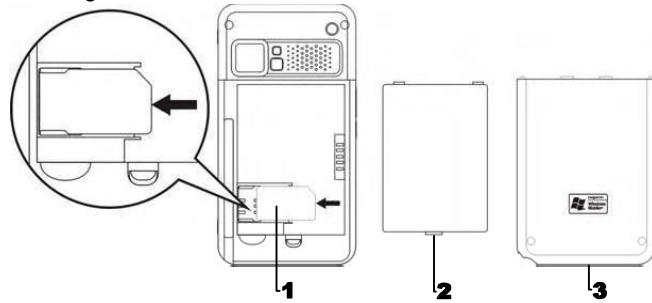

■ Installing the Battery

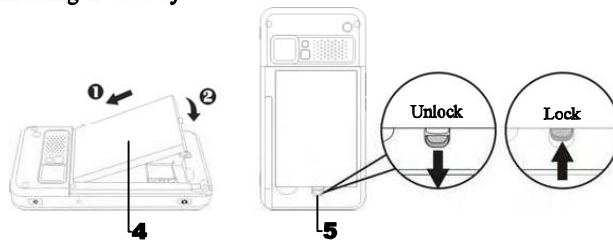

Using the Pocket PC for the First Time

Charging Power and Power Supply

- ❶ Connect the AC adapter plug to any household power outlet.
- ❷ Connect the other plug from the AC adapter to the USB port. The Pocket PC starts to charge automatically.
- ❸ If you need to connect Pocket PC and desktop computer, you could connect the USB cable to the USB port on the bottom of the Pocket PC. And then connect the other end of the USB cable to the USB port on the desktop computer. Your Pocket PC will also charge at the same time.

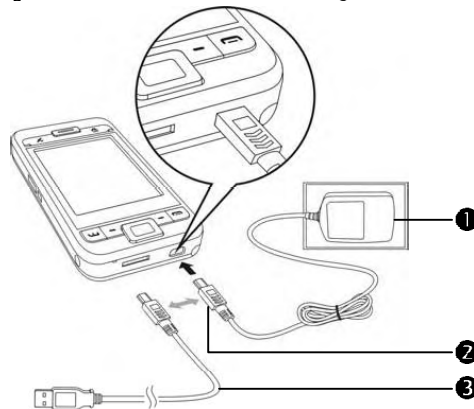

1. Remove the back cover.
(If you are opening this product for the first time, the main battery and the Pocket PC are packed separately inside the product package.)
2. Install the main battery properly and lock the battery securely.

3. Please connect one side of the AC adapter plug to any household power outlet and connect the other side of plug from the AC adapter to the USB port. The Pocket PC will start to charge automatically.
4. Cold Boot: Press and hold the “Power Button” with one hand, and use the stylus tip to press the “Reset Button” with the other hand. Release the “Power Button” and the “Reset Button” at the same time. Wait for the Pocket PC to restart and follow the instructions on the screen to complete screen alignment.
5. It will take about 8 hours to fully charge the battery after the first time you open the package. Subsequent charging will only take about 3 hours. After charging, you can disconnect the AC adapter and carry the Pocket PC around portably. To maintain smooth operation, charge the power regularly.
6. View the battery icon  on the upper right corner to check the power usage condition.
7. The LED indicator on the upper right of Pocket PC will display the charging and function usage status.

Charging	Fully charged	Insufficient power
Red LED lights up	Red LED goes off Green LED lights up	Red LED flashes
Phone is on	Caution or Warning	
Green LED flashes	Orange LED flashes	

8. The LED indicator on the upper left of Pocket PC

WLAN Active	Bluetooth Active	GPS Active
Orange LED flashes	Blue LED blinks once every 4 seconds	Blue LED blinks twice every 4 seconds

Re-installation or Replacing the Battery

If the phone, GPRS or wireless LAN connection function is already activated, deactivate it first and then replace the battery.

1. Slide and remove the back cover of Pocket PC.
2. You may poke down to unlock the main battery lock in order to remove the battery.
3. Replace the main battery and lock it properly. When you remove the main battery, your Pocket PC will enter the sleep mode.
4. Slide the back cover into the groove, and reinstall the back cover.

