



Quick Start Guide

Brand : **IgniteNet**

Model name : **SS-AC1900**

Product name : **SunSpot AC1900 Dual Band Enterprise AP**

1. Unpack the AP



- ◆ Cloud-Enabled AP SunSpot AC1900
- ◆ Mounting kit — 2 screws, 2 wall plugs, and 4 rubber feet
- ◆ Universal AC/DC power adapter
- ◆ Ethernet cable (Cat. 5e, 3 m)
- ◆ Documentation — *Quick Start Guide*

2. Mount the AP

a. Mounting the AP on a Desktop

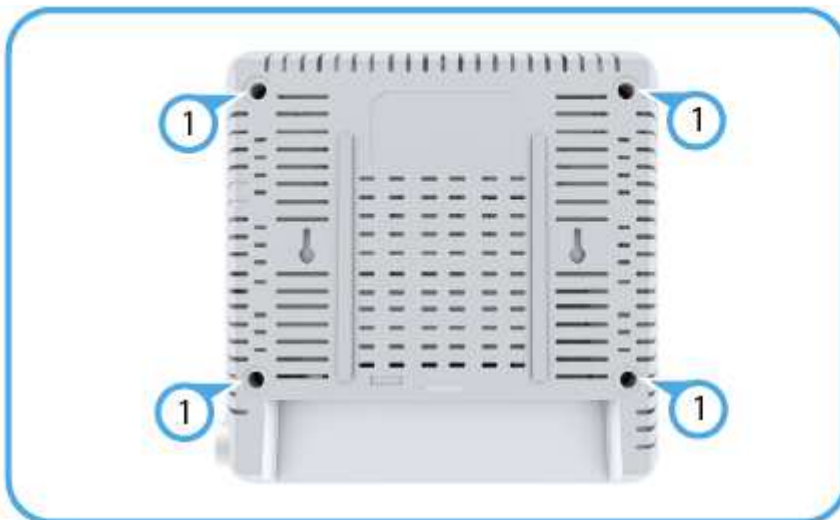

- 1 Attach the included four rubber feet to the base of the AP.
- 2 Place the AP on the desktop.



Note: If the AP is mounted on a wall or ceiling, do not attach the provided rubber feet on the AP.

Quick Start Guide

b. Mounting the AP on a Wall



- 1 At the installation location on the wall, mark two holes 116 mm (4.57 in.) apart for the wall plugs and screws.
Drill two holes for the wall plugs, and then insert the plugs and tap them flush with the wall surface.
Insert the two screws in the wall plugs leaving the screw heads about 5 mm from the wall surface.

With its ports facing down, place the AP's mounting points over the two screws, and then slide it down on the screws.
Do not let go of the AP until you confirm that it is secure.

Quick Start Guide

c. Mounting the AP on a Ceiling

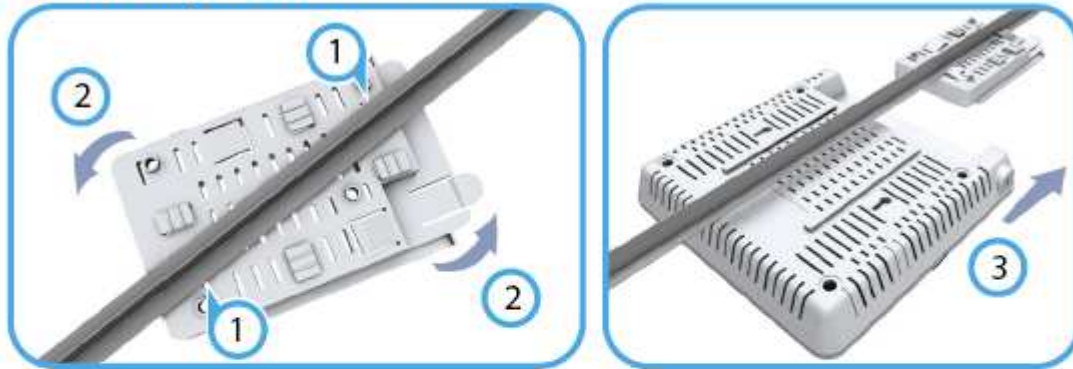

- 1 Press the retention clips of the mounting plate against the ceiling T-bar.
- 2 Rotate the plate until the T-bar snaps into place.
- 3 Slide the rails on the back of the AP along the sides of the ceiling mounting plate until it snaps into its secured position.

i **Note:** The mounting plate supports two different sizes of suspended ceiling T-bars. The position illustrated above is for 15 mm bars. Use the position at a 90 degrees angle for 24.5 mm bars.

3. Connect Cables

a. Using the AC/DC Power Adapter





Quick Start Guide

- 1 Connect the cable from the AC/DC power adapter to the DC power jack on the AP.
Connect the power adapter to a nearby AC power source (100-240 VAC, 50/60 Hz).
- 2 Connect Category 5e or better cable to the **WAN** RJ-45 port.
Connect the other end of this cable to a LAN switch.
- 3 (Optional) Connect local LAN devices to any of the other RJ-45 ports on the AP using Category 5e or better cable.
These 1000BASE-T ports are labeled **LAN1** to **LAN4**.
For the SFP slot, first install an SFP transceiver and then connect fiber optic cabling to the transceiver port.
The following SFP transceivers are supported:
 - ◆ 1000BASE-SX
 - ◆ 1000BASE-LX
 - ◆ 1000BASE-ZX
 - ◆ 1000BASE-LHX

Quick Start Guide

b. Using a PoE Power Source



- 1 Connect Category 5e or better cable to the **WAN** RJ-45 port, and the other end of this cable to an 802.3at PoE LAN switch. Alternatively, connect Category 5e or better cable to one of the **LAN1** to **LAN4** RJ-45 ports, and the other end to an optional passive PoE injector.
- 2 (Optional) Connect local LAN devices to any of the other RJ-45 ports on the AP using Category 5e or better cable. For the SFP slot, first install an SFP transceiver and then connect fiber optic cabling to the transceiver port.

Quick Start Guide

4. Verify AP Operation



- 1 The **WAN** port link/activity LED should be on/blinking green.
When connected, the **LAN1-LAN4** port link/activity LEDs should also be on/blinking green.
- 2 The system/wireless LED should be on cyan when the AP is powered on.
During normal operation, the wireless LED should be on/blinking green (2.4 GHz) or blue (5 GHz).



Quick Start Guide

5. Connect to the Web User Interface

To access the web interface, connect a PC directly to one of the AP's **LAN1 - LAN4** RJ-45 ports. In a web browser, enter the AP's default management IP address of 192.168.2.1 to access the web login page.

If you want to connect to the web interface using the **WAN** port, the IP address is automatically assigned through DHCP by default. If a DHCP server is unreachable, the **WAN** port reverts to a fallback IP address of 192.168.1.20.



Log in to the web interface using the default settings:

- ◆ Login Name — root
- ◆ Password — admin123



Note: To reset the AP to factory default settings, press and hold down the AP's **Reset** button for 5 seconds.



Quick Start Guide

6. Complete the Setup Wizard

SETUP WIZARD

Select Your Country

Please select your location. This setting will be used to determine your country's regulatory rules. This selection can only be changed if you reset to defaults.

United States

Will this product be cloud managed?

Yes, I will manage this device with the IgniteNet Cloud controller.

No, I will be operating this device in stand-alone mode.

Done

Select the country of operation for the AP. Setting the correct country ensures that the radios operate within local regulations specified for Wi-Fi networks.

Manage the AP with the IgniteNet Cloud Controller

Go to **cloud.ignitenet.com** to register your AP.

Log in and select **Devices** from the menu. Click **Add Device** and enter the AP serial number and MAC address to register the AP with your cloud network. The serial number and MAC address can be found on the product packaging or label.

Manage the AP in Stand-Alone Mode

If you select to manage the AP in stand-alone mode, use the web interface to manually make your configuration changes.

For more information on AP configuration in stand-alone mode, refer to the *HeliOS User Manual*, which can be downloaded from **ignitenet.com/support**.

Hardware Specifications

2.4GHz Radio : **IEEE802.11b/g/n**

5GHz Radio : **IEEE802.11a/n/ac**

Operation Frequency : **2412~2462MHz, 5180~5240MHz, 5745~5825MHz**

Power Supply : **DC 12V from adapter DC 48V or 24V from POE**



Quick Start Guide

Federal Communication Commission Interference Statement

This device complies with Part 15 of the FCC Rules. Operation is subject to the following two conditions: (1) This device may not cause harmful interference, and (2) this device must accept any interference received, including interference that may cause undesired operation.

This equipment has been tested and found to comply with the limits for a Class B digital device, pursuant to Part 15 of the FCC Rules. These limits are designed to provide reasonable protection against harmful interference in a residential installation. This equipment generates, uses and can radiate radio frequency energy and, if not installed and used in accordance with the instructions, may cause harmful interference to radio communications. However, there is no guarantee that interference will not occur in a particular installation. If this equipment does cause harmful interference to radio or television reception, which can be determined by turning the equipment off and on, the user is encouraged to try to correct the interference by one of the following measures:

- Reorient or relocate the receiving antenna.
- Increase the separation between the equipment and receiver.
- Connect the equipment into an outlet on a circuit different from that to which the receiver is connected.
- Consult the dealer or an experienced radio/TV technician for help.

FCC Caution: Any changes or modifications not expressly approved by the party responsible for compliance could void the user's authority to operate this equipment.

This transmitter must not be co-located or operating in conjunction with any other antenna or transmitter.

Operations in the 5.15-5.25GHz band are restricted to indoor usage only.

Radiation Exposure Statement:

This equipment complies with FCC radiation exposure limits set forth for an uncontrolled environment. This equipment should be installed and operated with minimum distance 39cm between the radiator & your body.



Quick Start Guide

Industry Canada statement:

This device complies with ISED's licence-exempt RSSs. Operation is subject to the following two conditions:

(1) This device may not cause harmful interference, and (2) this device must accept any interference received, including interference that may cause undesired operation.

Le présent appareil est conforme aux CNR d'ISED applicables aux appareils radio exempts de licence. L'exploitation est autorisée aux deux conditions suivantes : (1) le dispositif ne doit pas produire de brouillage préjudiciable, et (2) ce dispositif doit accepter tout brouillage reçu, y compris un brouillage susceptible de provoquer un fonctionnement indésirable.

Caution :

(i) the device for operation in the band 5150-5250 MHz is only for indoor use to reduce the potential for harmful interference to co-channel mobile satellite systems;

(ii) the maximum antenna gain permitted for devices in the band 5725-5850 MHz shall be such that the equipment still complies with the e.i.r.p. limits specified for point-to-point and non-point-to-point operation as appropriate; and

(iii) Users should also be advised that high-power radars are allocated as primary users (i.e. priority users) of the bands 5650-5850 MHz and that these radars could cause interference and/or damage to LE-LAN devices.

Avertissement:

(i) les dispositifs fonctionnant dans la bande 5150-5250 MHz sont réservés uniquement pour une utilisation à l'intérieur afin de réduire les risques de brouillage préjudiciable aux systèmes de satellites mobiles utilisant les mêmes canaux;

(ii) le gain maximal d'antenne permis (pour les dispositifs utilisant la bande de 5725 à 5850 MHz) doit être conforme à la limite de la p.i.r.e. spécifiée pour l'exploitation point à point et l'exploitation non point à point, selon le cas;

(iii) De plus, les utilisateurs devraient aussi être avisés que les utilisateurs de radars de haute puissance sont désignés utilisateurs principaux (c.-à-d., qu'ils ont la priorité) pour les bandes 5650-5850 MHz et que ces



Quick Start Guide

radars pourraient causer du brouillage et/ou des dommages aux dispositifs LAN-EL.

Radiation Exposure Statement:

This equipment complies with ISED radiation exposure limits set forth for an uncontrolled environment. This equipment should be installed and operated with minimum distance 47cm between the radiator & your body.

Déclaration d'exposition aux radiations:

Cet équipement est conforme aux limites d'exposition aux rayonnements ISED établies pour un environnement non contrôlé. Cet équipement doit être installé et utilisé avec un minimum de 47 cm de distance entre la source de rayonnement et votre corps.

低功率電波輻射性電機管理辦法

第十二條 經型式認證合格之低功率射頻電機，非經許可，公司、商號或使用者均不得擅自變更頻率、加大功率或變更原設計之特性及功能。

第十四條 低功率射頻電機之使用不得影響飛航安全及干擾合法通信；經發現有干擾現象時，應立即停用，並改善至無干擾時方得繼續使用。

前項合法通信，指依電信法規定作業之無線電通信。

低功率射頻電機須忍受合法通信或工業、科學及醫療用電波輻射性電機設備之干擾。

在 5.15-5.25 兆赫頻帶內操作之無線資訊傳輸設備，限於室內使用。

「電磁波曝露量MPE標準值 $1\text{mW}/\text{cm}^2$ ，本產品使用時建議應距離人體 39 cm」

1. 使用此產品時應避免影響附近雷達系統之操作。
2. 高增益指向性天線只得應用於固定式點對點系統。