

ELECTRICAL

Frequency : 2.4~2.5/
5.15~5.85GHz

Maximum Gain (dBi)
2.4G 1.83dBi
5G 3.37dBi

NO	DESCRIPTION		Q'TY	REMARK
A	Body	FPC (0.5oz,1mil) (Single Layer)Black	1	
B	Double Tape	3M9888T	1	
C	Cable	(Coaxial Cable ϕ 1.13) ;Red	1	
D	Connector	4#PEX ;Ni/Gold	1	721301013076

Front View

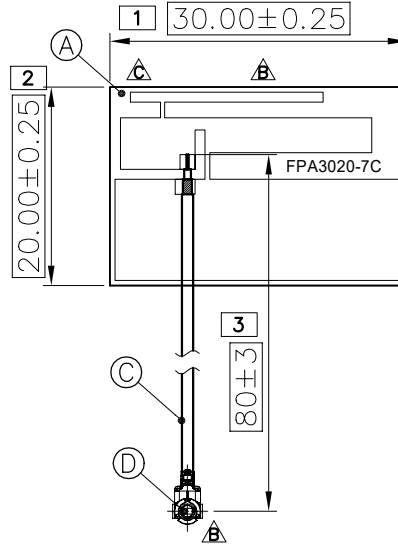

Back View

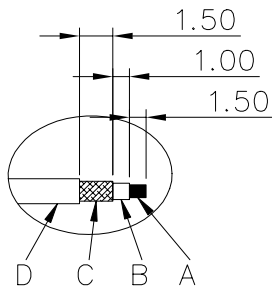
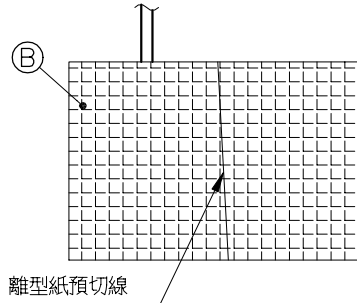

A-Center Conductor
B-Dielectric
C-Outer Conductor
D-Jacket

Connector 方向
100mm ± 90°
200mm ± 135°
200mm 以上不管控

※標記 記號者, 為重點檢驗尺寸

		設計DR.	CXLIU	2022.02.21	品名 ARTICLE	版本 REV. C														
		核准APPD.	Marco																	
<table border="1"> <tr> <td><input type="checkbox"/></td> <td>變更軟板及端子</td> <td>2022.04.26</td> <td>CXLIU</td> </tr> <tr> <td><input type="checkbox"/></td> <td>變更軟板及端子</td> <td>2022.03.11</td> <td>CXLIU</td> </tr> <tr> <td>LTR</td> <td>DESCRIPTION</td> <td>DATE</td> <td>REQ. BY</td> </tr> </table>		<input type="checkbox"/>	變更軟板及端子	2022.04.26	CXLIU	<input type="checkbox"/>	變更軟板及端子	2022.03.11	CXLIU	LTR	DESCRIPTION	DATE	REQ. BY	容許公差 TOLERANCE		RFFPA3020081MLB303	單位 UNIT	比例 SCALE	張數 SHEET	
<input type="checkbox"/>	變更軟板及端子	2022.04.26	CXLIU																	
<input type="checkbox"/>	變更軟板及端子	2022.03.11	CXLIU																	
LTR	DESCRIPTION	DATE	REQ. BY																	
		6 以下.....±0.5 6 以上~30.....±1.5 30 以上~120.....±2.0 120 以上~315.....±3.0 315 以上~1000.....±5.0 1000 以上~2000.....±8.0		mm	****	1														
華新科技股份有限公司 WALSIN TECHNOLOGY CORPORATION																				