

**CHAMBERLAIN®**

MYQ-VIDSA1INT  
Quick Start Guide

[www.chamberlain.com](http://www.chamberlain.com)



This device complies with Part 15 of the FCC Rules. Operation is subject to the following two conditions:

- (1) This device may not cause harmful interference, and
- (2) This device must accept any interference received, including interference that may cause undesired operation.

Note: This product has been tested and found to comply with the limits for a Class B digital device, pursuant to Part 15 of the FCC Rules. These limits are designed to provide reasonable protection against harmful interference in a residential installation. This product generates, uses, and can radiate radio frequency energy and, if not installed and used in accordance with the instructions, may cause harmful interference to radio communications. However, there is no guarantee that interference will not occur in a particular installation. If this product does cause harmful interference to radio or television reception, which can be determined by turning the equipment off and on, the user is encouraged to try to correct the interference by one or more of the following measures:

- Reorient or relocate the receiving antenna.
- Increase the separation between the equipment and receiver.
- Connect the equipment into an outlet on a circuit different from that to which the receiver is connected.
- Consult the dealer or an experienced radio/TV technician for help.

Please take attention that changes or modification not expressly approved by the party responsible for compliance could void the user's authority to operate the equipment.

This equipment complies with FCC/IC RSS-102 radiation exposure limits set forth for an uncontrolled environment. This equipment should be installed and operated with minimum distance 20cm between the radiator & your body.

This device complies with Industry Canada licence-exempt RSS standard(s). Operation is subject to the following two conditions:

- (1) this device may not cause interference, and
- (2) this device must accept any interference, including interference that may cause undesired operation of the device.

Le présent appareil est conforme aux CNR d'Industrie Canada applicables aux appareils radioexempts de licence. L'exploitation est autorisée aux deux conditions suivantes :

- (1) l'appareil ne doit pas produire de brouillage, et
- (2) l'utilisateur de l'appareil doit accepter tout brouillage radioélectrique subi, même si le brouillage est susceptible d'en compromettre le fonctionnement.

This equipment complies with FCC/IC RSS-102 radiation exposure limits set forth for an uncontrolled environment. This equipment should be installed and operated with minimum distance 20cm between the radiator & your body.

ce matériel est conforme aux limites de dose d'exposition aux rayonnements, FCC / CNR-102 énoncée dans un autre environnement.cette equipment devrait être installé et exploité avec distance minimale de 20 entre le radiateur et votre corps.

Under Industry Canada regulations, this radio transmitter may only operate using an antenna of a type and maximum (or lesser) gain approved for the transmitter by Industry Canada. To reduce potential radio interference to other users, the antenna type and its gain should be so chosen that the equivalent isotropically radiated power (e.i.r.p.) is not more than that necessary for successful communication.

Conformément à la réglementation d'Industrie Canada, le présent émetteur radio peut fonctionner avec une antenne d'un type et d'un gain maximal (ou inférieur) approuvé pour l'émetteur par Industrie Canada. Dans le but de réduire les risques de brouillage radioélectrique à l'intention des autres utilisateurs, il faut choisir le type d'antenne et son gain de sorte que la puissance isotrope rayonnée équivalente (p.i.r.e.) ne dépasse pas l'intensité nécessaire à l'établissement d'une communication

satisfaisante.

The user manual for local area network devices shall contain instructions related to the restrictions mentioned in the above sections, namely that:

- (i) the device for operation in the band 5150-5250 MHz is only for indoor use to reduce the potential for harmful interference to co-channel mobile satellite systems;
- (ii) the maximum antenna gain permitted for devices in the bands 5250-5350 MHz and 5470-5725 MHz shall comply with the e.i.r.p. limit; and
- (iii) the maximum antenna gain permitted for devices in the band 5725-5825 MHz shall comply with the e.i.r.p. limits specified for point-to-point and non point-to-point operation as appropriate.

(i) Les dispositifs fonctionnant dans la bande 5150-5250 MHz sont réservés uniquement pour une utilisation à l'intérieur afin de réduire les risques de brouillage préjudiciable aux systèmes de satellites mobiles utilisant les mêmes canaux.

(ii) le gain d'antenne maximal autorisé pour les appareils dans les bandes 5250-5350 MHz et 5470-5725 MHz doivent respecter le pire limiter; et

(iii) le gain d'antenne maximal autorisé pour les appareils dans la bande 5725-5825 MHz doivent respecter le pire limites spécifiées pour le point-à-point et l'exploitation non point à point, le cas échéant.

Users should also be advised that high-power radars are allocated as primary users (i.e. priority users) of the bands 5250-5350 MHz and 5650-5850 MHz and that these radars could cause interference and/or damage to LE-LAN devices.

Les utilisateurs de radars de haute puissance sont désignés utilisateurs principaux (c.-à-d., qu'ils ont la priorité) pour les bandes 5250-5350 MHz et 5650-5850 MHz et que ces radars pourraient causer du brouillage et/ou des dommages aux dispositifs LAN-EL.

# Setup

EN

## Step 1 Power-on

Plug the power cable into the camera and to the power adapter and then into a power outlet. When the indicator flickers red and blue, the power is ready for setup.

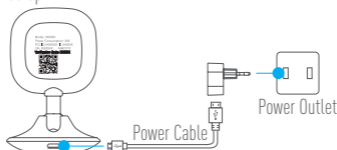

## Step 2 Quick Settings

1. Connect your mobile phone to Wi-Fi.
2. Download and install the My Q app by searching "My Q" in App Store (iOS 7.0 or later) and Google Play™ (Android 4.0 or later).
3. Launch the app and register for an My Q user account following the start-up wizard.
4. Log in the app and in the Home screen, tap "+" on the upper-right corner to enter the adding device interface.
5. Scan the QR code of the device with your mobile phone. Or you can manually input the 9-digit serial number to add the camera. The QR code and the serial number are located on the label on the back of the camera.

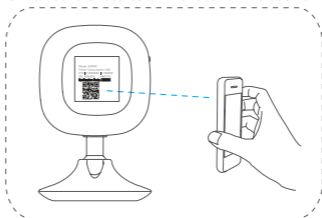

6. Follow the procedure to set the Wi-Fi connection of the camera.
7. Set the correct time zone, DST information and Date Format to finish setup.

## Installation

### Step 1 Installing the Metal Plate (Optional)

Pick a clean and flat surface and secure the metal plate to the desired position with the foam stickers or screws.

- i** There's a magnet piece inside the camera. You can skip this step if the surface is made of metal.

### Step 2 Installing the Camera

Secure the camera magnetically to the metal plate or metal surface.

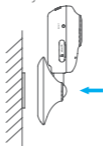

### Step 3 Completing Installation

Adjust the camera angle as required.

## Recording on the Memory Card

### Step 1 Installing the Memory Card

1. Flip the memory card slot cover clockwise to open it, see the following left figure.
2. Insert a microSD card into the slot until a click, see the following right figure.

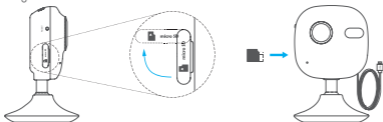

3. Replace the cover.

### Step 2 Initializing the Memory Card

1. From the My Q app, check the memory card status by tapping on the Storage Status in the Device Settings.
2. If the memory card status displays as Not Initialized, tap the Initialize button to initialize it. You can then record event triggered video in the camera after the initialization completed.

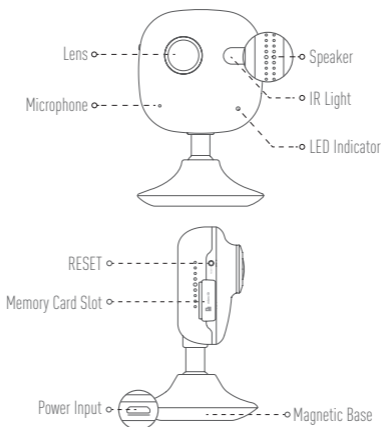

Name	Description
IR Light	Auto light source for dark environment. The camera video has two modes: color (for daylight recording) and black and white with IR illuminator (for night condition).
LED Indicator	<ul style="list-style-type: none"> <li>• Blinking Red and Blue: The camera is on; you can configure the Wi-Fi connection.</li> <li>• Steady Blue: The camera is being connected and operated by user(s).</li> <li>• Slow Blue Flicker: The camera is running properly.</li> <li>• Steady Red: The camera is starting up.</li> <li>• Slow Red Flicker: The Wi-Fi connection has failed.</li> <li>• Fast Red Flicker: MicroSD card error.</li> </ul>
Memory Card Slot	For microSD card (not included with this product). You can purchase separately. Recommended compatibility: Class 10, maximum space 128GB. After inserting the card, you can record the event inside the camera. You need to initialize it on the My Q App.
RESET	Hold down the RESET button for 10 seconds while the camera is running, the camera restarts and all parameters are reset to default.
Power Input	$\approx 5V \pm 10\%$

## Troubleshooting

**Q:** "The device is offline." or "The device is not registered." prompts appear when adding the camera using the My Q App.

**A:** 1. Make sure the network, which the camera is connected to, is working properly and the router's DHCP is enabled.  
2. Hold down the RESET button for 10 seconds to reset the settings if you change the network parameters.

**Q:** The mobile phone cannot receive alarm prompts when the camera is online.

**A:** 1. Make sure the My Q app is running on your mobile phone.  
2. For Android OS mobile phone, make sure the app is running in the background; and for iOS mobile phones, enable the message push function in "Settings > Notification".

**Q:** Does the camera support power via USB devices or a portable battery.

**A:** It's advised to use the My Q standard power adapter to provide a stable voltage supply.

**i** For more information, please visit [www.MyQlife.com](http://www.MyQlife.com).



**CHAMBERLAIN.**