

onn.

USER GUIDE

42" 5.1.2 Surround Soundbar System

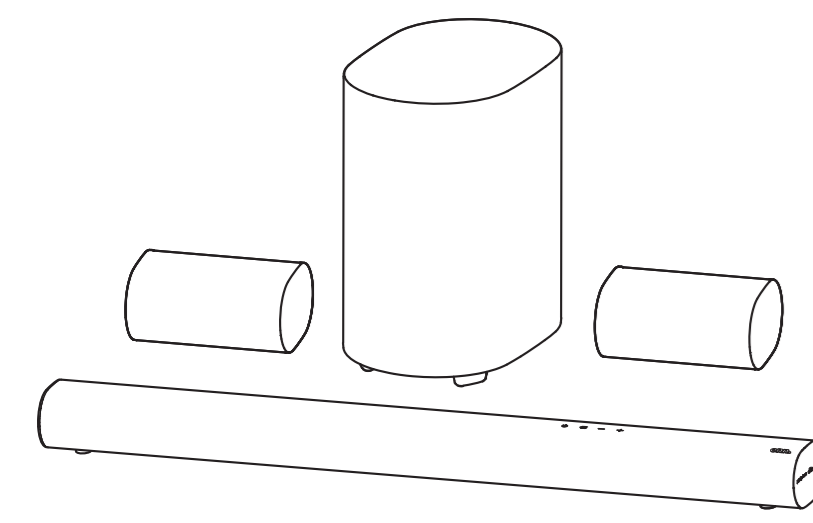

100135495

Figure 1

Contents & Information

CONTENTS & INFORMATION

- OVERVIEW 1
- MODEL DESCRIPTION 4
- FIRST TIME SETUP 6
- OPERATION 11
- CLEANING & CARE 16
- SPECIFICATIONS 16
- TROUBLESHOOTING 17

Features

- 5.1.2 Channels
- 6 Internal speakers + 2 true wireless satellite speakers + 1 wireless subwoofer
- 250W RMS output /1000W peak output (4 x RMS)
- White LED display
- Dolby Atmos*
- DTS:X* + DTS Virtual:X™
- Roku TV Ready*
- Bluetooth*

Overview

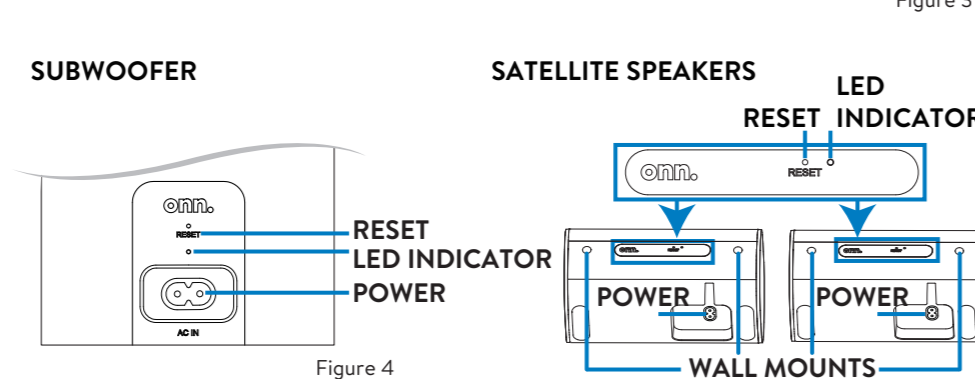
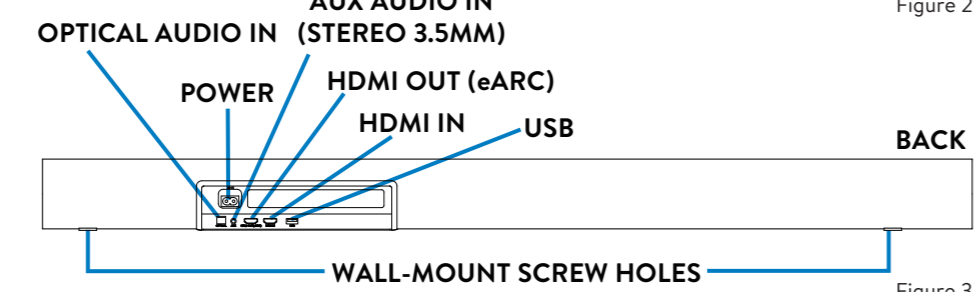
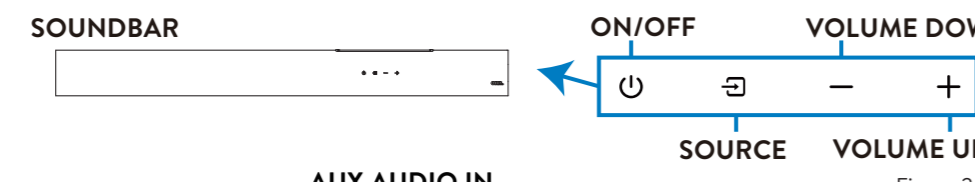

Figure 5

Function	Display
Power On	HELLO
Power Off	BYE
HDMI (ARC)	EARC/ARC
HDMI IN	HDMI
Optical	OPT
Aux in	AUX
USB	USB
Bluetooth pairing mode	BT PAIRING
Bluetooth device connected	BT
Volume up / down	VOLUME
Maximum / Minimum volume	MAX / MIN
Mute	MUTE
Talk mode	TALK
Music mode	MUSIC
Movie mode	MOVIE
Bass +/-	BASS +/-
Treble +/-	TRE +/-
DTS Virtual:X ON	VRTX ON
DTS Virtual:X OFF	VRTX OFF
Subwoofer and Satellite Speakers are pairing with Soundbar	SW PAIRING
Subwoofer and Satellite Speakers are connected with Soundbar	CONNECTED

Table 1

Table 2

Model Description

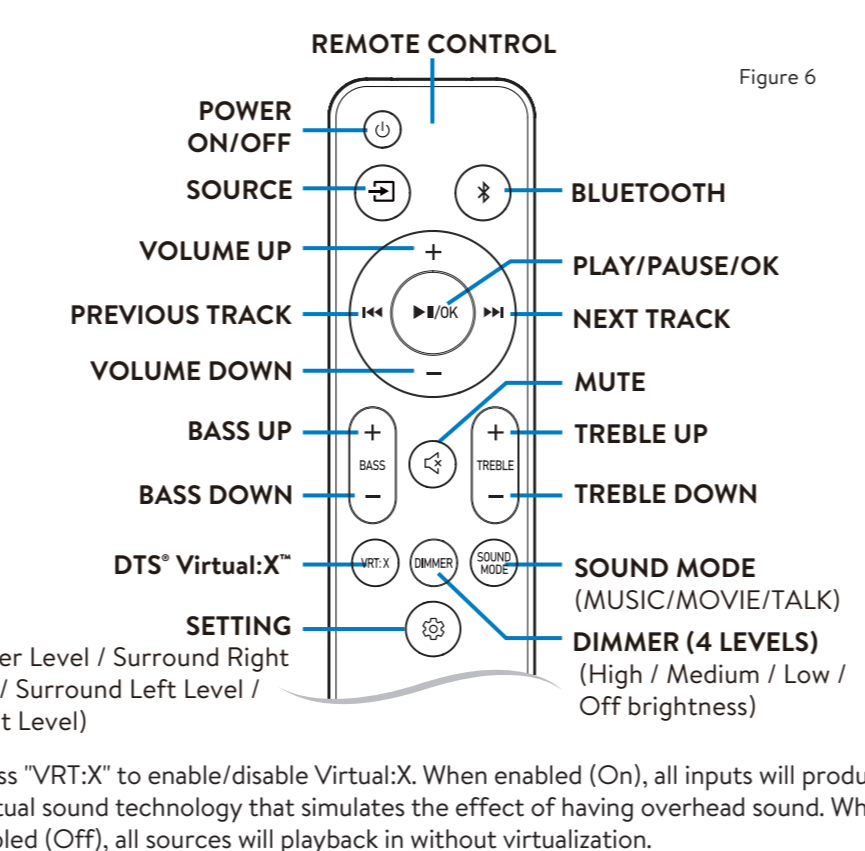

Figure 7

*Press "VRTX" to enable/disable Virtual:X. When enabled (On), all inputs will produce a virtual sound technology that simulates the effect of having overhead sound. When disabled (Off), all sources will playback in without virtualization.

Model Description



HARDWARE

Part	Description	Picture	Qty
A	Anchor		6
B	Short Screws		6
C	Long Screws		6
D	Wall Mount Brackets		4

Table 3

Figure 7

(Wall mounting, optional)

Parts

PARTS

Part	Description	Qty	Part	Description	Qty
1	Soundbar	1	6	HDMI cable	1
2	Wireless subwoofer	1	7	Optical cable	1
3	Satellite speaker	2	8	3.5 mm AUX cable	1
4	Remote control (requires 2 AAA batteries, included)	1	9	Wall mounting kit	1
5	Power cable	4	10	Wall mounting template	3
			11	Quick Start Guide	1

Table 4

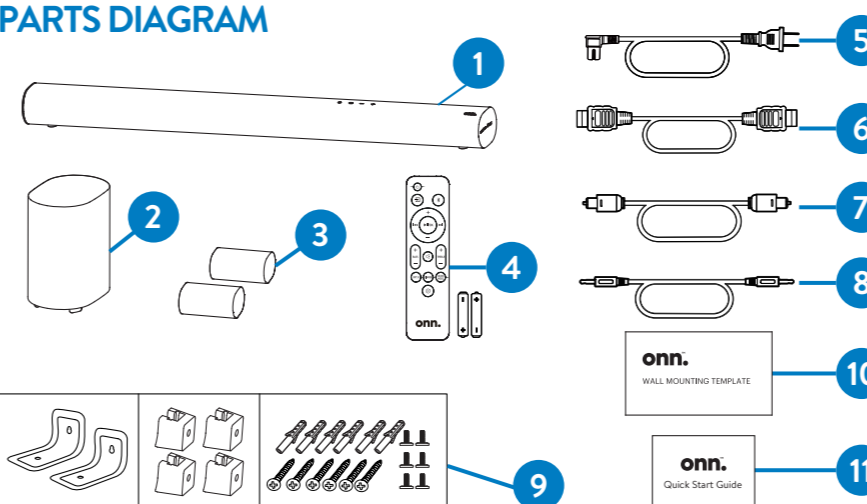

Figure 8

First Time Setup

ON A SURFACE

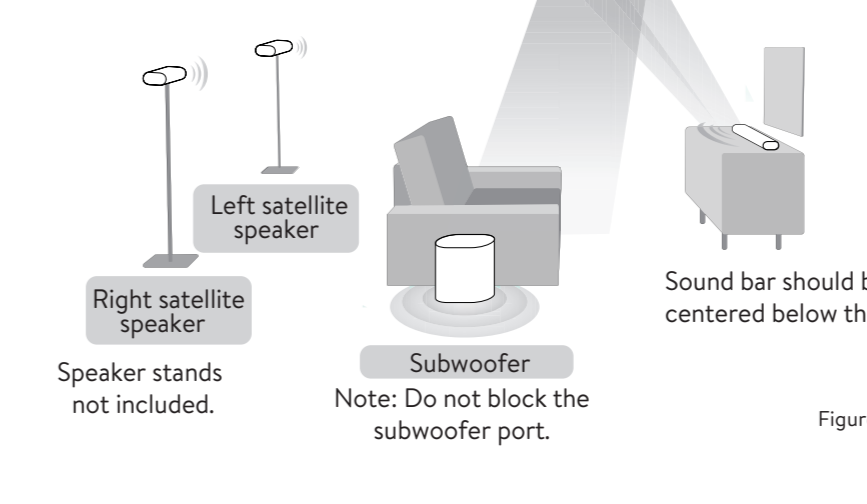
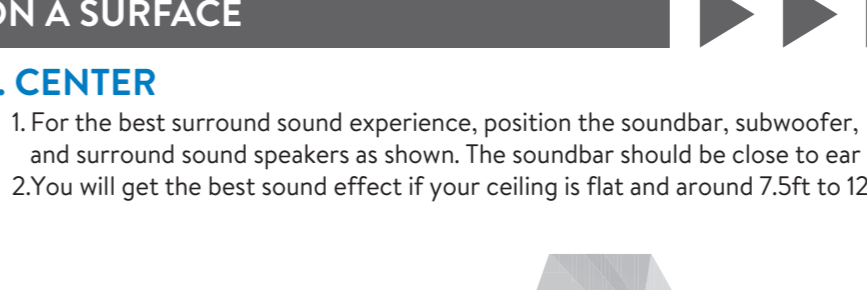

Figure 11

Speaker stands not included. Note: Do not block the subwoofer port.

Cleaning & Care

CLEANING

- Wipe down surfaces with a light cloth.
- Never use abrasive pads to clean device.
- Avoid using liquids to clean device.

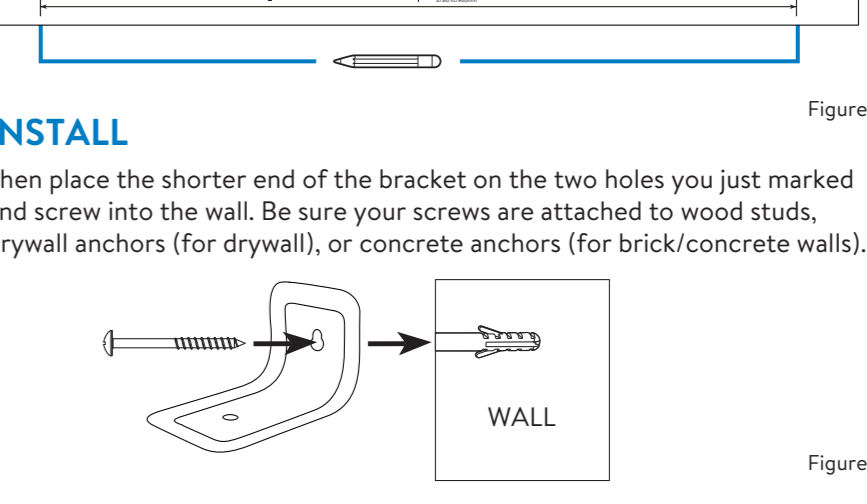

Figure 16

CAUTION
Ensure the unit is fully unplugged from the power supply before cleaning.

Specifications

Assembled LxWxH

- Soundbar: 42 x 4.3 x 3.2 Inches
- Subwoofer: 8.2 x 11.8 x 13.9 Inches
- Satellite Speaker: 6.5 x 4.3 x 3.2 Inches

Table 7

Problem	Cause	Solution
No power	Power off	Press "ON" button on remote control or on Soundbar.
	Loose power cord	Ensure the power cord is securely connected.
No audio	Faulty outlet	Plug a different device into the electrical outlet to verify that the outlet is working correctly.
	Low Volume / Mute	Press "VOLUME" +/- buttons to increase volume.
	Some TVs do not Pass through Digital Audio	Change TV output to PCM.
Bluetooth or disconnect	Input source	Select different Input source
	Not All TVs have Audio outputs listed.	Connect directly to another device (Blu-Ray, Game System, etc.)
	TV set to variable audio output	Set audio output to fixed or standard, NOT variable.
	Bluetooth source device	Increase volume / unmute source device
Subwoofer and soundbar too far	The subwoofer is out of range, please move the subwoofer closer to the soundbar.	The subwoofer is within 5m of the soundbar.
	Source too far	Move the source device closer to soundbar
	Solid obstruction	Move source device into line-of-site of soundbar
Other wireless devices	Turn off / move devices away (wireless security cameras, wireless video baby monitors, cordless phones, and microwave ovens)	

Table 7

Table 7

3B. HANG

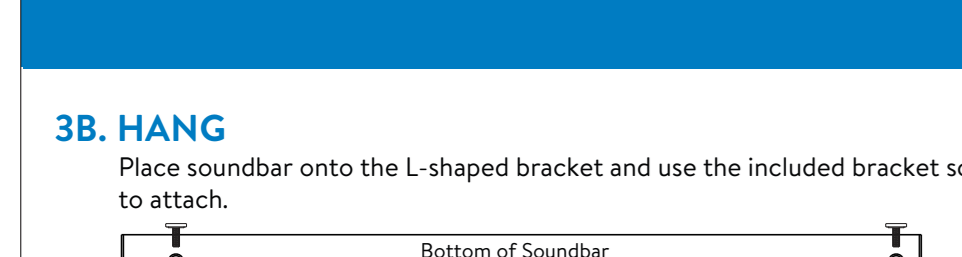

Figure 12

Wall-mounting the Satellite Speakers

- To wall-mount the satellite speakers**
1. Attach the wall mount screw to the back of the satellite speakers.
 2. Secure the wall mount bracket to the wall.
 3. Slide the speakers on to the wall brackets. Ensure the wall mount screw is secured within the bracket grooves.

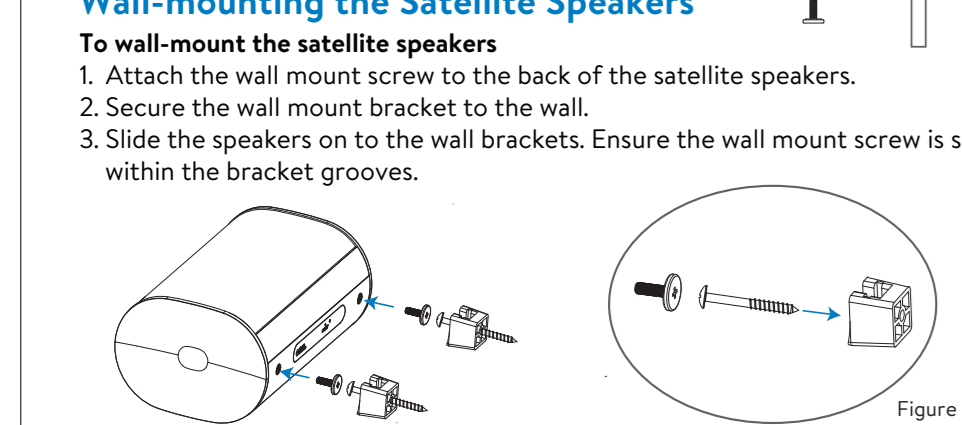

Figure 13

4. CHOOSE CABLE

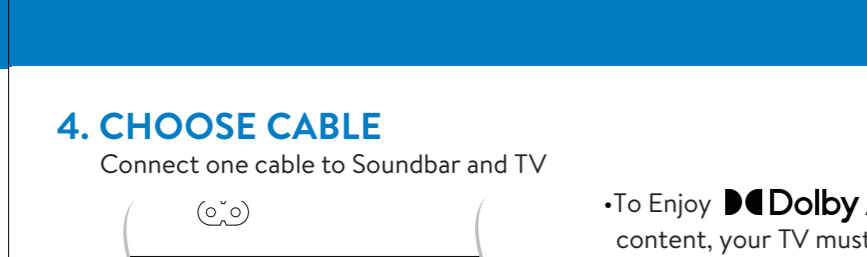

Figure 14

Better Good Best

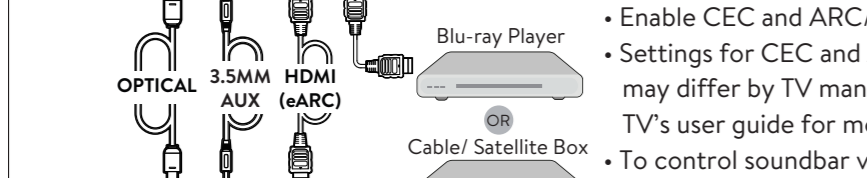

Figure 14

- To Enjoy **Dolby Atmos** content, your TV must support the HDMI-CEC and Enhanced Audio Return Channel (eARC) function.
- Enable CEC and ARC/eARC on TV
- Settings for CEC and ARC/eARC may differ by TV manufacturer. See TV's user guide for more.
- To control soundbar volume on TV remote, enable System Audio Control in CEC menu.
- CEC Function naming may differ by TV Manufacture. See TV's user guide for more.
- Only HDMI 2.0 cables (and higher) support eARC.
- If no Audio using Digital Inputs see troubleshooting.

Tip: If you have a Roku TV®, setup is easy. Just use the included cable to connect your soundbar to the HDMI (ARC/eARC) port on your TV and follow the on-screen instructions.

5. CONNECT POWER

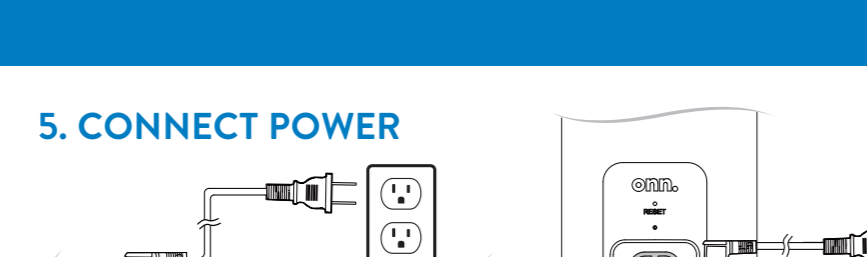

Figure 15

6. INSTALL BATTERIES



Figure 16

- WARNING**
Do not mix old and new batteries.
- WARNING**
Do not mix alkaline, standard (carbon-zinc) or rechargeable (nickel-cadmium, ni-mh, etc.) batteries.

Figure 16

Operation

CONNECT SUBWOOFER & SATELLITES

1A. AUTOMATIC PAIRING



Figure 17

1B. MANUAL PAIRING (IF AUTOMATIC PAIRING FAILED)

- A: Press and hold the reset hole of the subwoofer and satellite speakers for 1 second with a pin.
- B: Press "BT" and "BT" simultaneously for 3 seconds on the soundbar or remote control.
- C: When wireless connection is successful, the indicator will be solid blue.

Figure 18

LED State	Status
Flashing	In pairing mode
Breathing	Connection/Pairing Failed
Solid	Connected/Pairing successful

Table 5

Table 5

Operation

CONNECT SUBWOOFER & SATELLITES

1B. MANUAL PAIRING (IF AUTOMATIC PAIRING FAILED)

- A: Press and hold the reset hole of the subwoofer and satellite speakers for 1 second with a pin.
- B: Press "BT" and "BT" simultaneously for 3 seconds on the soundbar or remote control.
- C: When wireless connection is successful, the indicator will be solid blue.

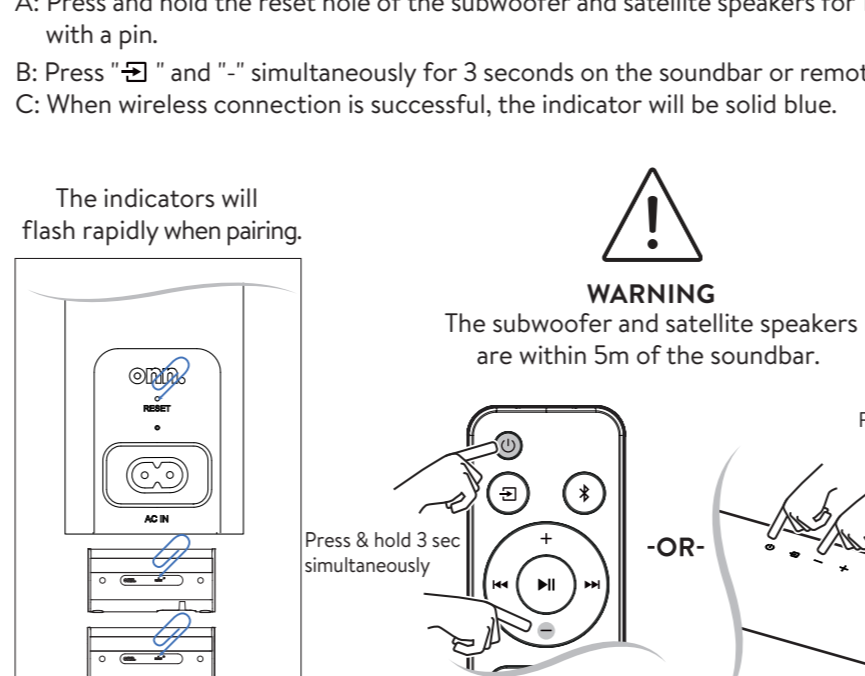

Figure 18

Bluetooth® Operation

1A. POWER ON/OFF

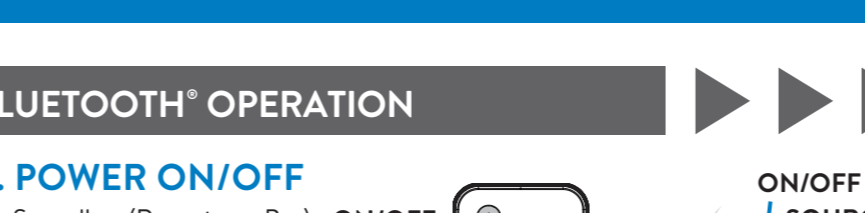

Figure 19

2A. SELECT SOURCE

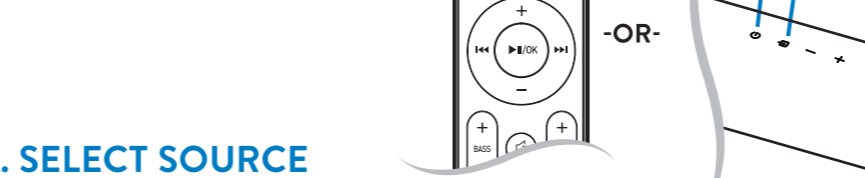

Figure 20

3A. PAIR DEVICE

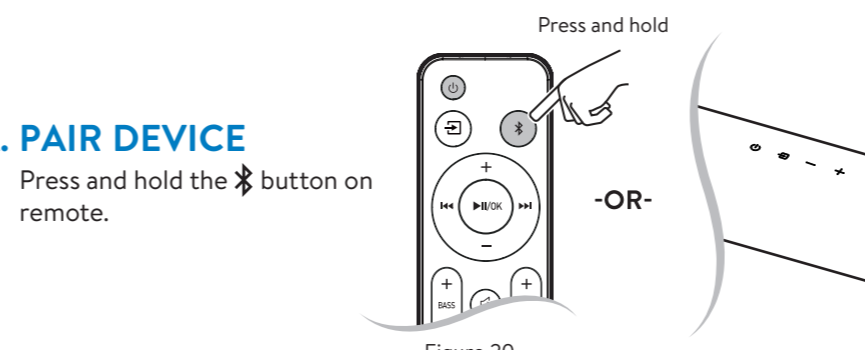

Figure 20

Bluetooth® Operation

1A. POWER ON/OFF

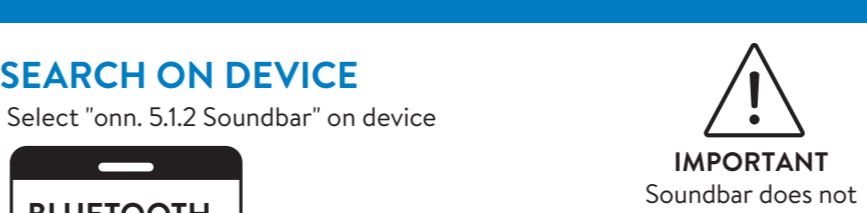

Figure 19

2A. SELECT SOURCE



Figure 20

3A. PAIR DEVICE

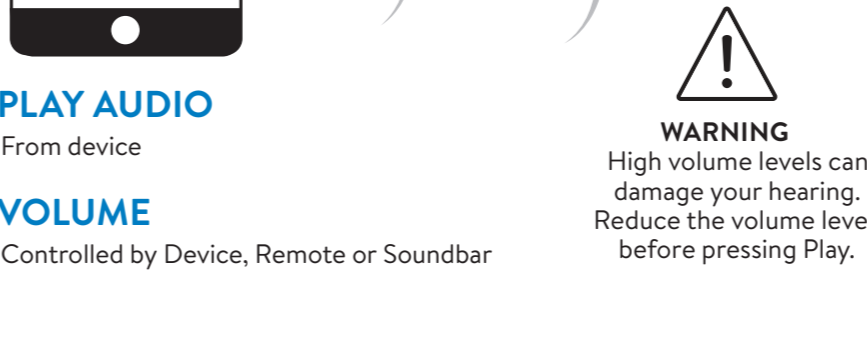

Figure 20

4A. SEARCH ON DEVICE

Select "onn. 5.1.2 Soundbar" on device



Figure 21

5A. PLAY AUDIO

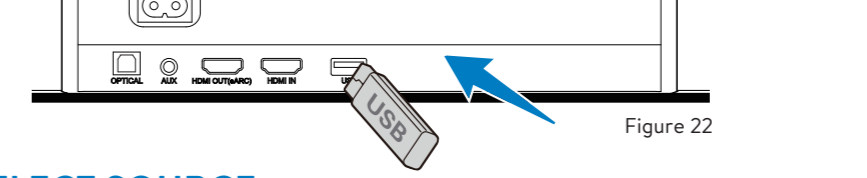

Figure 21

6A. VOLUME

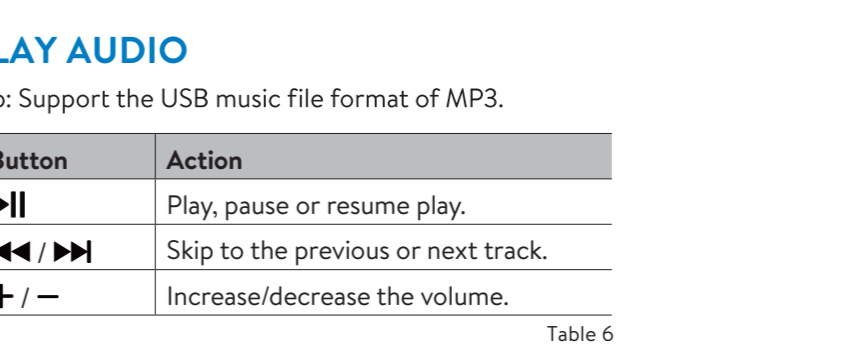

Figure 21

USB OPERATION

1B. INSERT THE USB DEVICE

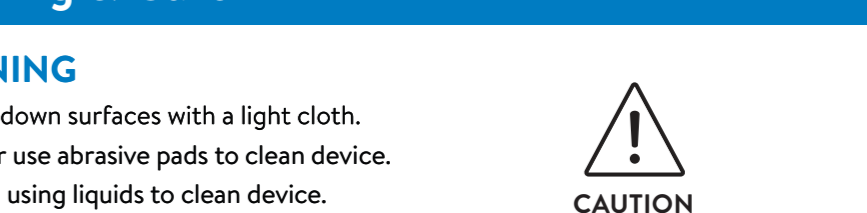

Figure 22

2B. SELECT SOURCE



Figure 22

3B. PLAY AUDIO

Tip: Support the USB music file format of MP3.

Button	Action
	Play, pause or resume play.
	Skip to the previous or next track.
	Increase/decrease the volume.

Table 6

Table 6

1120mm

正面

onn.™

42 5.1.2 Surround Soundbar System
Model:100135495

Wall Mounting Template

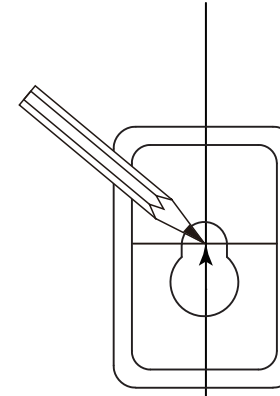

MARK HERE

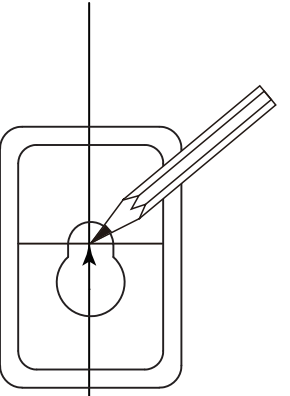

MARK HERE

背面



IMPORTANT SAFETY INSTRUCTIONS

- Read these instructions - All the safety and operating instructions should be read before this product is operated.
- Keep these instructions - The safety and operating instructions should be retained for future reference.
- Heed all warnings - All warnings on the appliance and in the operating instructions should be adhered to.
- Follow all instructions - All operating and use instructions should be followed.
- Do not use this apparatus near water - The appliance should not be used near water or moisture - for example, in a wet basement or near a swimming pool, and the like.
- Clean only with dry cloth.
- Do not block any ventilation openings. Install in accordance with the manufacturer's instructions.
- Do not install near any heat sources such as radiators, heat registers, stoves, or other apparatus (including amplifiers) that produce heat.
- Do not defeat the safety purpose of the polarized or grounding plug. A polarized plug has two blades with one wider than the other. A grounding plug has two blades and a third grounding prong. The wide blade or the third prong is provided for your safety. If the provided plug does not fit into your outlet, consult an electrician for replacement of the obsolete outlet.
- Protect the power cord from being walked on or pinched particularly at the plugs, convenience receptacles, and at the point where they exit from the apparatus.
- Only use attachments/accessories specified by the manufacturer.
- Use only with the cart, stand, tripod, bracket, or table specified by the manufacturer, or sold with the apparatus. When a cart or rack is used, use caution when moving the cart/appliance combination to avoid injury from tip-over.
- Unplug the apparatus during lightning storms or when unused for long periods of time.
- Refer all servicing to qualified personnel. Servicing is required when the apparatus has been damaged in any way, such as power supply cord or plug is damaged, liquid has been spilled on or objects have fallen into the apparatus has been exposed to rain or moisture, does not operate normally, or has been dropped.



IMPORTANT SAFETY INSTRUCTIONS

- Do not install this equipment in a confined or built-in space such as a book case or similar unit, and maintain well-ventilated conditions. The ventilation should not be impeded by covering the ventilation openings with items, such as newspaper, tablecloths, curtains, etc.
- WARNING:** To reduce the risk of fire or electric shock, do not expose this apparatus to rain or moisture. The apparatus shall not be exposed to dripping or splashing and that objects filled with liquids, such as vases, shall not be placed on apparatus.
- WARNING:** The mains plug is used as disconnect device. The disconnect device shall remain readily operable.
- This equipment is a Class II or double insulated electrical appliance. It has been designed in such a way that it does not require a safety connection to electrical earth.
- This lightning flash with arrowhead symbol within an equilateral triangle is intended to alert the user to the presence of non-insulated "dangerous voltage" within the product's enclosure that may be of sufficient magnitude to constitute a risk of electric shock.
- Warning:** To reduce the risk of electric shock, do not remove cover (or back) as there are no user-serviceable parts inside. Refer servicing to qualified personnel.
- The exclamation point within an equilateral triangle is intended to alert the user to the presence of important operating and maintenance instructions in the literature accompanying the appliance.

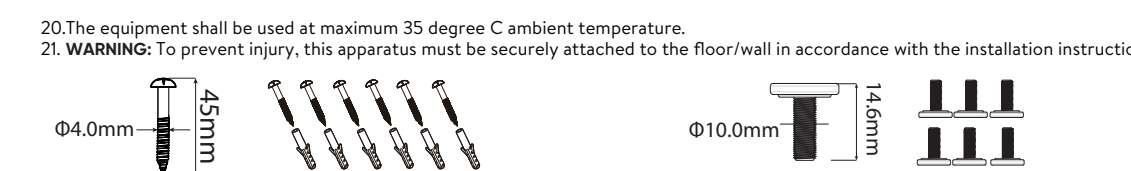

CAUTION

- Batteries should not be exposed to excessive heat such as sunshine, fire, etc.
- Keep new and used batteries away from children.
- If the battery compartment does not close securely, stop using the product and keep it away from children.
- If you think batteries might have been swallowed or placed inside any part of the body, seek immediate medical attention.

Dolby Atmos

Dolby, Dolby Atmos, and the double D symbol are registered trademarks of Dolby Laboratories Licensing Corporation. Manufactured under license from Dolby Laboratories. Confidential unpublished works. Copyright © 2012-2021 Dolby Laboratories. All rights reserved.

HDMI

The Adapted Trademarks HDMI, HDMI High Definition Multimedia Interface, HDMI trade dress and the HDMI Logos are trademarks or registered trademarks of HDMI Licensing Administrator, Inc. in the United States and other countries.

Bluetooth

The Bluetooth® word mark and logos are registered trademarks owned by the Bluetooth SIG, Inc. and any use of such marks by Walmart Inc. is under license. Other trademarks and trade names are those of their respective owners.

Roku TV

Roku TV, Roku TV Ready, and the Roku TV Ready logo are trademarks of Roku, Inc. This product is Roku TV Ready-supported in the United States. Countries are subject to change. For the most current list of countries in which this product is Roku TV Ready-supported, please email rokutvready@roku.com.

FCC Statement :

This device complies with Part 15 of the FCC Rules. Operation is subject to the following two conditions: 1) This device may not cause harmful interference, and 2) This device must accept any interference received, including interference that may cause undesired operation.

- Note:** This equipment has been tested and found to comply with the limits for a Class B digital device, pursuant to part 15 of the FCC Rules. These limits are designed to provide reasonable protection against harmful interference in a residential installation. This equipment generates, uses and can radiate radio frequency energy and, if not installed and used in accordance with the instructions, may cause harmful interference to radio communication. However, there is no guarantee that interference will not occur in a particular installation. If this equipment does cause harmful interference to radio or television reception, which can be determined by turning the equipment off and on, the user is encouraged to try to correct the interference by one or more of the following measures:
- Reorient or relocate the receiving antenna.
 - Increase the separation between the equipment and receiver.
 - Connect the equipment into an outlet on a circuit different from that to which the receiver is connected.
 - Consult the dealer or an experienced radio/TV technician for help.

FCC Caution:

- Changes or modifications not expressly approved by the party responsible for compliance could void the user's authority to operate the equipment.
- This equipment complies with FCC and IC radiation exposure limits set forth for an uncontrolled environment. This equipment should be installed and operated with minimum distance 20cm between the radiator & your body.
- Shielded cables must be used with this unit to ensure compliance with the Class B FCC limits.

California Prop 65 Warning :

WARNING This product can expose you to chemicals, including Lead, which is known to the State of California to cause cancer. For more information go to: www.P65Warnings.ca.gov.

Federal Communications Commission (FCC) Statement

This device complies with part 15 of the FCC Rules. Operation is subject to the following two conditions: (1) This device may not cause harmful interference, and (2) this device must accept any interference received, including interference that may cause undesired operation.

- Note:** This equipment has been tested and found to comply with the limits for a Class B digital device, pursuant to part 15 of the FCC Rules. These limits are designed to provide reasonable protection against harmful interference in a residential installation. This equipment generates, uses and can radiate radio frequency energy and, if not installed and used in accordance with the instructions, may cause harmful interference to radio communications. However, there is no guarantee that interference will not occur in a particular installation. If this equipment does cause harmful interference to radio or television reception, which can be determined by turning the equipment off and on, the user is encouraged to try to correct the interference by one or more of the following measures:
- Reorient or relocate the receiving antenna.
 - Increase the separation between the equipment and receiver.
 - Connect the equipment into an outlet on a circuit different from that to which the receiver is connected.
 - Consult the dealer or an experienced radio/TV technician for help.

Warning: Changes or modifications made to this device not expressly approved by SHENZHEN FENDA TECHNOLOGY CO., LTD. may void the FCC authorization to operate this device.

RF exposure statement:

The transmitter must not be colocated or operated in conjunction with any other antenna or transmitter. This equipment complies with the FCC RF radiation exposure limits set forth for an uncontrolled environment. This equipment should be installed and operated with a Minimum distance of 20cm between the radiator and any part of your body.

160mm